

Plan Showing the Revised Proposal for the construction of Stilt Floor part / Ground floor part + 4 floors Retail Shop cum commercial (Office) building availing Premium FSI (Height = 18.30m) at Old Door No.8, New Door No.37, Thanikachalam Road, T.Nagar, Chennai Comprised in Old S.No.6313part, T.S.No.6313/2, Block No.138 of T.Nagar village within Greater Chennai Corporation Limit.

| A) AREA STATEMENT | SQ.M. |
|--|---------|
| AREA AS PER PATA | 683.50 |
| AREA AS PER DOCUMENT | 683.50 |
| AREA CONSIDERED FOR FSI | 683.50 |
| STREET ALIGNMENT/ ROAD WIDENING/ LINK ROAD | 0.00 |
| OSR AREA | 0.00 |
| TOTAL FSI AREA | 1602.37 |
| FSI FACTOR | 2.344 |
| COVERAGE AREA (PERCENTAGE %) | NA |

| A) PARKING STATEMENT | REQUIRED | PROVIDED |
|----------------------|----------|----------|
| VEHICLE | | |
| LORRY | 0 | 0 |
| CAR | 14 | 15 |
| TWO WHEELER | 51 | 59 |
| CYCLE | 0 | 0 |

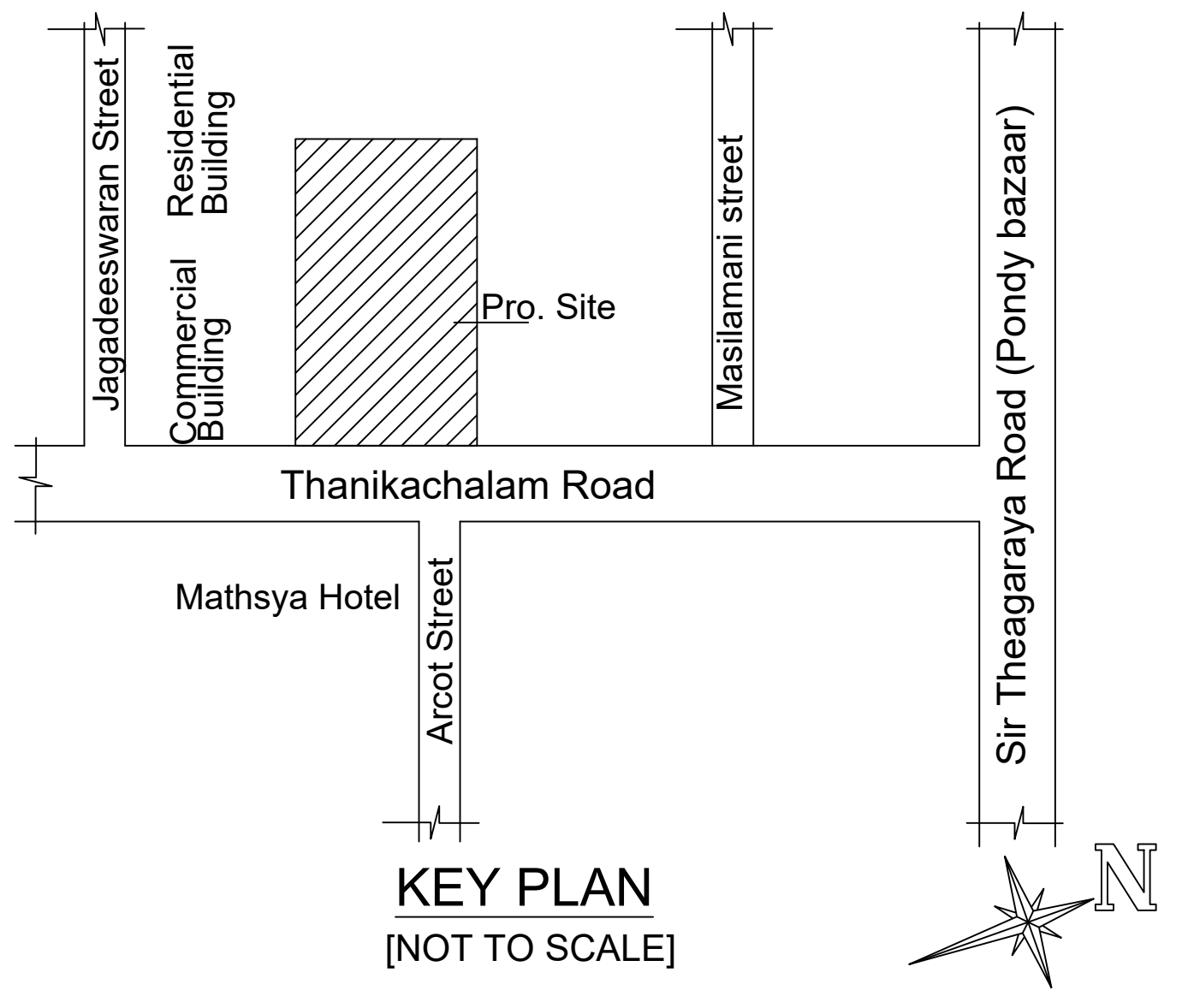

Location plan (Taken as per User Inputs)

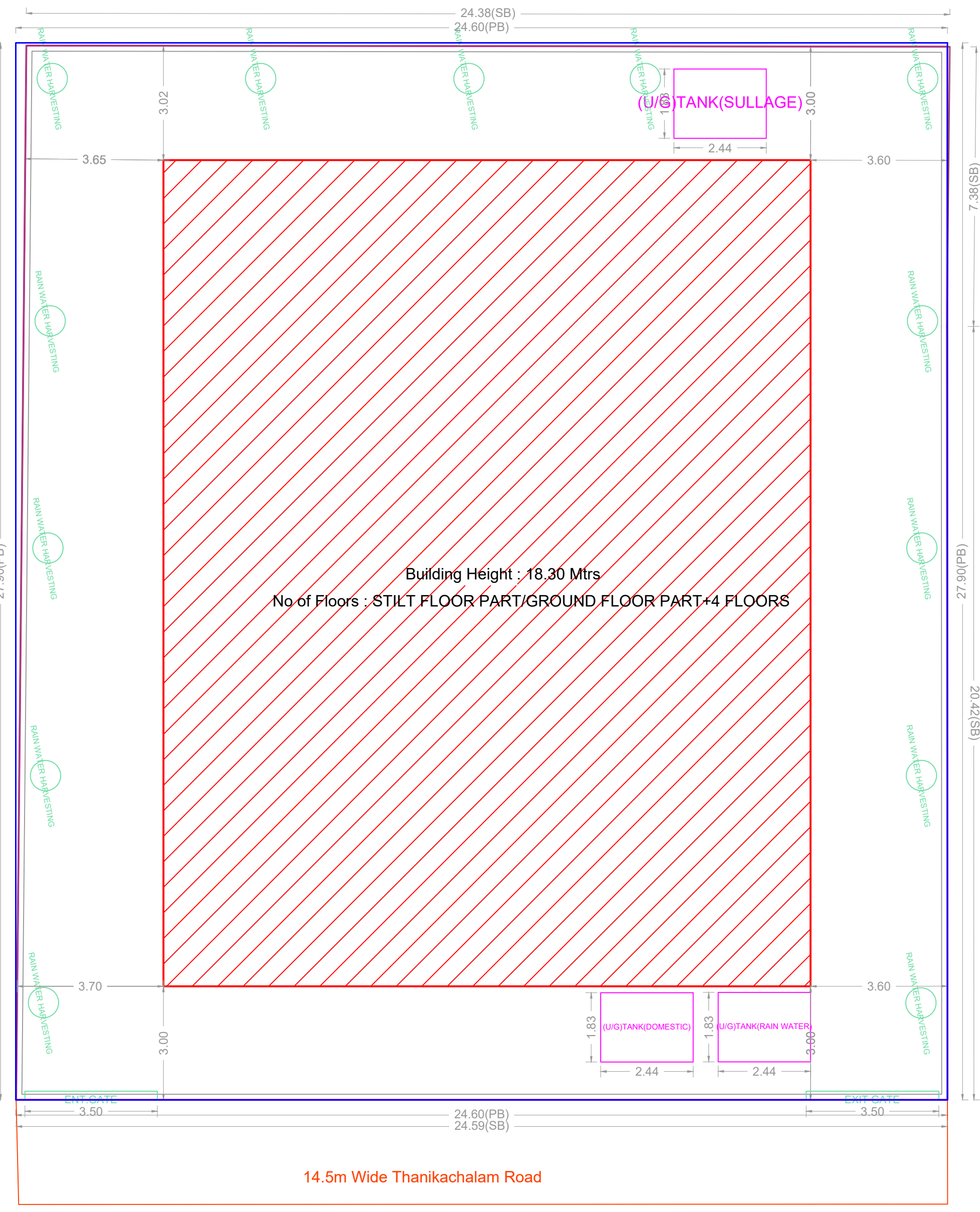

SITE PLAN

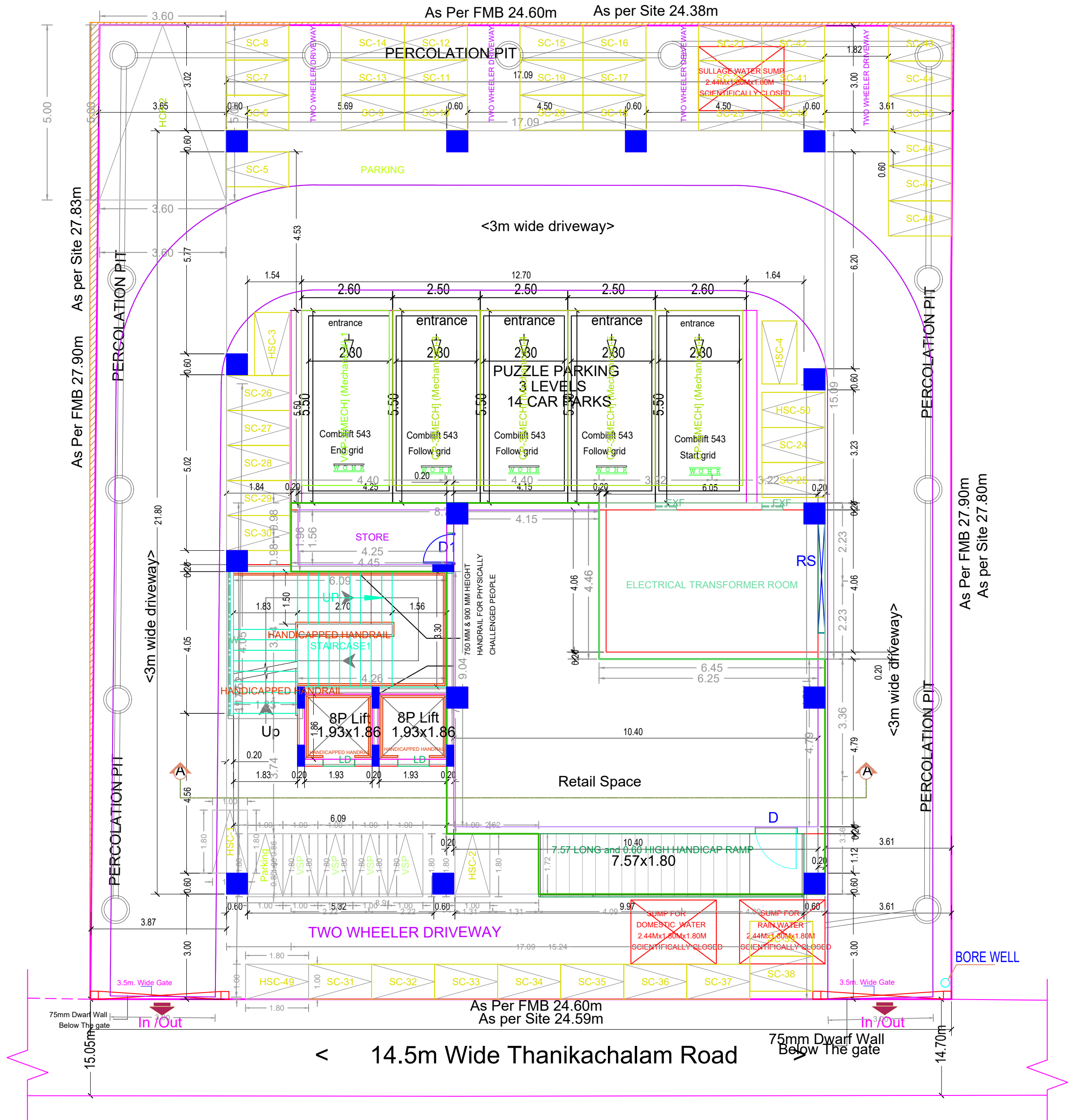

SITE/STILT FLOOR PLAN

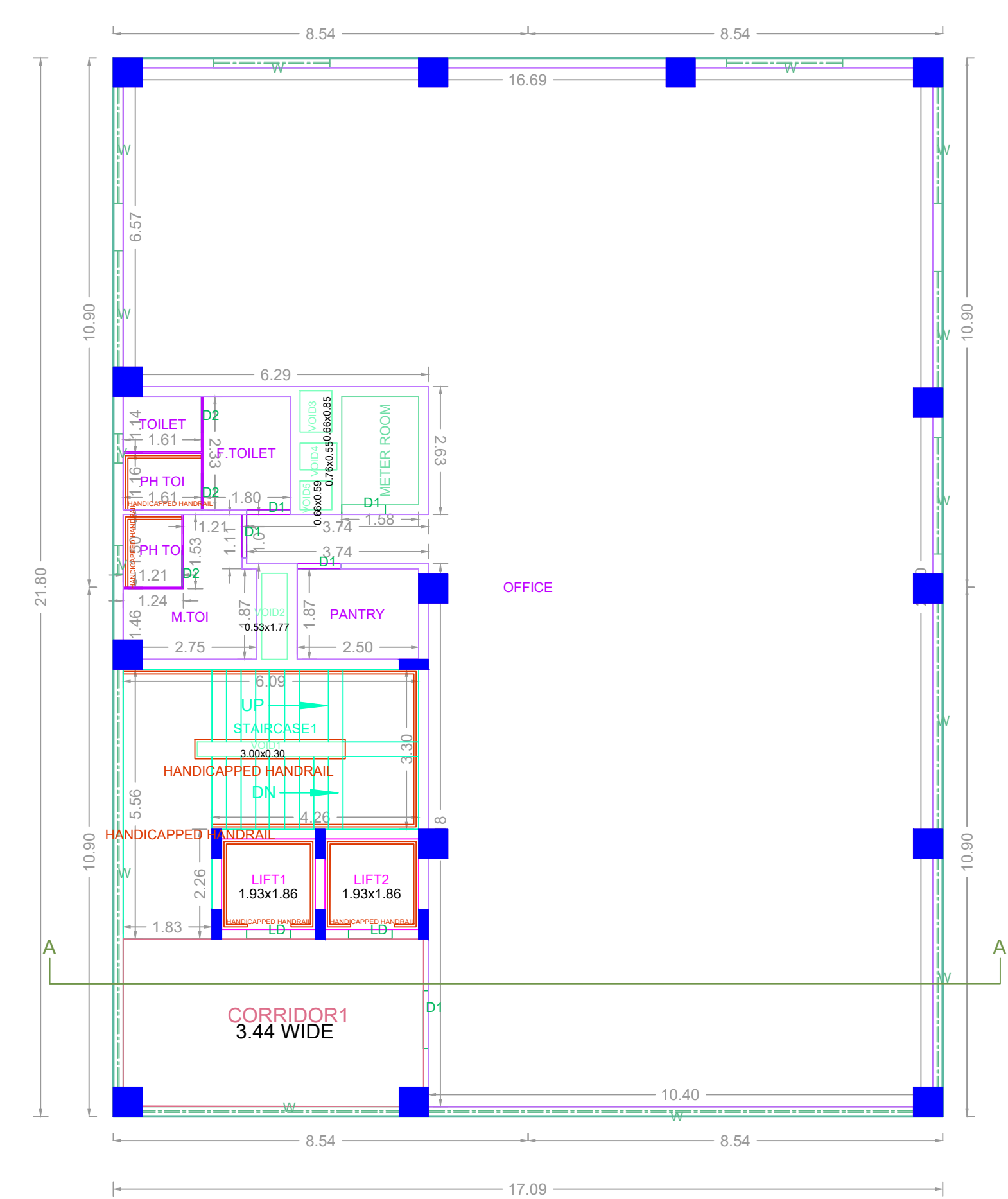

TYPICAL 1-4 FLOOR PLAN

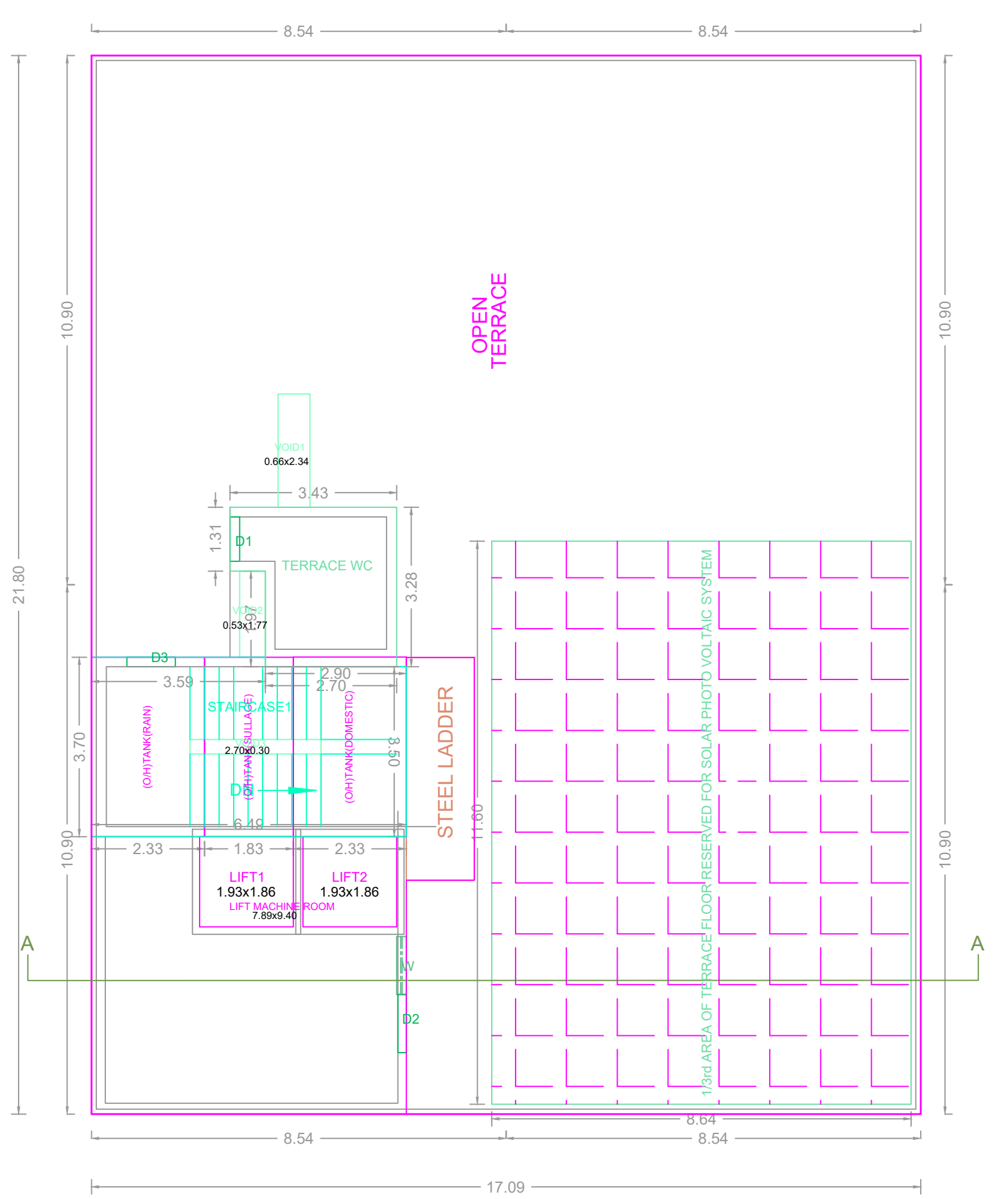

TERRACE FLOOR PLAN

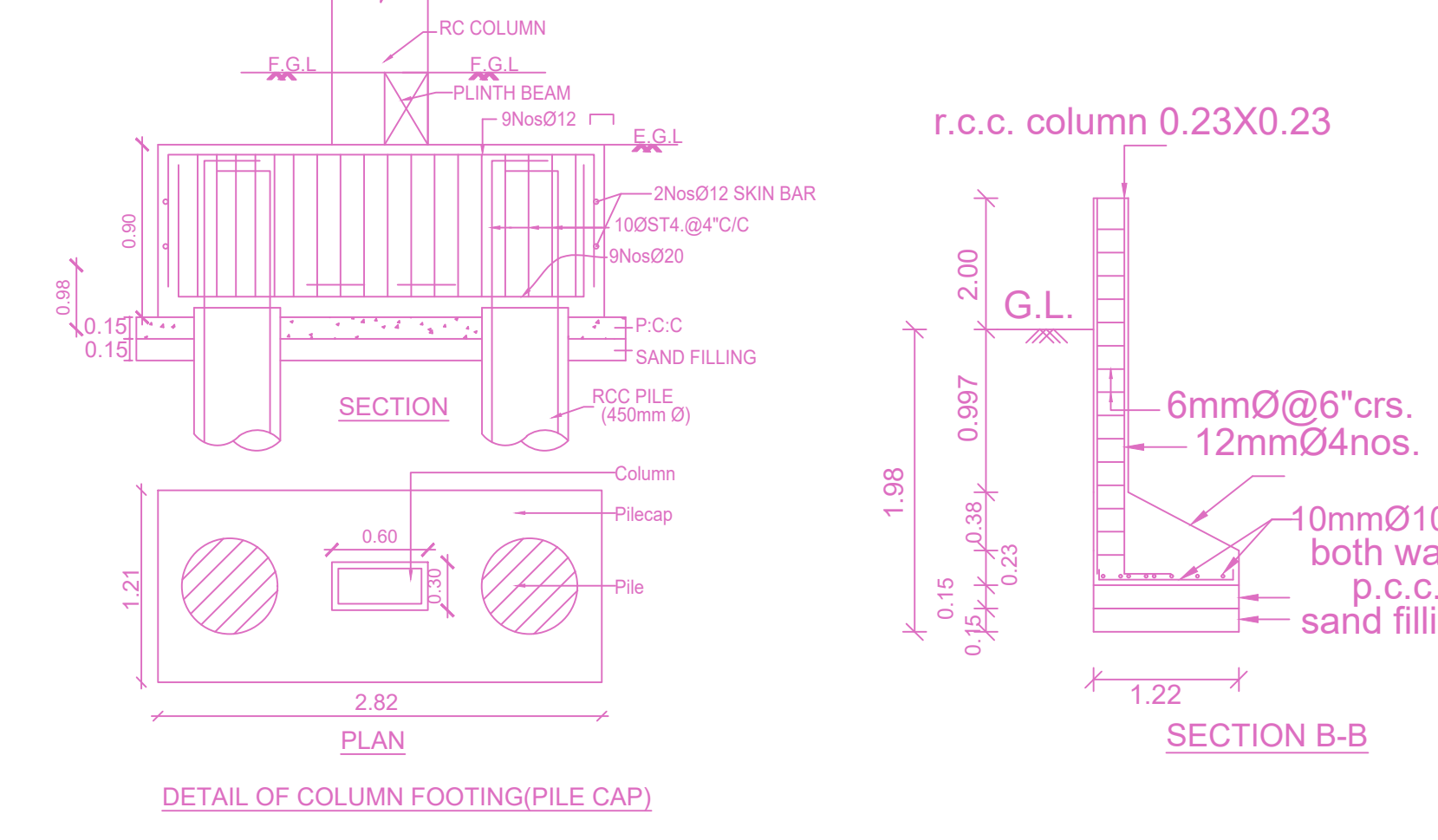
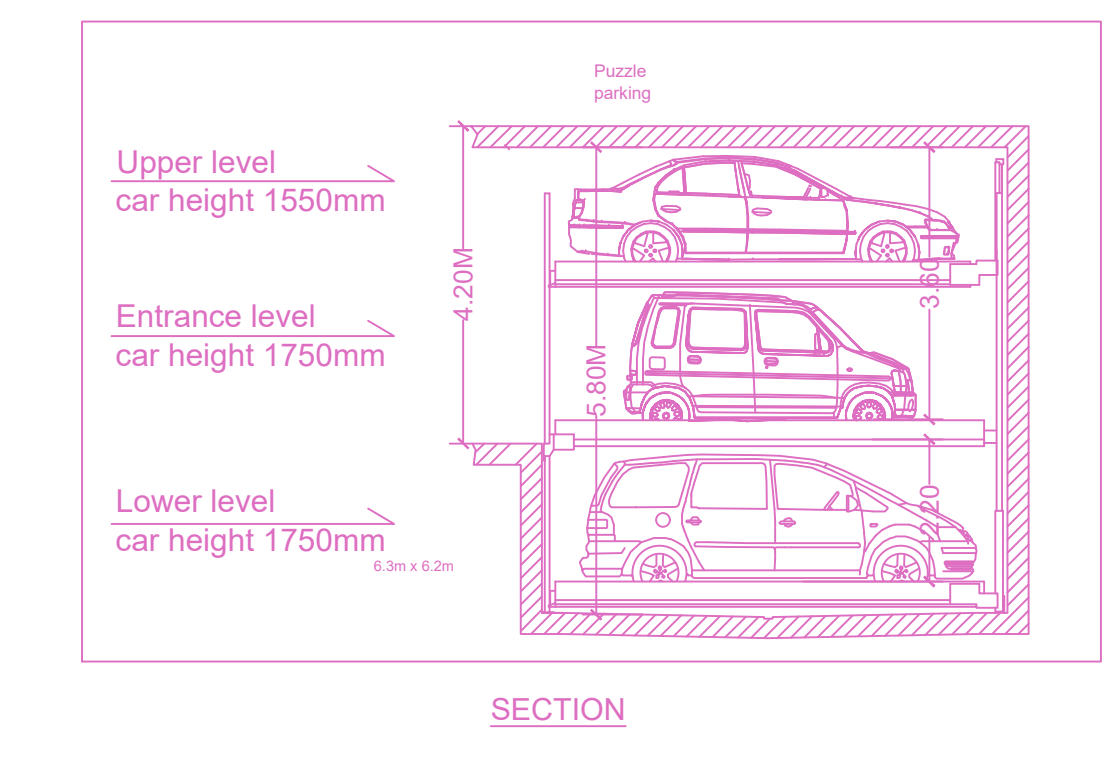
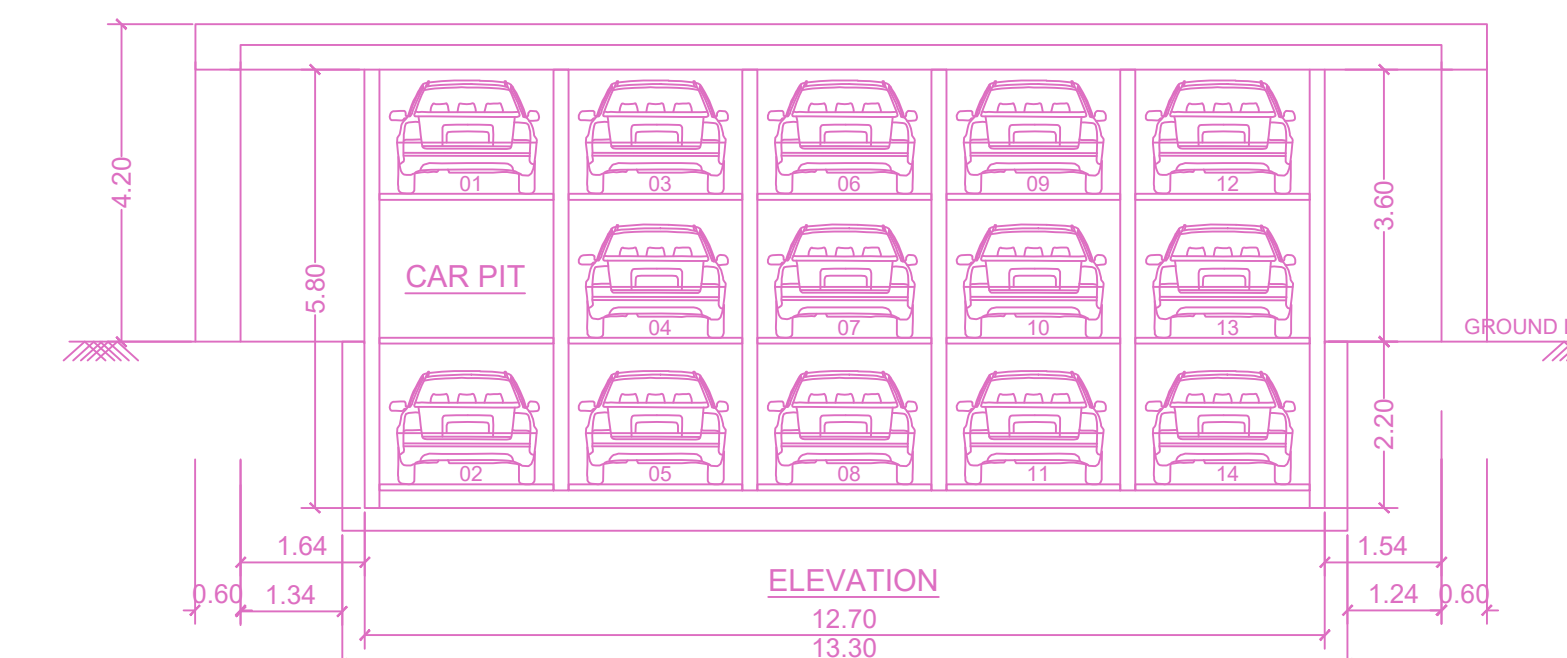
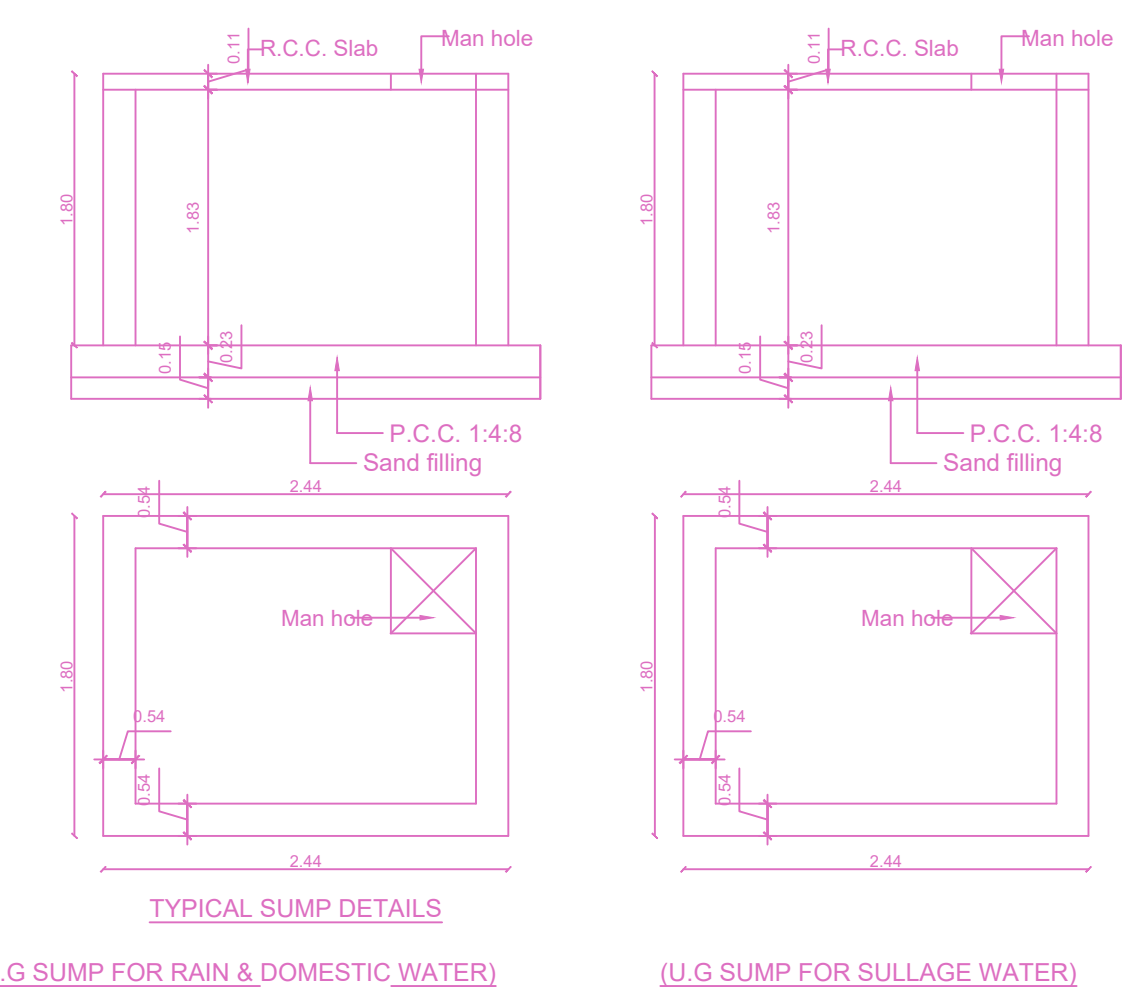

FLOOR WISE FSI STATEMENT: COM (1)

| FLOORS | COMM. | RESI. | IND. | SPEC. | DU | TOTAL FSI AREA |
|---------------------|---------|-------|------|-------|----|----------------|
| Terrace | 0.00 | 0.00 | 0.00 | 0.00 | 0 | 0.00 |
| FOURTH FLOOR | 369.38 | 0.00 | 0.00 | 0.00 | 0 | 369.38 |
| THIRD FLOOR | 369.38 | 0.00 | 0.00 | 0.00 | 0 | 369.38 |
| SECOND FLOOR | 369.38 | 0.00 | 0.00 | 0.00 | 0 | 369.38 |
| FIRST FLOOR | 369.38 | 0.00 | 0.00 | 0.00 | 0 | 369.38 |
| STILT PARKING FLOOR | 124.85 | 0.00 | 0.00 | 0.00 | 0 | 124.85 |
| Total | 1602.37 | 0.00 | 0.00 | 0.00 | 0 | 1602.37 |

BUILDING WISE FSI STATEMENT

| BUILDING | NO OF SAME BUILDING | COMM. | RESI. | IND. | SPEC. | DU | TOTAL FSI AREA |
|-----------|---------------------|---------|-------|------|-------|----|----------------|
| COM-1 (1) | 1 | 1602.37 | 0.00 | 0.00 | 0.00 | 0 | 1602.37 |
| Total | | 1602.37 | 0.00 | 0.00 | 0.00 | 0 | 1602.37 |

APPROVAL CONDITION

SCALE: 1:100

CHENNAI METROPOLITAN DEVELOPMENT AUTHORITY

APPROVED

SUBJECT TO THE CONDITIONS MENTIONED IN THIS OFFICE

For Check/Planner / Chief Planner / Member Secretary
High Rise Building / Non High Rise Building
This Approval is valid only after building Permit is issued by the concerned Local Body.

KEY NO. 3788 QR CODE