

PLAN SHOWING THE PROPOSED CONSTRUCTION OF STILT + 2 FLOOR + 3rd FLOOR (Part) RESIDENTIAL BUILDING WITH 9 DWELLING UNITS AT PLOT NO. 1 & 2, LOTUS STREET, KOLAPAKKAM, CHENNAI-600 122 AND COMPRISED IN S. NO. 63/3 & 4 OF KOLAPAKKAM VILLAGE, KUNDRATHUR TALUK, KANCHIPURAM DISTRICT AND WITHIN THE LIMITS OF KUNDRATHUR PANCHAYAT UNION

A) AREA STATEMENT	SQ.M.
AREA AS PER PATA	400.00
AREA AS PER DOCUMENT	403.20
AREA CONSIDERED FOR FSI	400.00
STREET ALIGNMENT/ ROAD WIDENING/LINK ROAD	0.00
OSR AREA	0.00
TOTAL FSI AREA	788.61
FSI FACTOR	1.972
COVERAGE AREA (PERCENTAGE %)	NA

A) PARKING STATEMENT	REQUIRED	PROVIDED
VEHICLE		
LORRY	0	0
CAR	3	9
TWO WHEELER	10	10
CYCLE	0	0

REGULARIZATION APPROVAL:-
REGULARISATION APPROVAL OBTAINED IN KUNDRATHUR PANCHAYAT UNION VIDE LETTER NO. 3226/2022/A3, DATED 17.08.2022, PLANNING PERMIT NO. 1045/2022

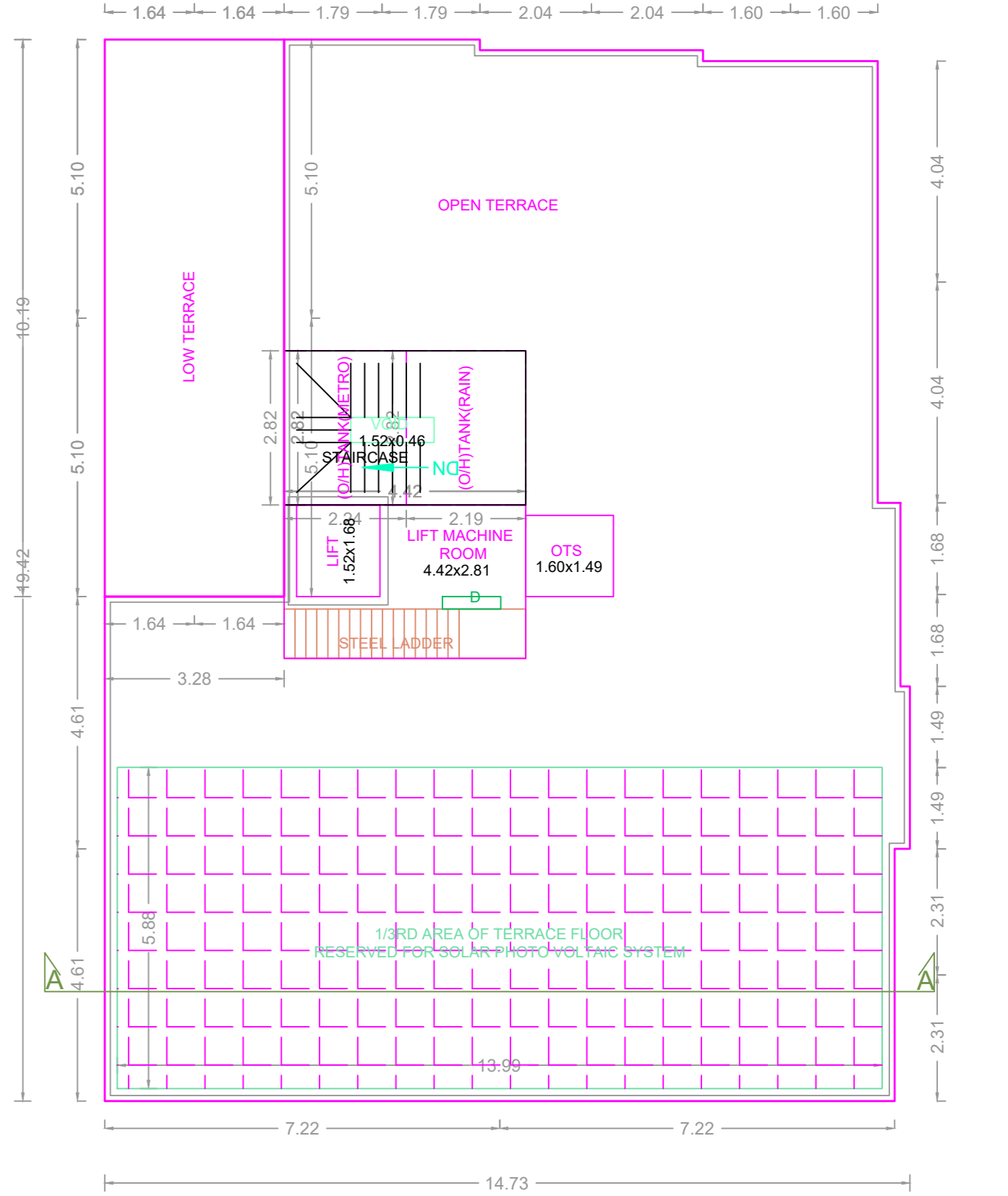
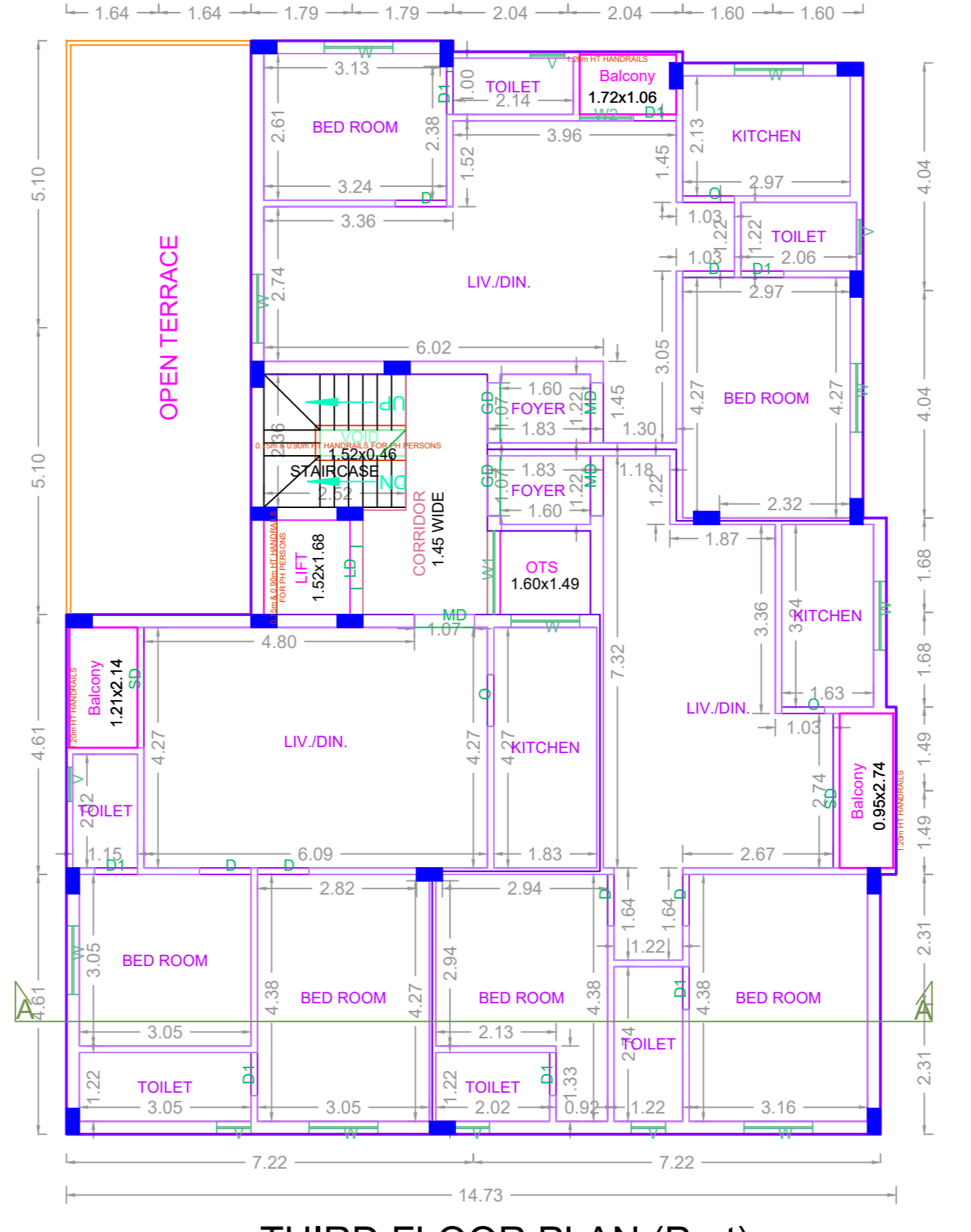
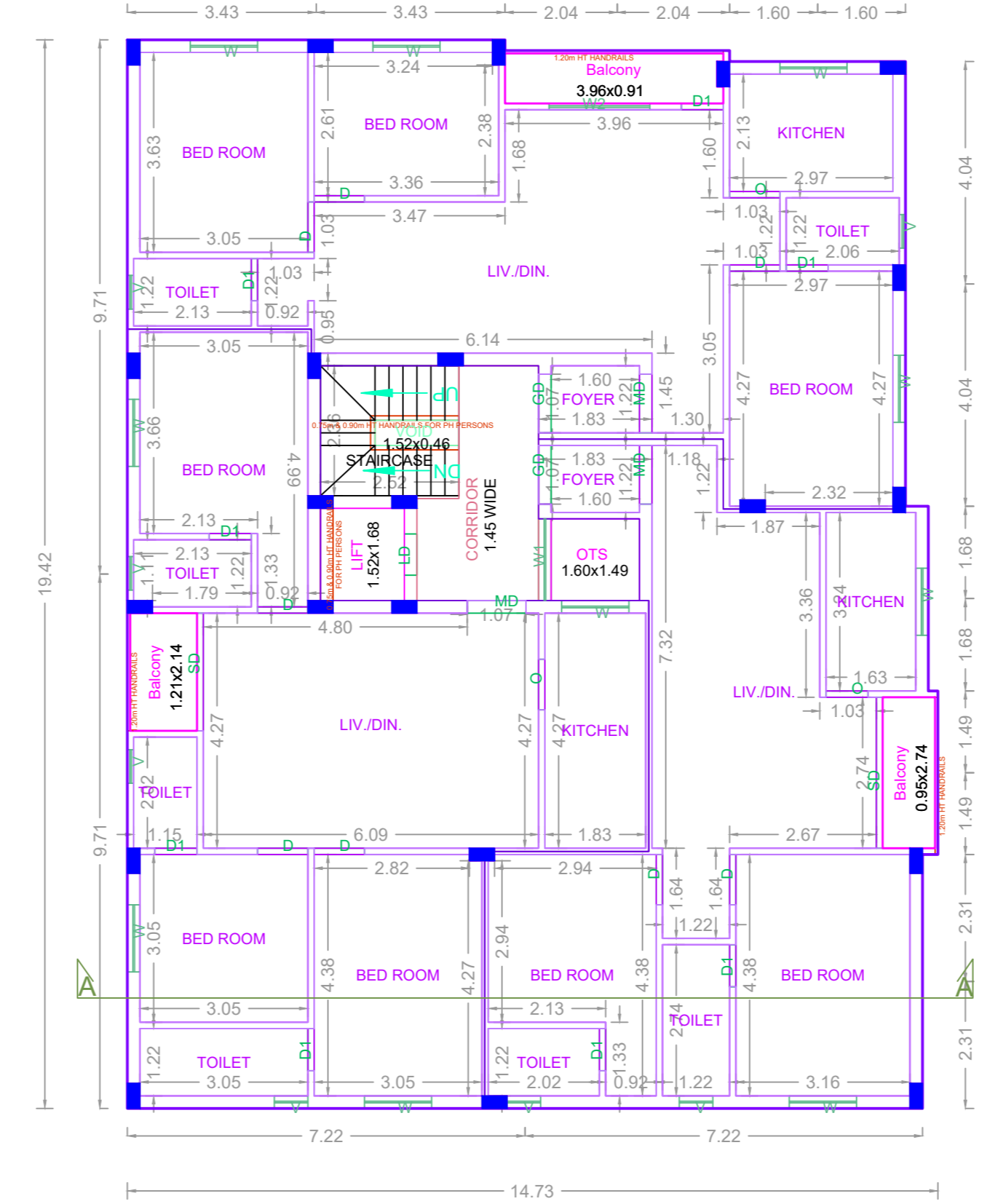
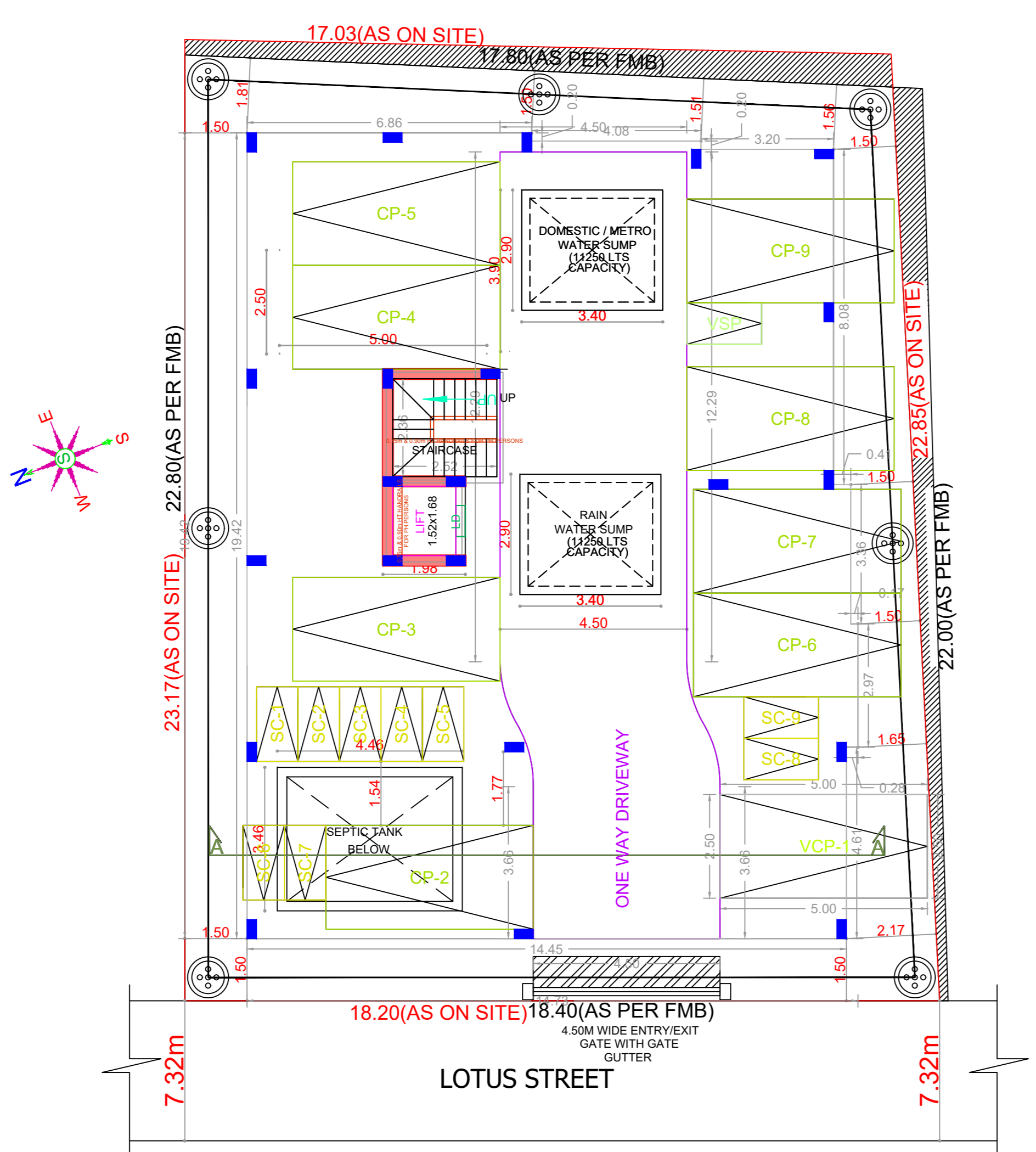
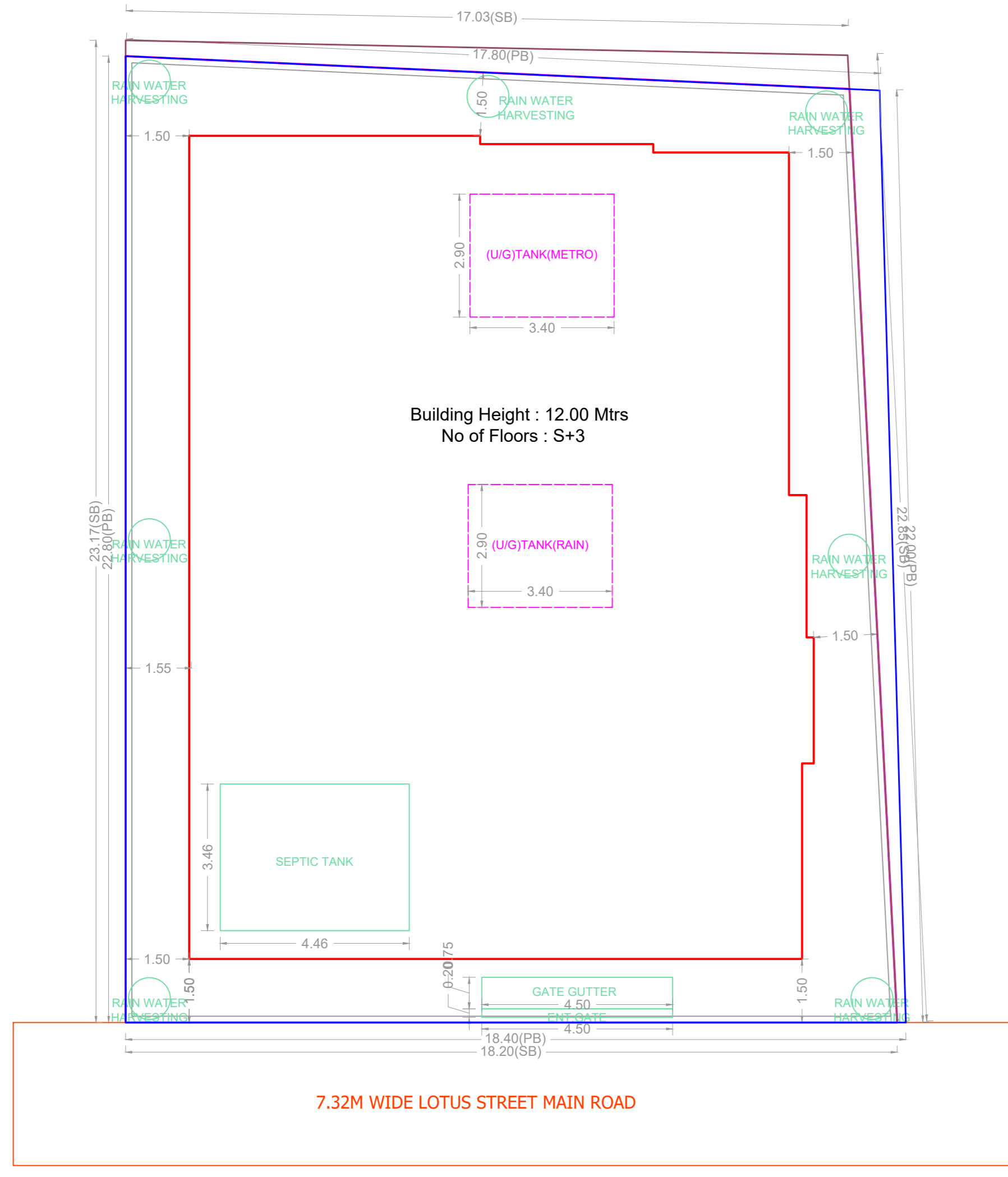
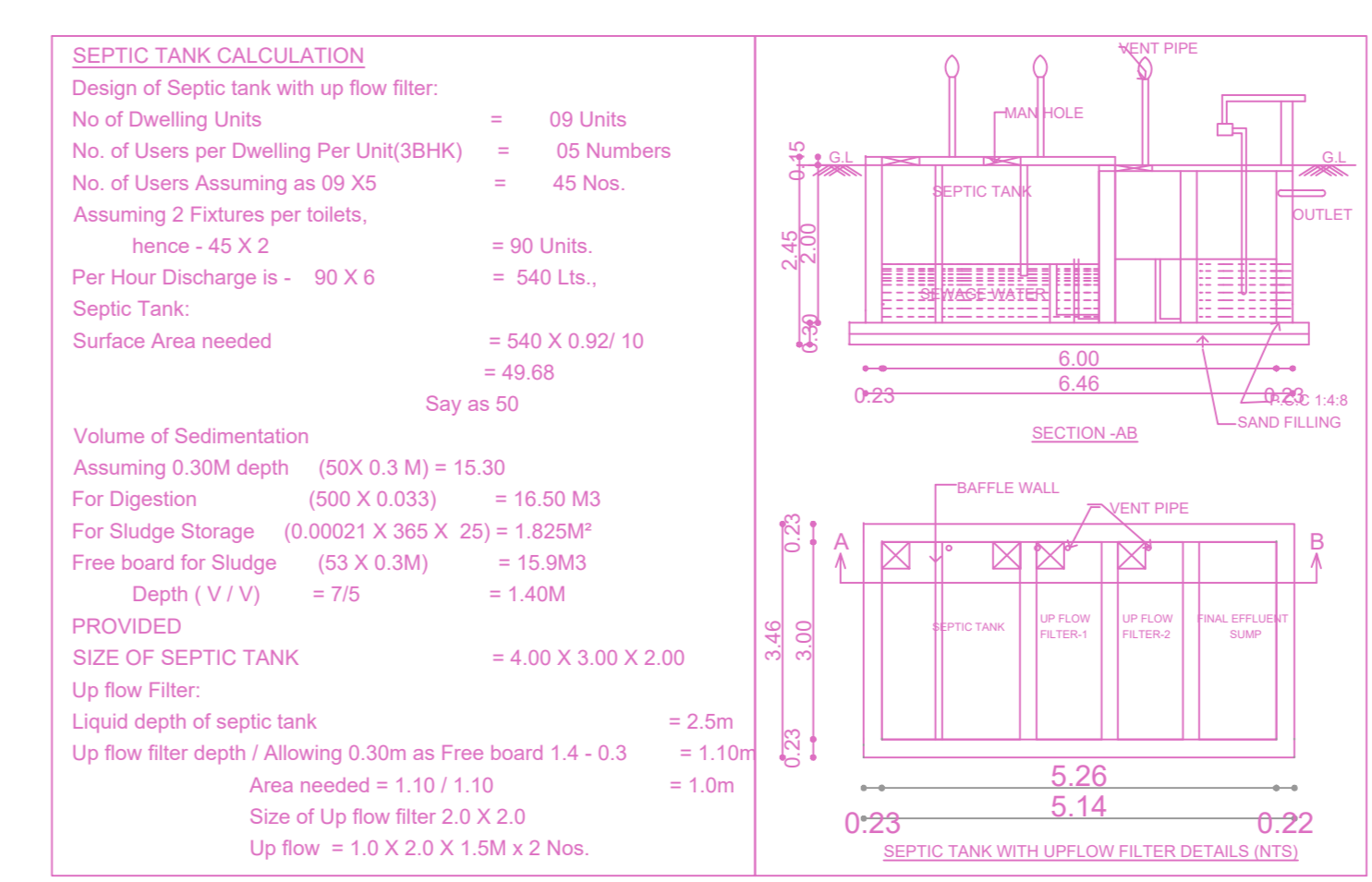
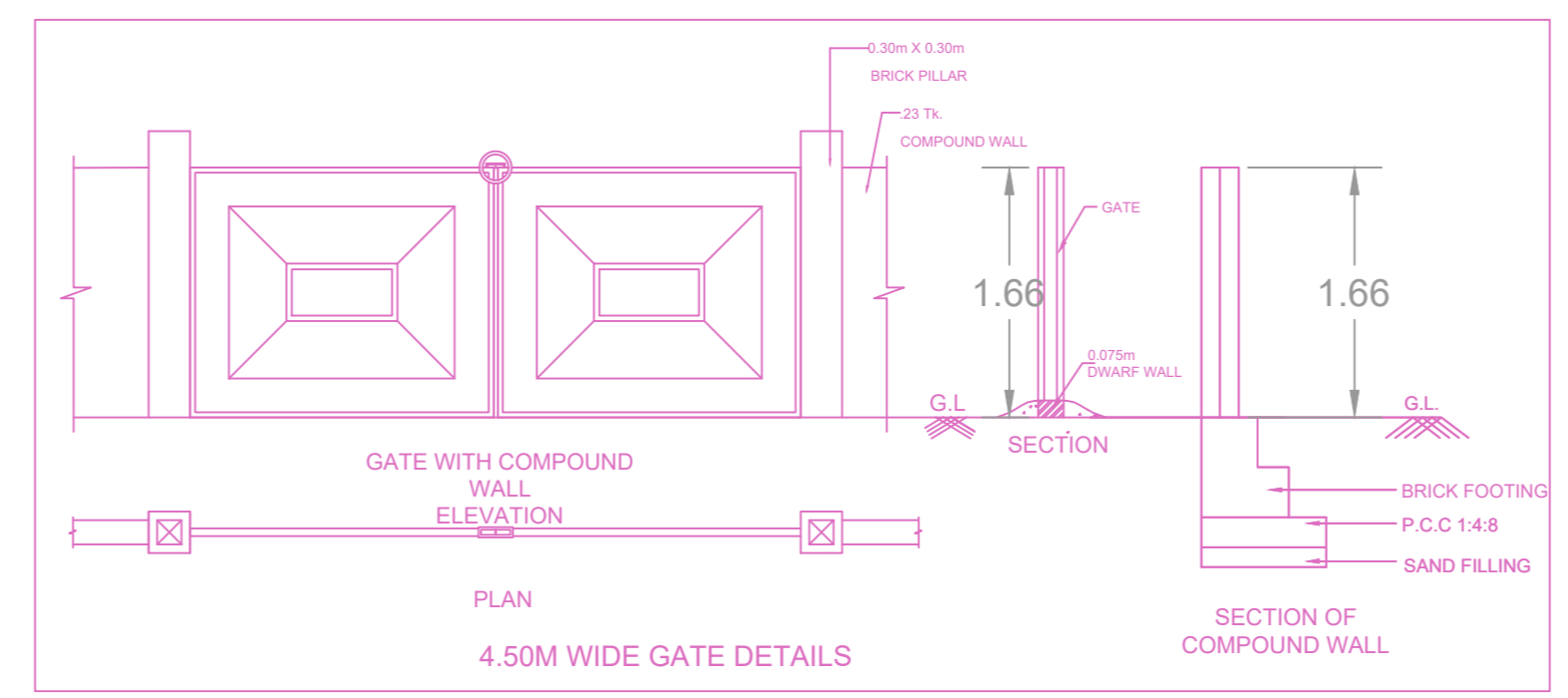

FLOOR WISE FSI STATEMENT: A (RESIDENTIAL)

FLOORS	FSI AREA				DU	TOTAL FSI AREA
	COMM.	RESI.	IND.	SPEC.		
Terrace	0.00	0.00	0.00	0.00	0	0.00
THIRD FLOOR	0.00	240.59	0.00	0.00	3	240.59
SECOND FLOOR	0.00	274.01	0.00	0.00	3	274.01
FIRST FLOOR	0.00	274.01	0.00	0.00	3	274.01
STILT PARKING FLOOR	0.00	0.00	0.00	0.00	0	0.00
Total	0.00	788.61	0.00	0.00	9	788.61

BUILDING WISE FSI STATEMENT

BUILDING	NO OF SAME BUILDING	FSI AREA				DU	TOTAL FSI AREA
		COMM.	RESI.	IND.	SPEC.		
A-1 (RESIDE...)		0.00	788.61	0.00	0.00	9	788.61
Total		0.00	788.61	0.00	0.00	9	788.61

APPROVAL CONDITION

APPROVAL CONDITION

SCALE 1:100

CHENNAI METROPOLITAN DEVELOPMENT AUTHORITY
APPROVED
SUBJECT TO THE CONDITIONS MENTIONED IN THIS OFFICE

For (Deputy Planner / Chief Planner / Member-Secretary)
High Rise Building / Non High Rise Building
This Approval is valid only after building Permit is issued by the concerned Local Body.

KEY NO. 3688

QR CODE