

ELEVATION

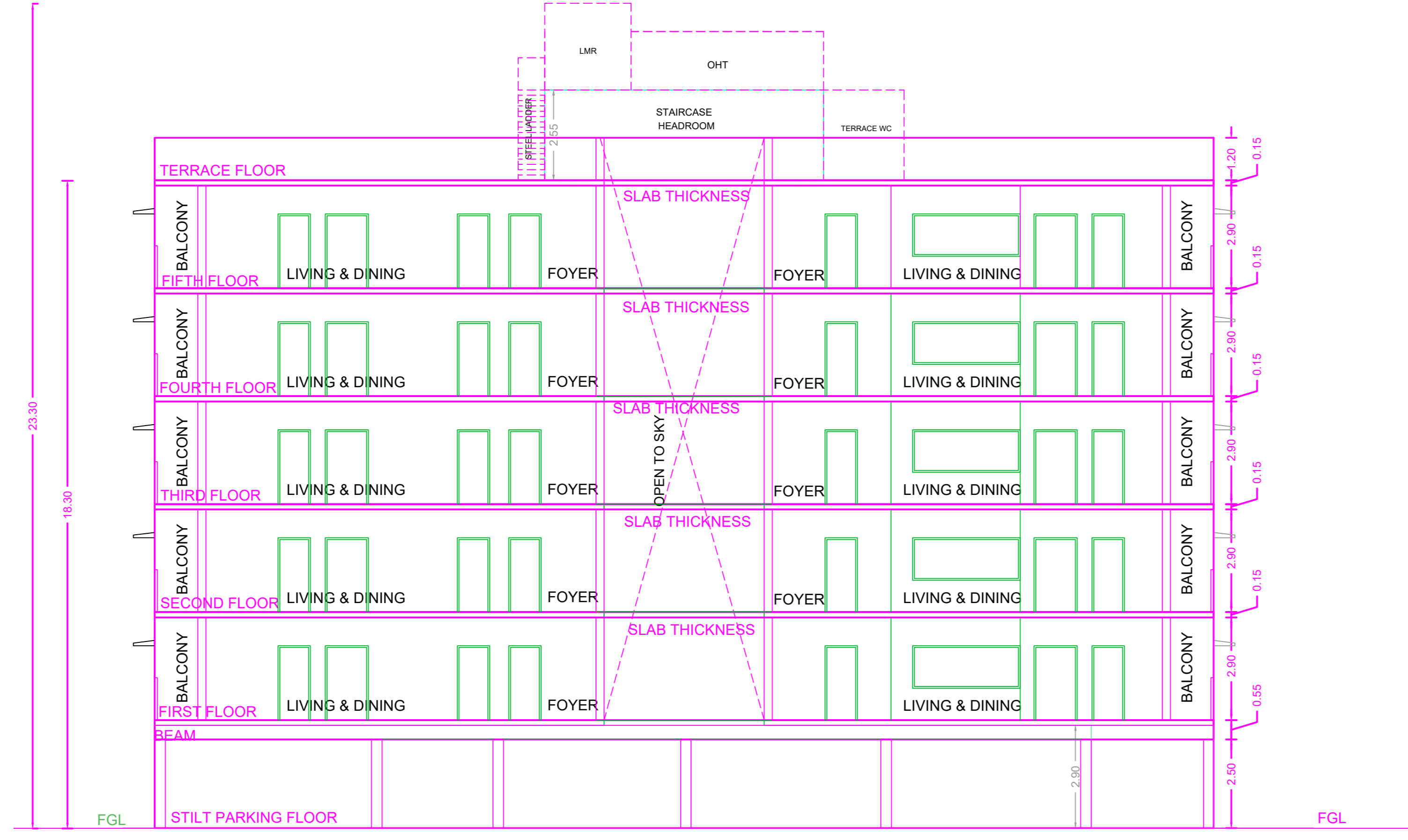

SECTION A-A

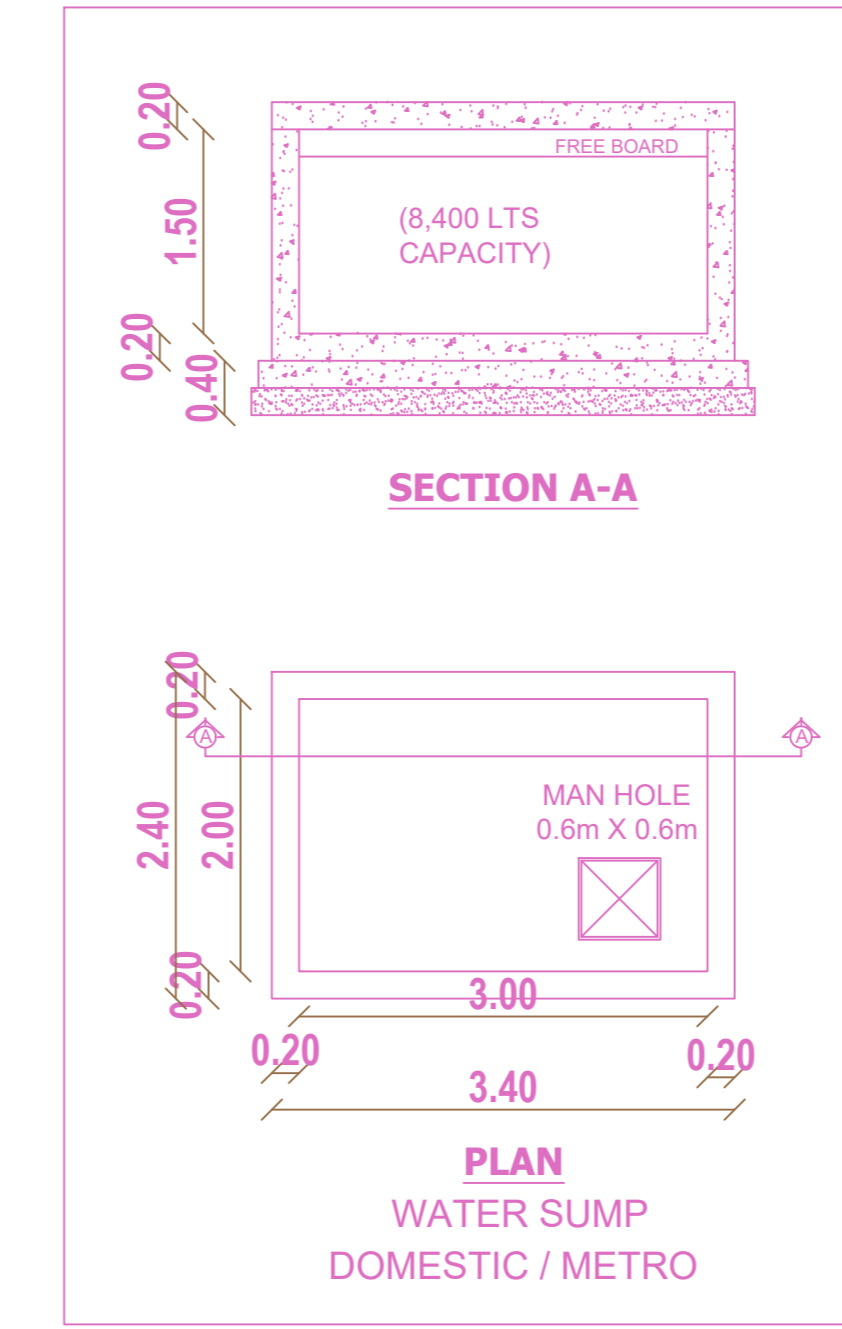

PLAN WATER SUMP DOMESTIC / METRO

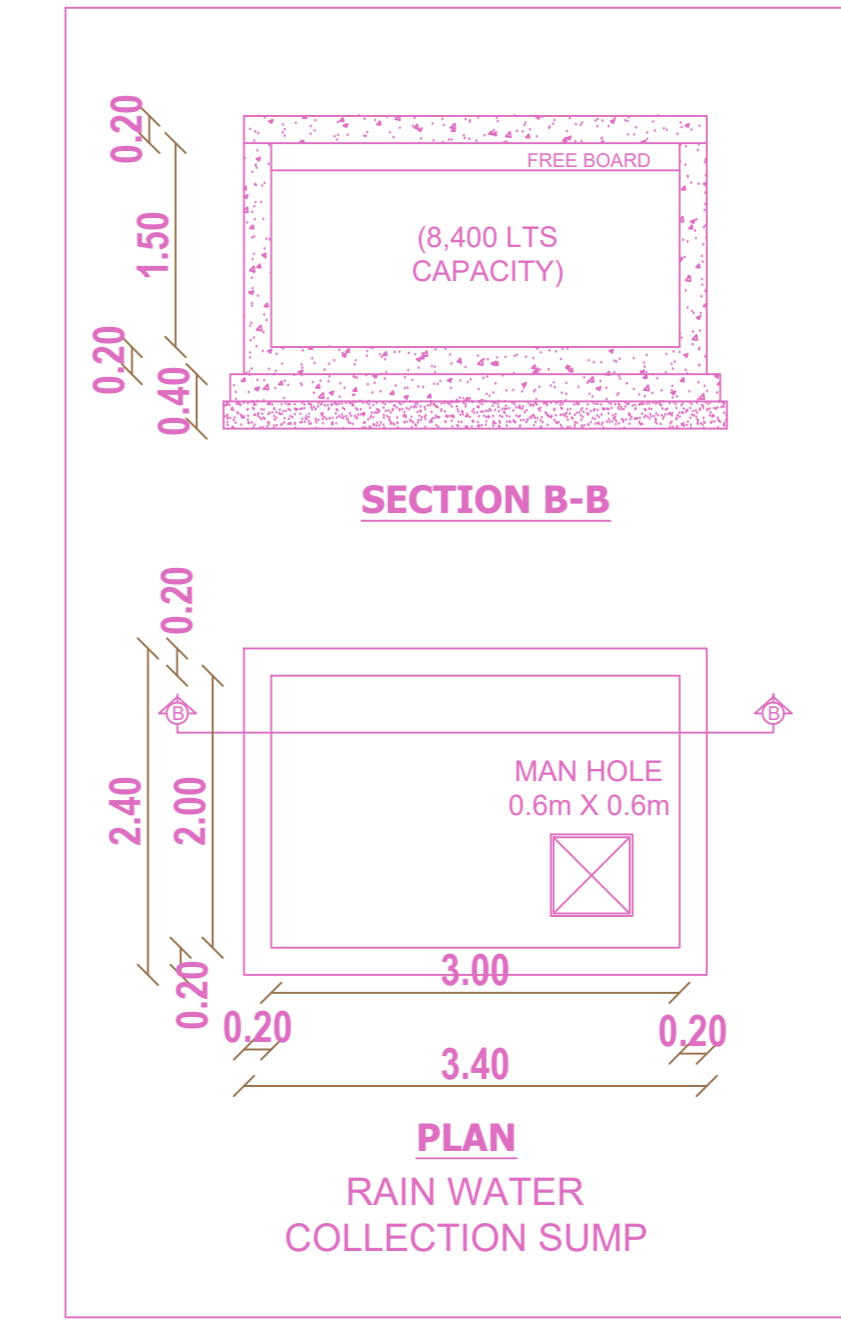

PLAN RAIN WATER COLLECTION SUMP

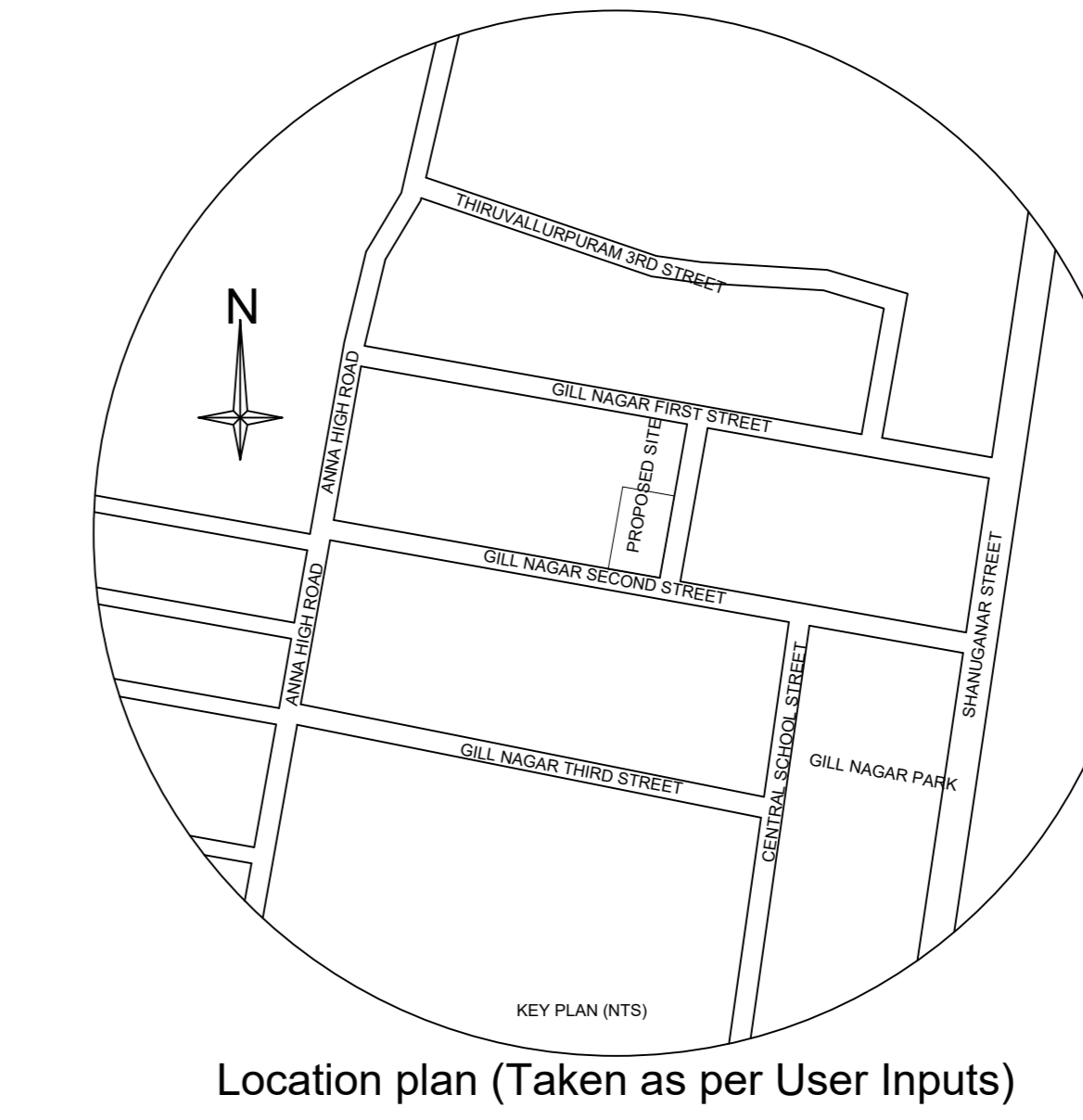

Location plan (Taken as per User Inputs)

PLAN SHOWING THE PROPOSED CONSTRUCTION OF STILT FLOOR + 5 FLOORS RESIDENTIAL BUILDING WITH 10 DWELLING UNITS (HEIGHT-18.30M) AVAILING PREMIUM FSI AT PLOT NO.47, DOOR NO.1(47A) & 16(47), GILL NAGAR 1ST CROSS STREET & GILL NAGAR 2ND STREET, GILL NAGAR, CHOOLAMEDU, CHENNAI COMPRISED IN T.S.NOS 44/13 & 44/14, BLOCK NO.13 OF PULIYUR VILLAGE WITHIN THE LIMITS OF GREATER CHENNAI CORPORATION, ZONE - IX, DIVISION- 109.

A) AREA STATEMENT		SQ.M.
AREA AS PER PATTA		667.50
AREA AS PER DOCUMENT		671.50
AREA CONSIDERED FOR FSI		667.50
STREET ALIGNMENT/ ROAD WIDENING/LINK ROAD		0.00
OSR AREA		0.00
TOTAL FSI AREA		1726.67
FSI FACTOR		2.587
COVERAGE AREA (PERCENTAGE %)		NA

A) PARKING STATEMENT		
VEHICLE	REQUIRED	PROVIDED
LORRY	0	0
CAR	22	22
TWO WHEELER	0	0
CYCLE	0	0

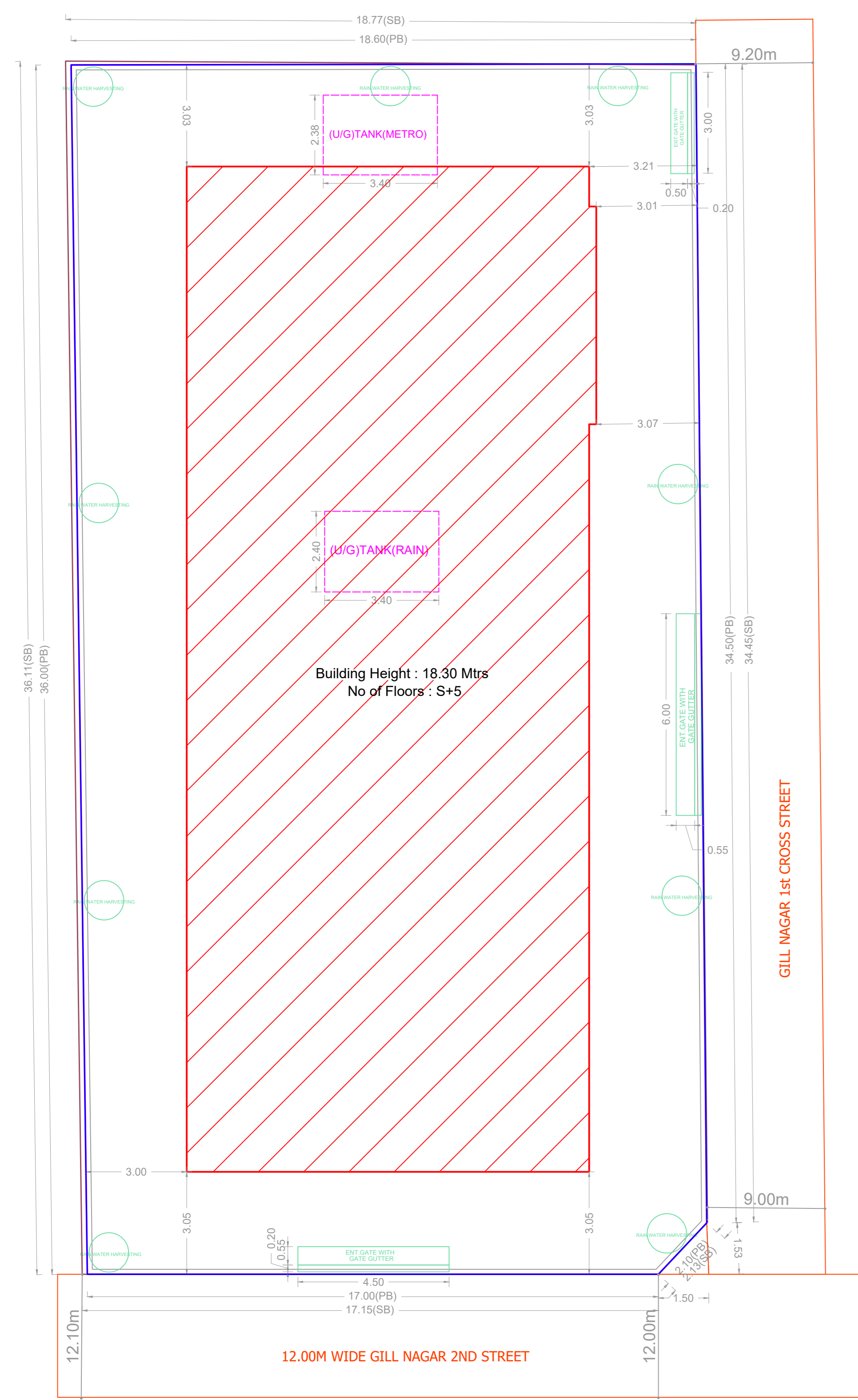

SITE PLAN

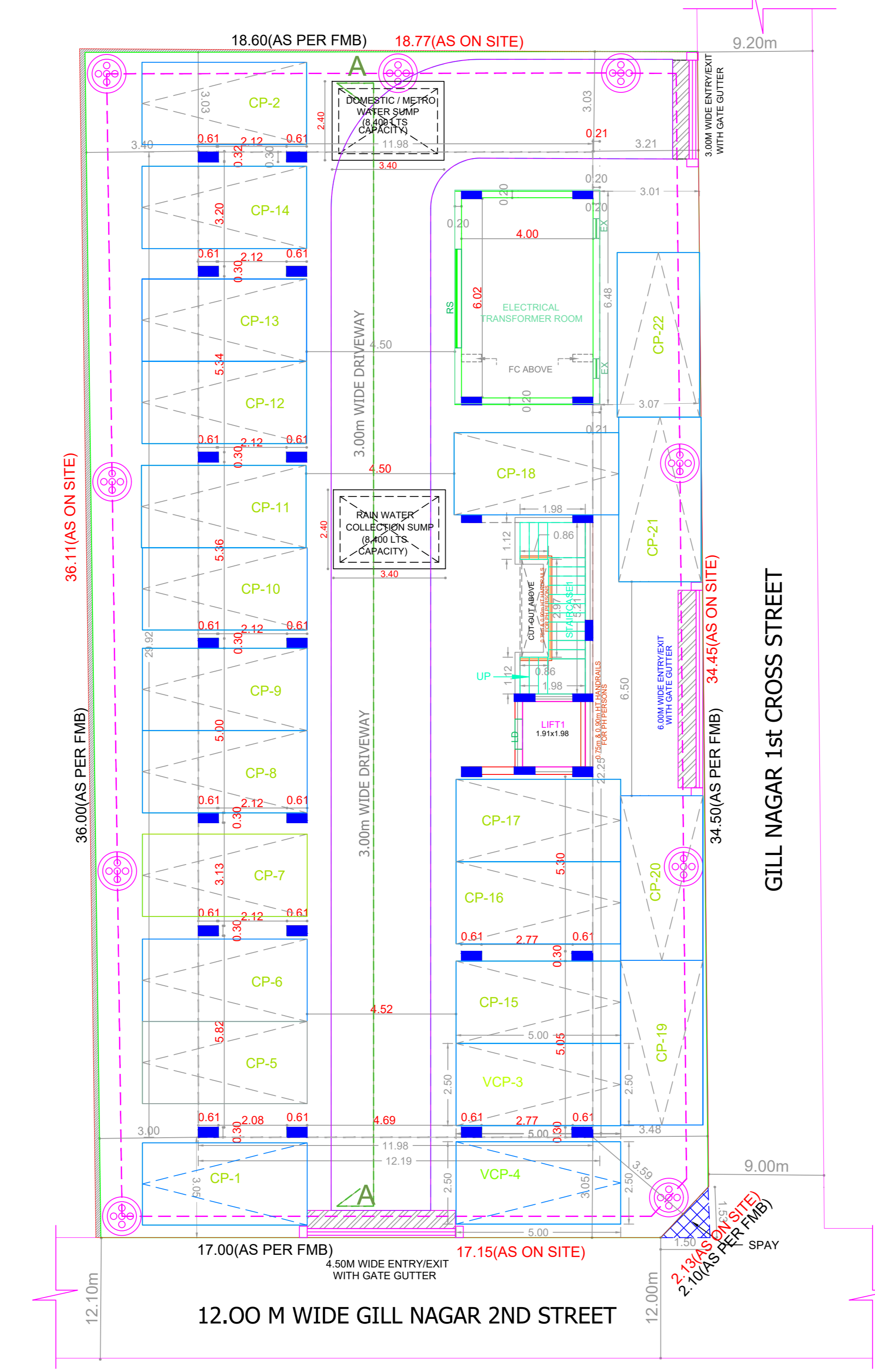

SITE/STILT PARKING FLOOR PLAN

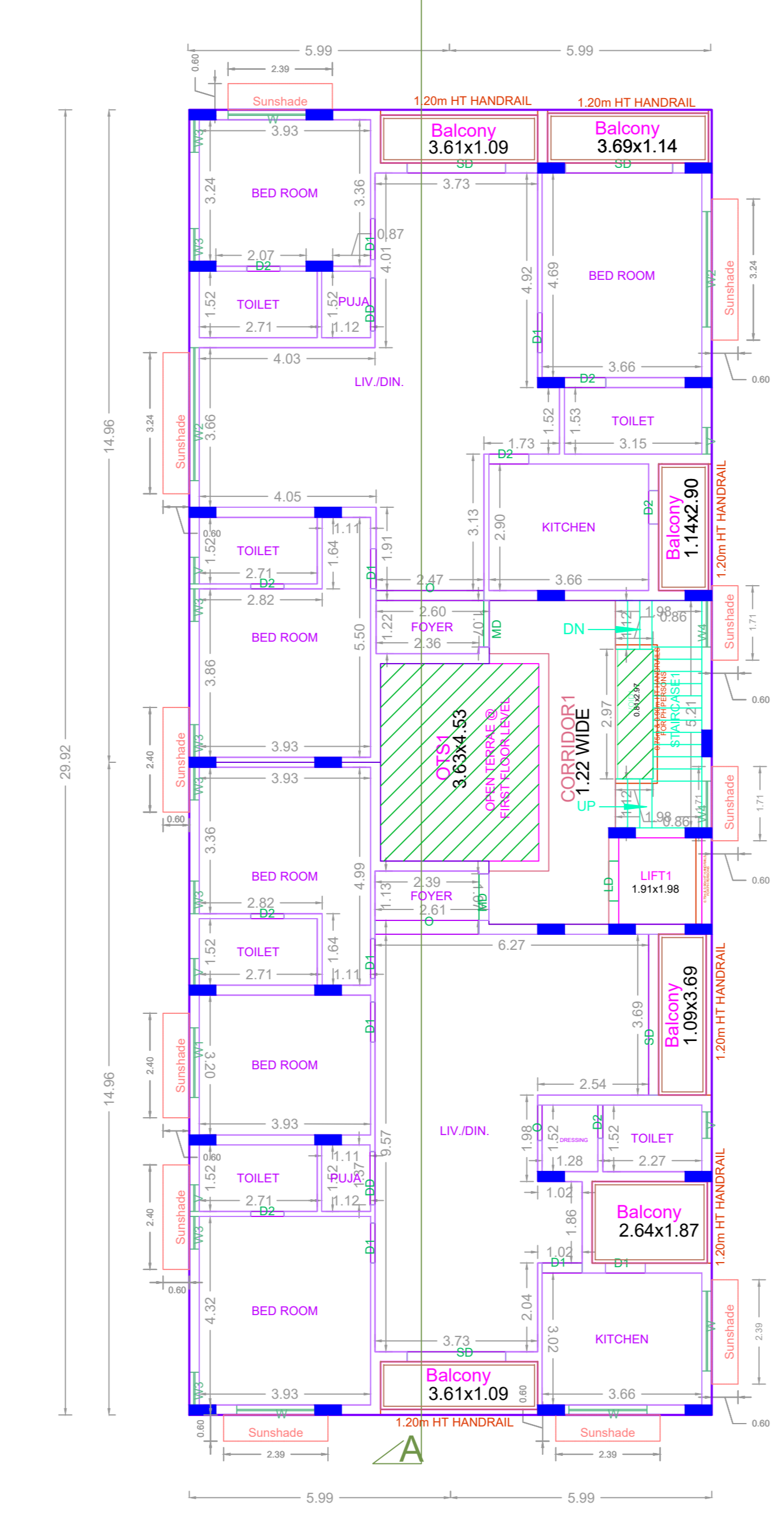

TYPICAL FLOOR PLAN (1ST, 2ND, 3RD, 4TH & 5TH FLOOR PLAN)

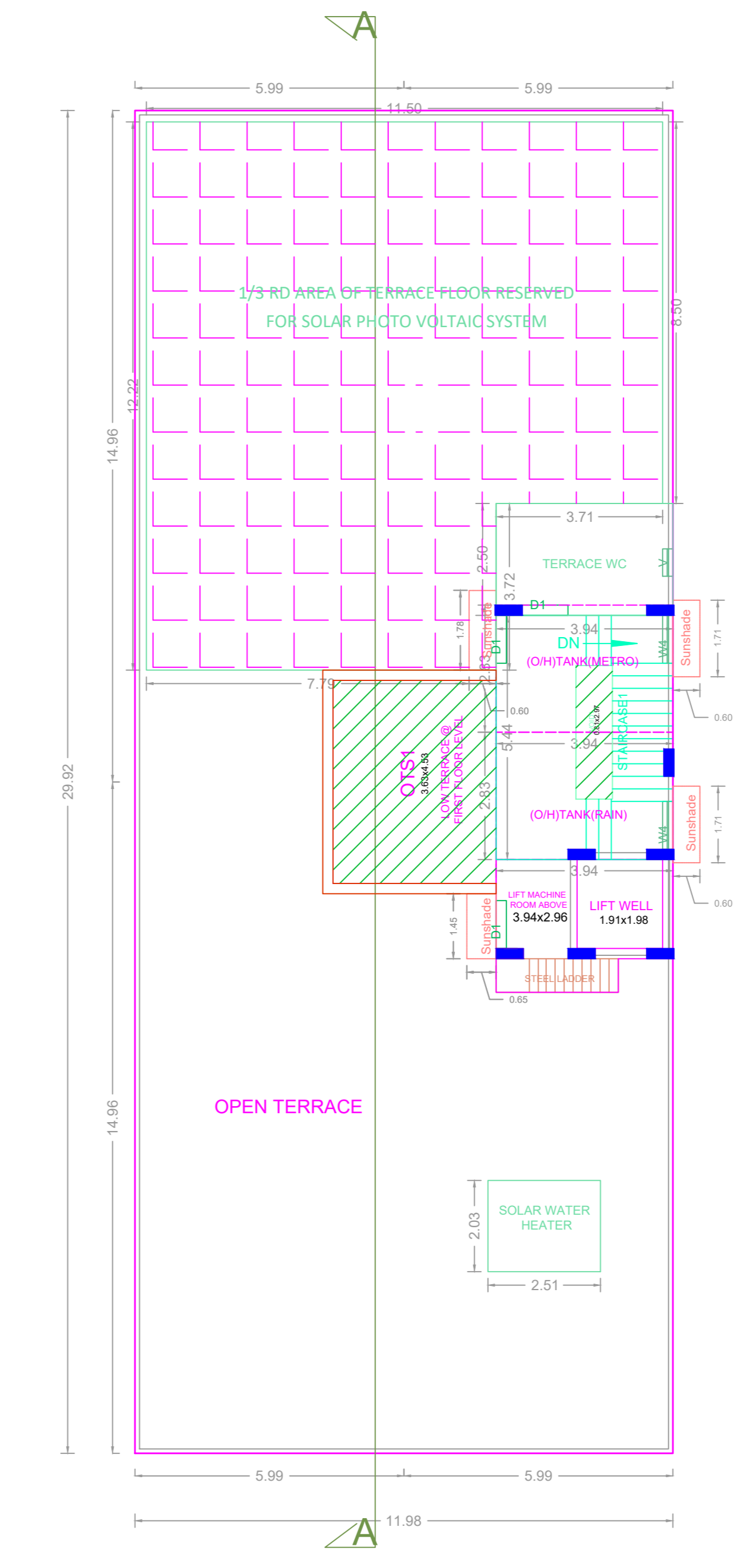

TERRACE FLOOR PLAN

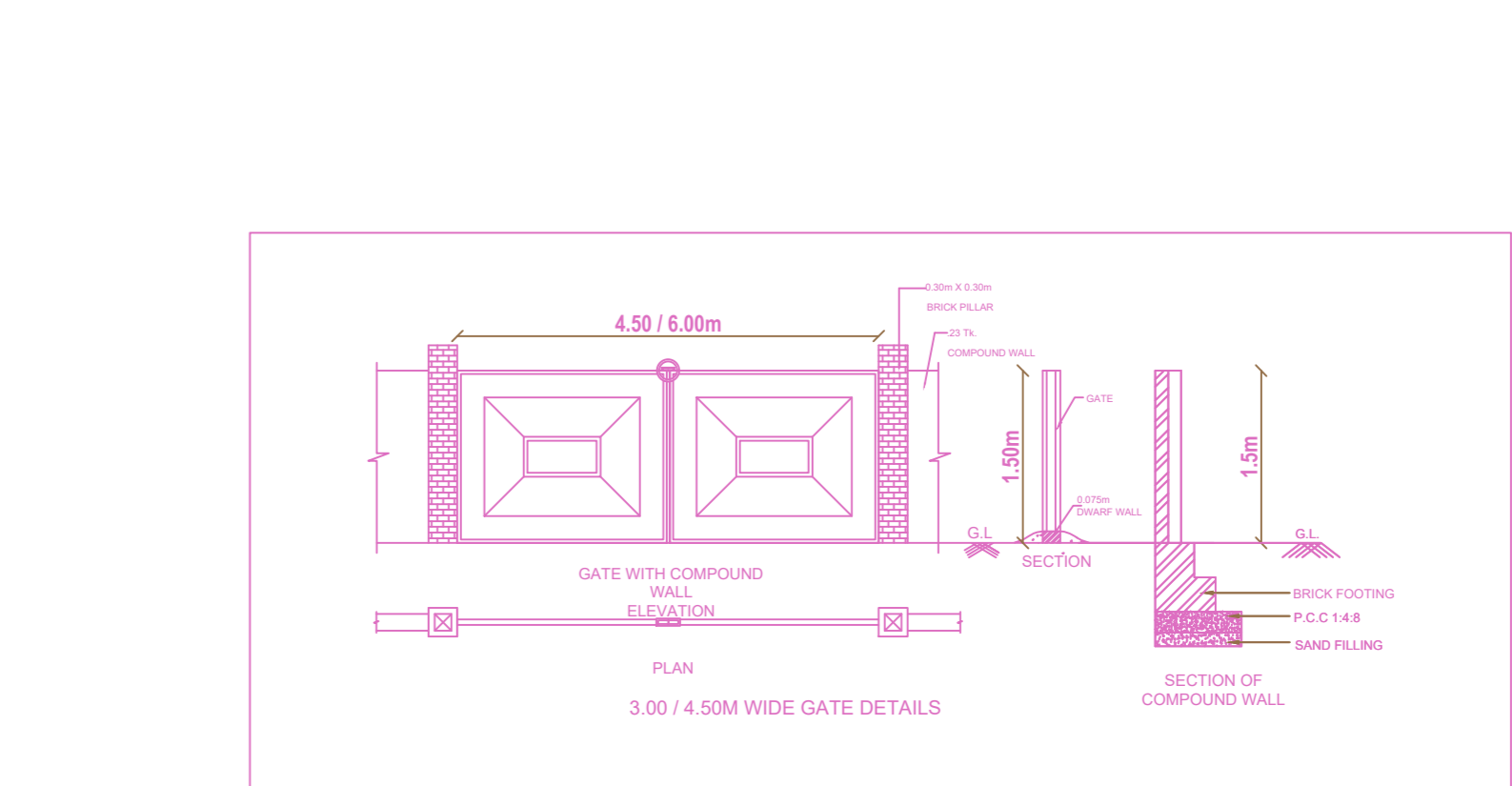

3.00M WIDE GATE DETAILS

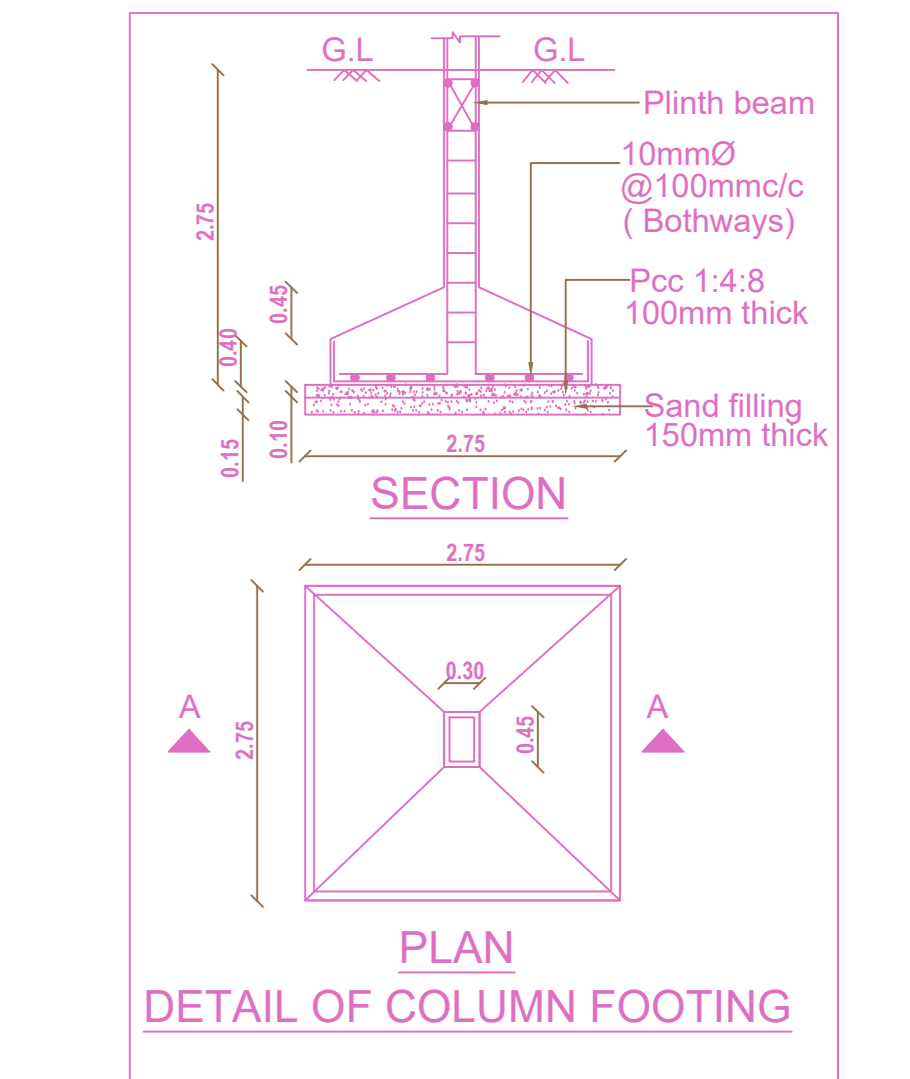

DETAIL OF COLUMN FOOTING

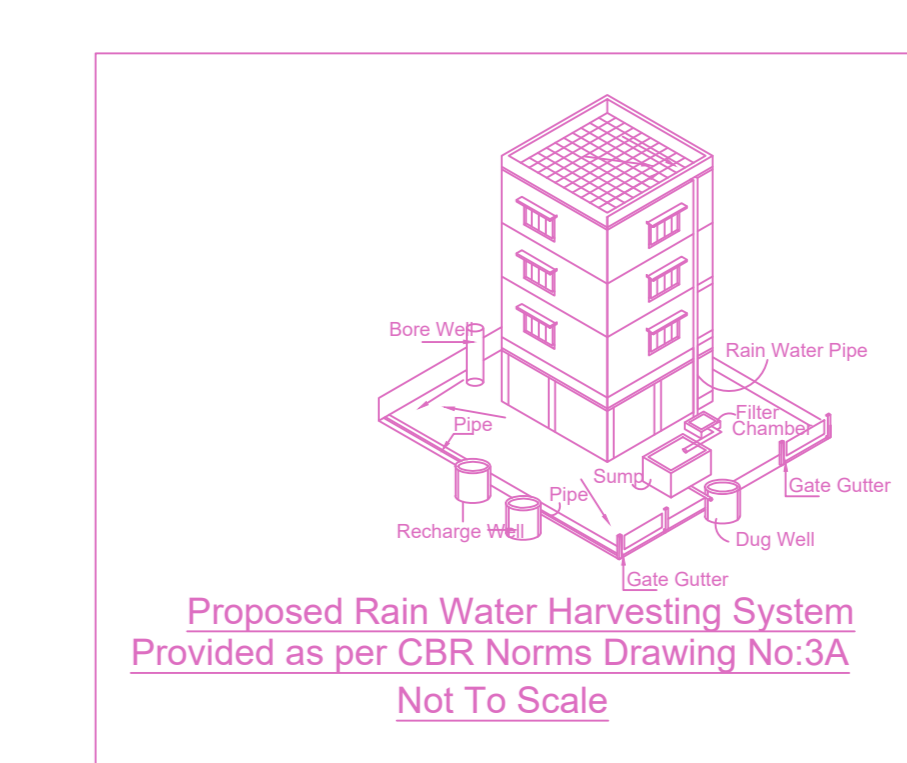

Proposed Rain Water Harvesting System Provided as per CBR Norms Drawing No.3A Not To Scale

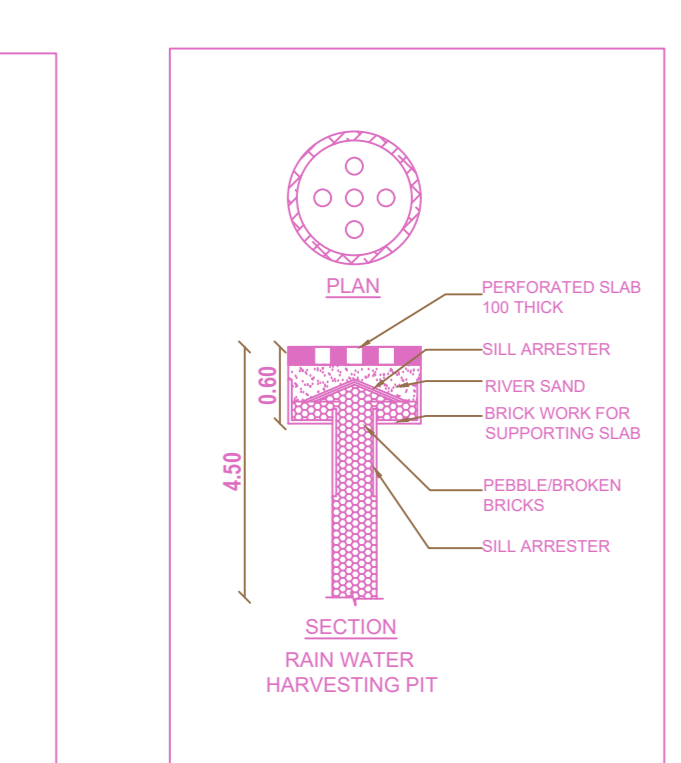

RAIN WATER HARVESTING PIT

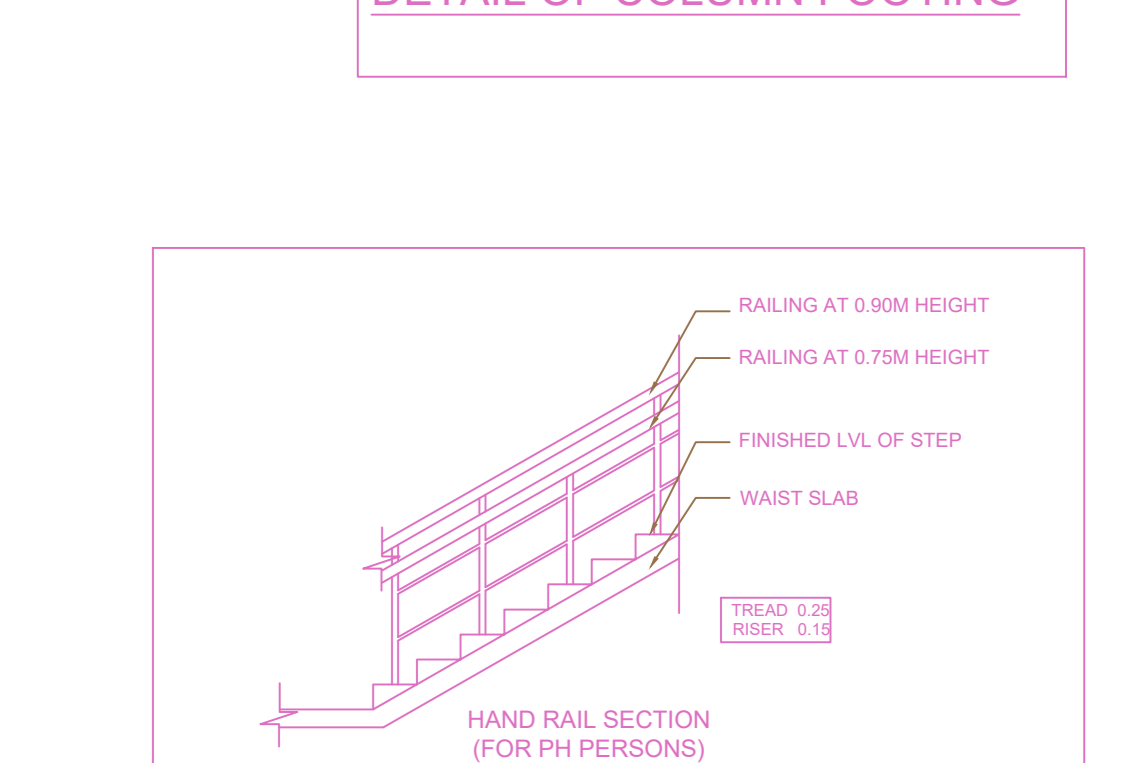

HAND RAIL SECTION (FOR PVA PORTLAND)

BUILDING WISE FSI STATEMENT

BUILDING	NO OF SAME BUILDING	FSI AREA				DU	TOTAL FSI AREA
		COMM.	RESI.	IND.	INST.		
A-1 (RESIDE...)		0.00	1726.67	0.00	0.00	10	1726.67
Total		0.00	1726.67	0.00	0.00	10	1726.67

FLOOR WISE FSI STATEMENT: A (RESIDENTIAL)

FLOORS	FSI AREA				DU	TOTAL FSI AREA
	COMM.	RESI.	IND.	INST.		
STILT PARKING FLOOR	0.00	28.52	0.00	0.00	0	28.52
FIRST FLOOR	0.00	339.63	0.00	0.00	2	339.63
SECOND FLOOR	0.00	339.63	0.00	0.00	2	339.63
THIRD FLOOR	0.00	339.63	0.00	0.00	2	339.63
FOURTH FLOOR	0.00	339.63	0.00	0.00	2	339.63
FIFTH FLOOR	0.00	339.63	0.00	0.00	2	339.63
Terrace	0.00	0.00	0.00	0.00	0	0.00
Total	0.00	1726.67	0.00	0.00	10	1726.67

APPROVAL CONDITION

SCALE: 1:100

CHENNAI METROPOLITAN DEVELOPMENT AUTHORITY

APPROVED

SUBJECT TO THE CONDITIONS MENTIONED IN THIS OFFICE

For (Design Review / Check Review / Material Approval) High Rise Building / High Rise Building

The Approver is valid only after Building Permit is issued by the concerned Local Body.

GR CODE