

SITE PLAN

PLAN SHOWING THE PROPOSED CONSTRUCTION OF STILT FLOOR + 4 FLOORS SHOPPING COMPLEX AT POONAMALLEE HIGH ROAD, GOPARASANALLUR, CHENNAI COMPRISED IN S.NO.102/1B, 103/1B & 103/1C OF GOPARASANALLUR VILLAGE WITHIN THE LIMITS OF POONAMALLEE PANCHAYAT UNION.

A) AREA STATEMENT	SQM.
AREA AS PER PATTA	1600.00
AREA AS PER DOCUMENT	1578.26
AREA CONSIDERED FOR FSI	1578.26
STREET ALIGNMENT/ ROAD WIDENING LINK ROAD	0.00
OSR AREA	0.00
TOTAL FSI AREA	2624.26
FSI FACTOR	1.663
COVERAGE AREA (PERCENTAGE %)	NA

A) PARKING STATEMENT		
VEHICLE	REQUIRED	PROVIDED
LORRY	0	0
CAR	26	26
TWO WHEELER	26	26
CYCLE	0	0

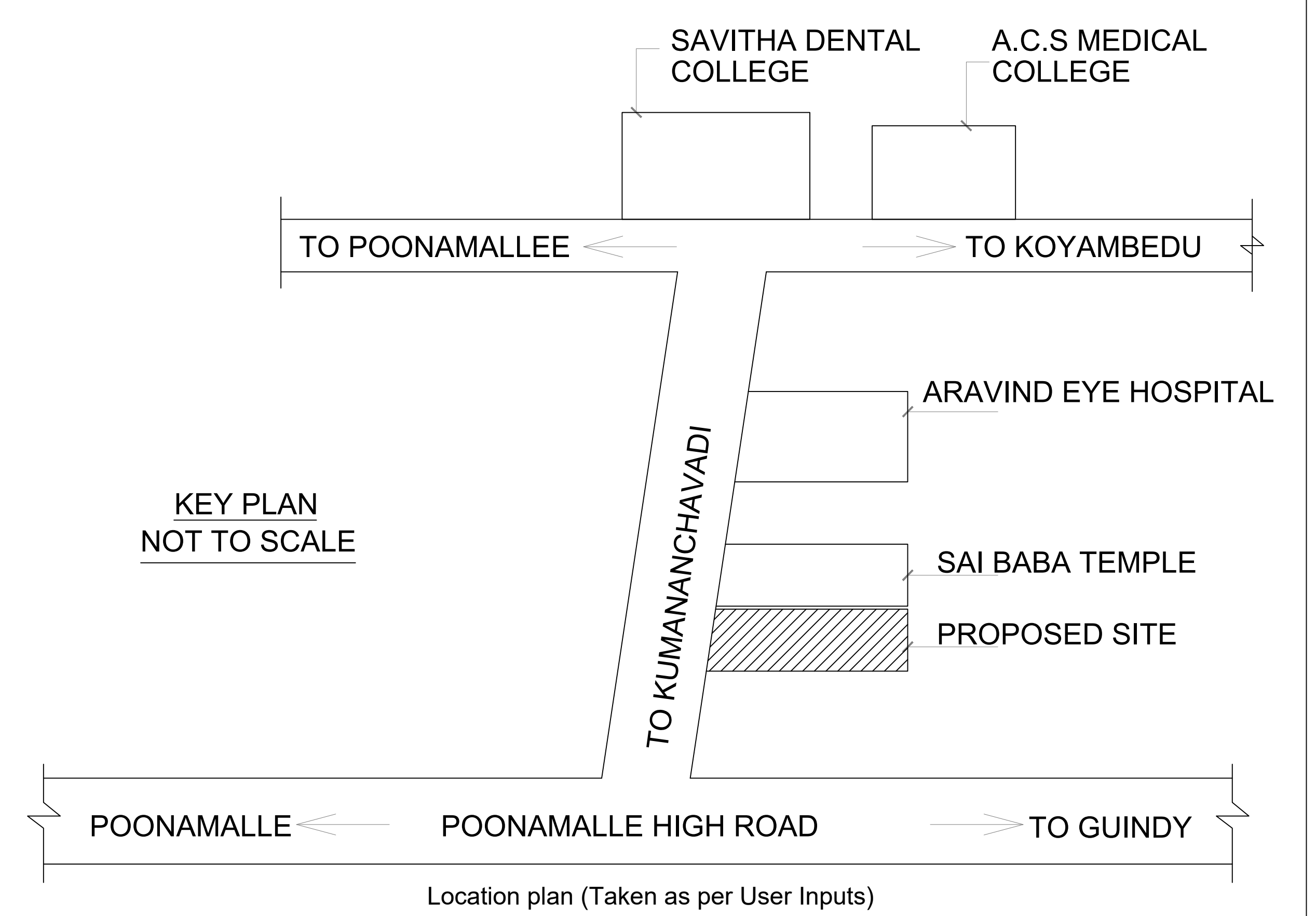
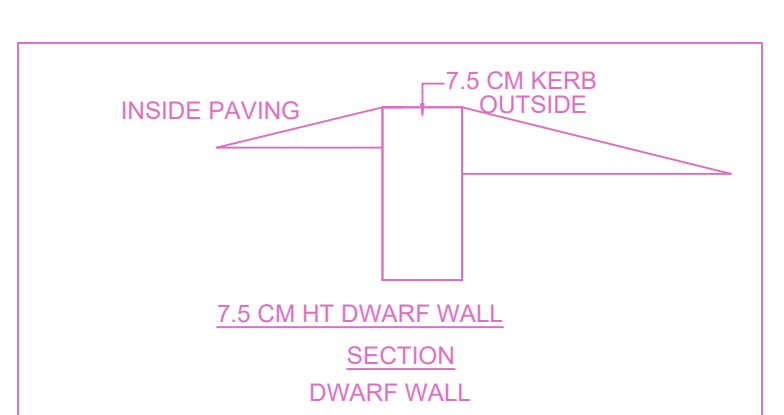
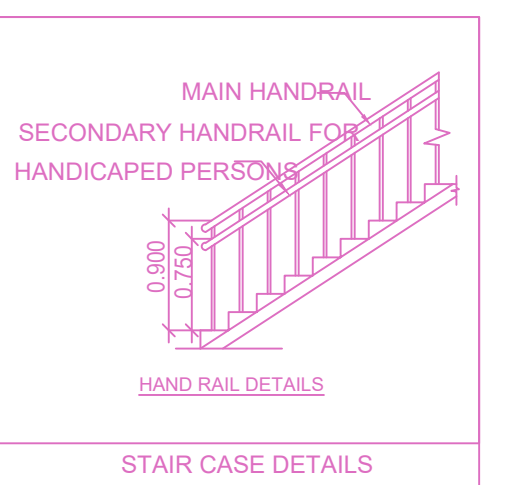
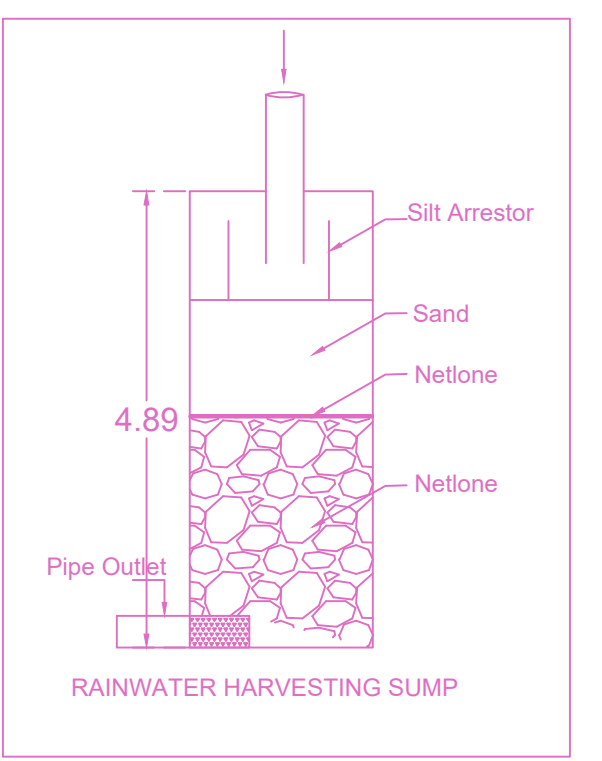
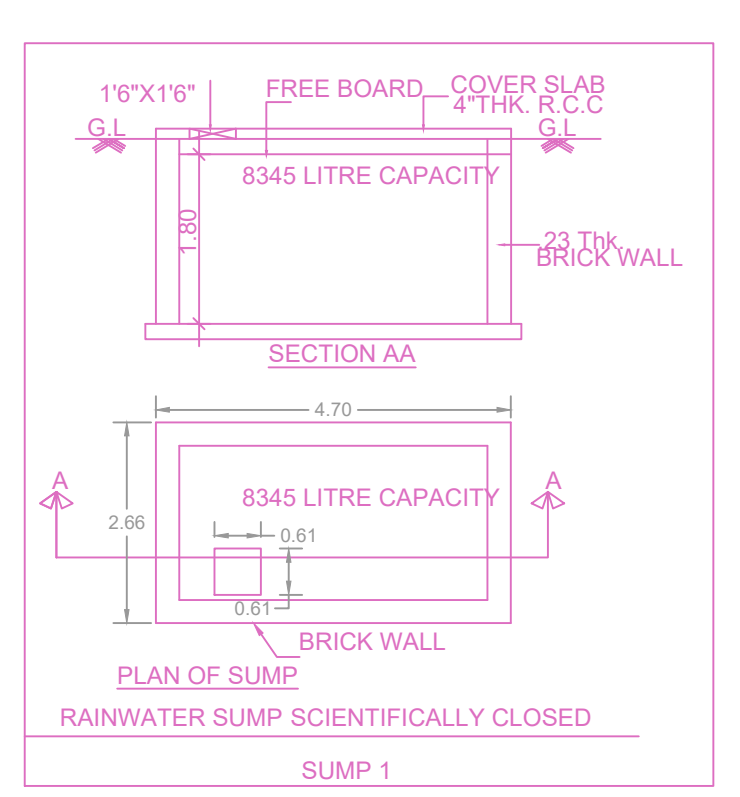
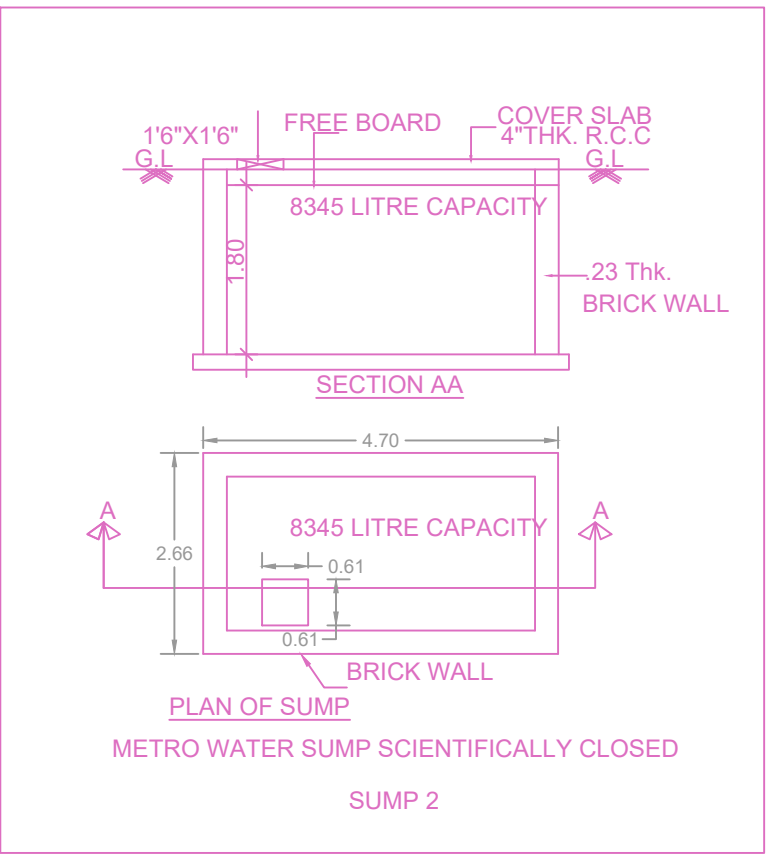
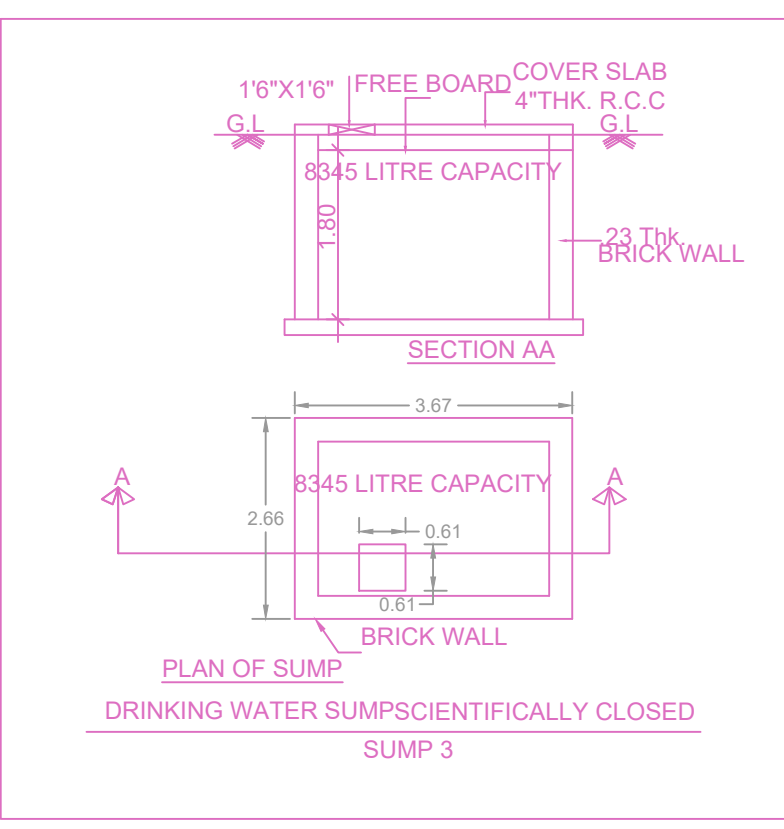
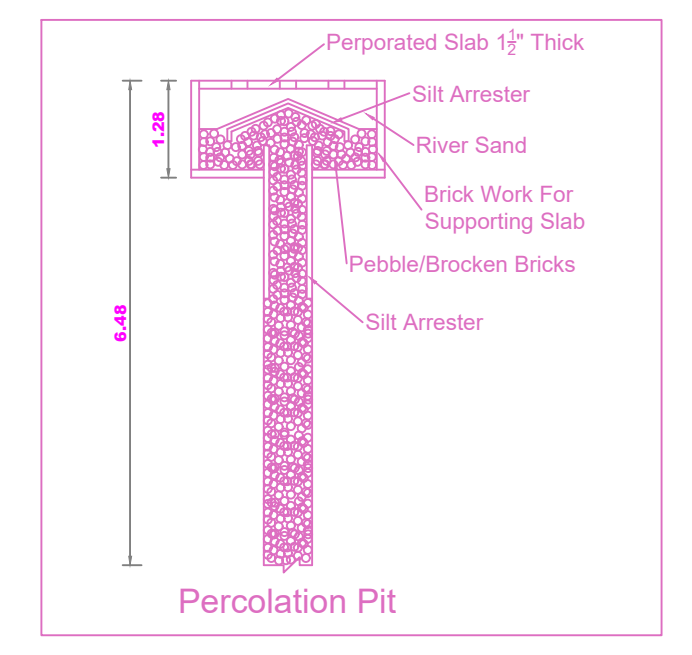
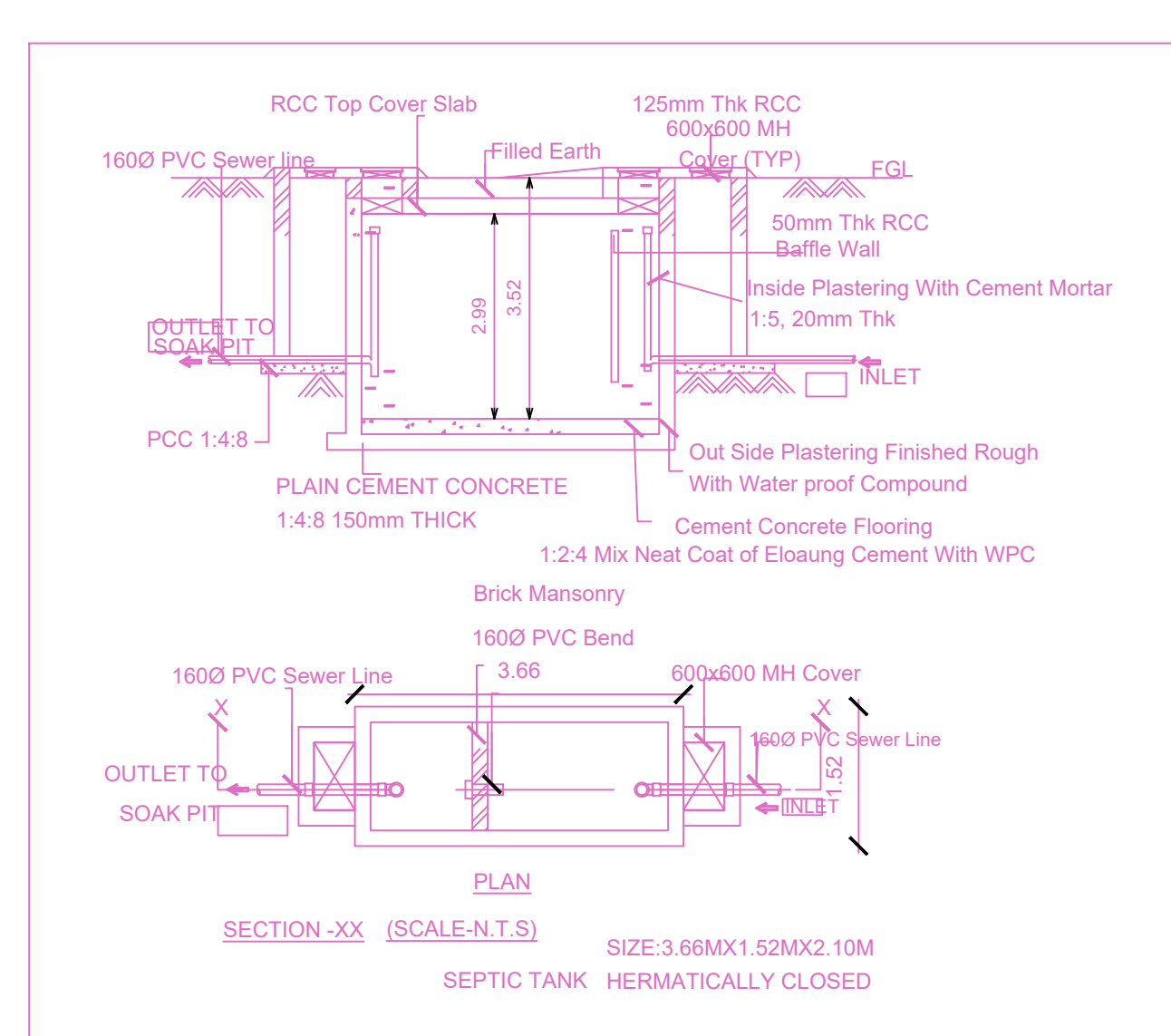
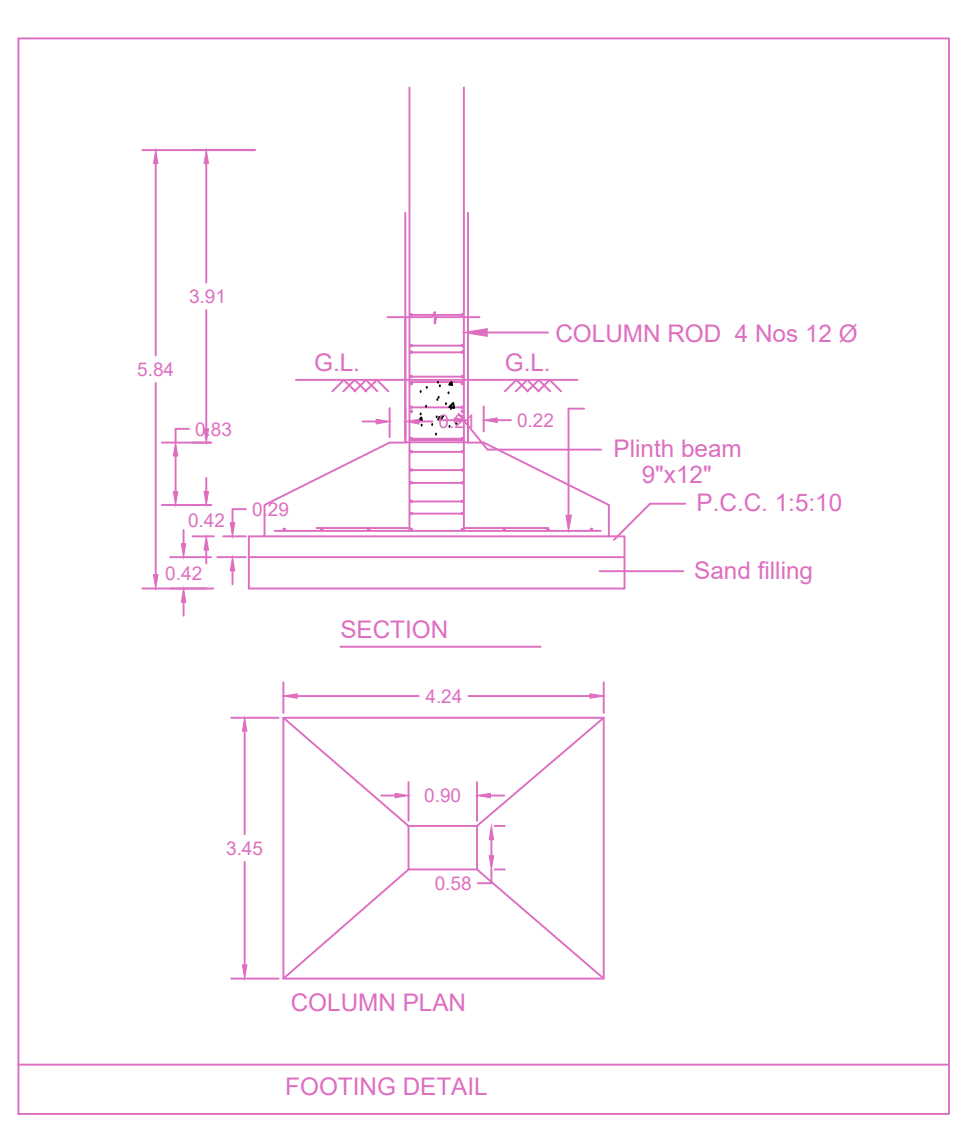
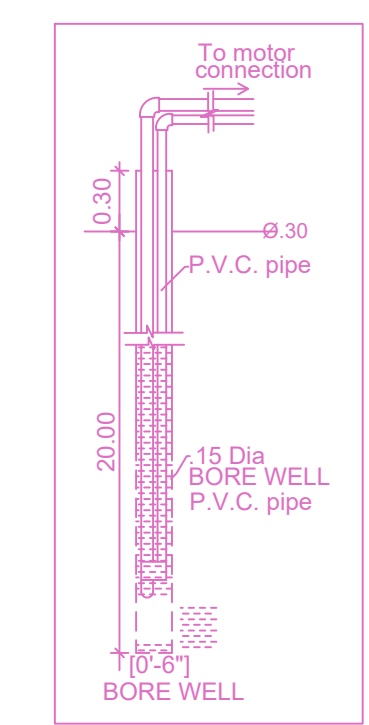
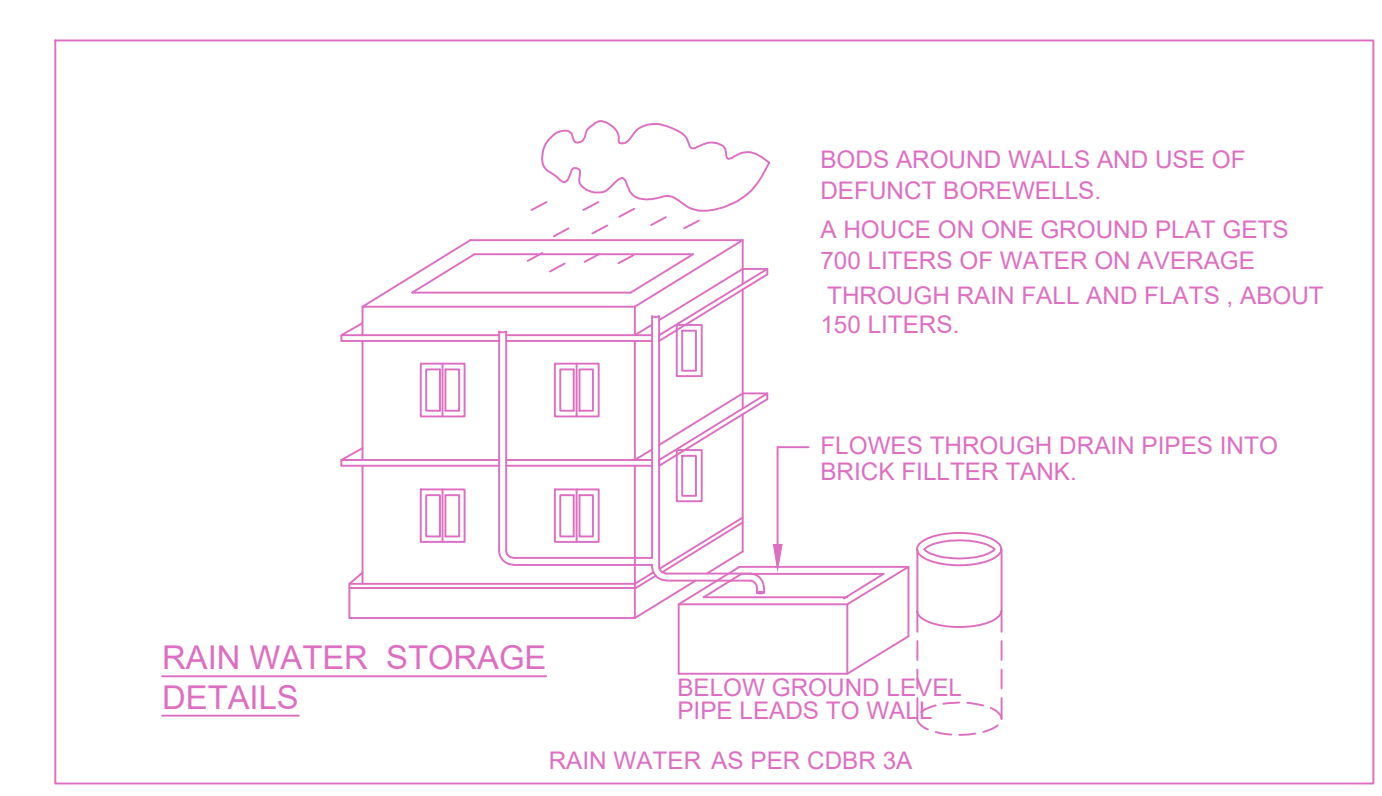
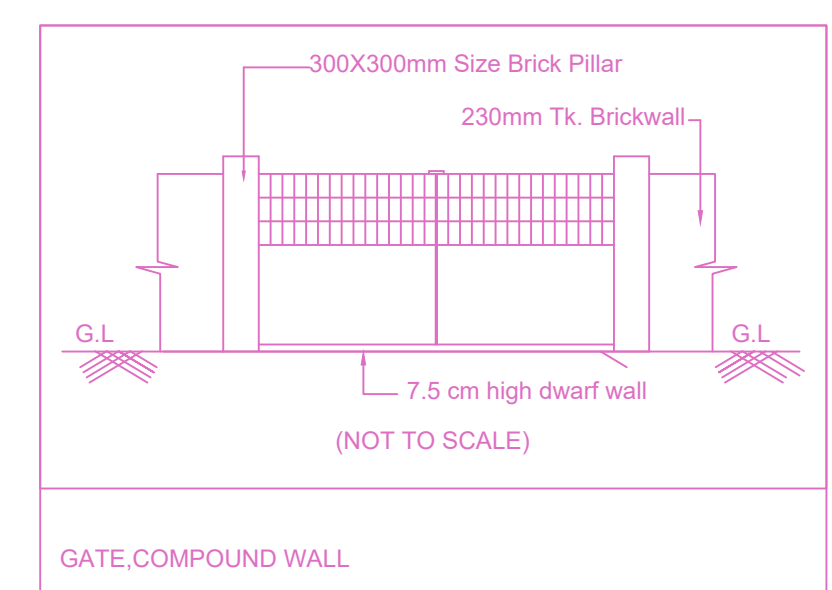
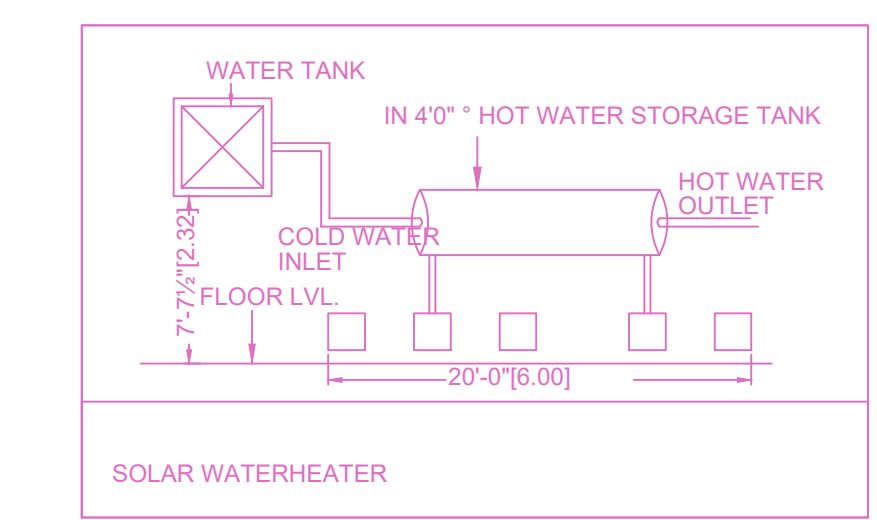
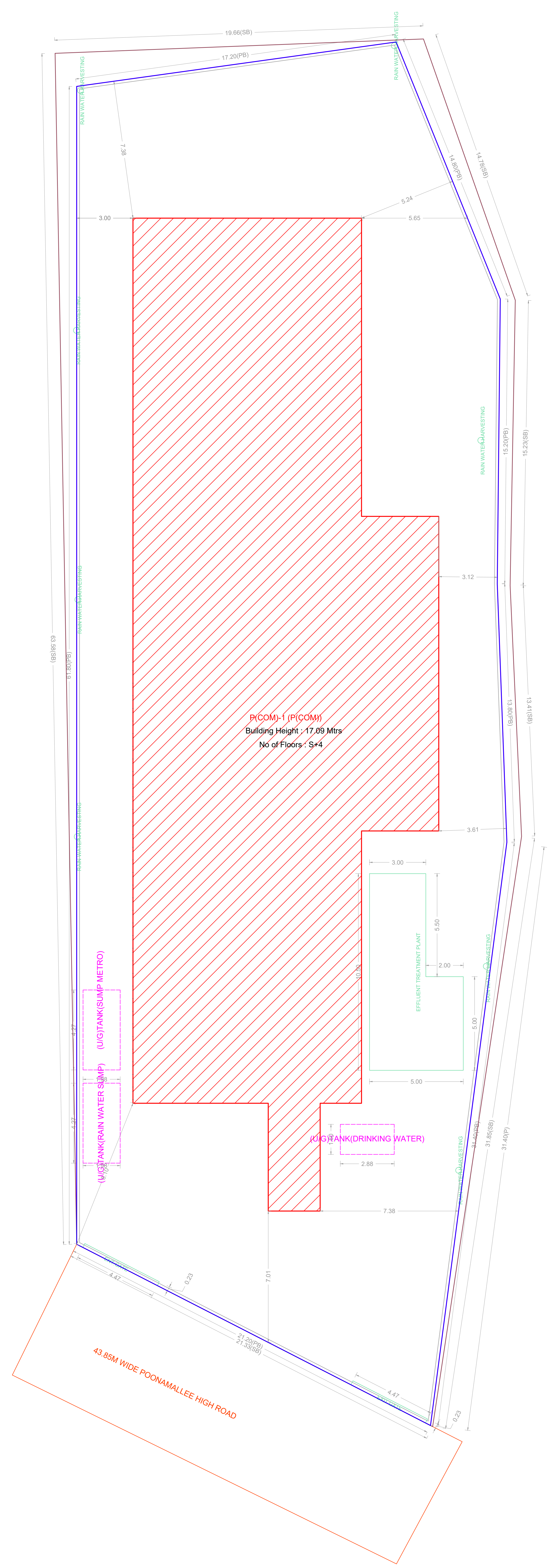

FLOOR WISE FSI STATEMENT: P(COM) (P(COM))

FLOORS	FSI AREA				DU	TOTAL FSI AREA
	COMM.	RESI.	IND.	SPEC.		
Terrace	0.00	0.00	0.00	0.00	0	0.00
FOURTH FLOOR	645.07	0.00	0.00	0.00	0	645.07
THIRD FLOOR	645.07	0.00	0.00	0.00	0	645.07
SECOND FLOOR	645.07	0.00	0.00	0.00	0	645.07
FIRST FLOOR	645.07	0.00	0.00	0.00	0	645.07
STILT PARKING FLOOR	43.98	0.00	0.00	0.00	0	43.98
Total	2624.26	0.00	0.00	0.00	0	2624.26

BUILDING WISE FSI STATEMENT

BUILDING	NO OF SAME BUILDINGS	FSI AREA				DU	TOTAL FSI AREA
		COMM.	RESI.	IND.	SPEC.		
P(COM)-1 (P...)	1	2624.26	0.00	0.00	0.00	0	2624.26
Total	1	2624.26	0.00	0.00	0.00	0	2624.26

APPROVAL CONDITION

SCALE: 1:100

CHENNAI METROPOLITAN DEVELOPMENT AUTHORITY

APPROVED

SUBJECT TO THE CONDITIONS MENTIONED IN THIS OFFICE

For (Client/Planner / Chief Planner / Member Secretary)
High Rise Building / Non High Rise Building
This Approval is valid only after building Permit is issued by the concerned Local Body.

KEY NO. 0788

QR CODE

