

KEY PLAN (NTS)  
[ONLY AS REFERENCE]  
Location plan (Taken as per User Inputs)

PLAN SHOWING THE PROPOSED ADDITIONAL CONSTRUCTION OF STILT + 3 FLOORS AND 4TH FLOOR PART SHOP CUM OFFICE BUILDING - COMMERCIAL BUILDING (1ST FLOOR-SHOP, 2ND, 3RD AND 4TH FLOOR PART-OFFICE) (HEIGHT-15.65M) AT DOOR NO.843, ANNA SALAI, CHENNAI COMPRISED IN R.S.NO.3226, BLOCK NO.64 OF TRIPPLICANE VILLAGE WITHIN THE LIMIT OF GREATER CHENNAI CORPORATION

| AREA STATEMENT                            | SQ.M.  |
|---|--------|
| AREA AS PER PATTI                         | 537.00 |
| AREA AS PER DOCUMENT                      | 536.97 |
| AREA CONSIDERED FOR FSI                   | 536.97 |
| STREET ALIGNMENT/ ROAD WIDENING/LINK ROAD | 0.00   |
| OSR AREA                                  | 0.00   |
| TOTAL FSI AREA                            | 805.40 |
| FSI FACTOR                                | 1.50   |
| COVERAGE AREA (PERCENTAGE %)              | N/A    |

| A) PARKING STATEMENT |          |          |
|----------------------|----------|----------|
| VEHICLE              | REQUIRED | PROVIDED |
| LORRY                | 0        | 0        |
| CAR                  | 6        | 7        |
| TWO WHEELER          | 23       | 24       |
| CYCLE                | 0        | 0        |

BUILDING WISE FSI STATEMENT

| BUILDING    | NO OF SAME BUILDING | FSI AREA |       |      |       | DU | TOTAL FSI AREA |
|-------------|---------------------|----------|-------|------|-------|----|----------------|
|             |                     | COMM.    | RESI. | IND. | SPEC. |    |                |
| A-1 (KOLAM) |                     | 805.40   | 0.00  | 0.00 | 0.00  | 0  | 805.40         |
| Total       |                     | 805.40   | 0.00  | 0.00 | 0.00  | 0  | 805.40         |

FLOOR WISE FSI STATEMENT: A (KOLAM)

| FLOORS              | FSI AREA |       |      |       | DU | TOTAL FSI AREA |
|---------------------|----------|-------|------|-------|----|----------------|
|                     | COMM.    | RESI. | IND. | SPEC. |    |                |
| Terrace             | 0.00     | 0.00  | 0.00 | 0.00  | 0  | 0.00           |
| FOURTH FLOOR        | 163.01   | 0.00  | 0.00 | 0.00  | 0  | 163.01         |
| THIRD FLOOR         | 214.13   | 0.00  | 0.00 | 0.00  | 0  | 214.13         |
| SECOND FLOOR        | 214.13   | 0.00  | 0.00 | 0.00  | 0  | 214.13         |
| FIRST FLOOR         | 214.13   | 0.00  | 0.00 | 0.00  | 0  | 214.13         |
| STILT PARKING FLOOR | 0.00     | 0.00  | 0.00 | 0.00  | 0  | 0.00           |
| Total               | 805.40   | 0.00  | 0.00 | 0.00  | 0  | 805.40         |

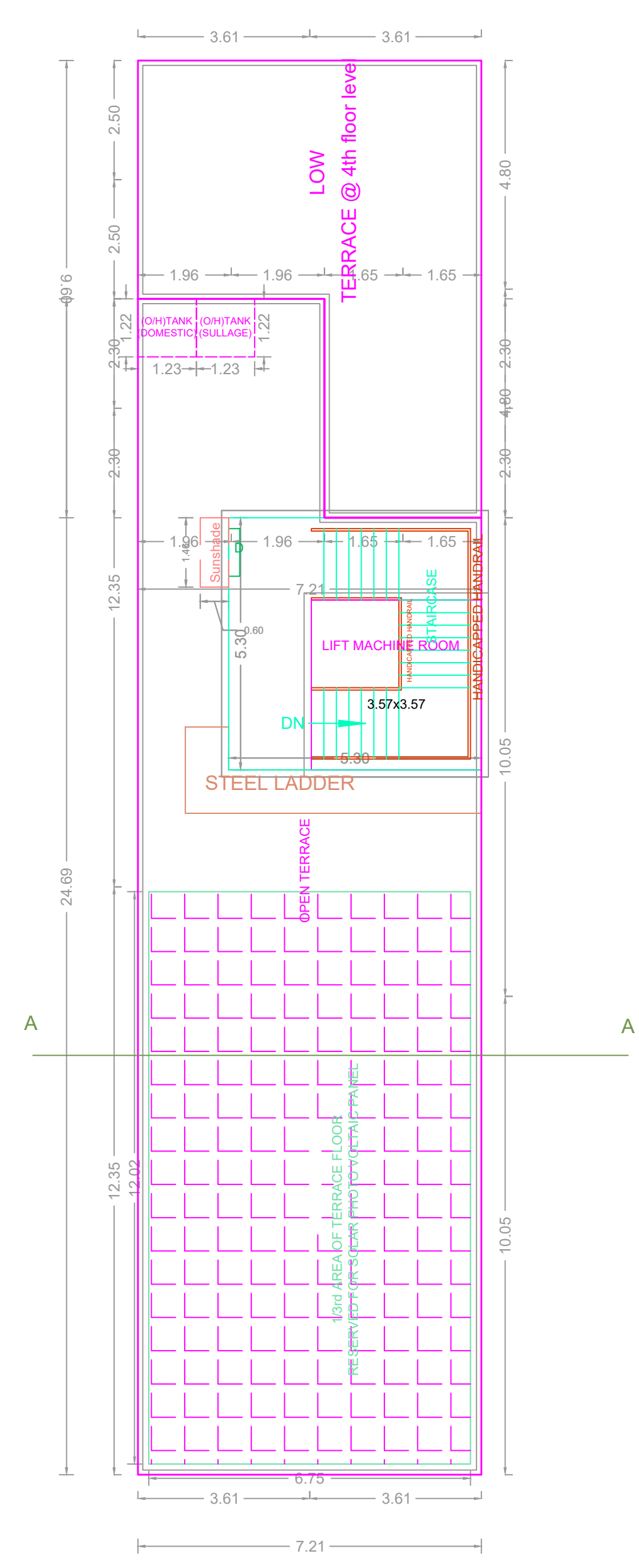
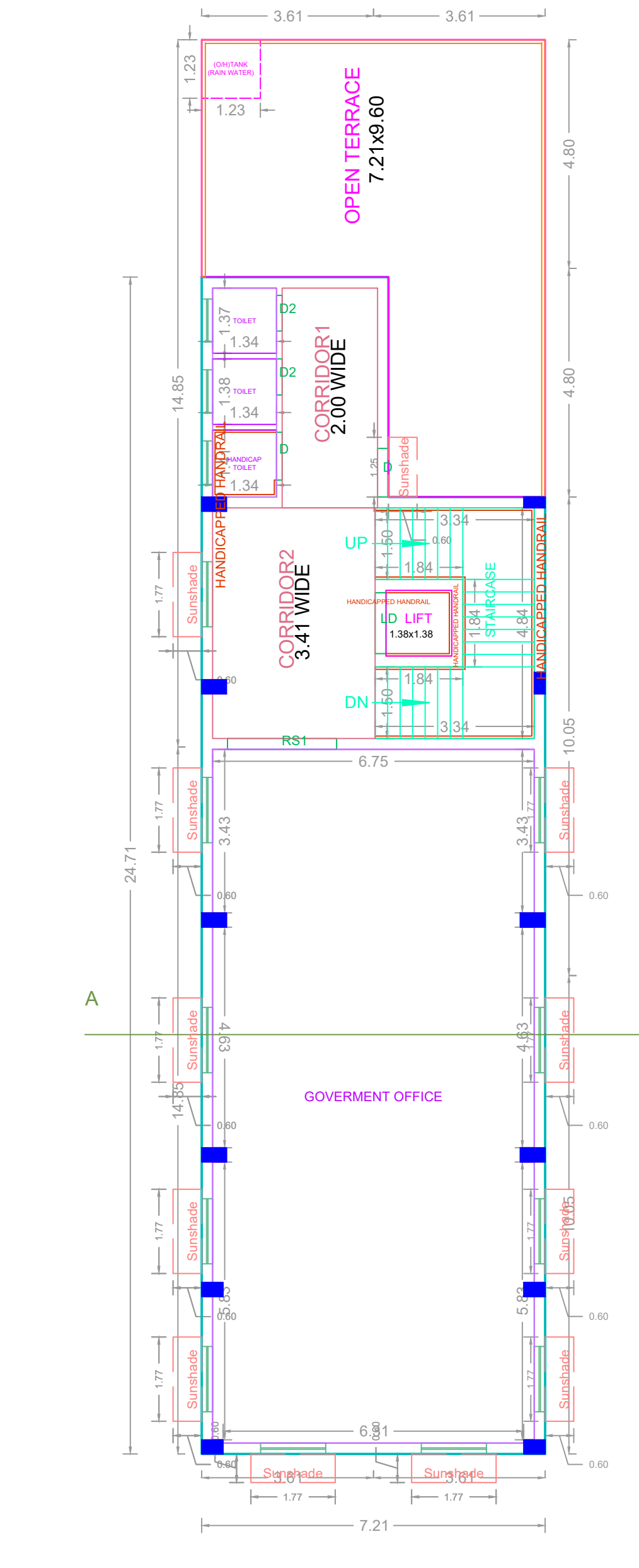
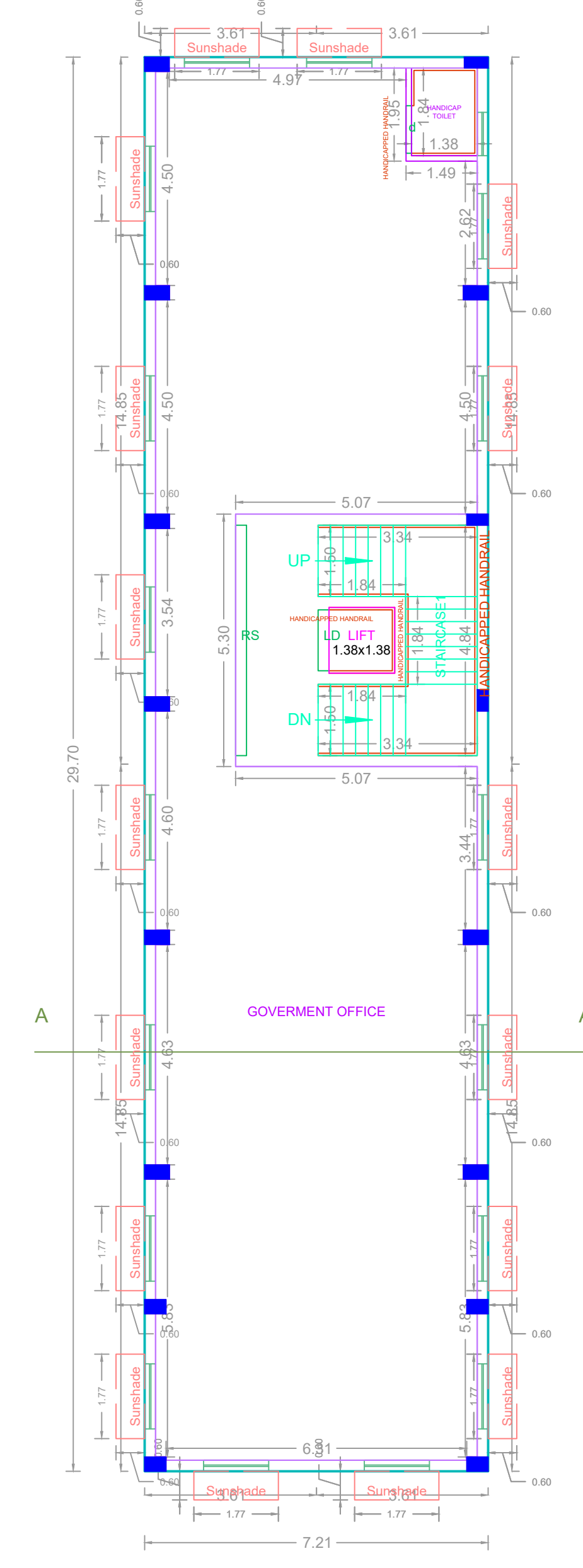
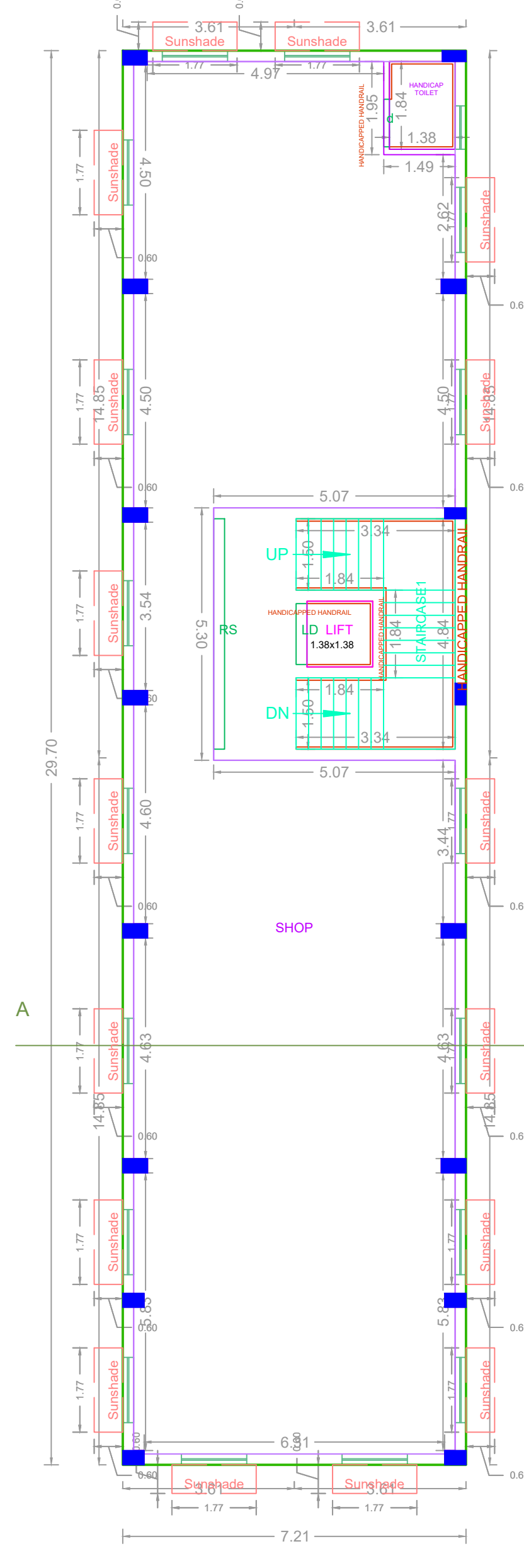
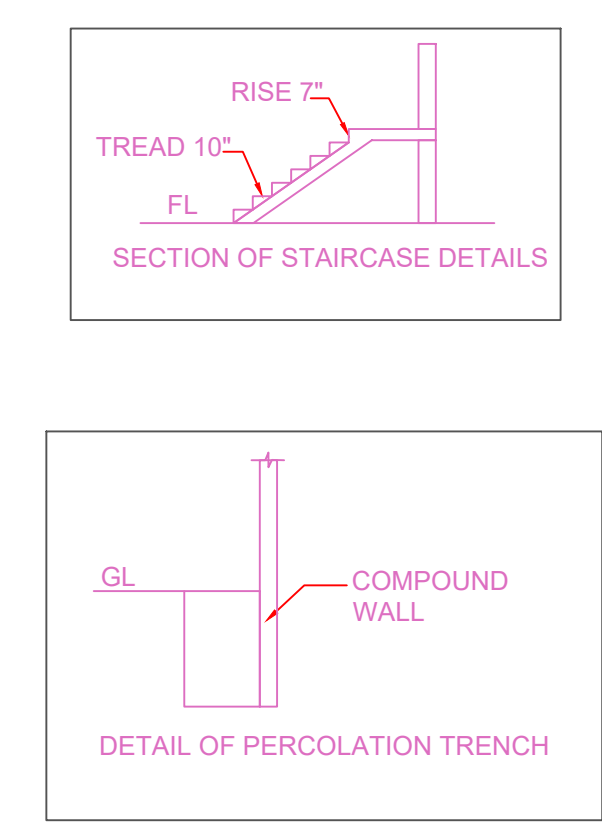
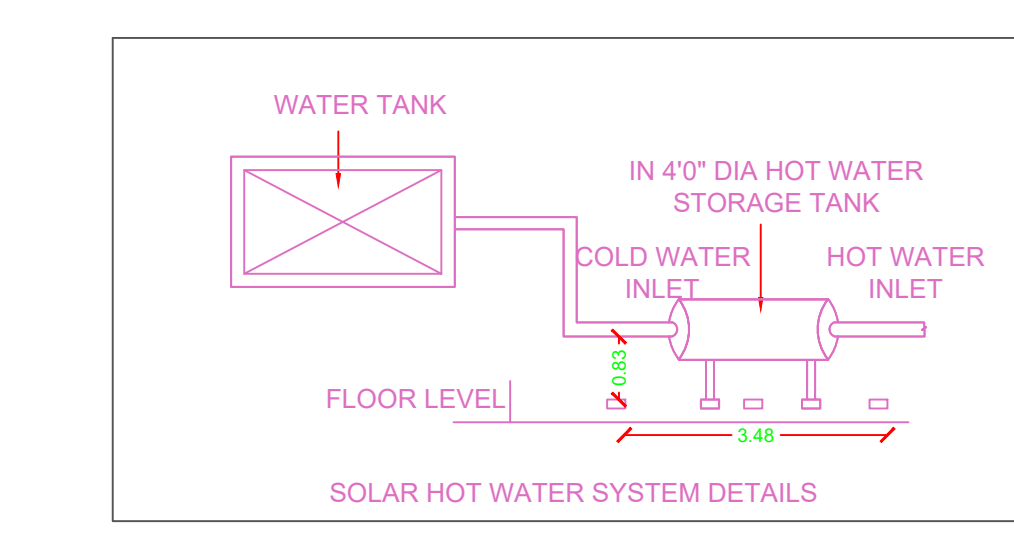
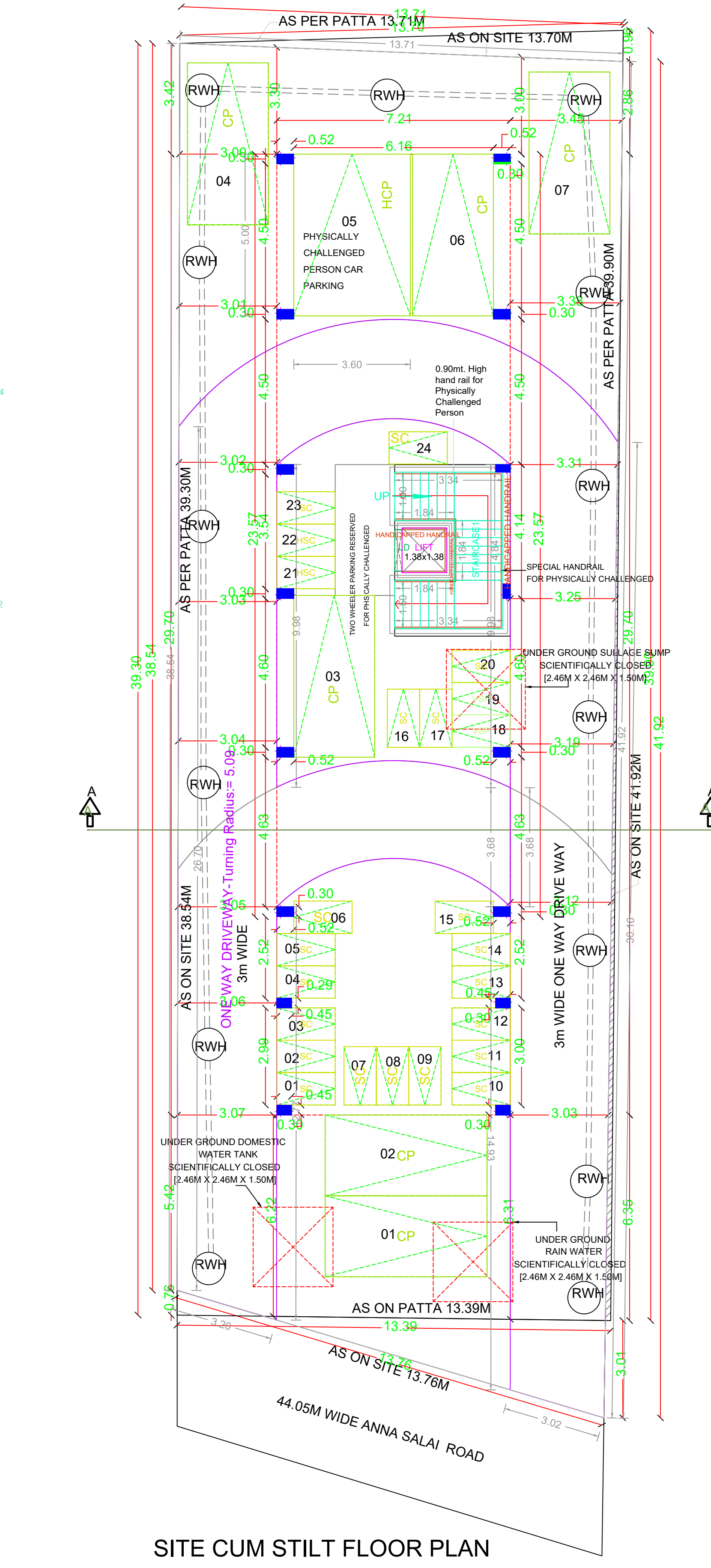
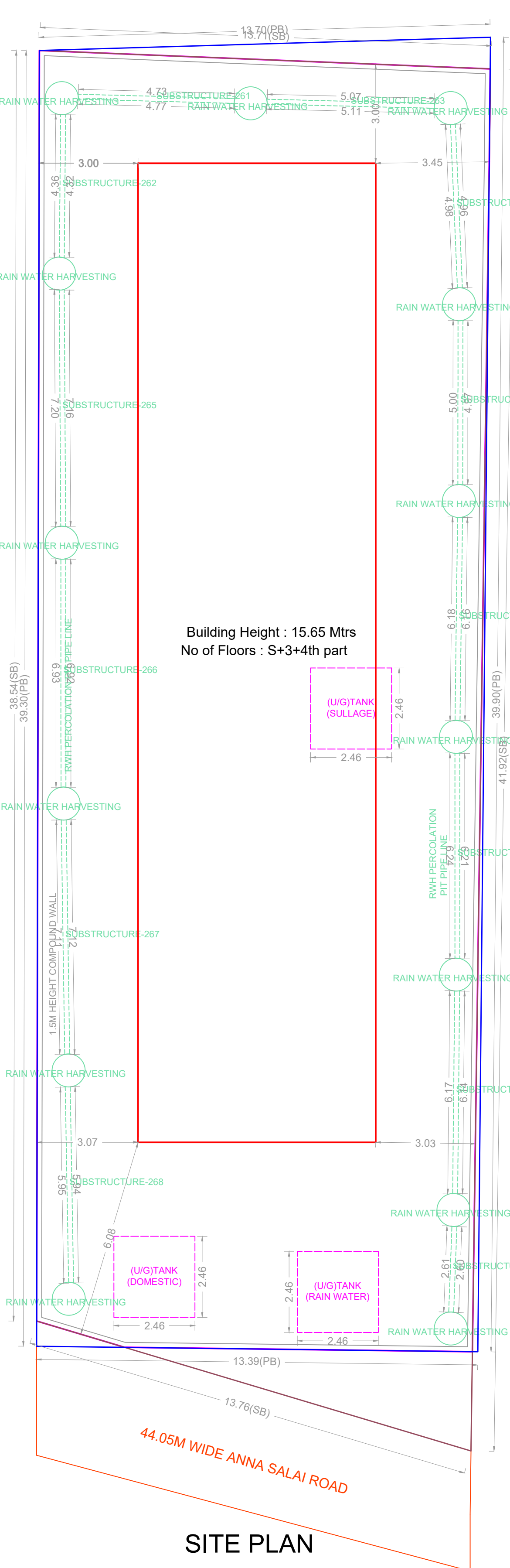

APPROVAL CONDITION

SCALE: 1:100

CHENNAI METROPOLITAN DEVELOPMENT AUTHORITY

APPROVED

SUBJECT TO THE CONDITIONS MENTIONED IN THIS OFFICE

For Deputy Planner / Chief Planner / Member (Secretary)  
High Rise Building / Non High Rise Building  
This Approval is valid only after building Permit is issued by the concerned Local Body.

KEY NO. 8688

QR CODE