

PLAN SHOWING THE PROPOSED CONSTRUCTION OF STILT FLOOR + 4 FLOORS RESIDENTIAL BUILDING WITH 8 DWELLING UNITS (HEIGHT-14.95M) AT BLOCK NO. 176, DOOR NO. 330/1, KURINJI COLONY, 4TH AVENUE, SHANTHI COLONY, ANNA NAGAR, CHENNAI COMPRISED IN OLD S. NO. 270/PART, T. S. NO. 60/10, BLOCK NO. 19 OF KOYAMBEDU VILLAGE WITHIN THE LIMITS OF GREATER CHENNAI CORPORATION.

A) AREA STATEMENT	SQ.M.
AREA AS PER PATTA	518.50
AREA AS PER DOCUMENT	520.25
AREA CONSIDERED FOR FSI	518.50
STREET ALIGNMENT/ ROAD WIDENING/LINK ROAD	0.00
OSR AREA	0.00
TOTAL FSI AREA	1036.92
FSI FACTOR	2.000
COVERAGE AREA (PERCENTAGE %)	NA

A) PARKING STATEMENT	REQUIRED	PROVIDED
LORRY	0	0
CAR	9	9
TWO WHEELER	0	0
CYCLE	0	0

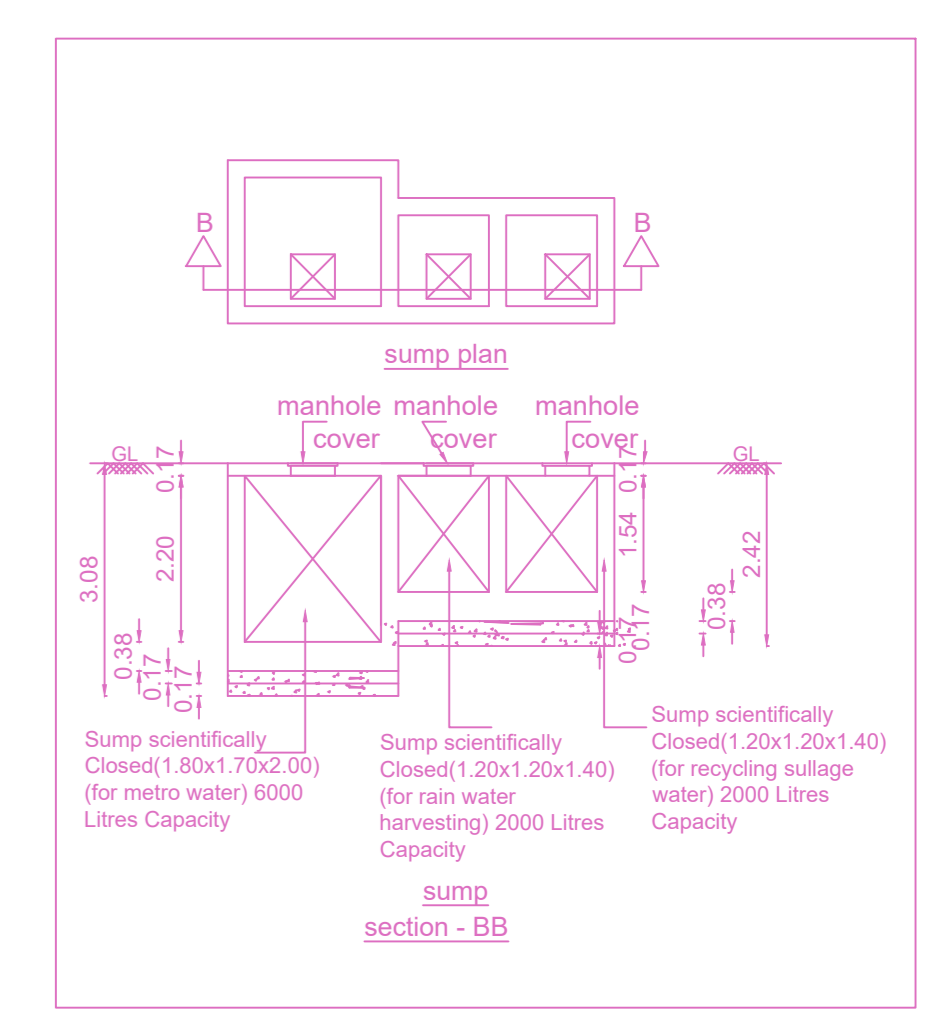
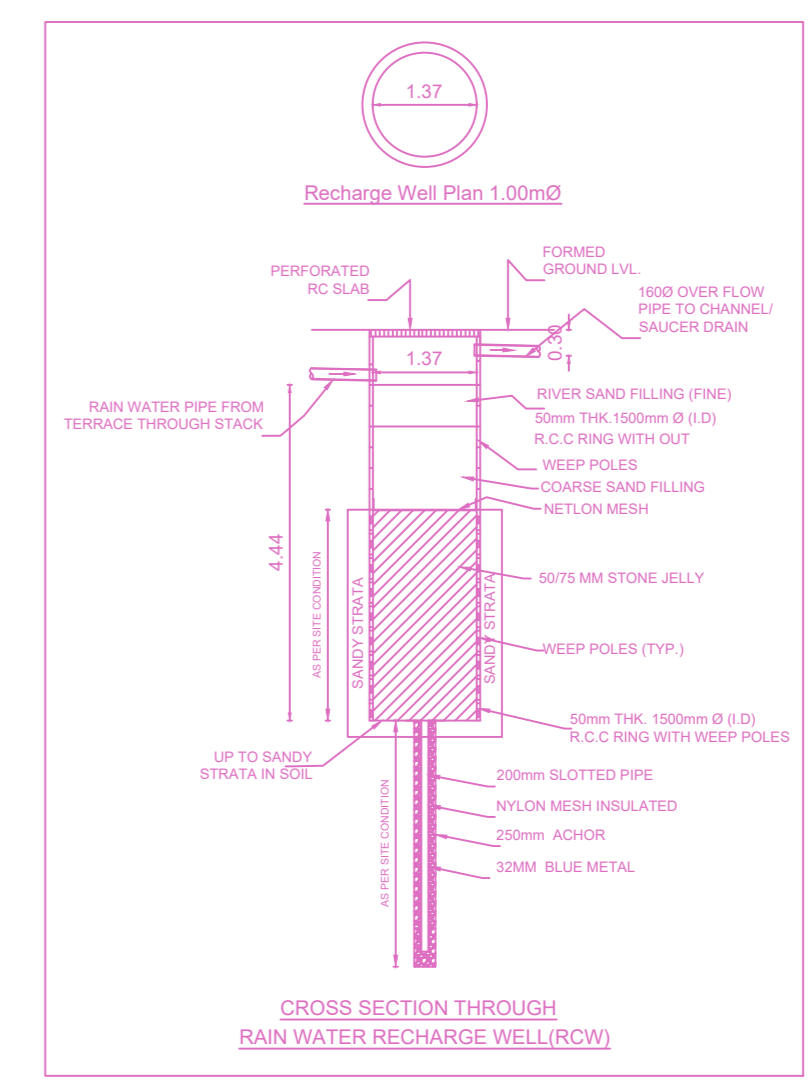
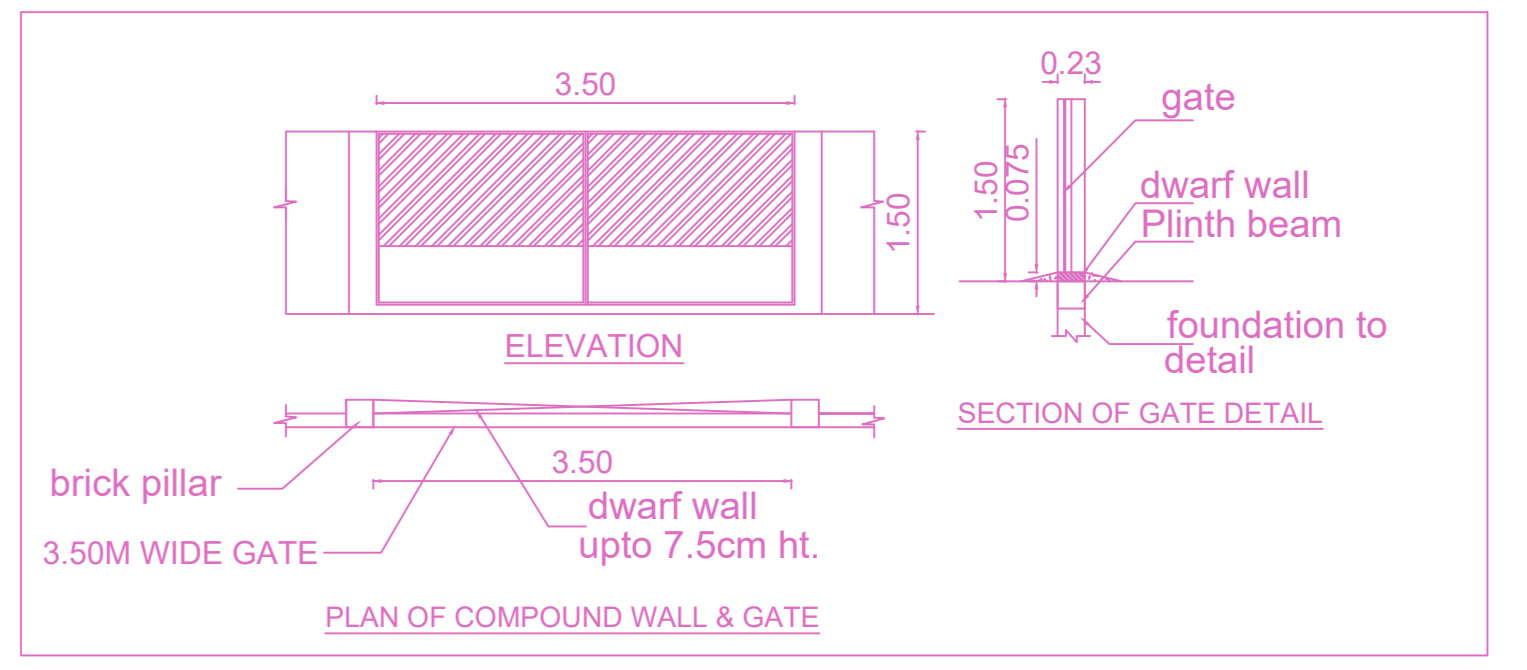
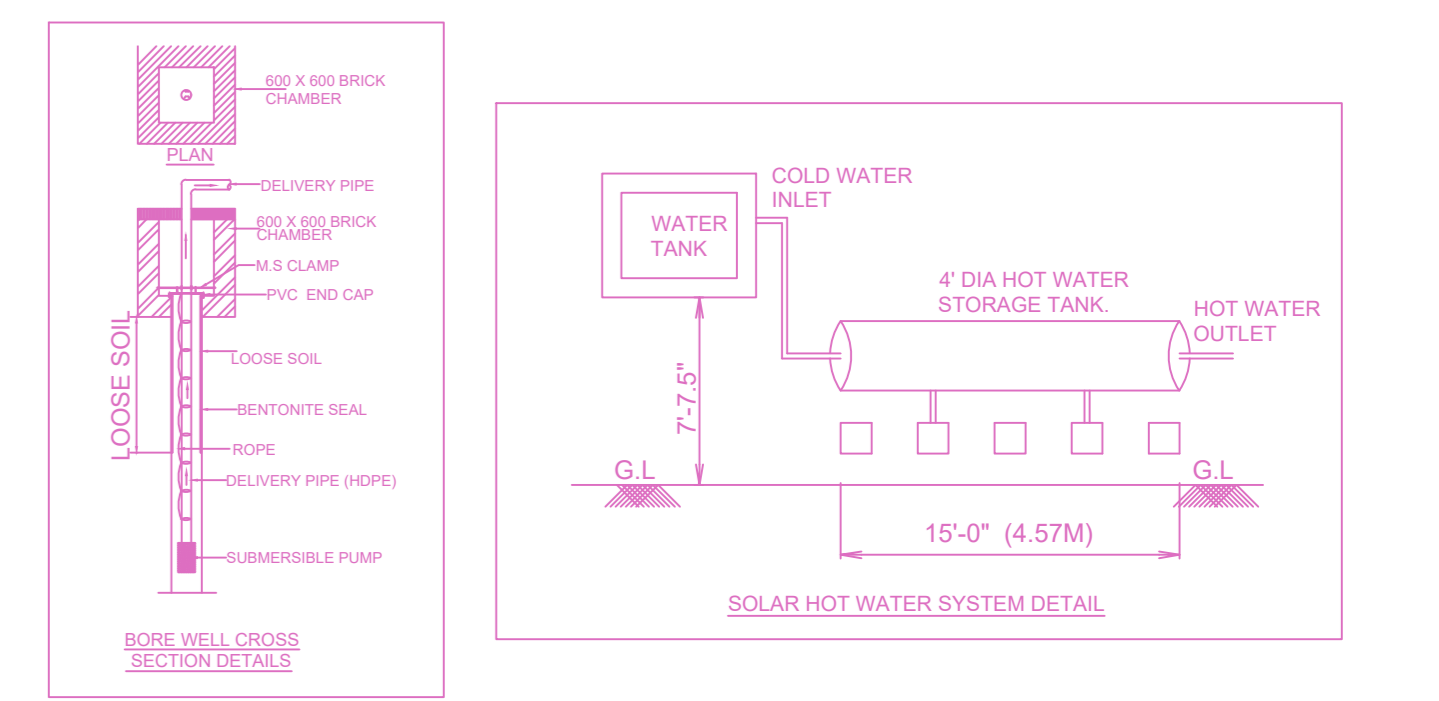
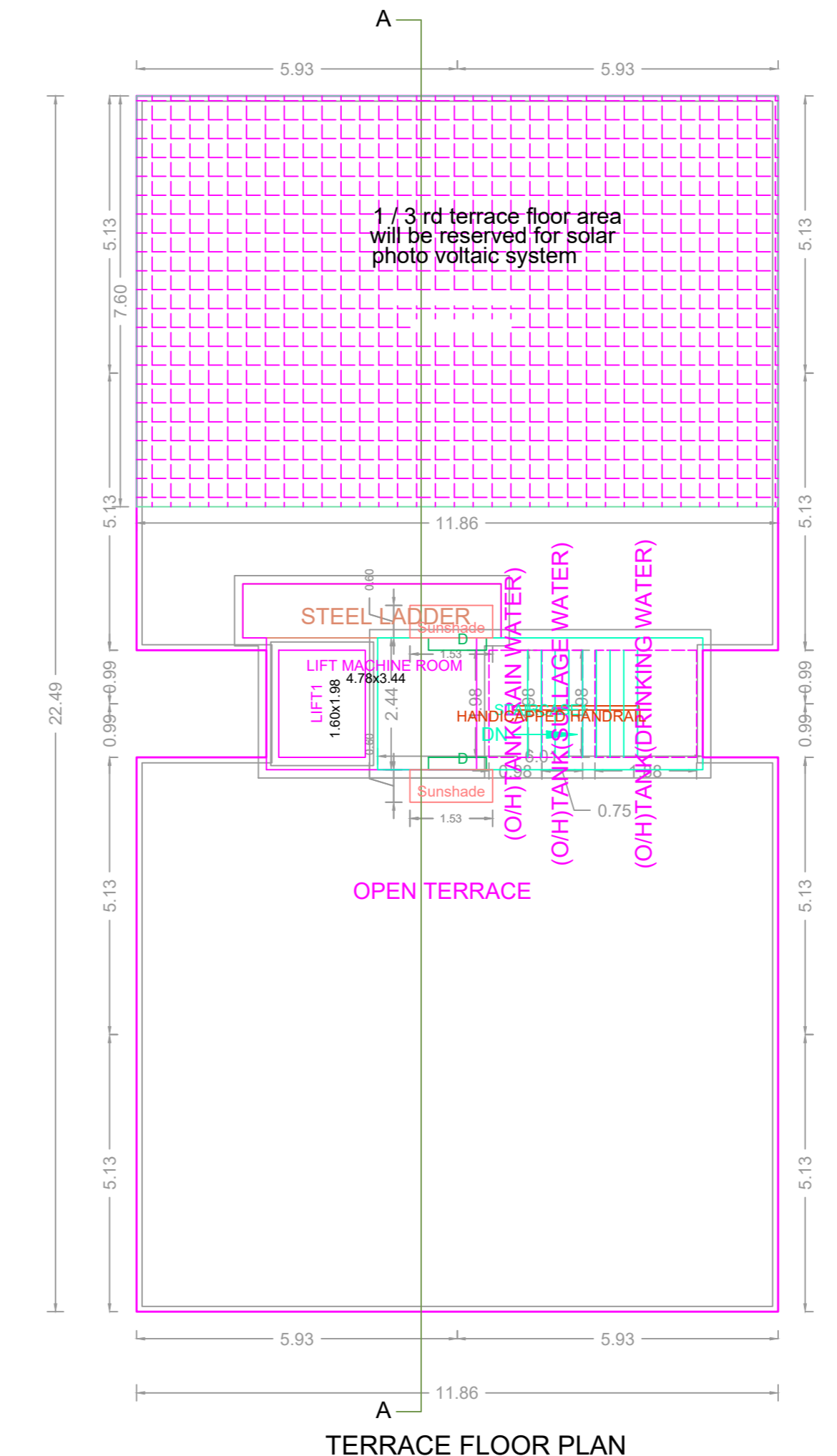
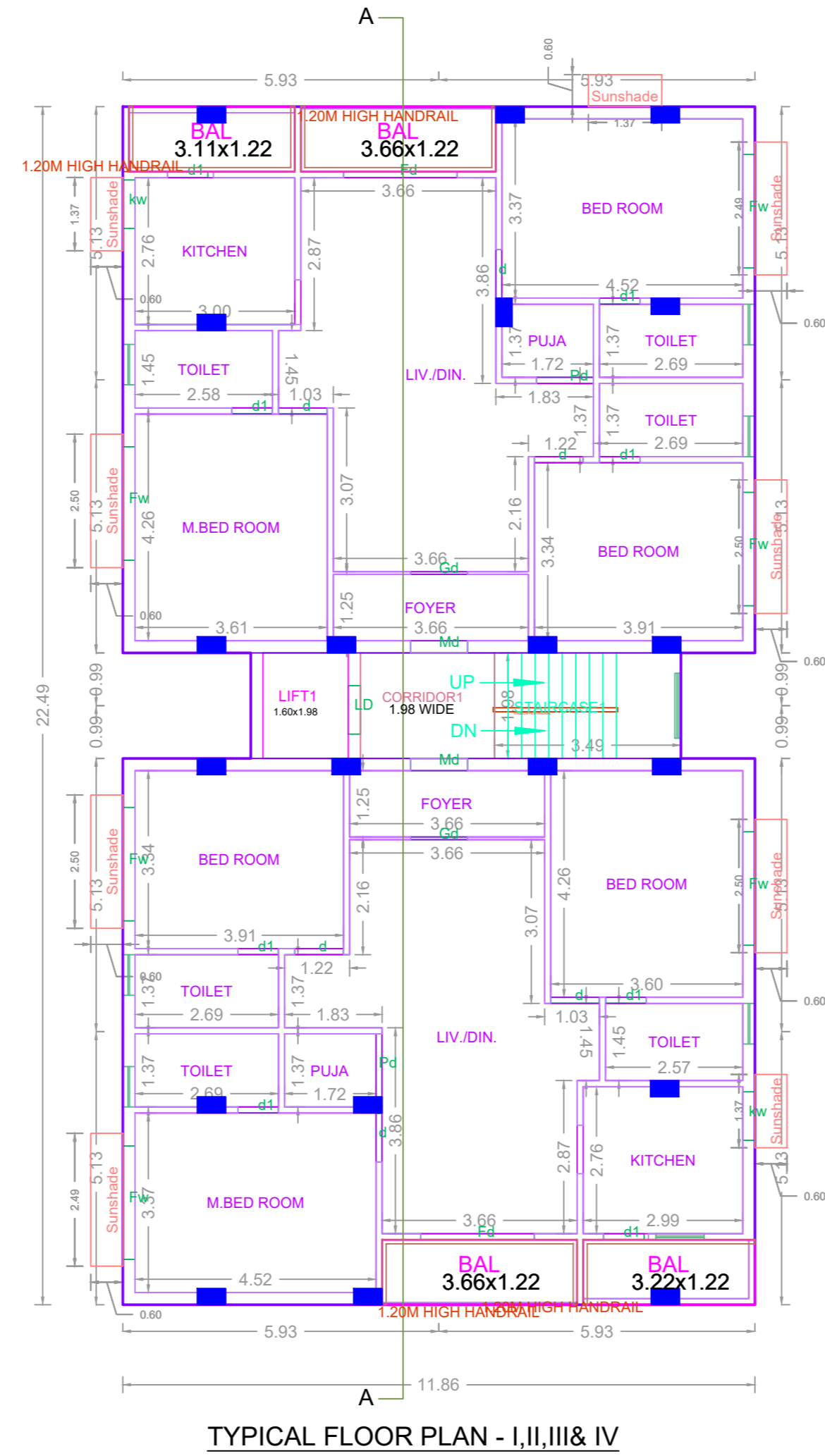
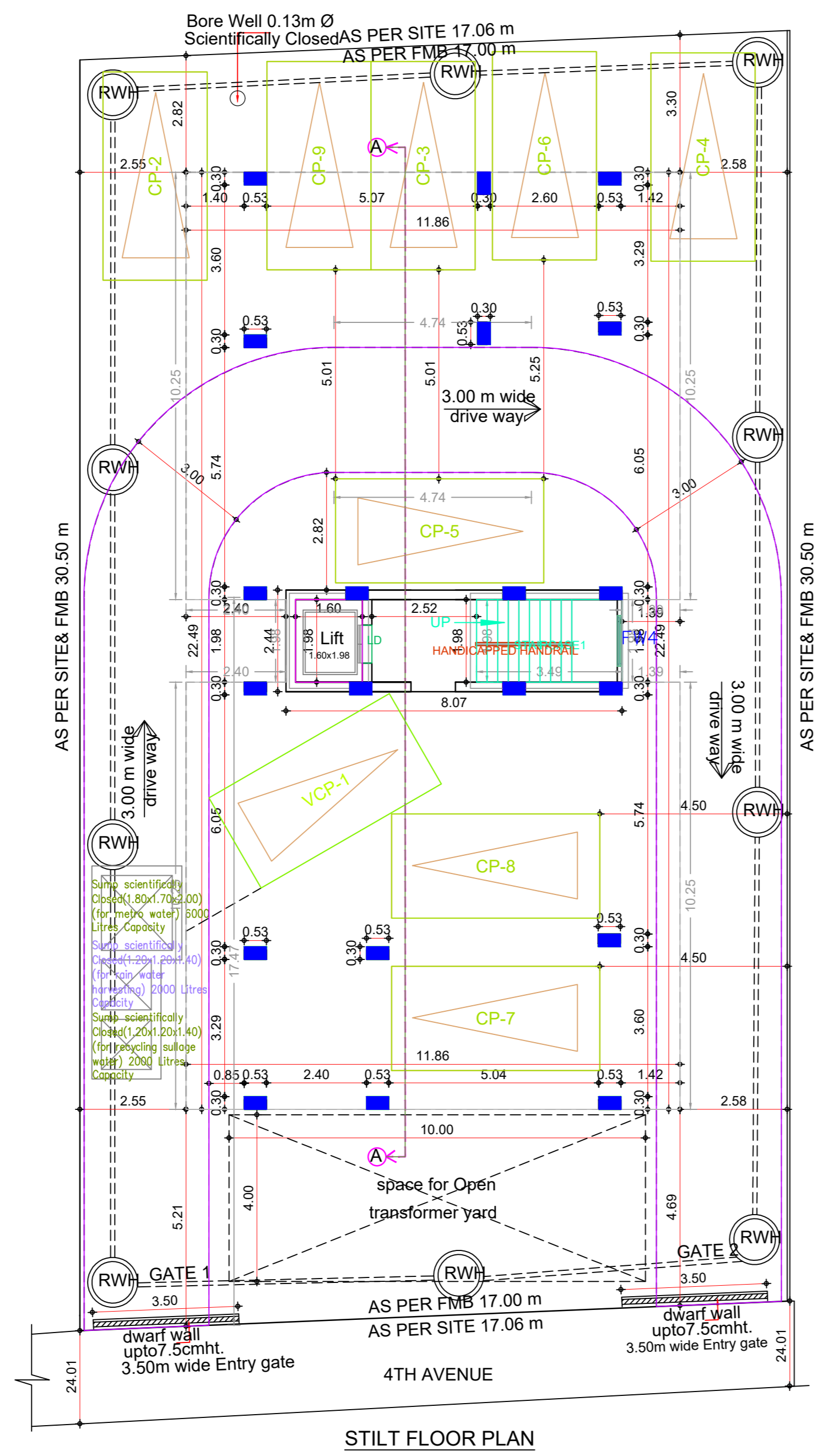
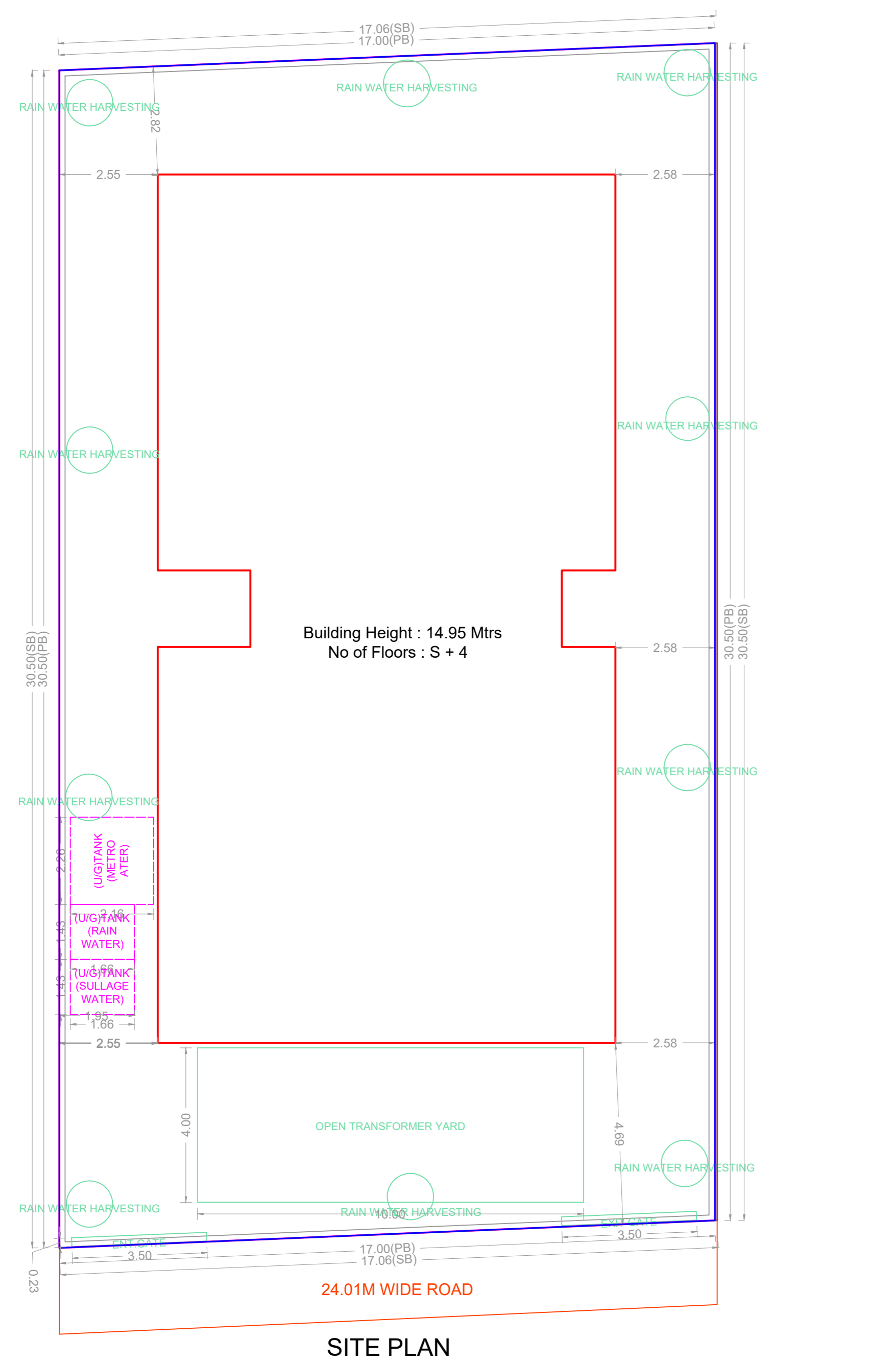
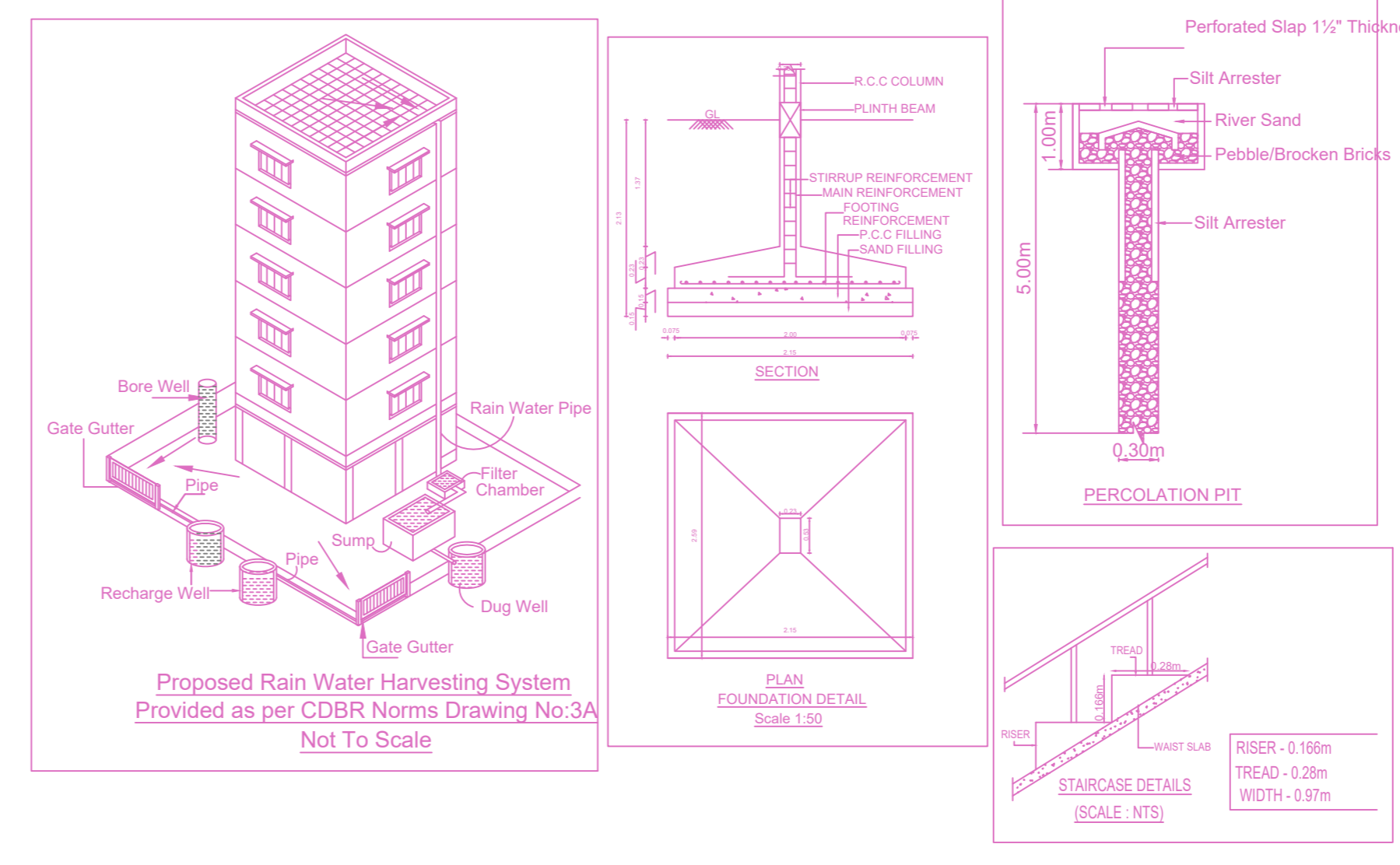

FLOOR WISE FSI STATEMENT: A (B)

FLOORS	COMM.	RESI.	IND.	SPEC.	DU	TOTAL FSI AREA
Terrace	0.00	0.00	0.00	0.00	0	0.00
FOURTH FLOOR	0.00	259.23	0.00	0.00	2	259.23
THIRD FLOOR	0.00	259.23	0.00	0.00	2	259.23
SECOND FLOOR	0.00	259.23	0.00	0.00	2	259.23
FIRST FLOOR	0.00	259.23	0.00	0.00	2	259.23
STILT PARKING FLOOR	0.00	0.00	0.00	0.00	0	0.00
Total	0.00	1036.92	0.00	0.00	8	1036.92

BUILDING WISE FSI STATEMENT

BUILDING	NO OF SAME BUILDING	COMM.	RESI.	IND.	SPEC.	DU	TOTAL FSI AREA
A-1 (B)		0.00	1036.92	0.00	0.00	8	1036.92
Total		0.00	1036.92	0.00	0.00	8	1036.92

APPROVAL CONDITION

SCALE 1:100

CHENNAI METROPOLITAN DEVELOPMENT AUTHORITY
APPROVED
 SUBJECT TO THE CONDITIONS MENTIONED IN THIS OFFICE

For (Deputy Planner / Chief Planner / Member-Secretary)
 High Rise Building / Non High Rise Building
 This Approval is valid only after building Permit is issued by the concerned Local Body.

KEY NO. 2788

QR CODE