

ELEVATION

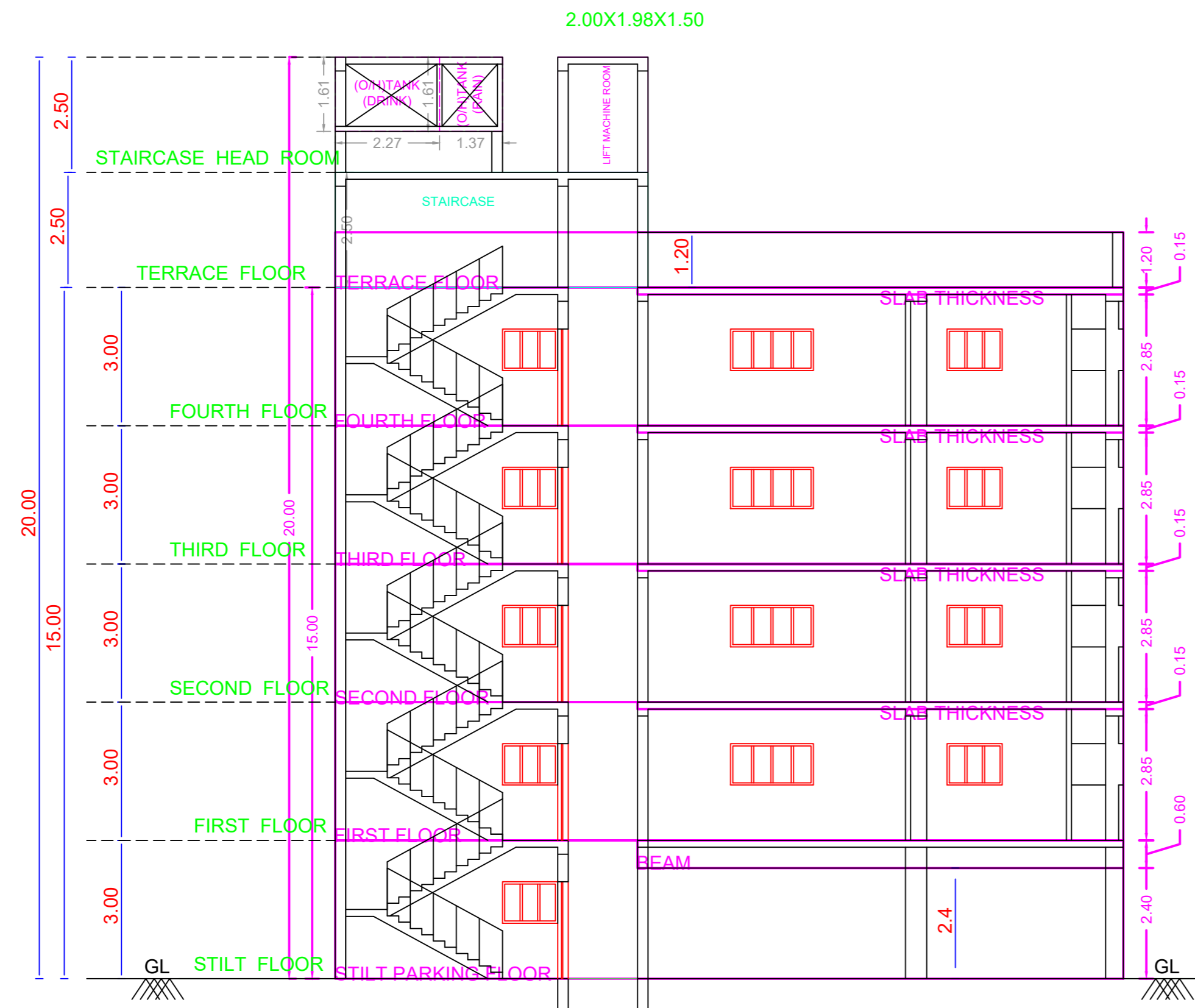

SECTION ON A - A

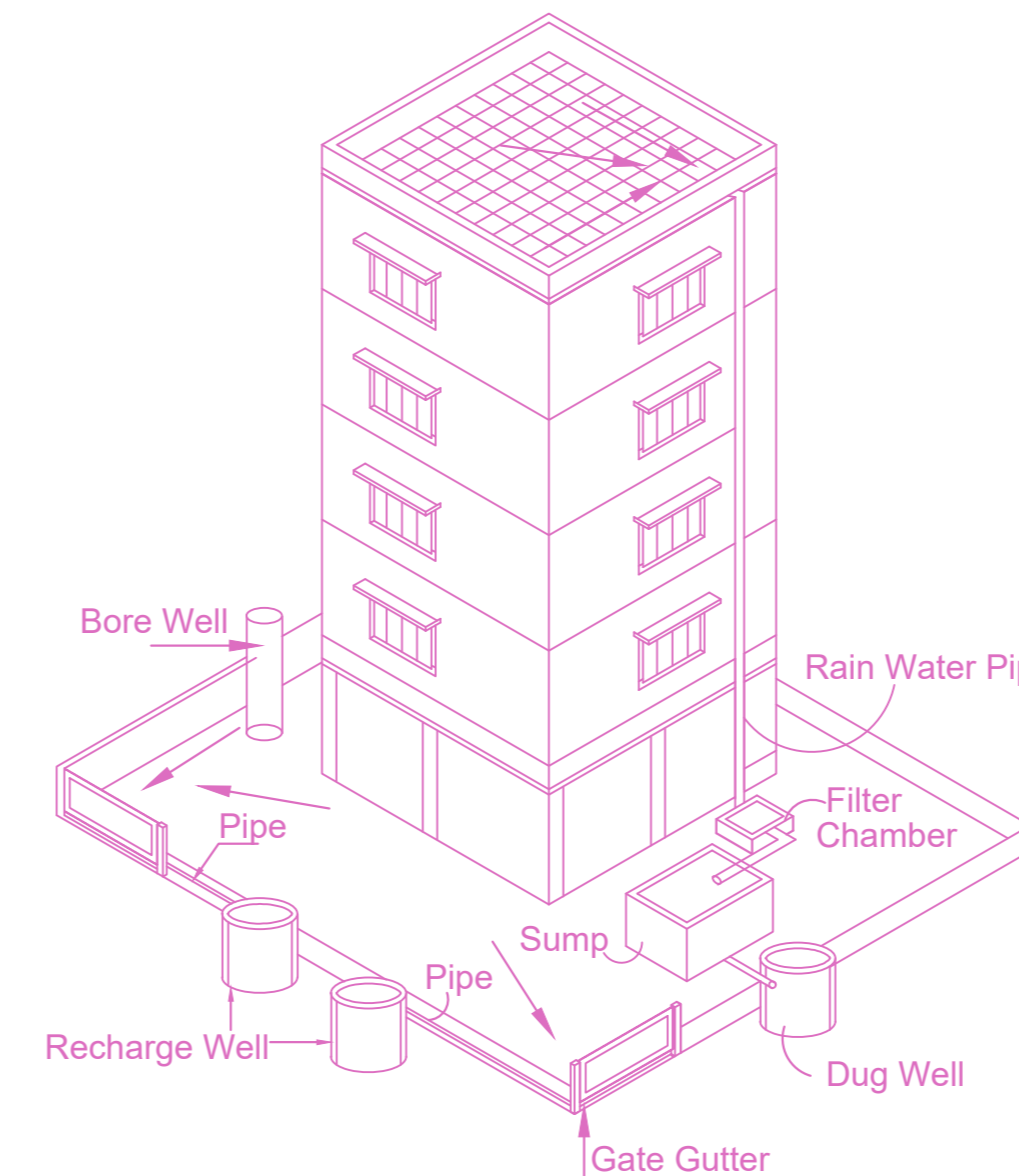

Proposed Rain Water Harvesting System
Provided as per CBR Norms Drawing No:3A
Not To Scale

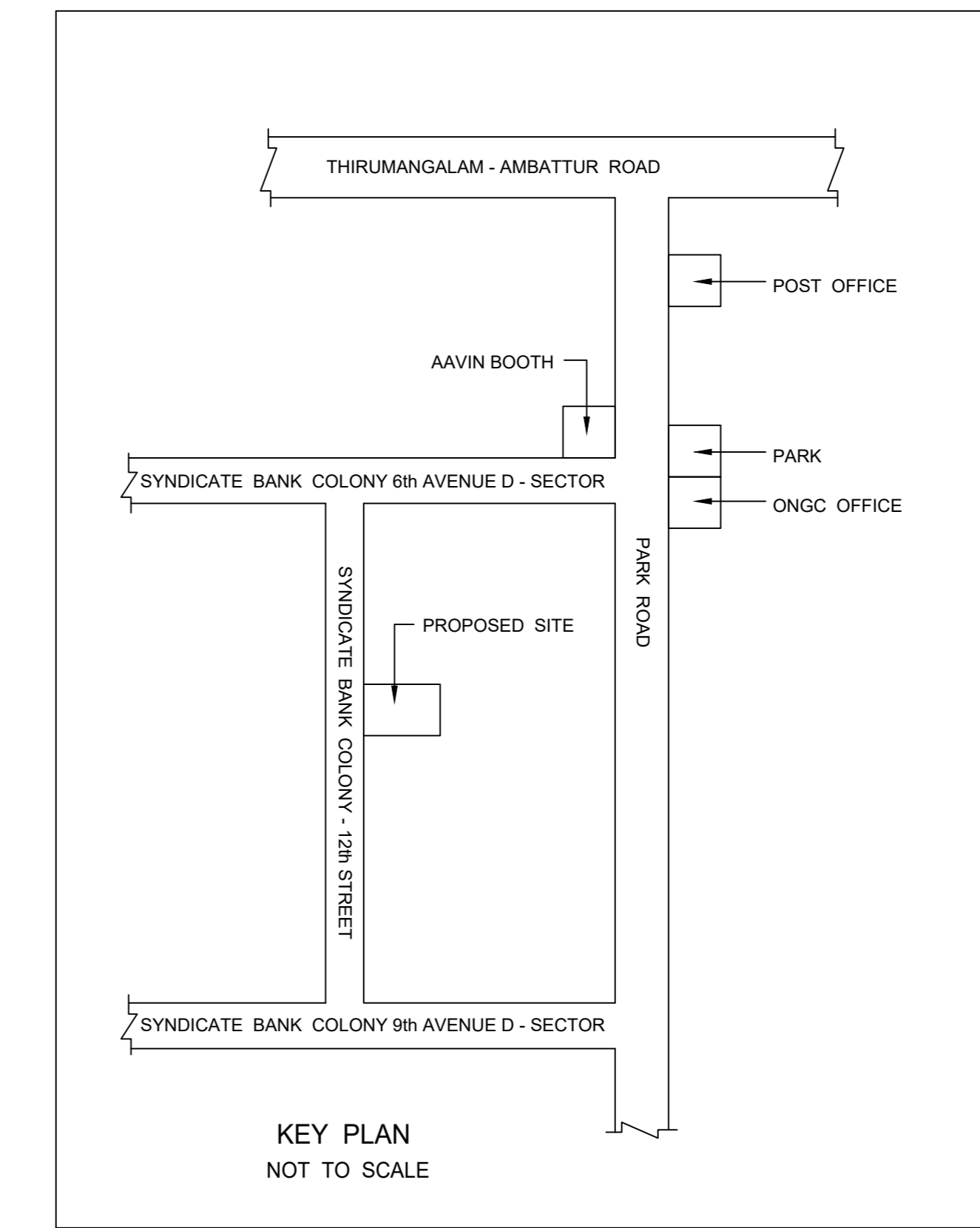

Location plan (Taken as per User Inputs)

PLAN SHOWING THE PROPOSED CONSTRUCTION OF STILT FLOOR + 4 FLOORS (15.00M HEIGHT) RESIDENTIAL BUILDING WITH 4 DWELLING UNITS AT PLOT NO.W-807, 12TH STREET, SYNDICATE BANK COLONY, ANNA NAGAR WEST EXTENSION, CHENNAI - 600 101, COMPRISED IN OLD S.NO'S. 155 PART & 157 PART (AS PER DOCUMENT), OLD S.NO.147/2B PART AND 155 PART (AS PER PATTI), T.S.NO.40, BLOCK NO.46 OF PADI VILLAGE WITHIN THE LIMITS OF GREATER CHENNAI CORPORATION. DIVISION No. 88 ZONE - VII

A) AREA STATEMENT		SQ.M.
AREA AS PER PATTA		280.00
AREA AS PER DOCUMENT		278.70
AREA CONSIDERED FOR FSI		278.70
STREET ALIGNMENT/ ROAD WIDENING/LINK ROAD		0.00
OSR AREA		0.00
TOTAL FSI AREA		490.60
FSI FACTOR		1.760
COVERAGE AREA (PERCENTAGE %)		NA

A) PARKING STATEMENT		
VEHICLE	REQUIRED	PROVIDED
LORRY	0	0
CAR	4	4
TWO WHEELER	0	0
CYCLE	0	0

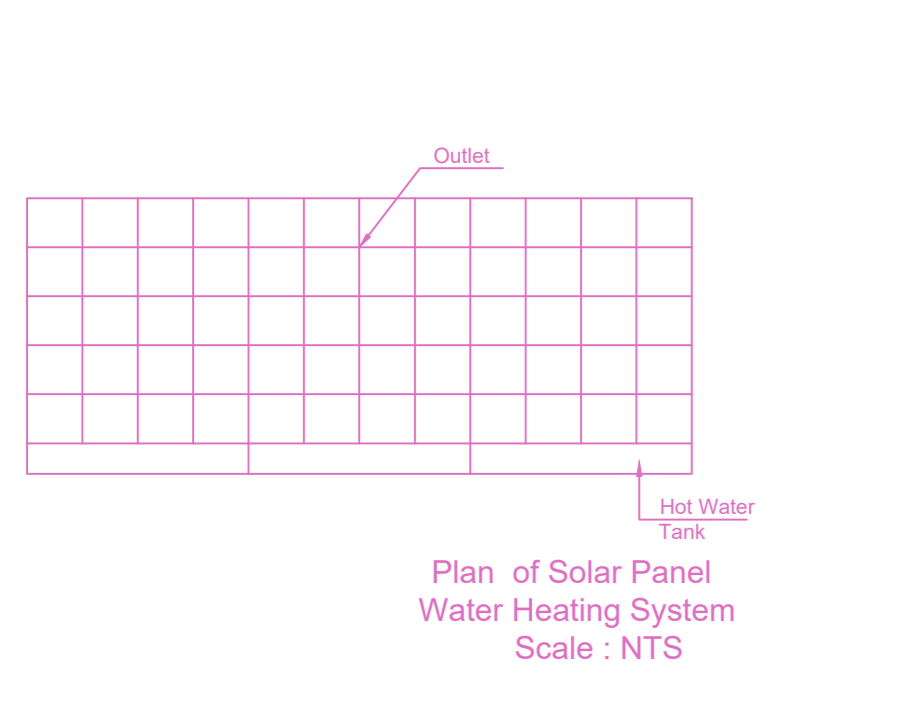

Plan of Solar Panel Water Heating System
Scale : NTS

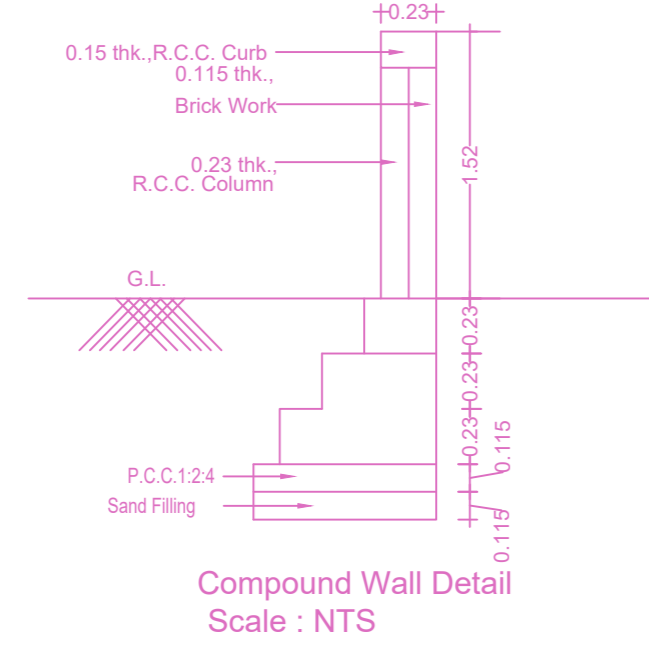

Compound Wall Detail
Scale : NTS

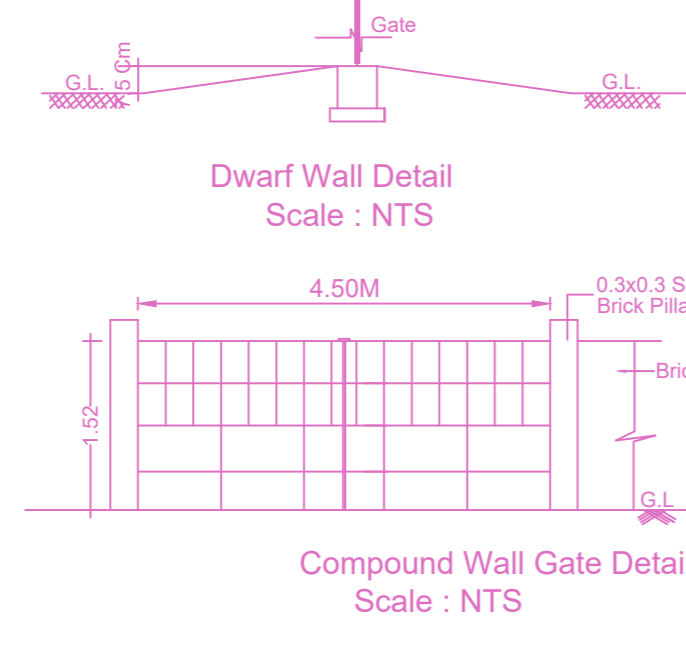

Dwarf Wall Detail
Scale : NTS

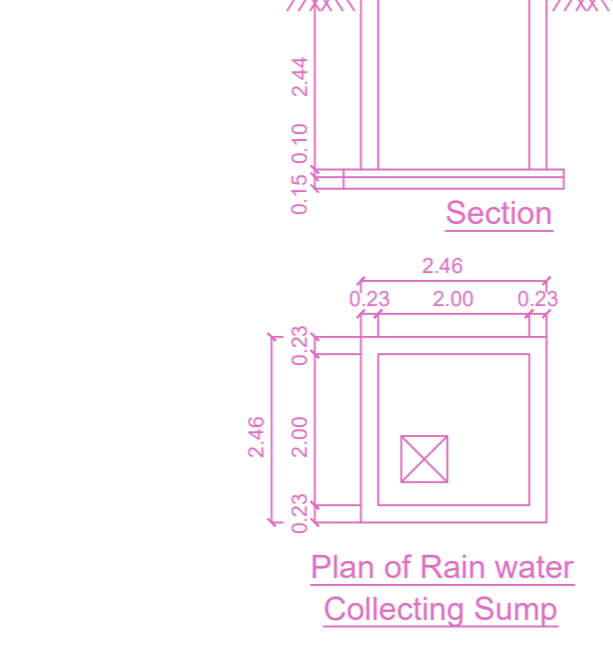

Plan of Rain water Collecting Sump
Scale : NTS

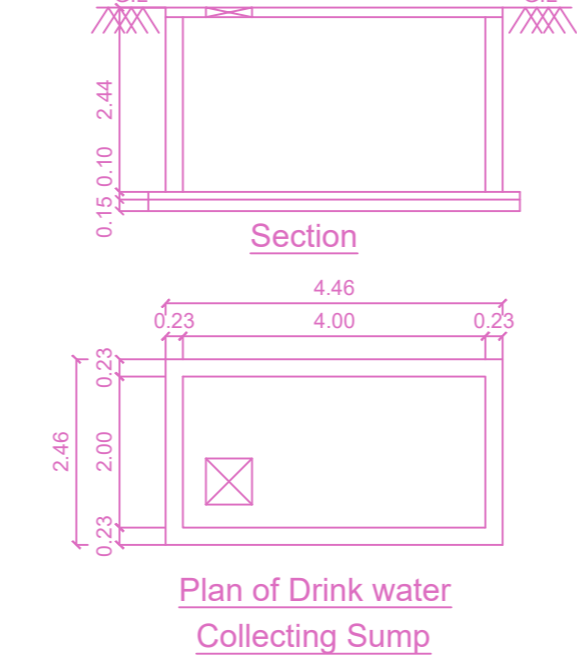

Plan of Drink water Collecting Sump
Scale : NTS

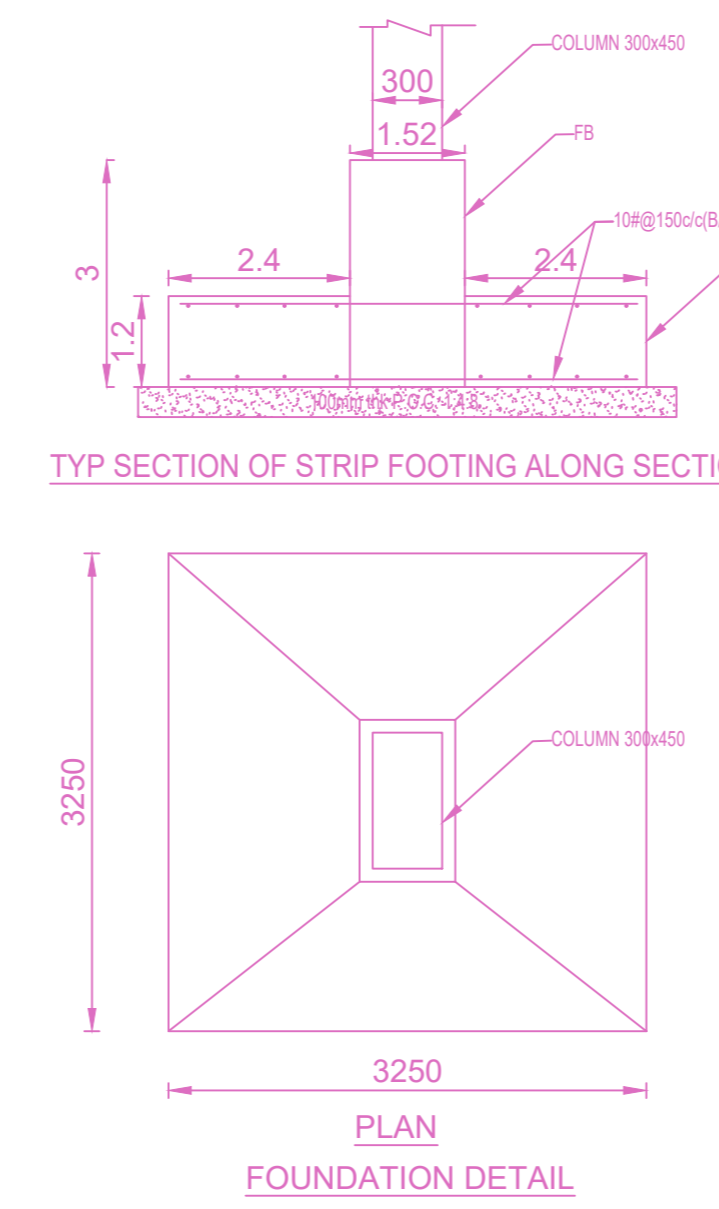

TYP SECTION OF STRIP FOOTING ALONG SECTION XX
FOUNDATION DETAIL

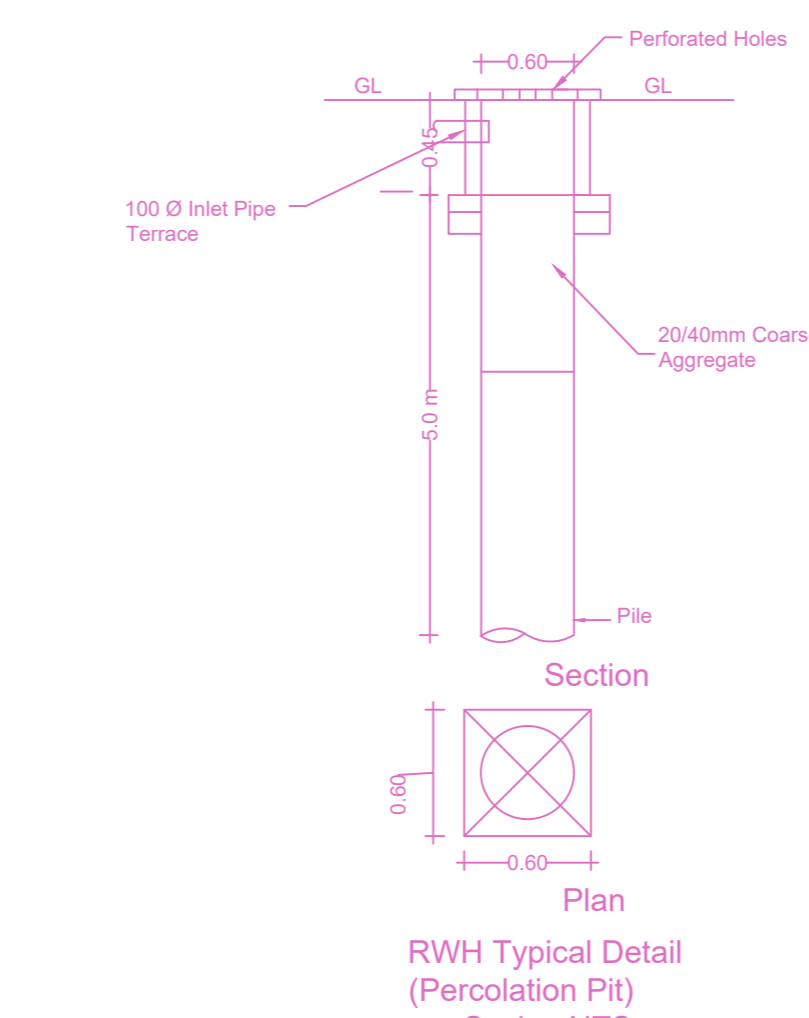

Plan RWH Typical Detail (Percolation Pit)
Scale : NTS

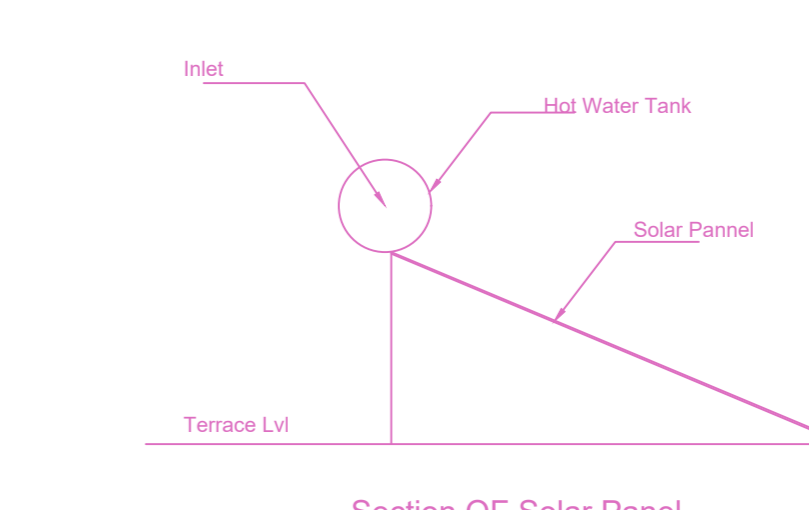

Section of Solar Panel
Scale : NTS

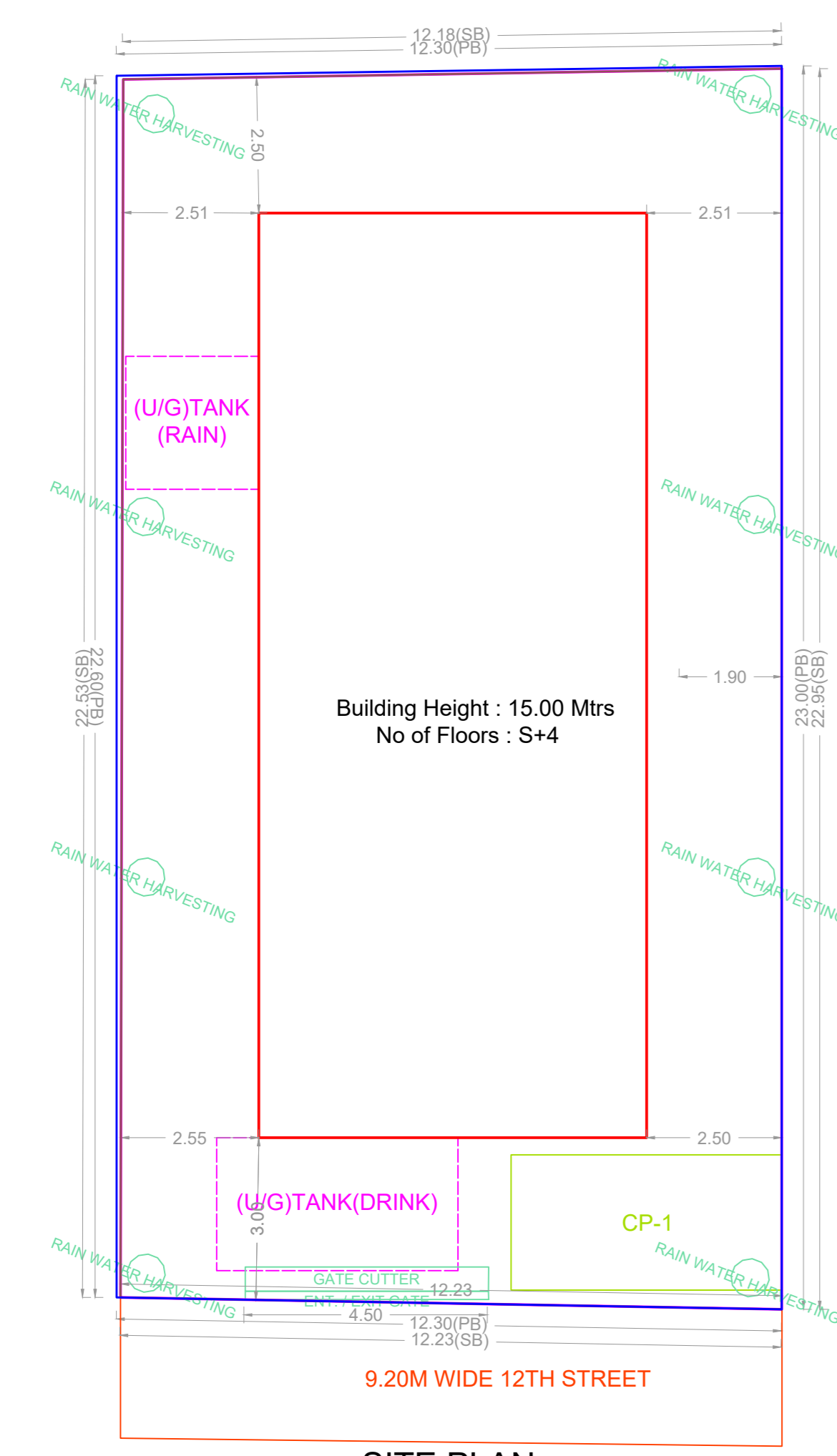

SITE PLAN

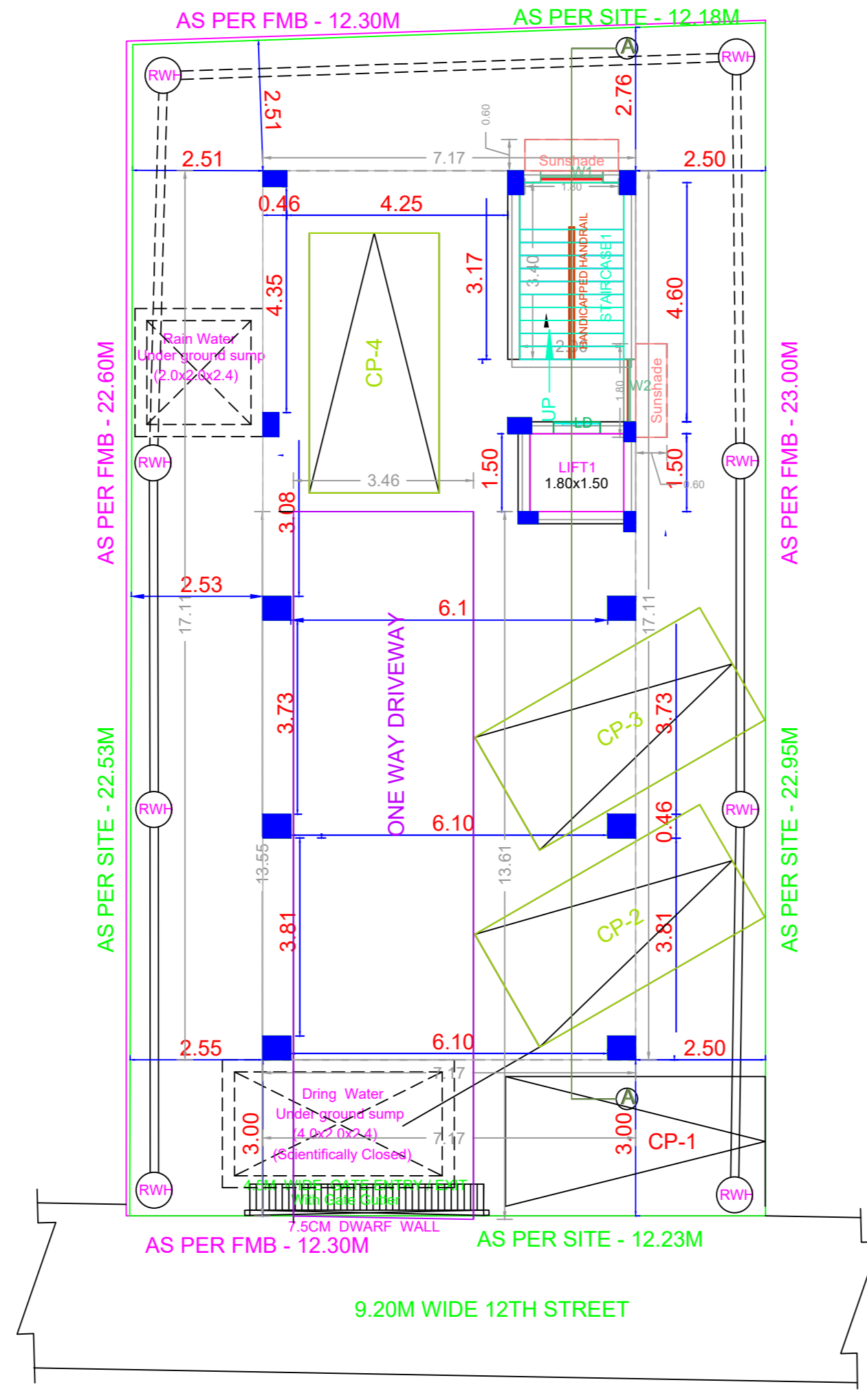

SITE CUM STILT FLOOR PLAN

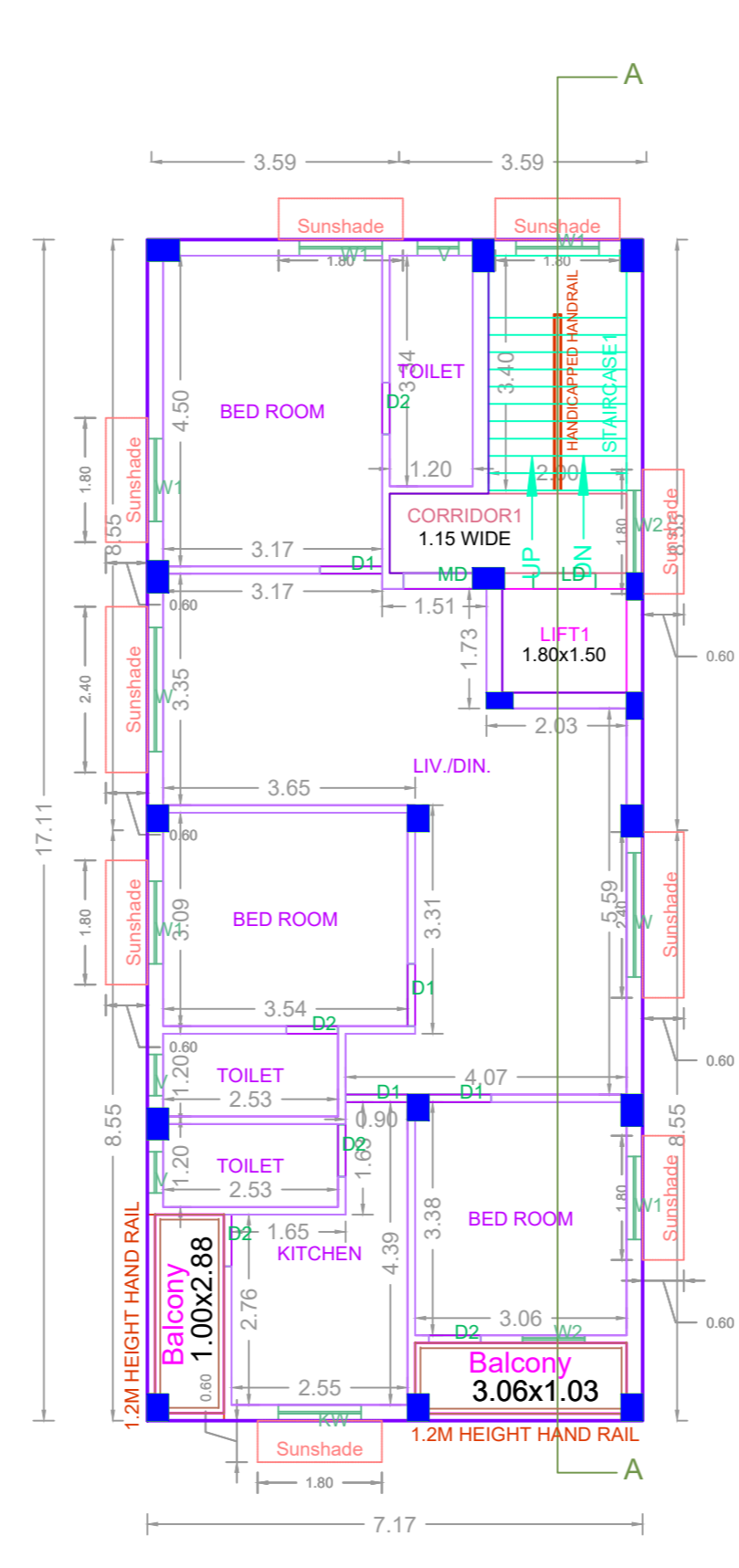

TYPICAL FLOOR PLAN
1st, 2nd, 3rd & 4th

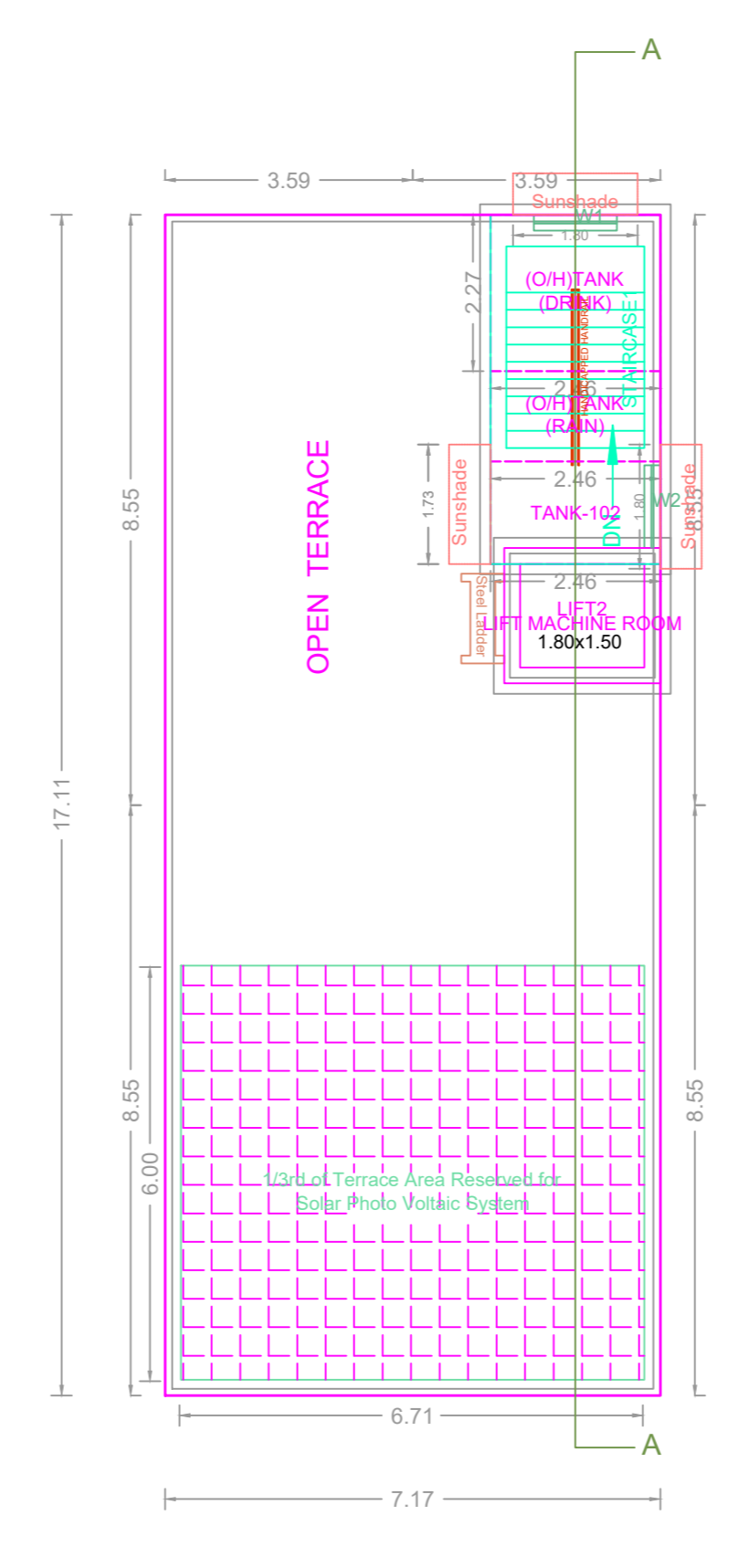

TERRACE FLOOR PLAN

FLOOR WISE FSI STATEMENT: A (B)						
FLOORS	FSI AREA				DU	TOTAL FSI AREA
	COMM.	RESI.	IND.	SPEC.		
Terrace	0.00	0.00	0.00	0.00	0	0.00
FOURTH FLOOR	0.00	122.65	0.00	0.00	1	122.65
THIRD FLOOR	0.00	122.65	0.00	0.00	1	122.65
SECOND FLOOR	0.00	122.65	0.00	0.00	1	122.65
FIRST FLOOR	0.00	122.65	0.00	0.00	1	122.65
STILT PARKING FLOOR	0.00	0.00	0.00	0.00	0	0.00
Total	0.00	490.60	0.00	0.00	4	490.60

BUILDING WISE FSI STATEMENT							
BUILDING	NO OF SAME BUILDING	FSI AREA				DU	TOTAL FSI AREA
		COMM.	RESI.	IND.	SPEC.		
A-1 (B)		0.00	490.60	0.00	0.00	4	490.60
Total		0.00	490.60	0.00	0.00	4	490.60

APPROVAL CONDITION

1. The building shall be constructed in accordance with the approved plans and specifications.

2. The building shall be completed within the stipulated time frame.

3. The building shall be handed over to the concerned authorities for occupation.

SCALE 1:100

CHENNAI METROPOLITAN DEVELOPMENT AUTHORITY

APPROVED

SUBJECT TO THE CONDITIONS MENTIONED IN THIS OFFICE

For (Deputy Planner / Chief Planner / Member-Secretary)
High Rise Building / Non High Rise Building
This Approval is valid only after building Permit is issued by the concerned Local Body.

KEY NO. 2688

QR CODE