

PLAN SHOWING THE PROPOSED CONSTRUCTION OF STILT FLOOR (PARKING) + 5 FLOORS (HEIGHT - 18.29M) RESIDENTIAL BUILDING WITH 5 DWELLING UNITS AVAILING PREMIUM FSI AT PLOT NO.2832, DOOR NO. AK-33, AK BLOCK 11TH MAIN ROAD AND 8TH CROSS STREET, NADUVAKARAI, ANNA NAGAR, CHENNAI - 600 040 COMPRISED IN OLD S.NO.147 PART, T.S.NO.35, BLOCK NO.9C OF NADUVAKARAI VILLAGE WITHIN THE LIMITS OF GREATER CHENNAI CORPORATION.

A) AREA STATEMENT		SQ.M.
AREA AS PER PATTA		343.00
AREA AS PER DOCUMENT		332.13
AREA CONSIDERED FOR FSI		332.13
STREET ALIGNMENT/ ROAD WIDENING/LINK ROAD		0.00
OSR AREA		0.00
TOTAL FSI AREA		686.85
FSI FACTOR		2.068
COVERAGE AREA (PERCENTAGE %)		NA

A) PARKING STATEMENT		
VEHICLE	REQUIRED	PROVIDED
LORRY	0	0
CAR	5	5
TWO WHEELER	0	0
CYCLE	0	0

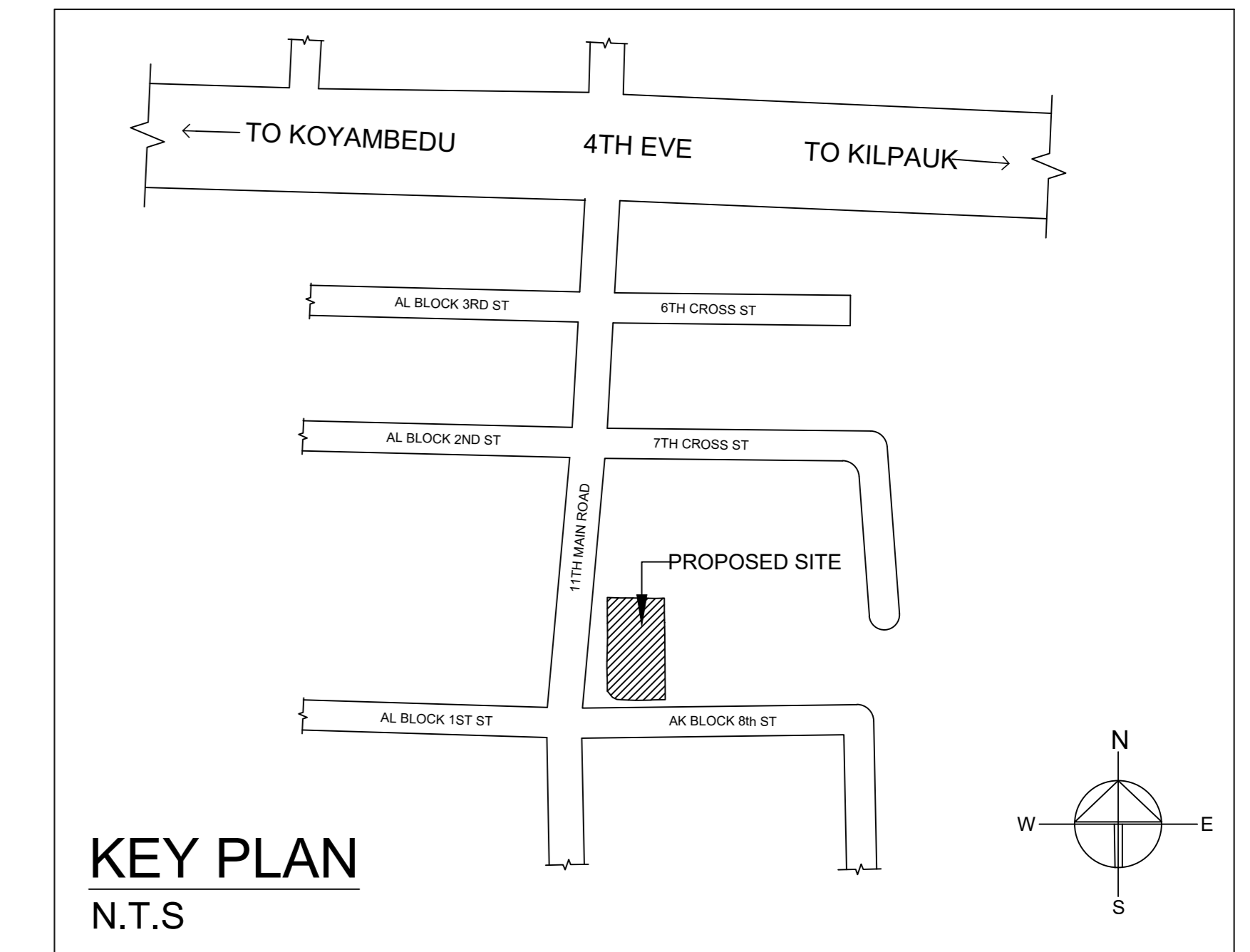
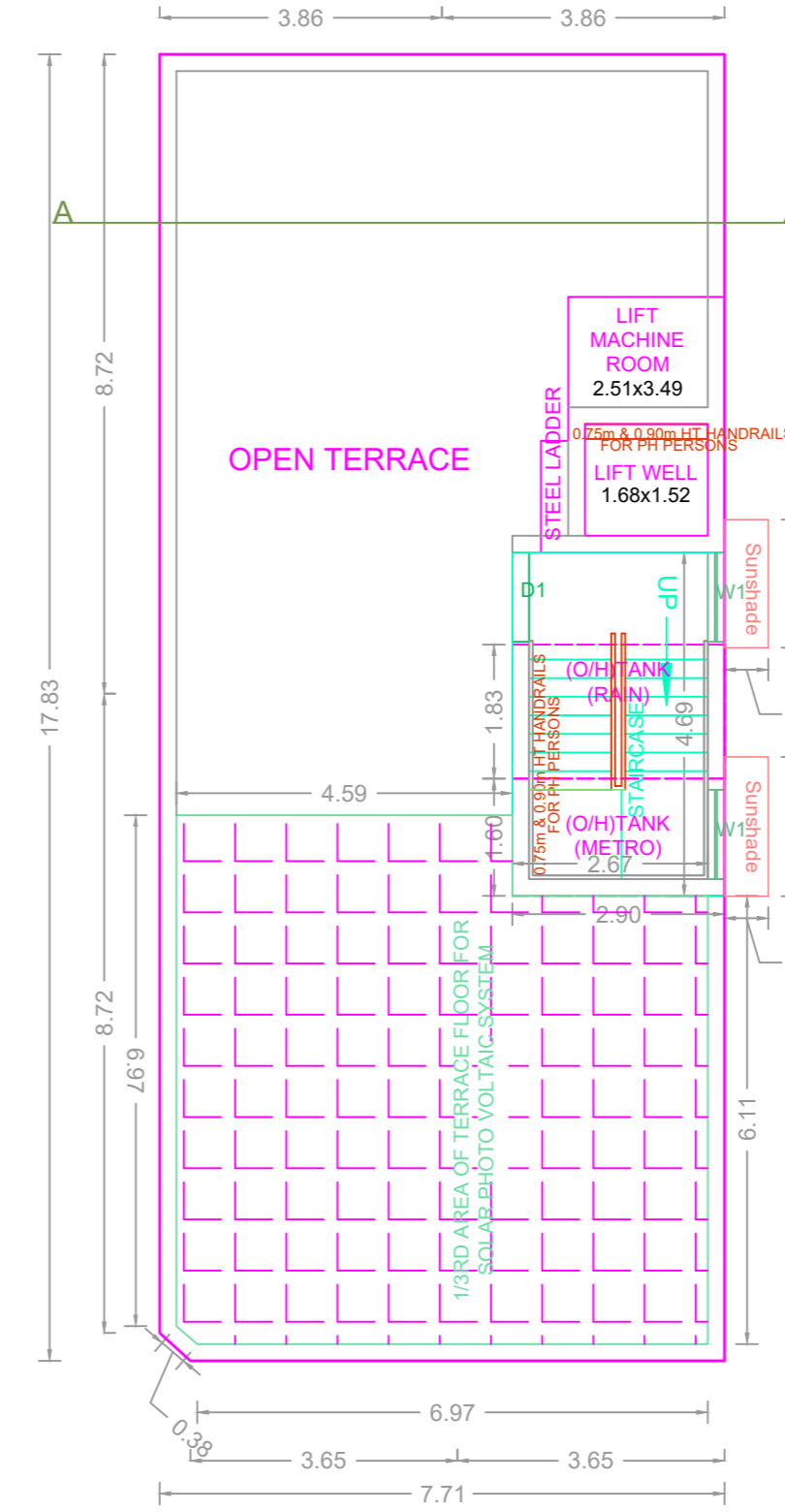
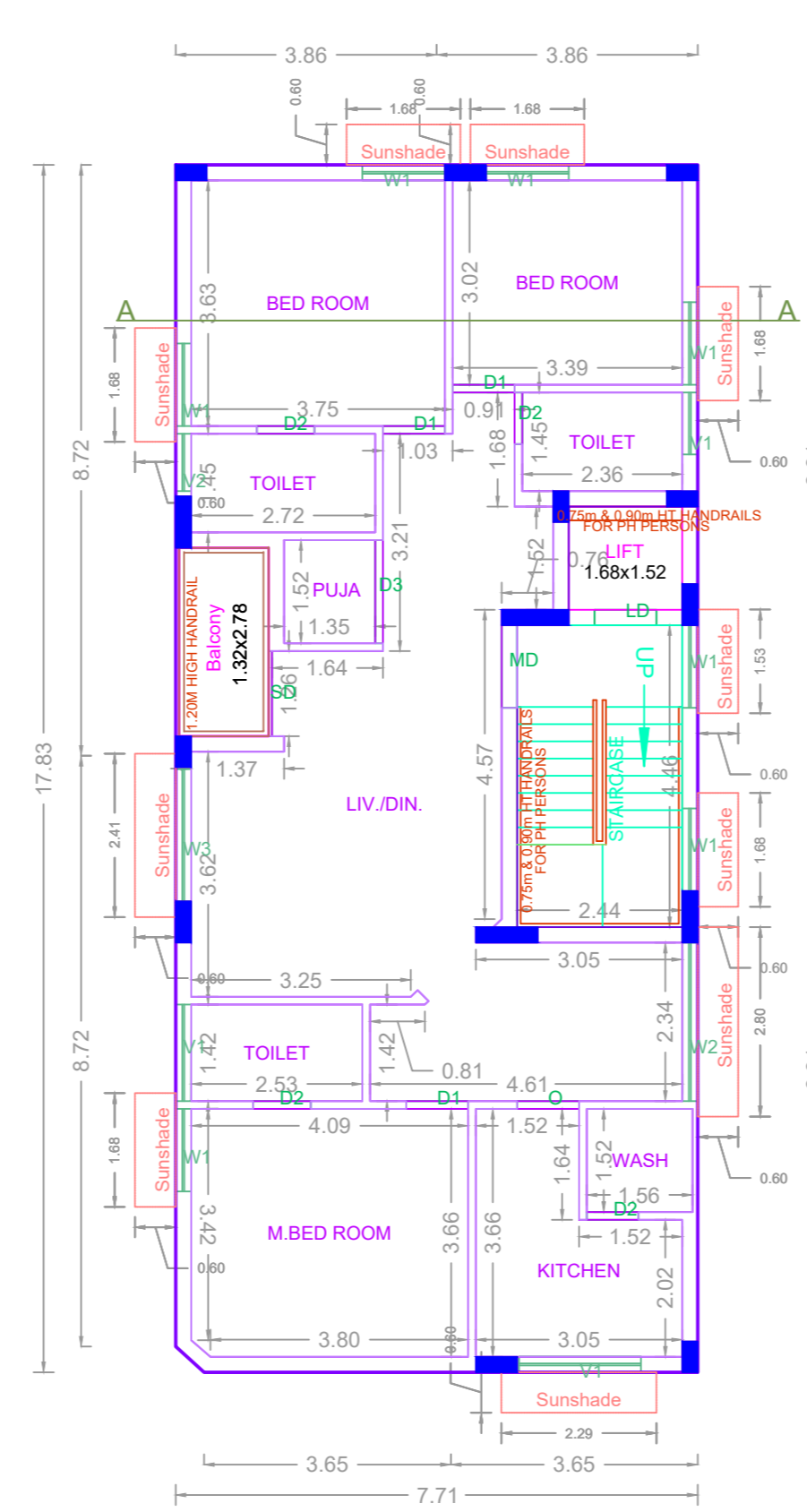
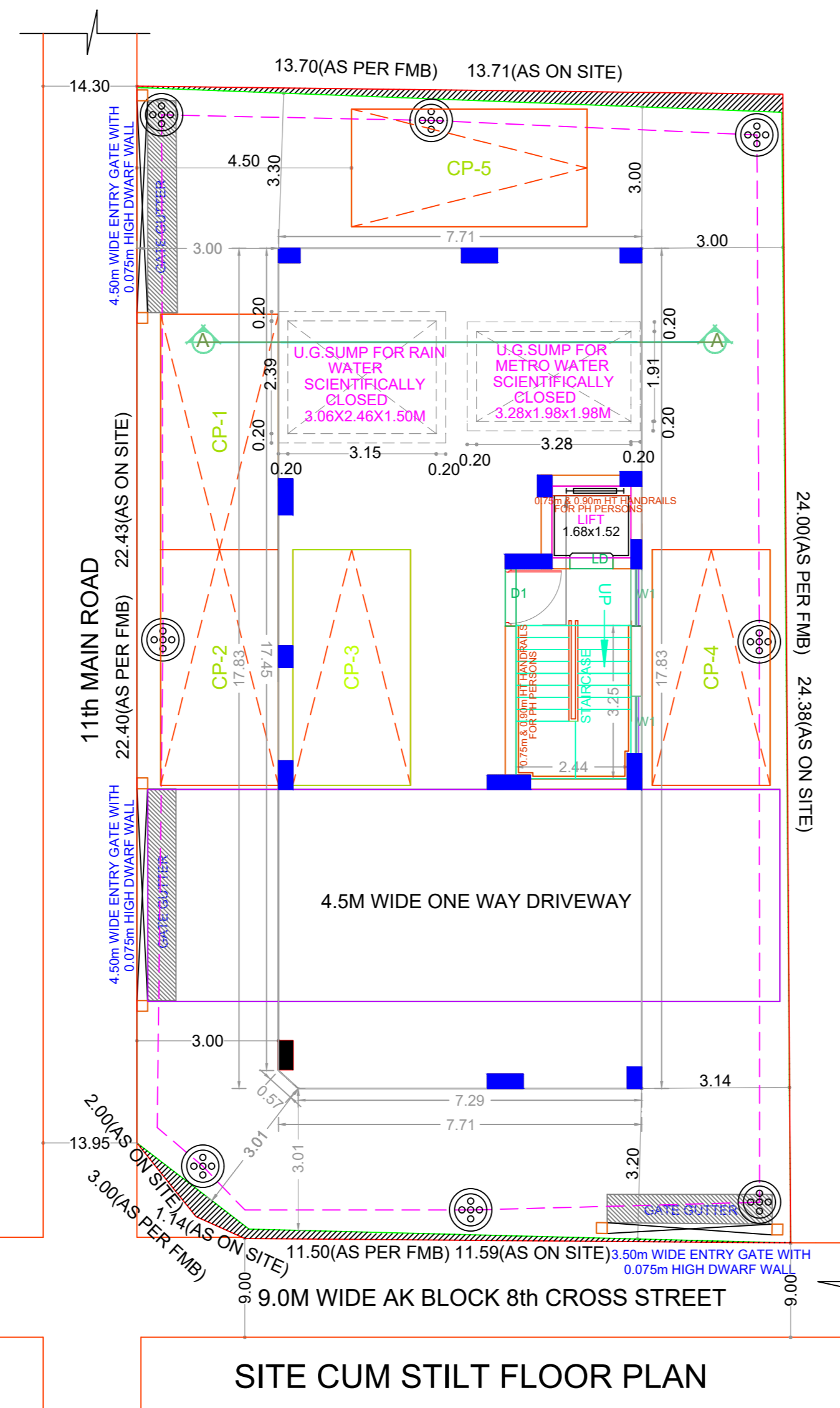
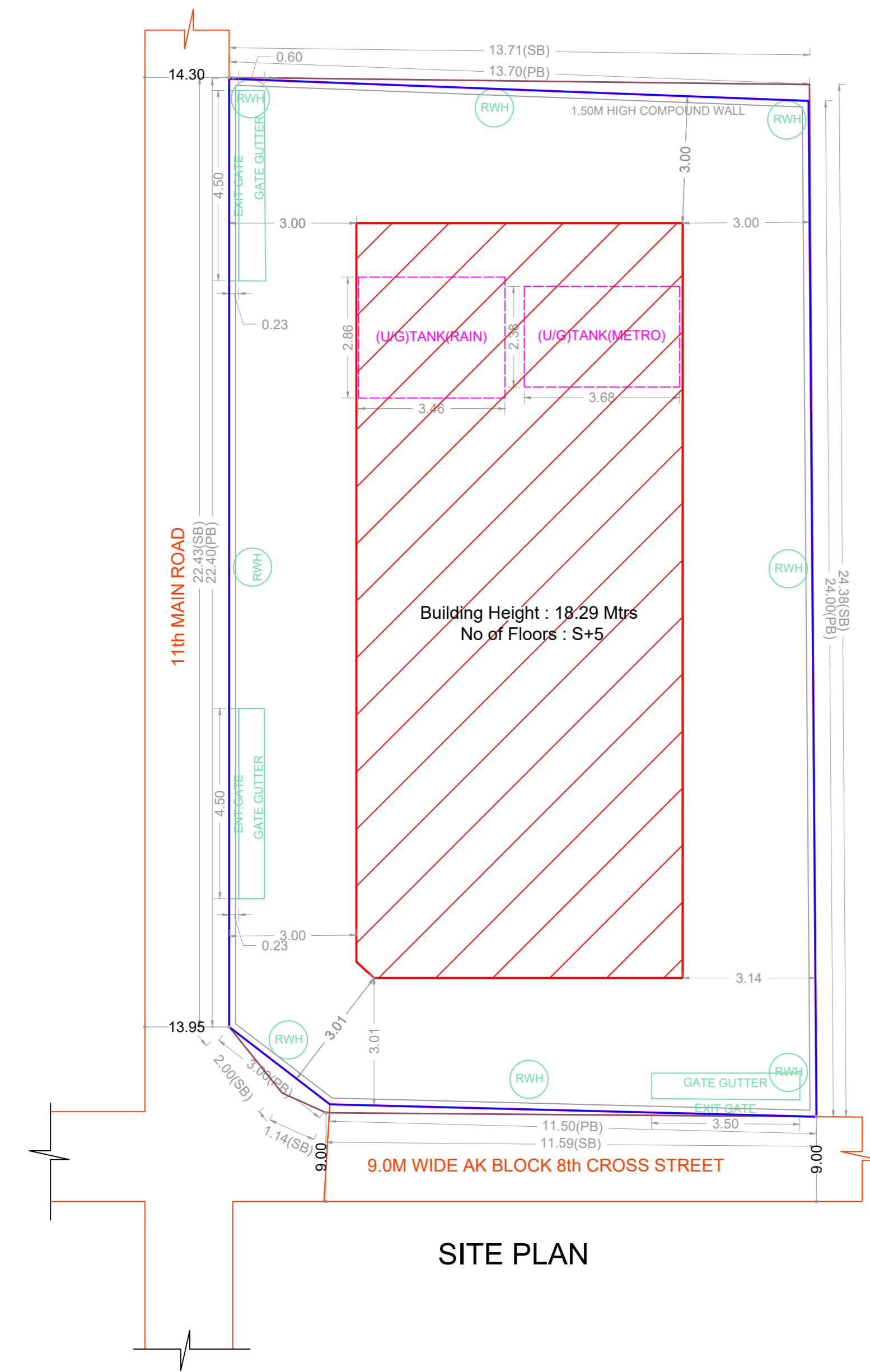

Location plan (Taken as per User Inputs)

**BUILDING WISE FSI STATEMENT**

BUILDING	NO OF SAME BUILDING	FSI AREA				DU	TOTAL FSI AREA
		COMM.	RESI.	IND.	INST.		
A-1 (RESI)		0.00	686.85	0.00	0.00	5	686.85
Total		0.00	686.85	0.00	0.00	5	686.85

**FLOOR WISE FSI STATEMENT: A (RESI)**

FLOORS	FSI AREA				DU	TOTAL FSI AREA
	COMM.	RESI.	IND.	INST.		
STILT PARKING FLOOR	0.00	0.00	0.00	0.00	0	0.00
FIRST FLOOR	0.00	137.37	0.00	0.00	1	137.37
SECOND FLOOR	0.00	137.37	0.00	0.00	1	137.37
THIRD FLOOR	0.00	137.37	0.00	0.00	1	137.37
FOURTH FLOOR	0.00	137.37	0.00	0.00	1	137.37
FIFTH FLOOR	0.00	137.37	0.00	0.00	1	137.37
Terrace	0.00	0.00	0.00	0.00	0	0.00
Total	0.00	686.85	0.00	0.00	5	686.85

**APPROVAL CONDITION**

APPROVAL CONDITION text and scale 1:100.

CHENNAI METROPOLITAN DEVELOPMENT AUTHORITY APPROVED SUBJECT TO THE CONDITIONS MENTIONED IN THIS OFFICE

For (Deputy Planner / Chief Planner / Member-Secretary) High Rise Building / Non High Rise Building This Approval is valid only after building Permit is issued by the concerned Local Body.

QR CODE