

SITE PLAN

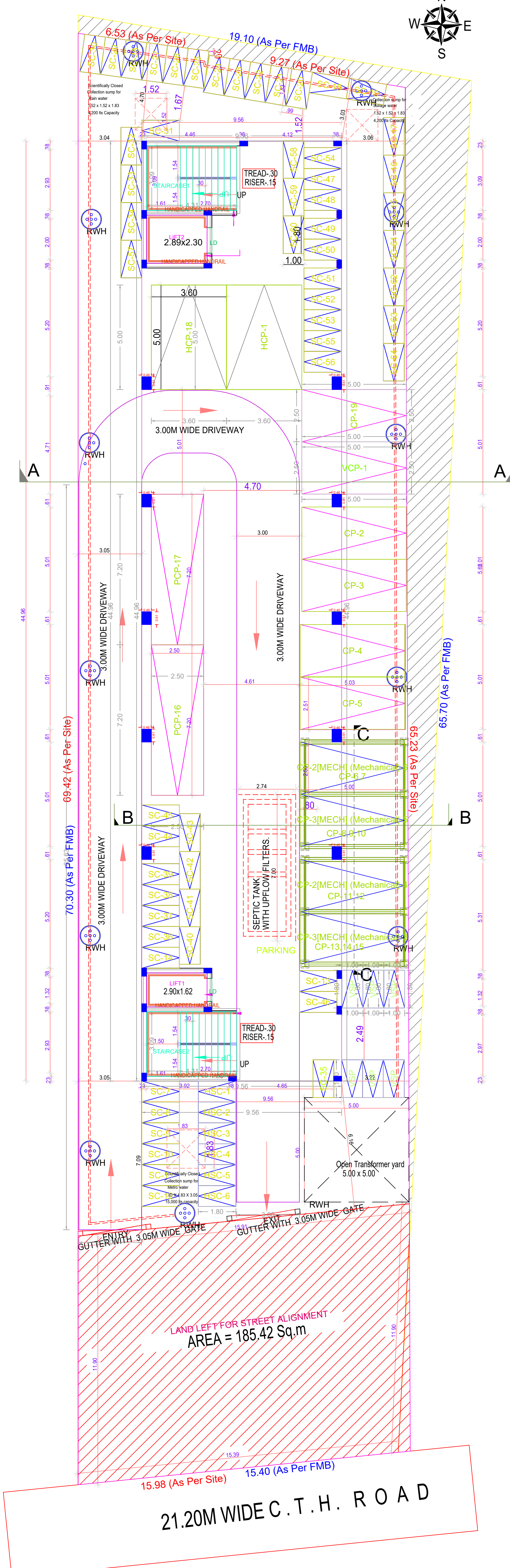

SITE CUM STILT FLOOR PLAN



EAST SIDE ELEVATION

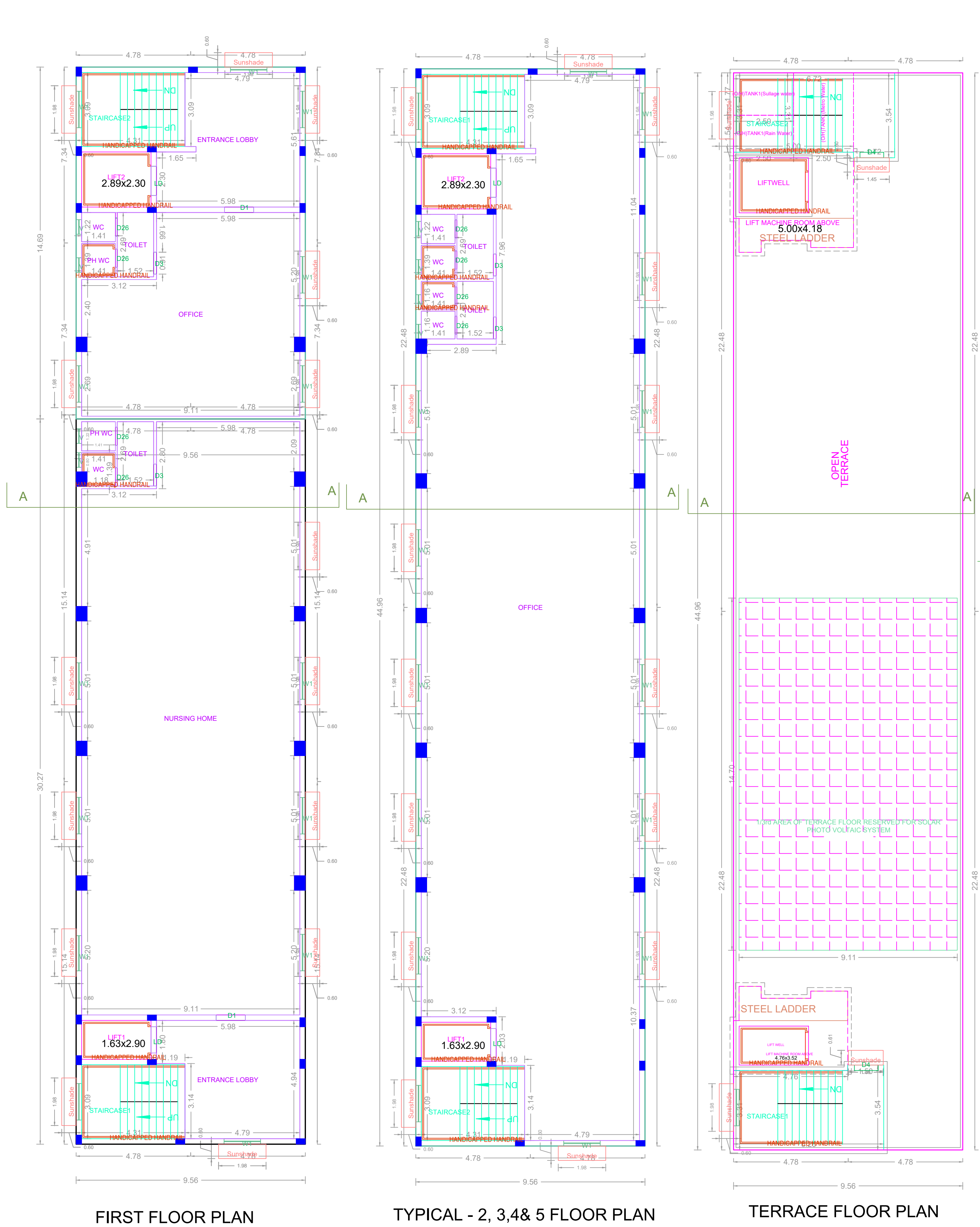

FIRST FLOOR PLAN

TYPICAL - 2, 3, 4 & 5 FLOOR PLAN

TERRACE FLOOR PLAN

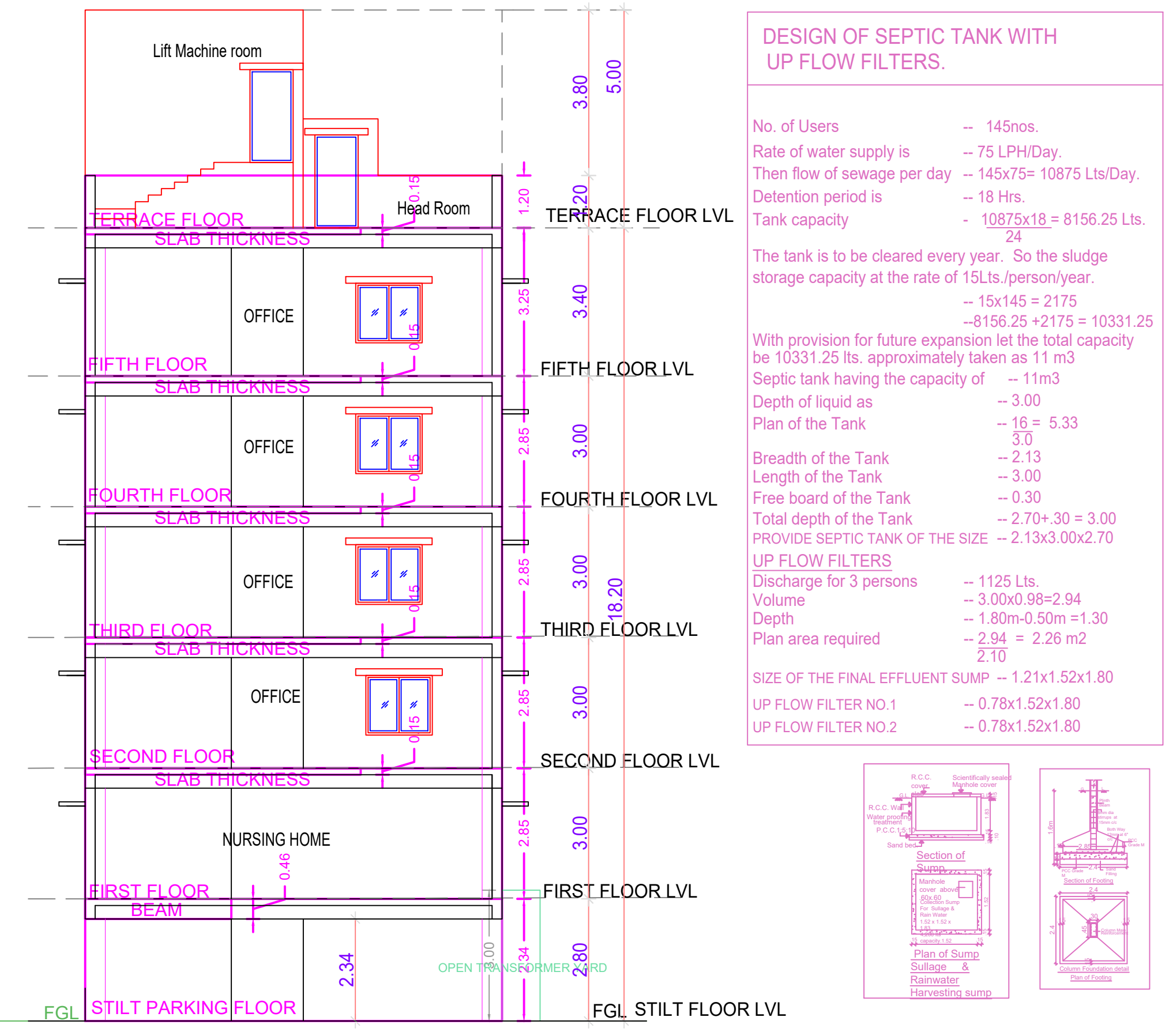

SECTION "AA"

FLOOR WISE FSI STATEMENT: A (BLOCK 1)

FLOORS	FSI AREA				DU	TOTAL FSI AREA
	COMM.	RESI.	IND.	INST.		
STILT PARKING FLOOR	0.00	0.00	0.00	0.00	0	0.00
FIRST FLOOR	429.94	0.00	0.00	0.00	0	429.94
SECOND FLOOR	429.94	0.00	0.00	0.00	0	429.94
THIRD FLOOR	429.94	0.00	0.00	0.00	0	429.94
FOURTH FLOOR	429.94	0.00	0.00	0.00	0	429.94
FIFTH FLOOR	429.94	0.00	0.00	0.00	0	429.94
Terrace	0.00	0.00	0.00	0.00	0	0.00
Total	2149.70	0.00	0.00	0.00	0	2149.70

BUILDING WISE FSI STATEMENT

BUILDING	NO OF SAME BUILDING	FSI AREA				DU	TOTAL FSI AREA
		COMM.	RESI.	IND.	INST.		
A-1 (BLOCK 1)	1	2149.70	0.00	0.00	0.00	0	2149.70
Total		2149.70	0.00	0.00	0.00	0	2149.70

APPROVAL CONDITION

SCALE: 1:100

CHENNAI METROPOLITAN DEVELOPMENT AUTHORITY

APPROVED

SUBJECT TO THE CONDITIONS MENTIONED IN THIS OFFICE

PLAN SHOWING THE PROPOSED CONSTRUCTION OF STILT FLOOR (PARKING PART) TWO LEVELS PIT PUZZLE PARKING PART) + 5 FLOORS COMMERCIAL BUILDING (1ST FLOOR NURSING HOME PART & OFFICE PART AND 2 TO 5 FLOORS OFFICE) HEIGHT: 18.20M C.T.H. ROAD THIRUMULLAVOYAL, CHENNAI, COMPRISED IN OLD S.NO. 2813A PART, 2813A1A2, 2823A1A PART, T.S.NO: 13, BLOCK NO. 29, WARD D OF THIRUMULLAVOYAL VILLAGE WITH IN THE LIMIT OF AVADI MUNICIPAL CORPORATION.

A) AREA STATEMENT	SQ.M.
AREA AS PER PATTA	1170.00
AREA AS PER DOCUMENT	1133.11
AREA CONSIDERED FOR FSI	1133.11
STREET ALIGNMENT/ ROAD WIDENING/LINK ROAD	185.42
OSR AREA	0.00
TOTAL FSI AREA	2149.70
FSI FACTOR	1.897
COVERAGE AREA (PERCENTAGE %)	NA

A) PARKING STATEMENT		
VEHICLE	REQUIRED	PROVIDED
LORRY	0	0
CAR	20	20
TWO WHEELER	67	70
CYCLE	0	0

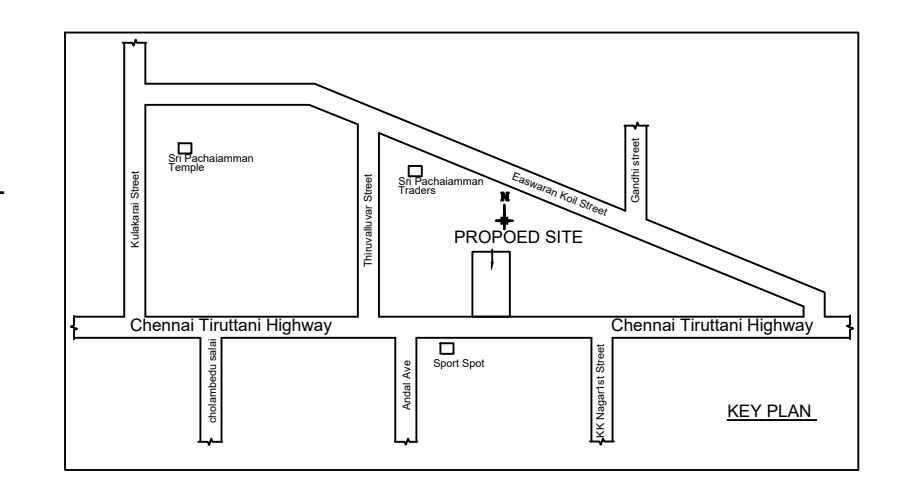

Location plan (Taken as per User Inputs)

DESIGN OF SEPTIC TANK WITH UP FLOW FILTERS.

No. of Users - 145nos.
 Rate of water supply is - 75 LPH/Day.
 Thin flow of sewage per day - 145x75 = 10875 Lts/Day.
 Detention period is - 18 Hrs.
 Tank capacity - 10875x18 = 6156.25 Lts.
 The tank is to be cleared every year. So the sludge storage capacity at the rate of 15Lts/person/year - 15x145 = 2175
 = 4156.25 - 2175 = 1031.25
 be 1031.25 Lts. approximately taken as 11 m³
 Septic tank having the capacity of - 11m³
 Depth of liquid as - 3.00
 Breadth of the Tank - 1.5 = 5.33
 Length of the Tank - 2.13
 Free board of the Tank - 3.00
 Total depth of the Tank - 2.70+3.00 = 3.00
 PROVIDE SEPTIC TANK OF THE SIZE - 2.13x3.00x2.70
 UP FLOW FILTERS
 Discharge for 3 persons - 1125 Lts.
 Volume - 3.00x0.95x2.94 = 1.80m³ = 1.30
 Depth - 2.94 = 2.26 m²
 Plan area required - 2.10
 SIZE OF THE FINAL EFFLUENT SUMP - 1.21x1.52x1.80
 UP FLOW FILTER NO.1 - 0.78x1.52x1.80
 UP FLOW FILTER NO.2 - 0.78x1.52x1.80

