

PLAN SHOWING THE PROPOSED CONSTRUCTION OF STILT/PIT PUZZLE (PARKING) +2 FLOORS SHOP COMMERCIAL BUILDING DOOR NO: 847/3 (273) THIRUVOTTIYUR HIGH ROAD, OLD WASHERMENPET, CHENNAI 600021, T.S.NO:3721/143 BLOCK NO:55, WARD-01, TONDAIRPET TOWN (PART -3) TONDAIRPET TALUK WITH IN GREATER CHENNAI CORPORATION -ZONE 04, CORPORATION DIVISION 42.

A) AREA STATEMENT		SQ.M.
AREA AS PER PATTA		473.50
AREA AS PER DOCUMENT		473.50
AREA CONSIDERED FOR FSI		473.50
STREET ALIGNMENT/ ROAD WIDENING/LINK ROAD		32.83
OSR AREA		0.00
TOTAL FSI AREA		674.24
FSI FACTOR		1.424
COVERAGE AREA (PERCENTAGE %)		NA

A) PARKING STATEMENT		
VEHICLE	REQUIRED	PROVIDED
LORRY	0	0
CAR	10	10
TWO WHEELER	10	10
CYCLE	0	0

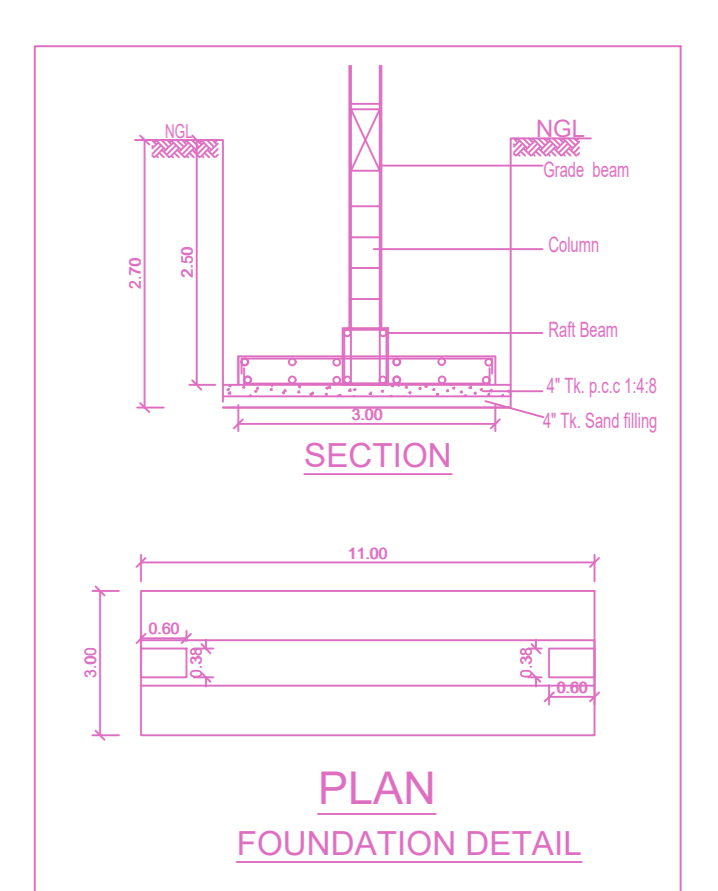
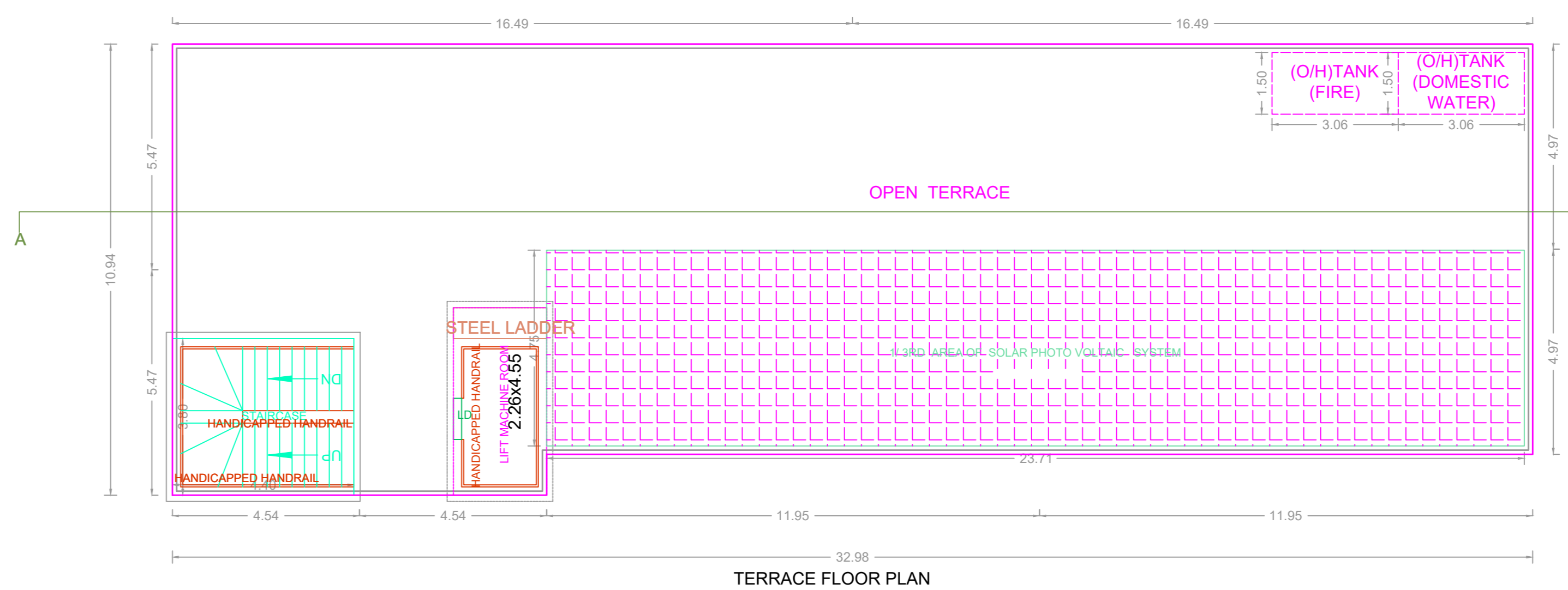
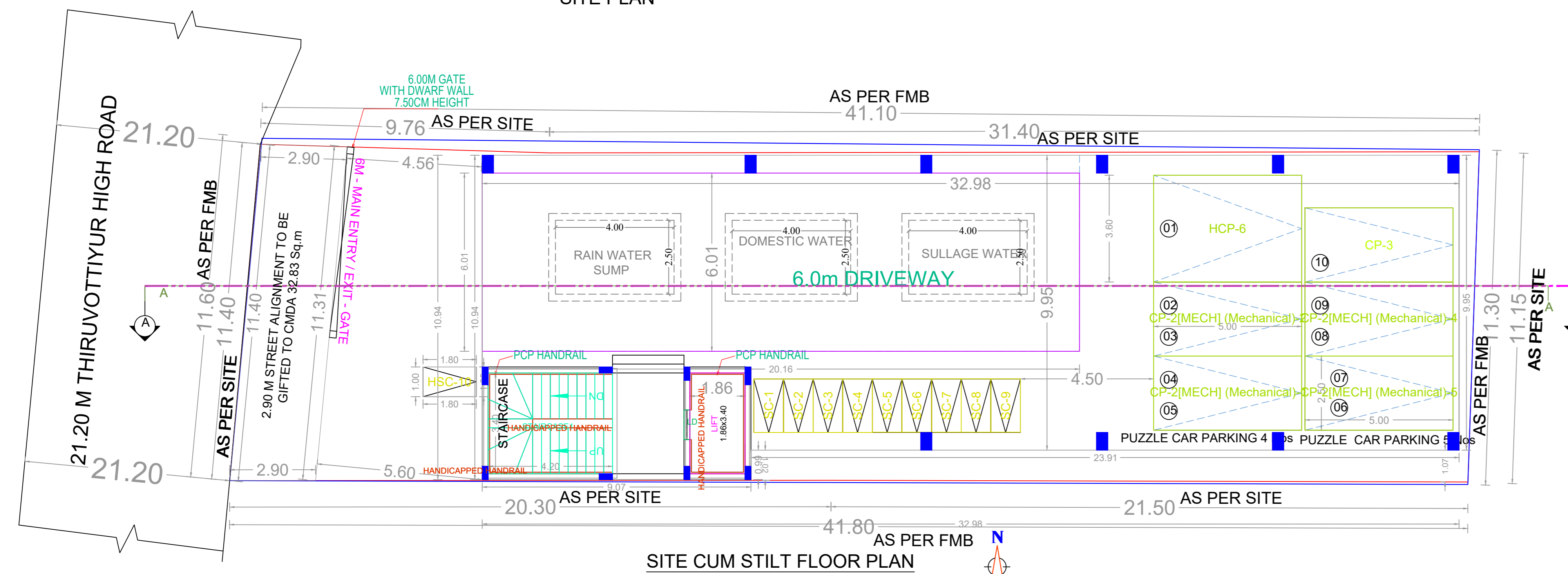
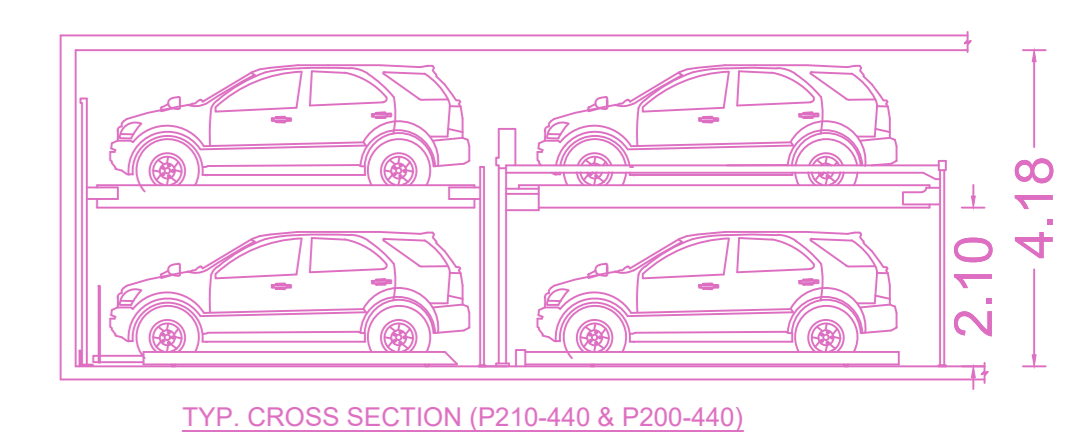
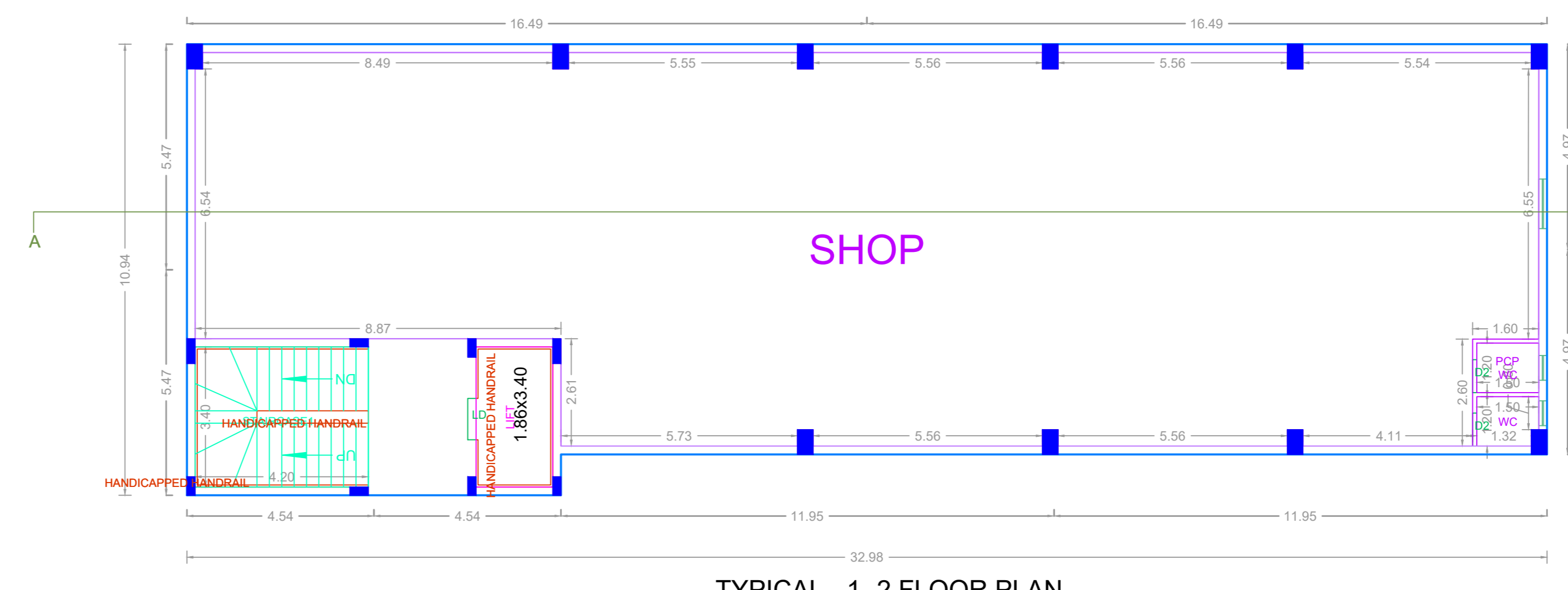
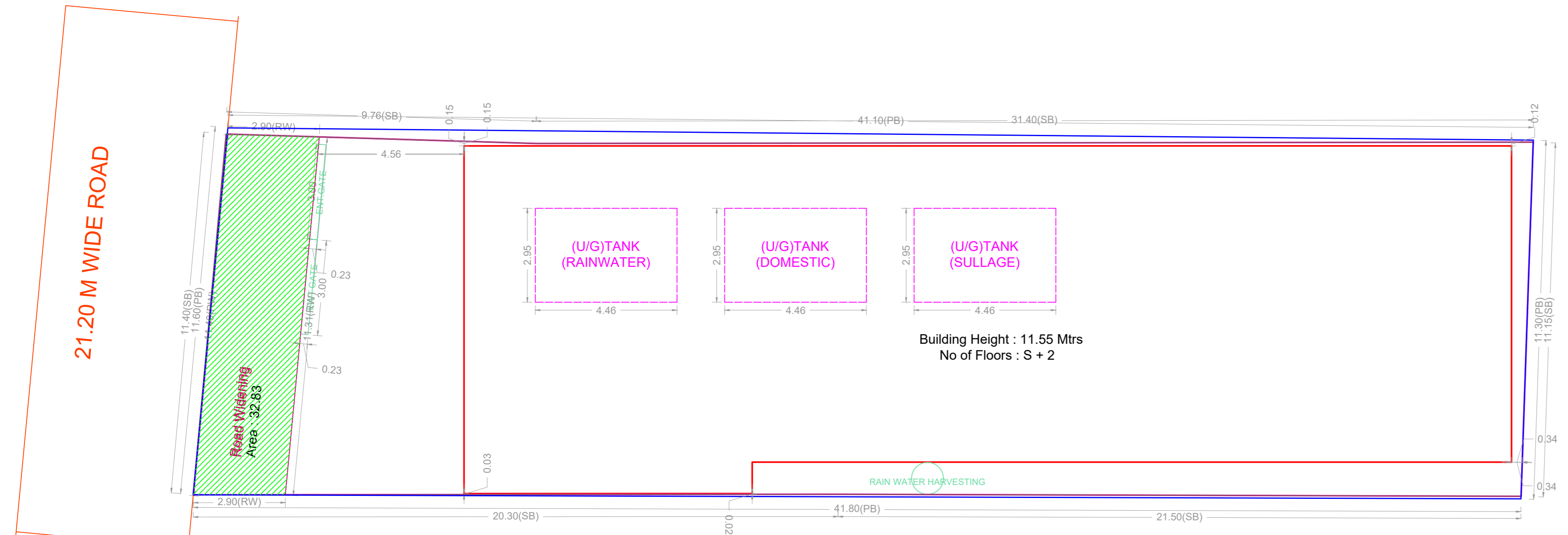

FLOOR WISE FSI STATEMENT: NHRB (COMM)

FLOORS	COMM.	RESI.	IND.	SPEC.	DU	TOTAL FSI AREA
Terrace	0.00	0.00	0.00	0.00	0	0.00
SECOND FLOOR	337.12	0.00	0.00	0.00	0	337.12
FIRST FLOOR	337.12	0.00	0.00	0.00	0	337.12
STILT PARKING FLOOR	0.00	0.00	0.00	0.00	0	0.00
Total	674.24	0.00	0.00	0.00	0	674.24

BUILDING WISE FSI STATEMENT

BUILDING	NO OF SAME BUILDING	COMM.	RESI.	IND.	SPEC.	DU	TOTAL FSI AREA
NHRB-1 (COMM)		674.24	0.00	0.00	0.00	0	674.24
Total		674.24	0.00	0.00	0.00	0	674.24

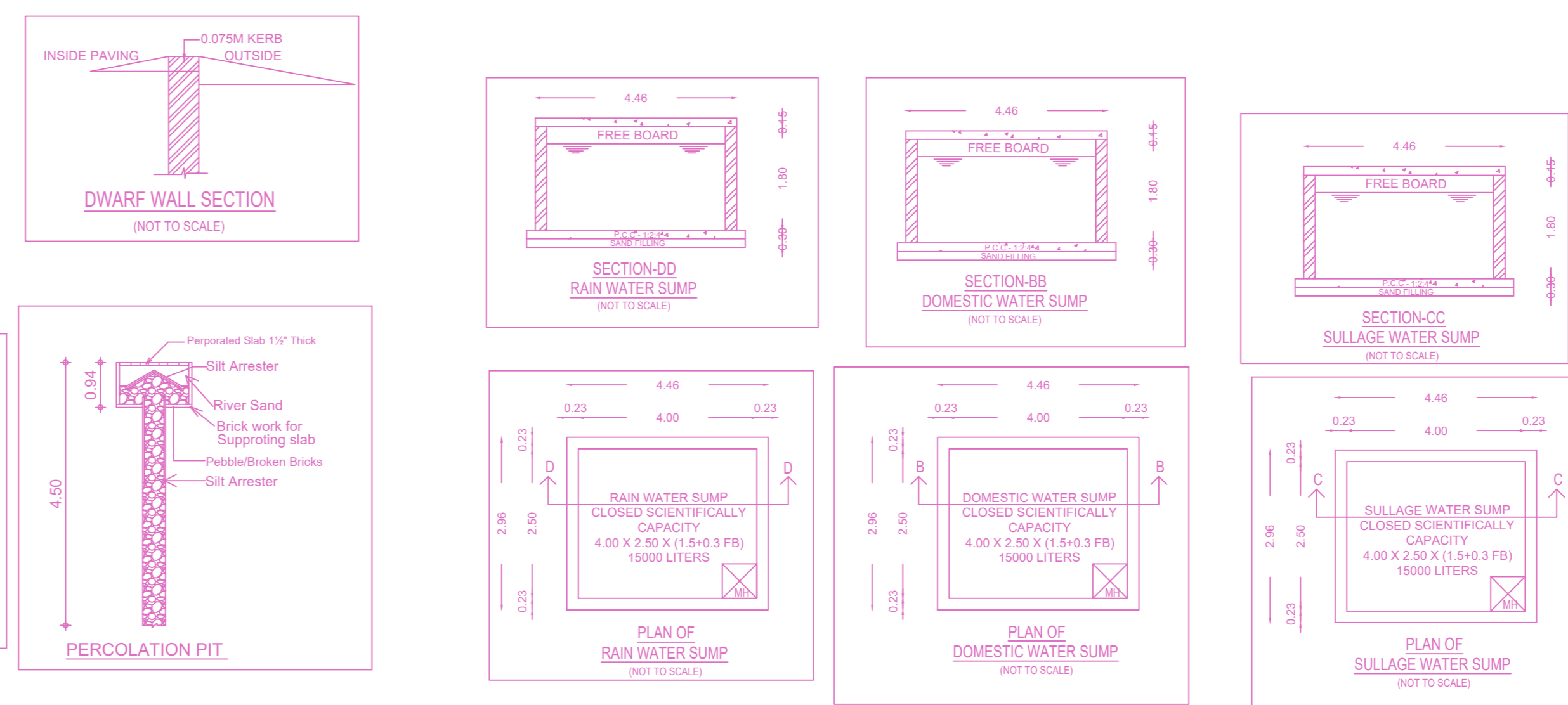
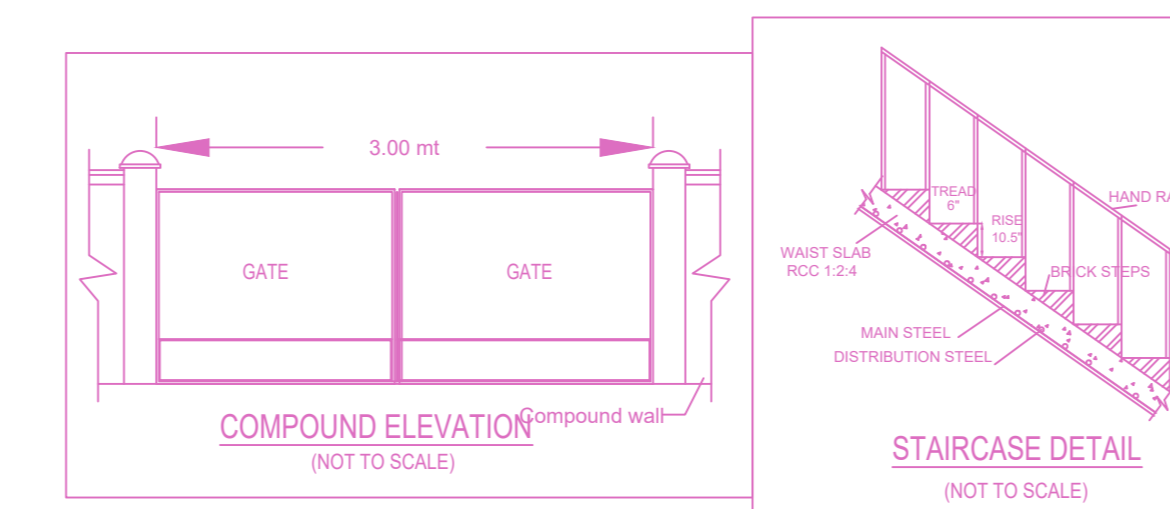
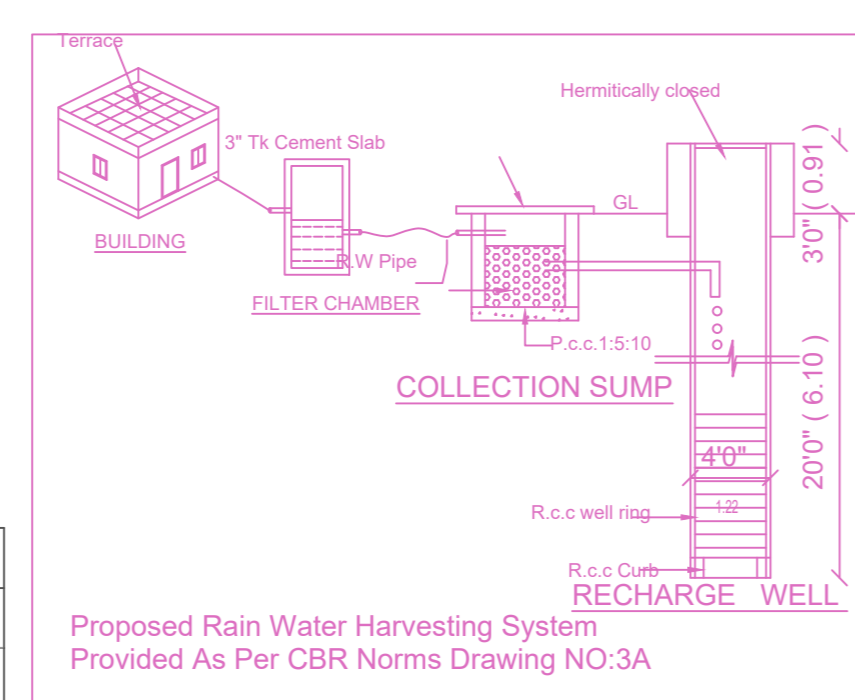

APPROVAL CONDITION

SCALE 1:100

CHENNAI METROPOLITAN DEVELOPMENT AUTHORITY
APPROVED

SUBJECT TO THE CONDITIONS MENTIONED IN THIS OFFICE

For (Deputy Planner / Chief Planner / Member-Secretary)
High Rise Building / Non High Rise Building
This Approval is valid only after building Permit is issued by the concerned Local Body.