

PLAN SHOWING THE PROPOSED CONSTRUCTION OF STILT + 5 FLOORS RESIDENTIAL BUILDING WITH 10 DWELLING UNITS AT PLOT NO.2570, NEW DOOR NO.16, OLD NO.A3-106, A1 BLOCK 4TH STREET, ANNA NAGAR, CHENNAI-600040, COMPRISED IN T.S.NO.206, BLOCK NO.1C OF MADHAVANKARAI TOWN, GREATER CHENNAI CORPORATION, DIVISION-100, ZONE-08.

A) AREA STATEMENT	SQ.M
AREA AS PER PATTA	529.00
AREA AS PER DOCUMENT	526.86
AREA CONSIDERED FOR FSI	526.86
STREET ALIGNMENT/ ROAD WIDENING/LINK ROAD	0.00
OSR AREA	0.00
TOTAL FSI AREA	1348.08
FSI FACTOR	2.599
COVERAGE AREA (PERCENTAGE %)	NA

A) PARKING STATEMENT	REQUIRED	PROVIDED
VEHICLE		
LORRY	0	0
CAR	11	11
TWO WHEELER	0	0
CYCLE	0	0

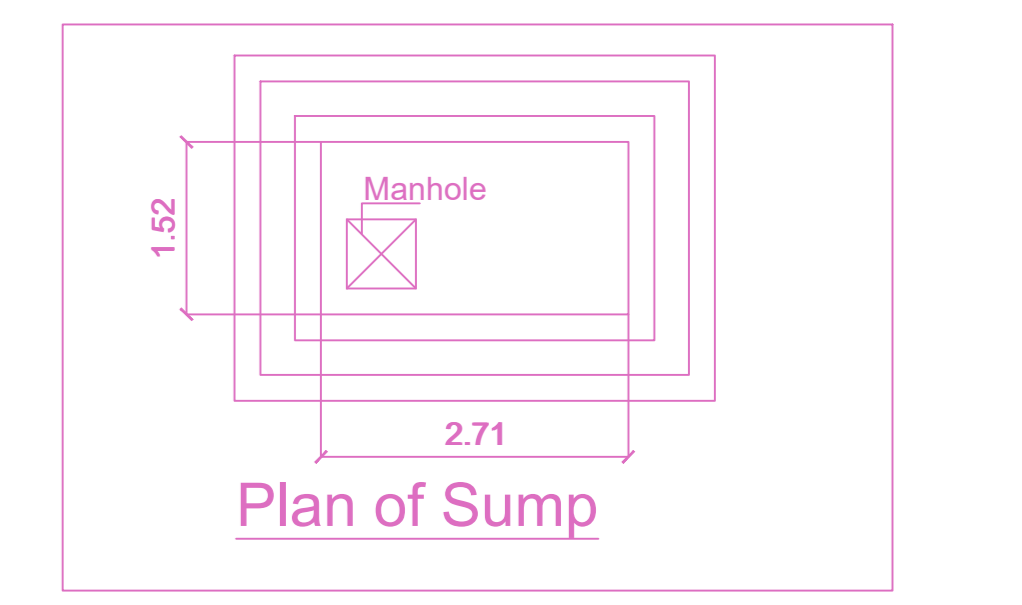
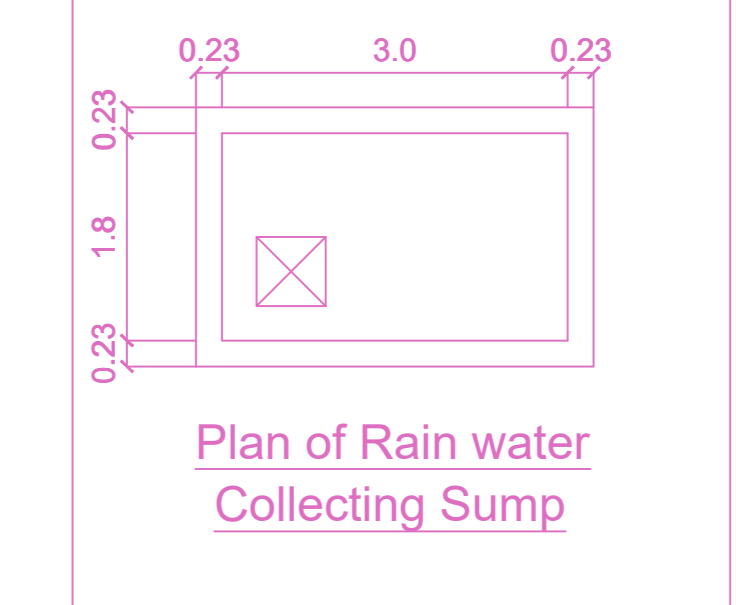
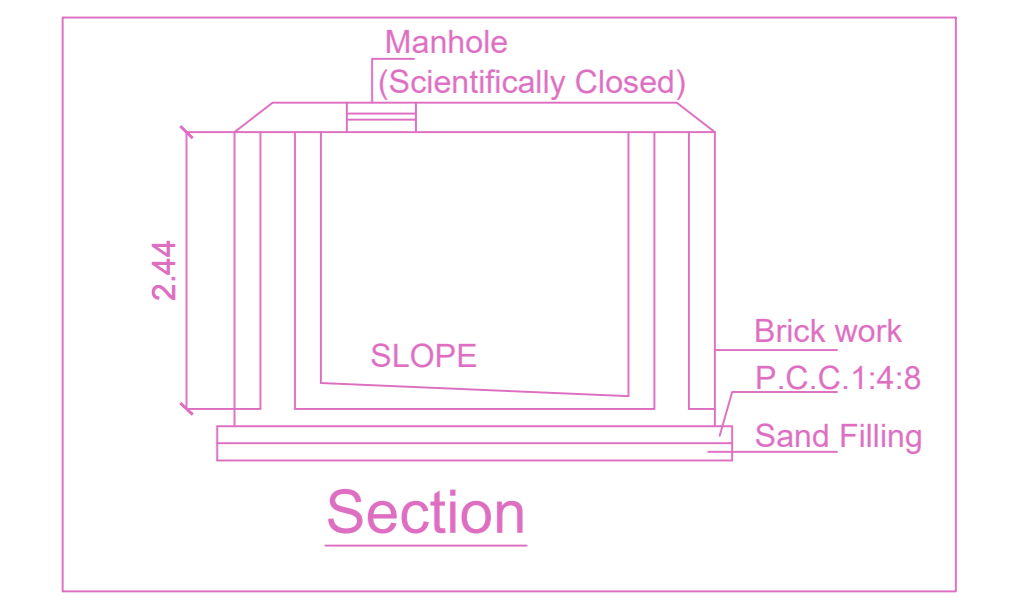
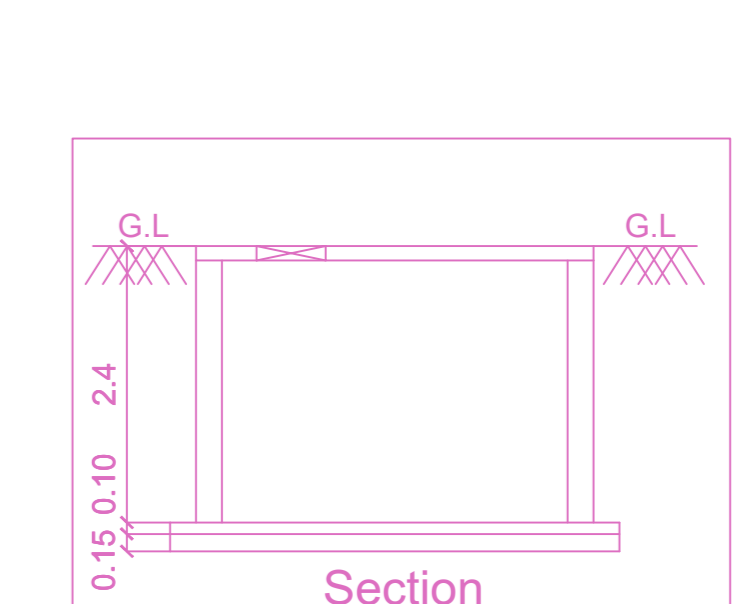
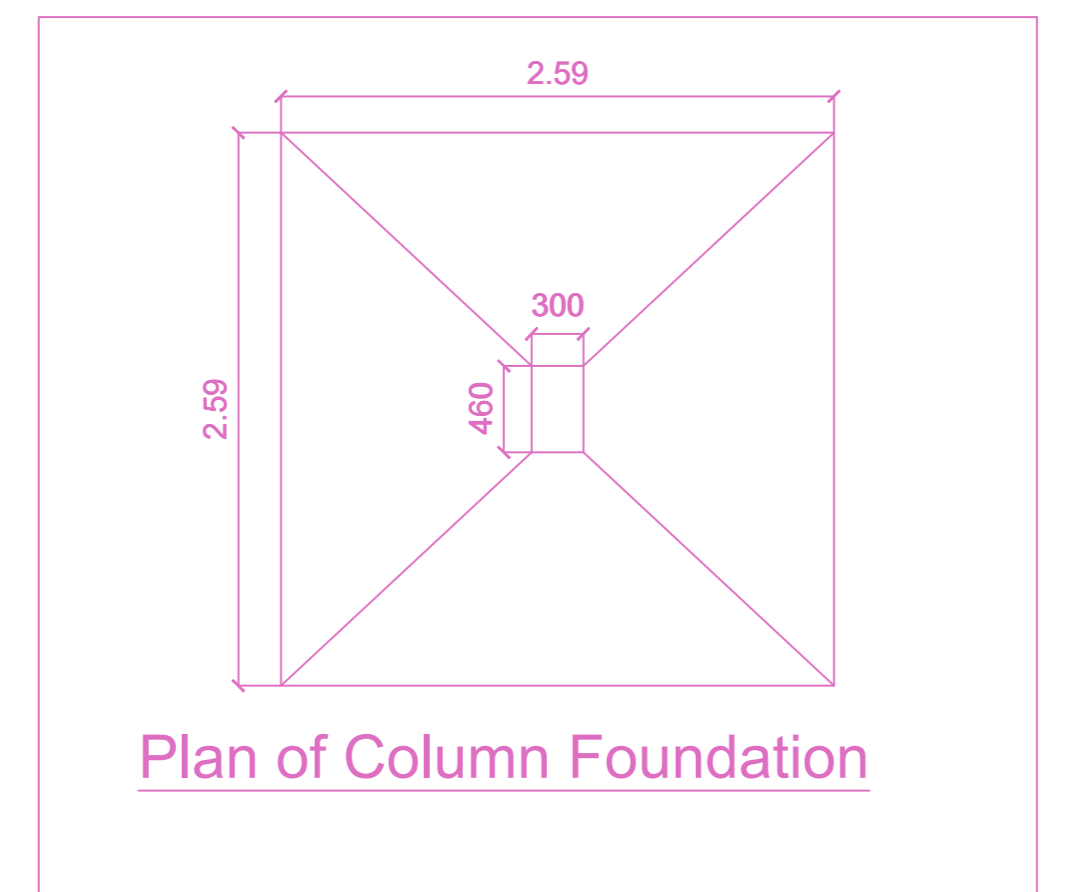
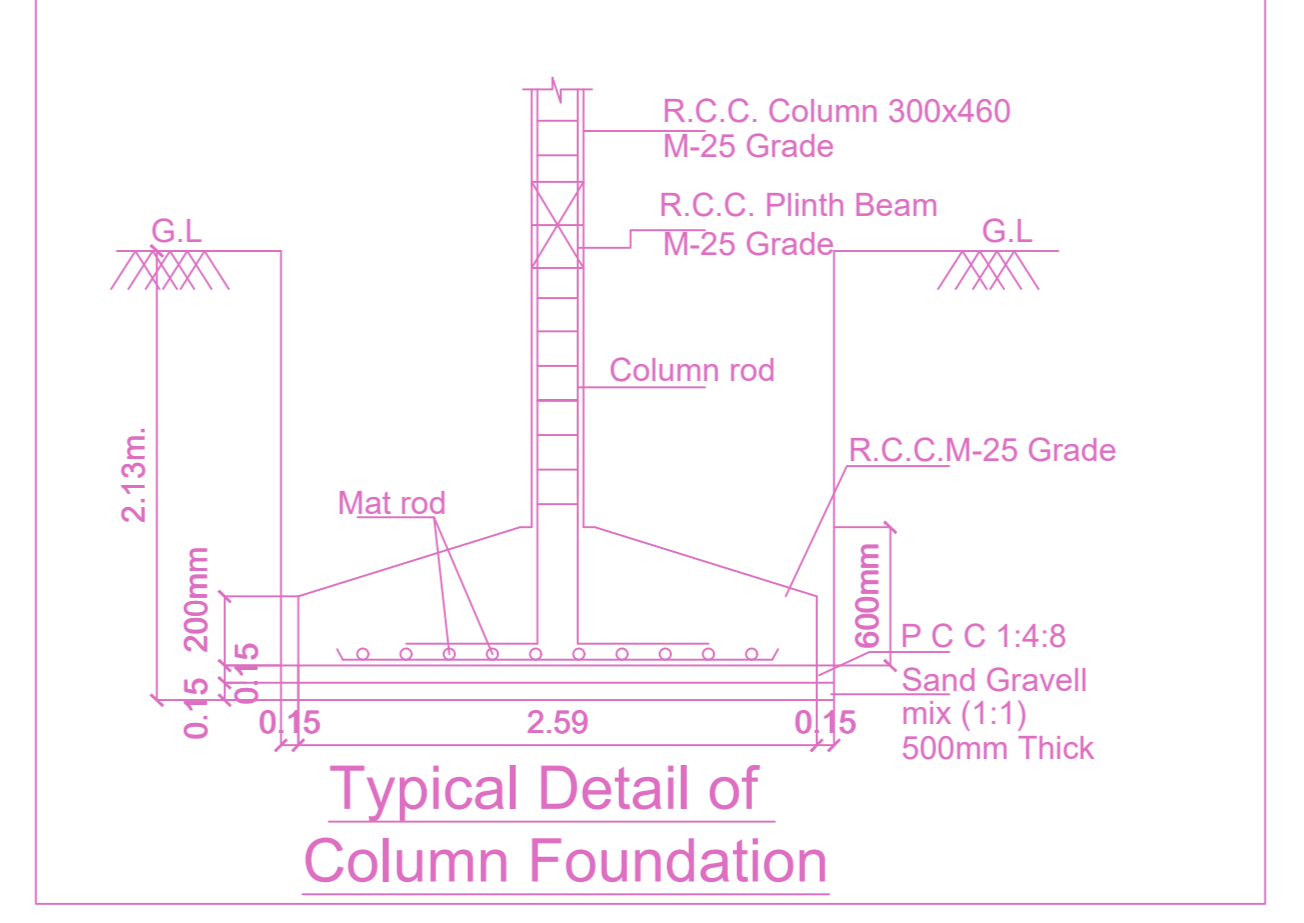
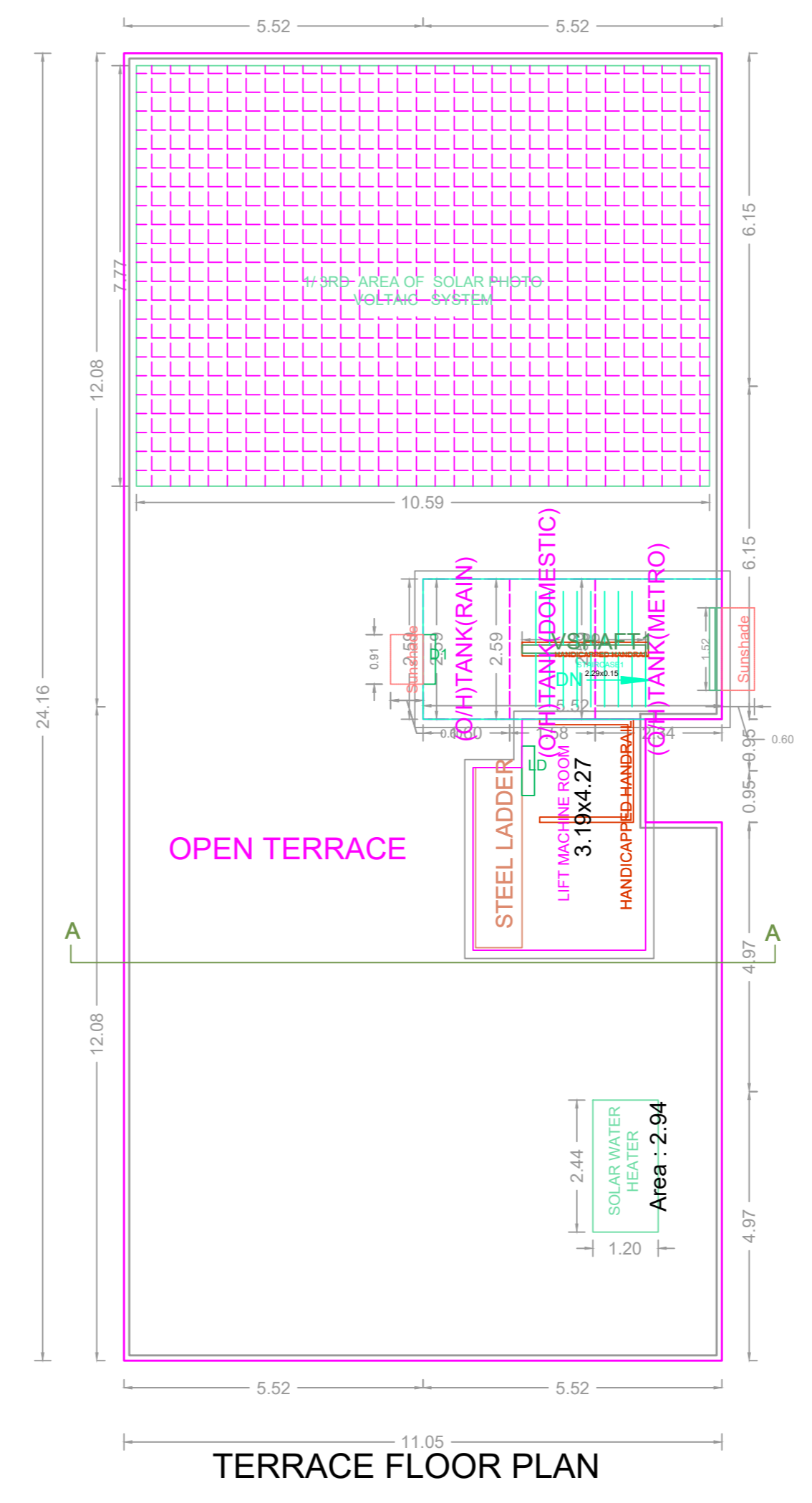
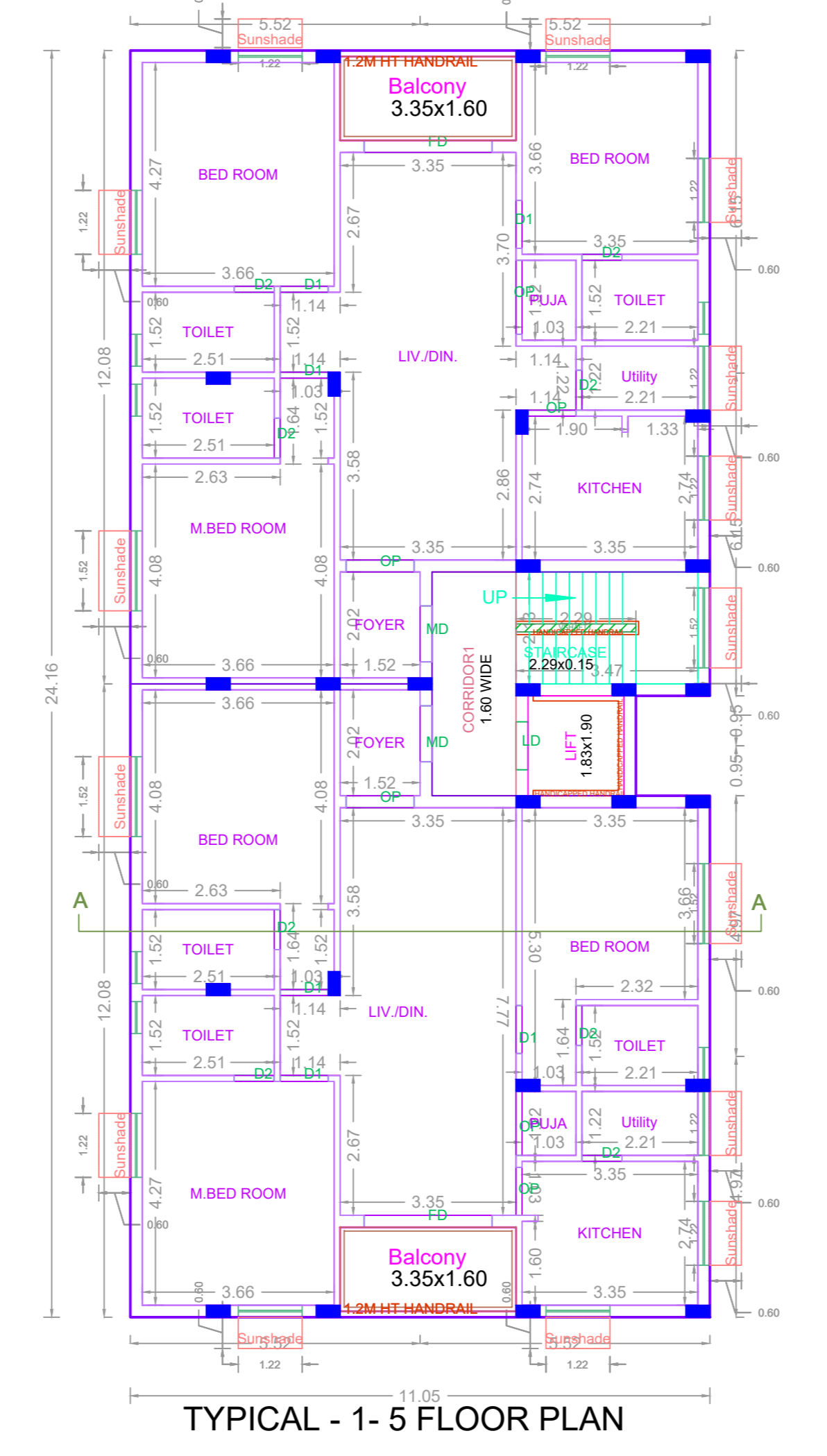
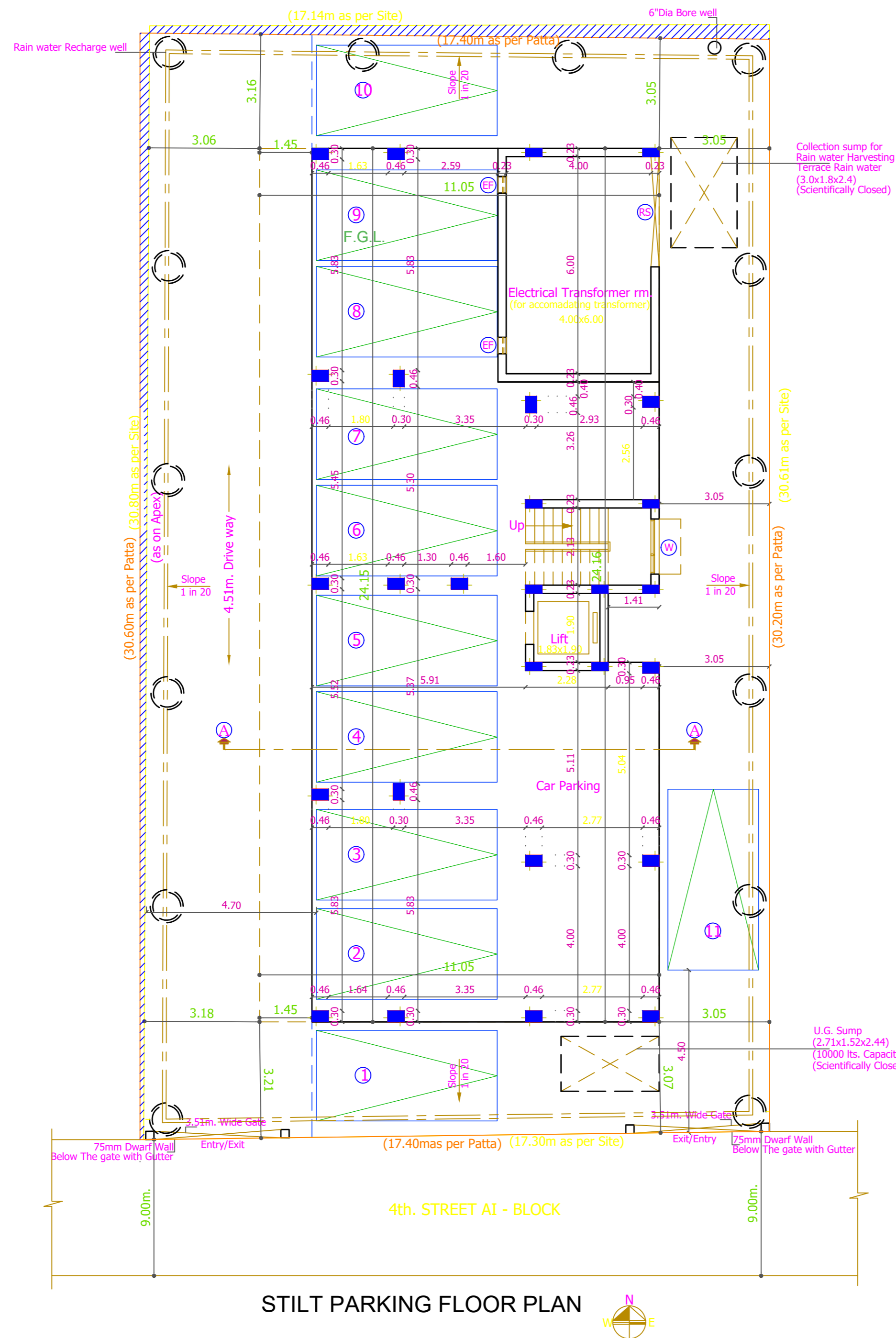
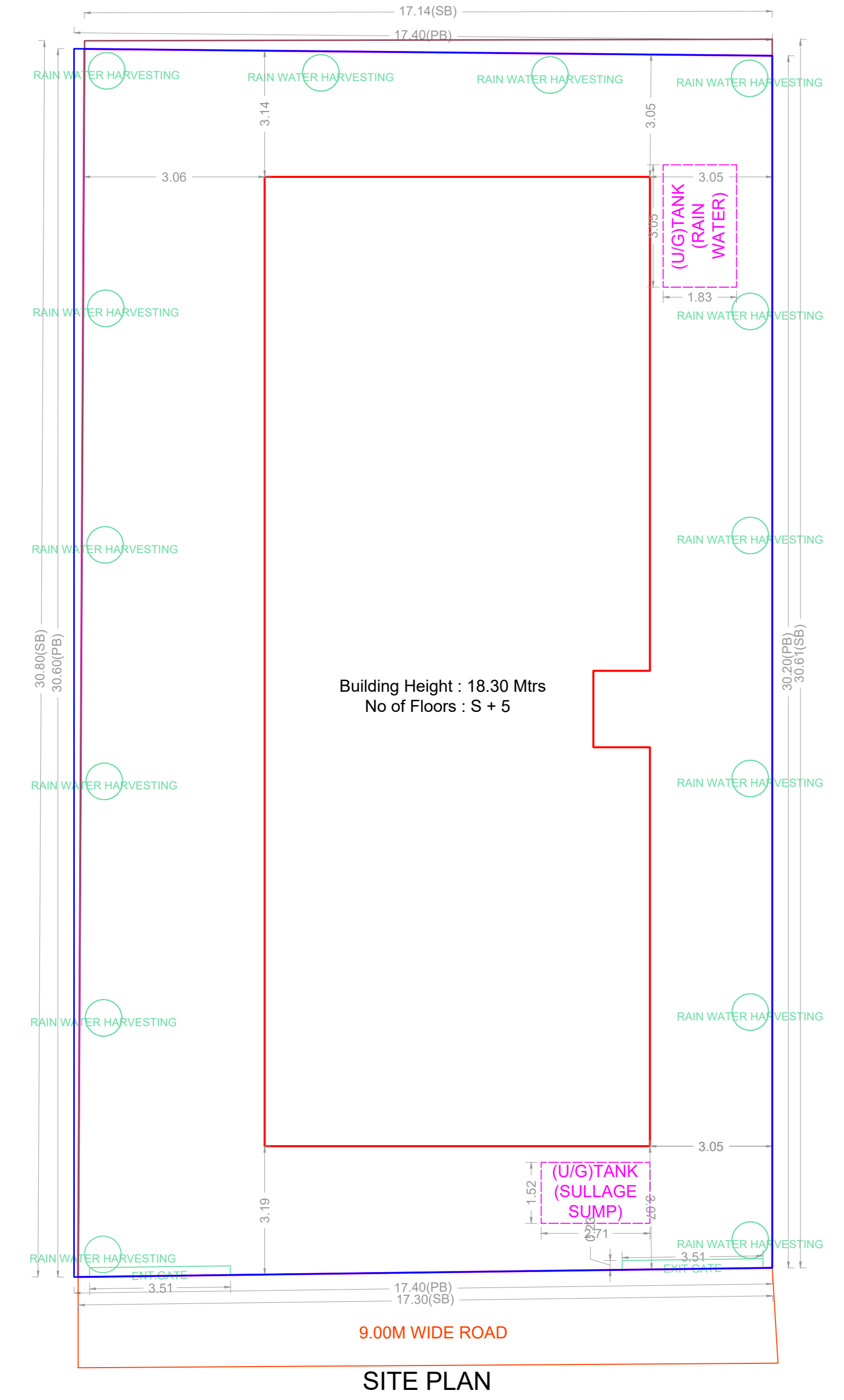
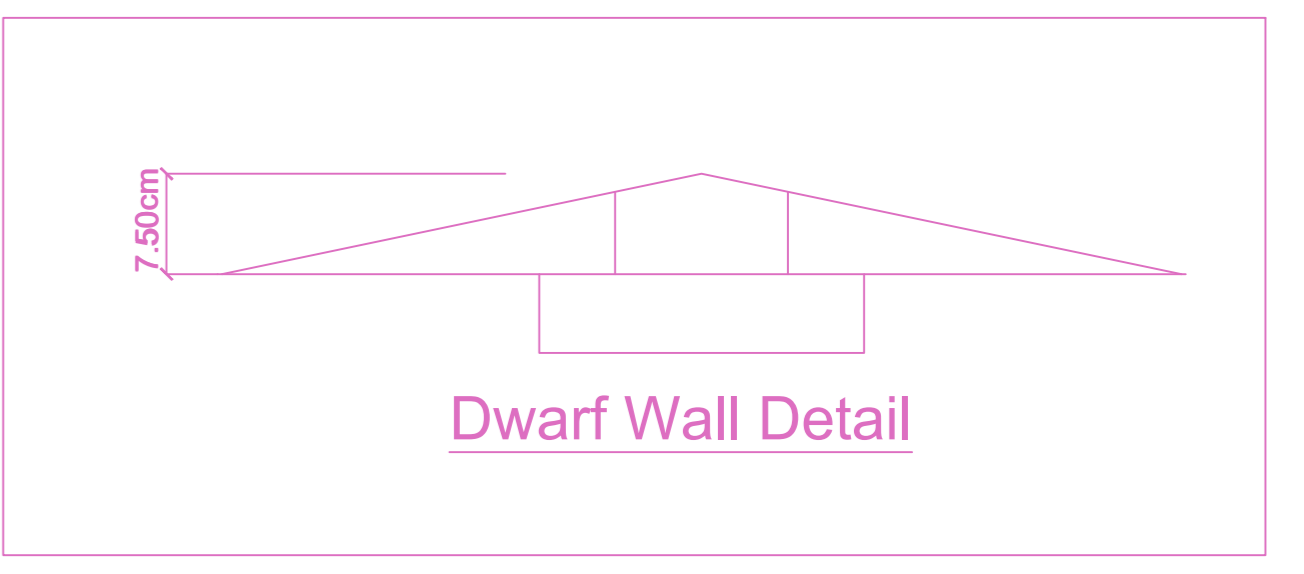

FLOOR WISE FSI STATEMENT: BLOCK (1)

FLOORS	FSI AREA				DU	TOTAL FSI AREA
	COMM.	RESI.	IND.	SPEC.		
Terrace	0.00	0.00	0.00	0.00	0	0.00
FIFTH FLOOR	0.00	263.86	0.00	0.00	2	263.86
FOURTH FLOOR	0.00	263.86	0.00	0.00	2	263.86
THIRD FLOOR	0.00	263.86	0.00	0.00	2	263.86
SECOND FLOOR	0.00	263.86	0.00	0.00	2	263.86
FIRST FLOOR	0.00	263.86	0.00	0.00	2	263.86
STILT PARKING FLOOR	0.00	28.78	0.00	0.00	0	28.78
Total	0.00	1348.08	0.00	0.00	10	1348.08

BUILDING WISE FSI STATEMENT

BUILDING	NO OF SAME BUILDING	FSI AREA				DU	TOTAL FSI AREA
		COMM.	RESI.	IND.	SPEC.		
BLOCK-1 (1)	1	0.00	1348.08	0.00	0.00	10	1348.08
Total		0.00	1348.08	0.00	0.00	10	1348.08

APPROVAL CONDITION

SCALE: 1:100

CHENNAI METROPOLITAN DEVELOPMENT AUTHORITY

APPROVED

SUBJECT TO THE CONDITIONS MENTIONED IN THIS OFFICE

KEY NO. 0788

QR CODE

This Planning Permission issued under New Rule 74C(2)(b), 2016 is valid only for the purpose of the project mentioned in the plan and is not transferable. New Rule 74C(2)(b) of 2016.