

ELEVATION

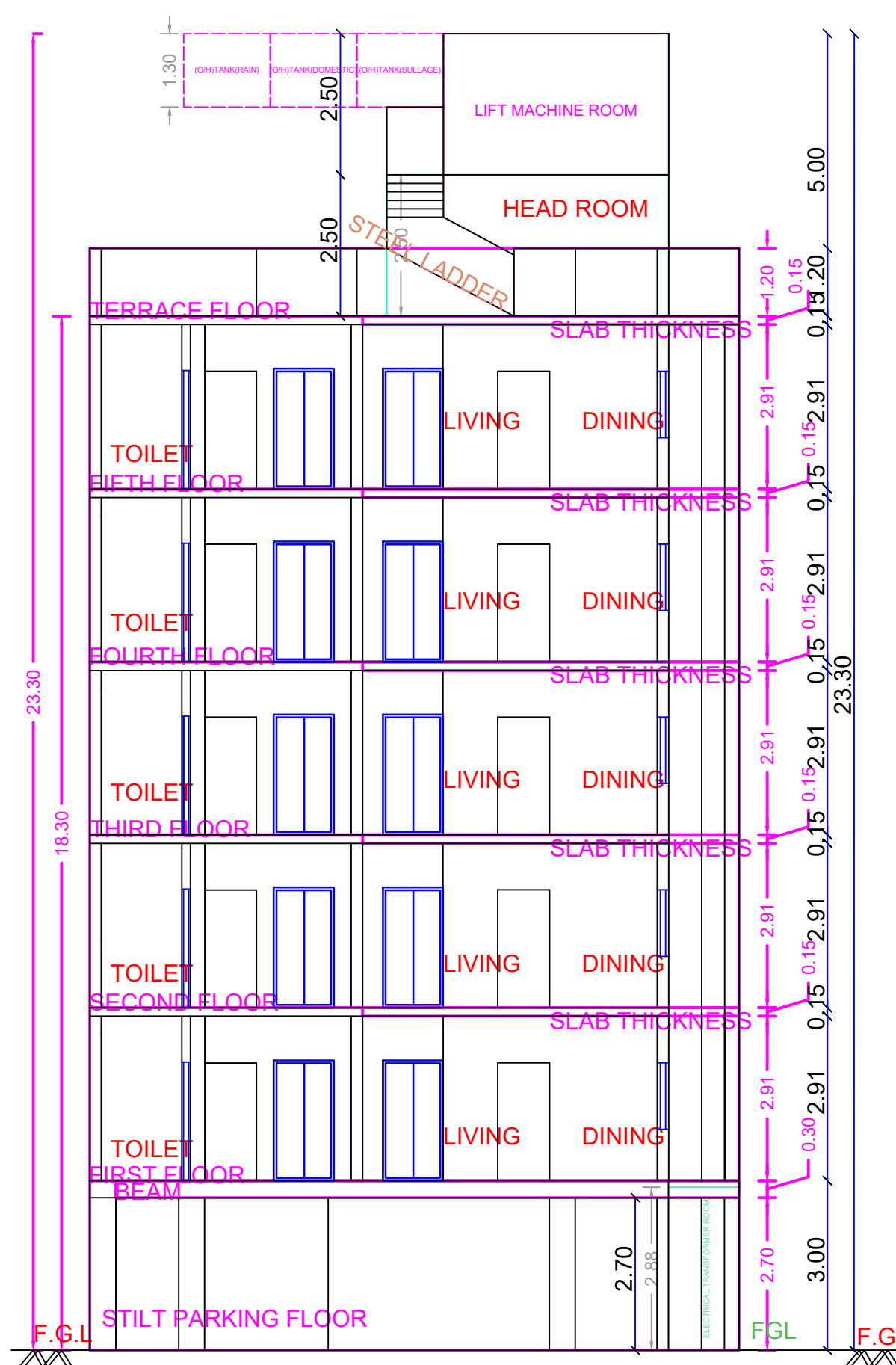

SECTION A-A

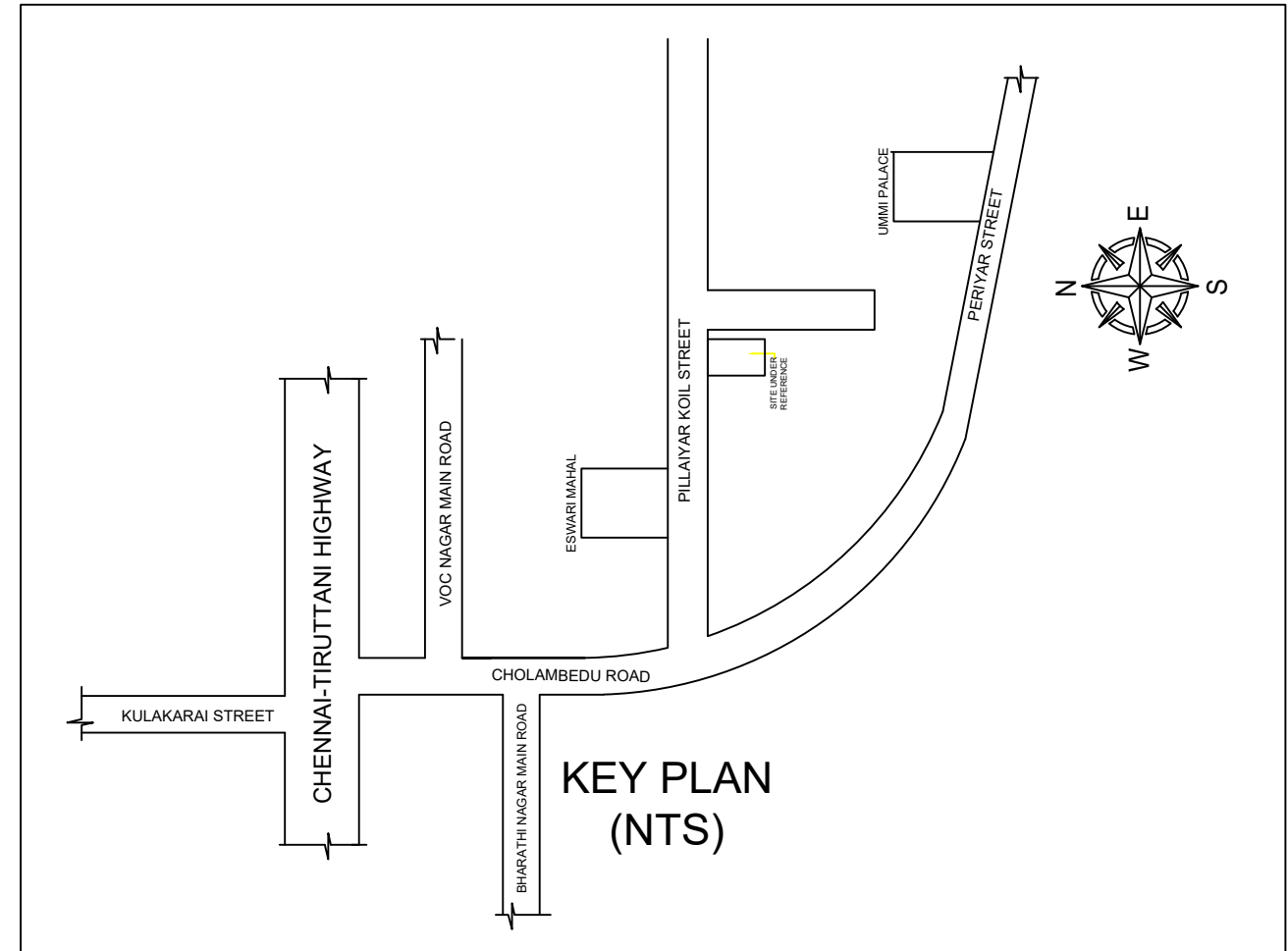
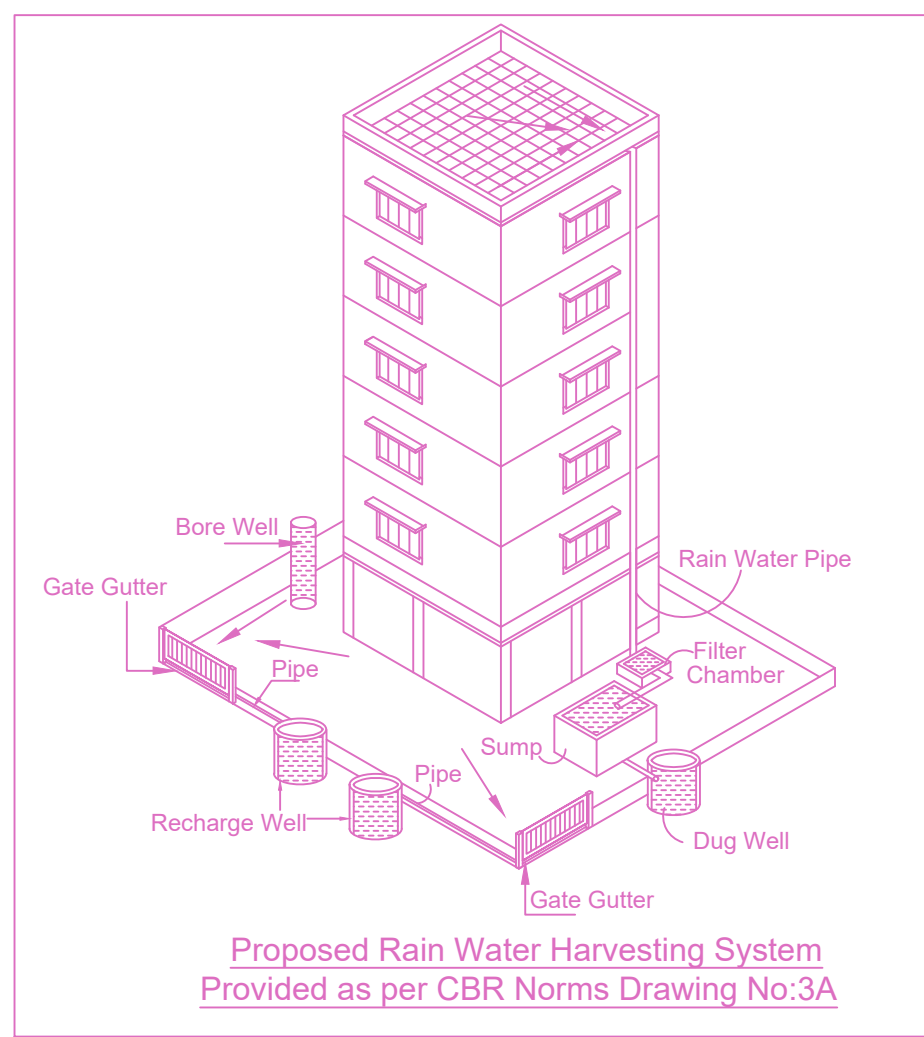
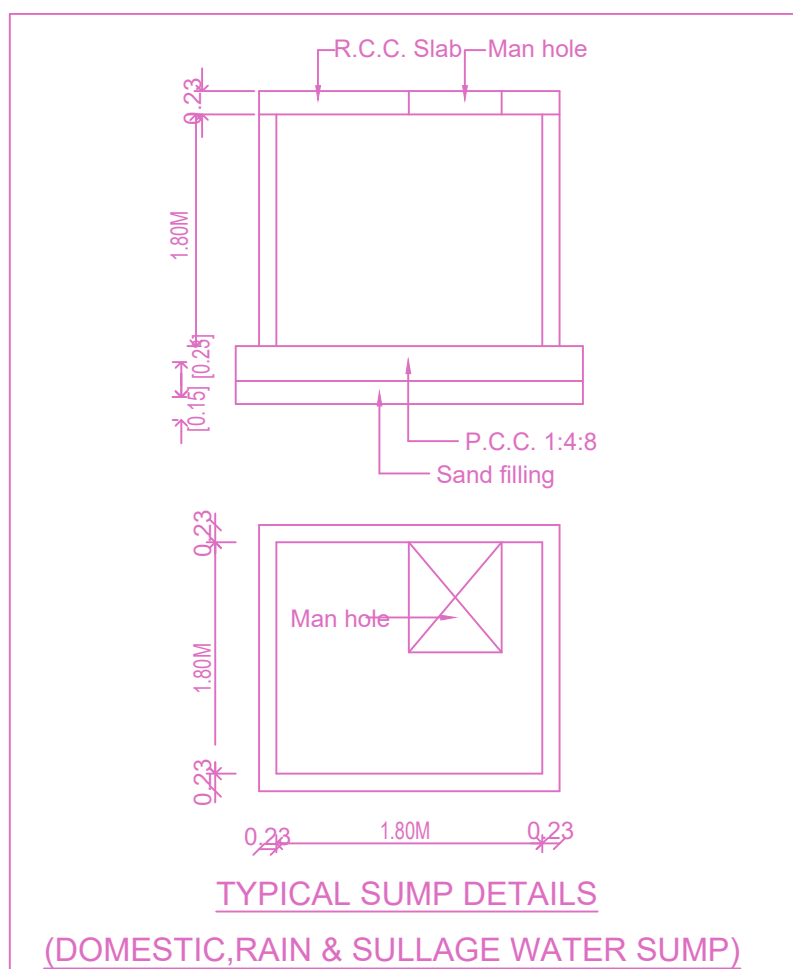
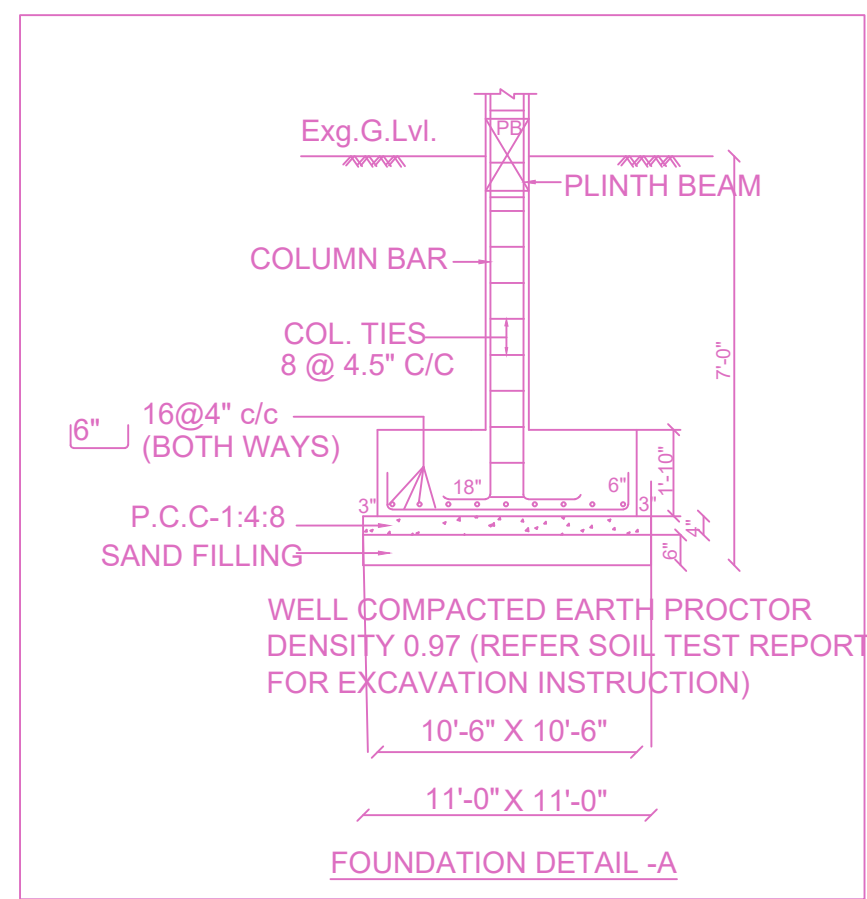

Location plan (Taken as per User Inputs)

BUILDING WISE FSI STATEMENT							
BUILDING	NO OF SAME BUILDING	FSI AREA				DU	TOTAL
		COMM.	RESI.	IND.	SPEC.		FSI AREA
NHRB-1 (RES)		0.00	1860.39	0.00	0.00	20	1860.39
Total		0.00	1860.39	0.00	0.00	20	1860.39

FLOOR WISE FSI STATEMENT: NHRB (RES)						
FLOORS	FSI AREA				DU	TOTAL
	COMM.	RES.	IND.	SPEC.		FSI AREA
Terrace	0.00	0.00	0.00	0.00	0	0.00
FIFTH FLOOR	0.00	366.65	0.00	0.00	4	366.65
FOURTH FLOOR	0.00	366.65	0.00	0.00	4	366.65
THIRD FLOOR	0.00	366.65	0.00	0.00	4	366.65
SECOND FLOOR	0.00	366.65	0.00	0.00	4	366.65
FIRST FLOOR	0.00	366.65	0.00	0.00	4	366.65
STILT PARKING FLOOR	0.00	27.14	0.00	0.00	0	27.14
Total	0.00	1880.39	0.00	0.00	20	1880.39

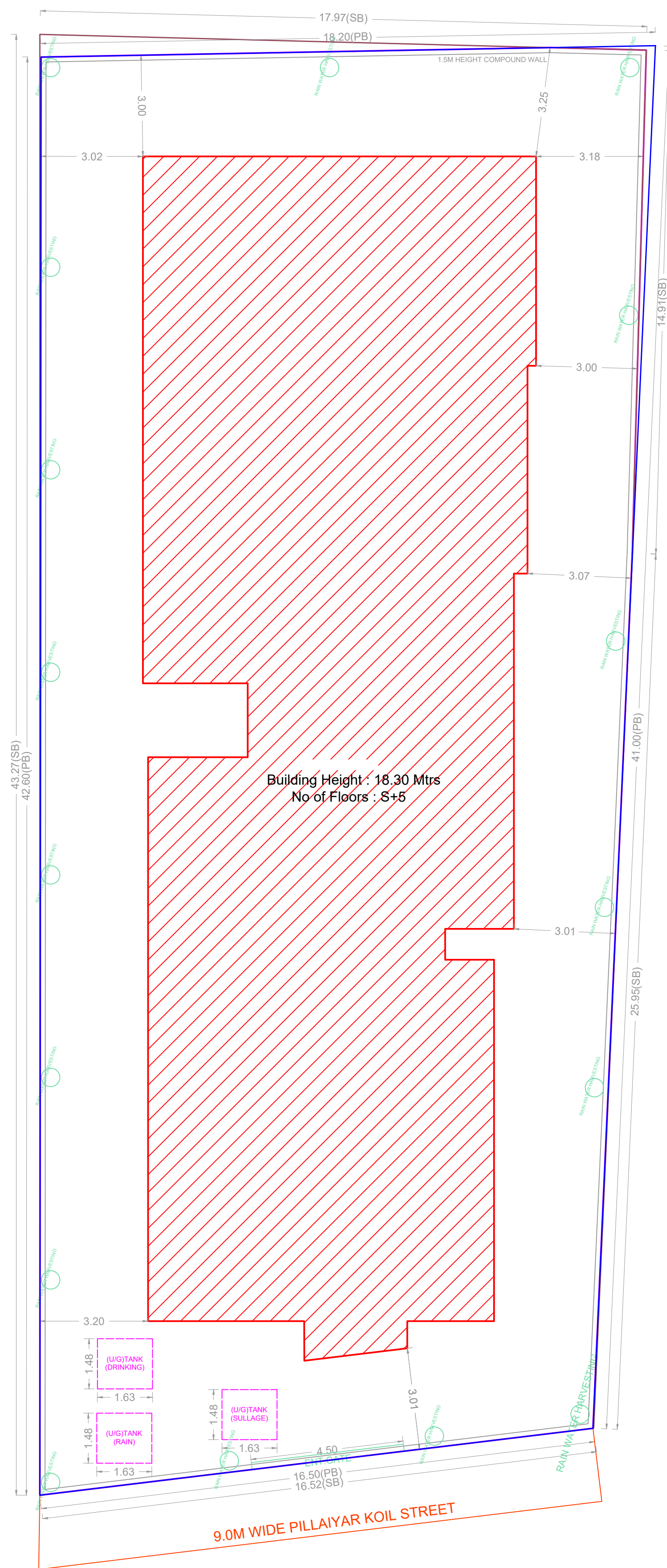

SITE PLAN

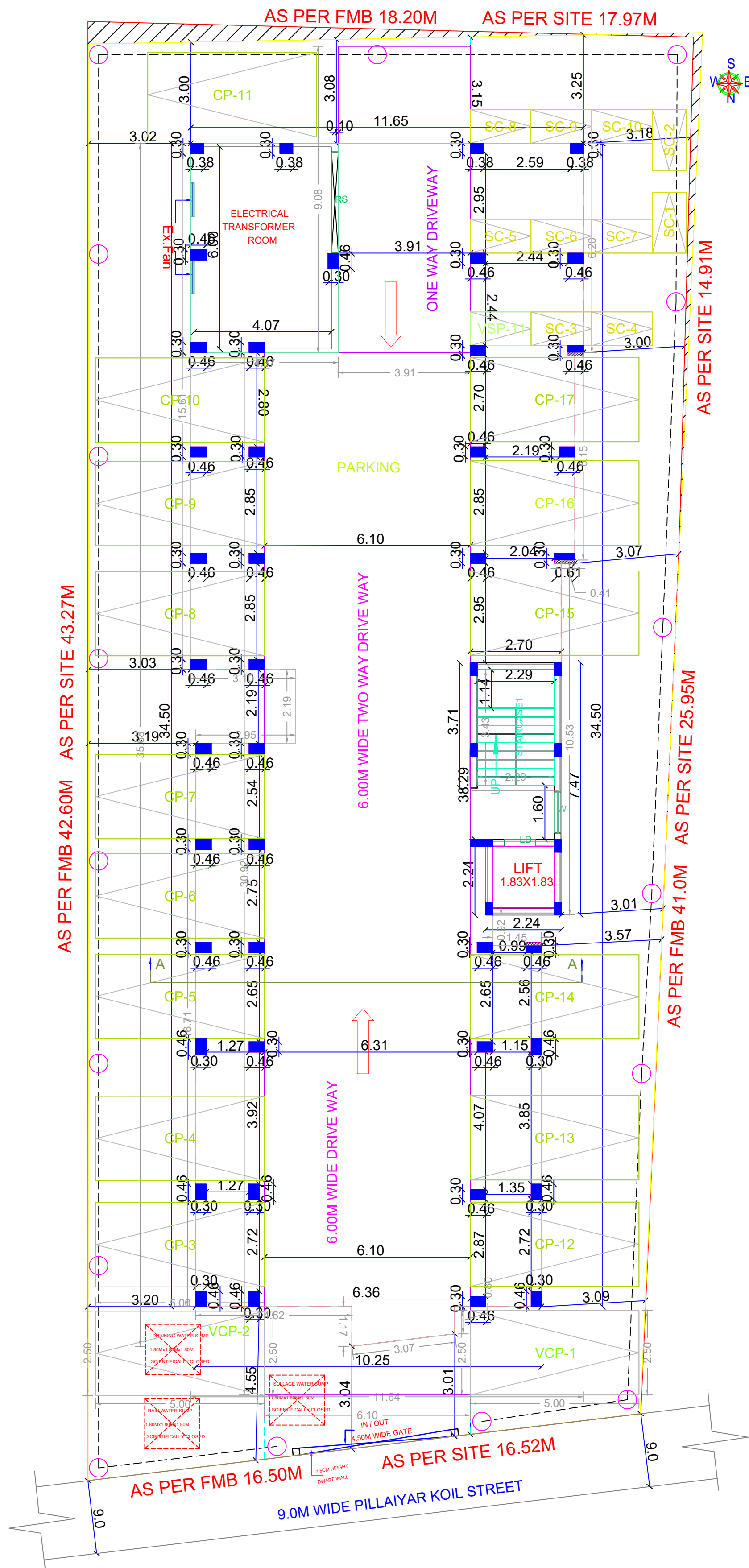

SITE CUM STILT FLOOR PLAN

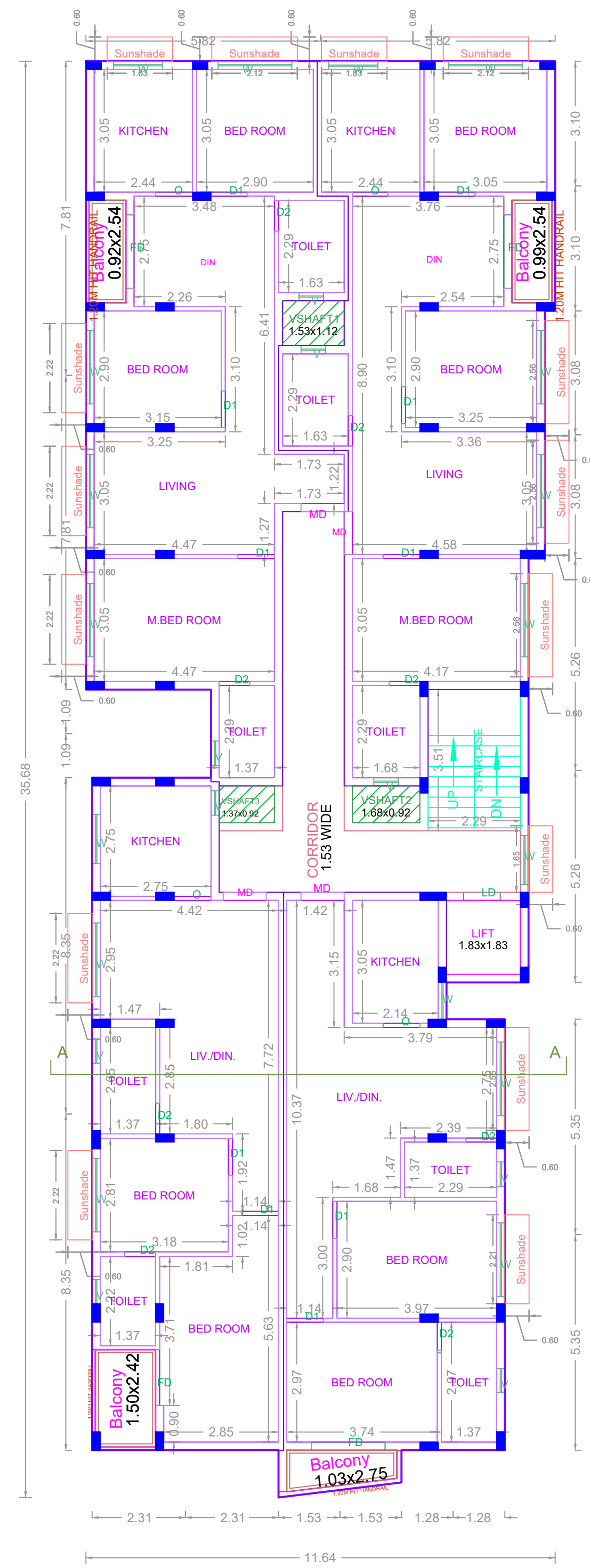

TYPICAL FLOOR PLAN
(1ST,2ND,3RD,4TH & 5TH)

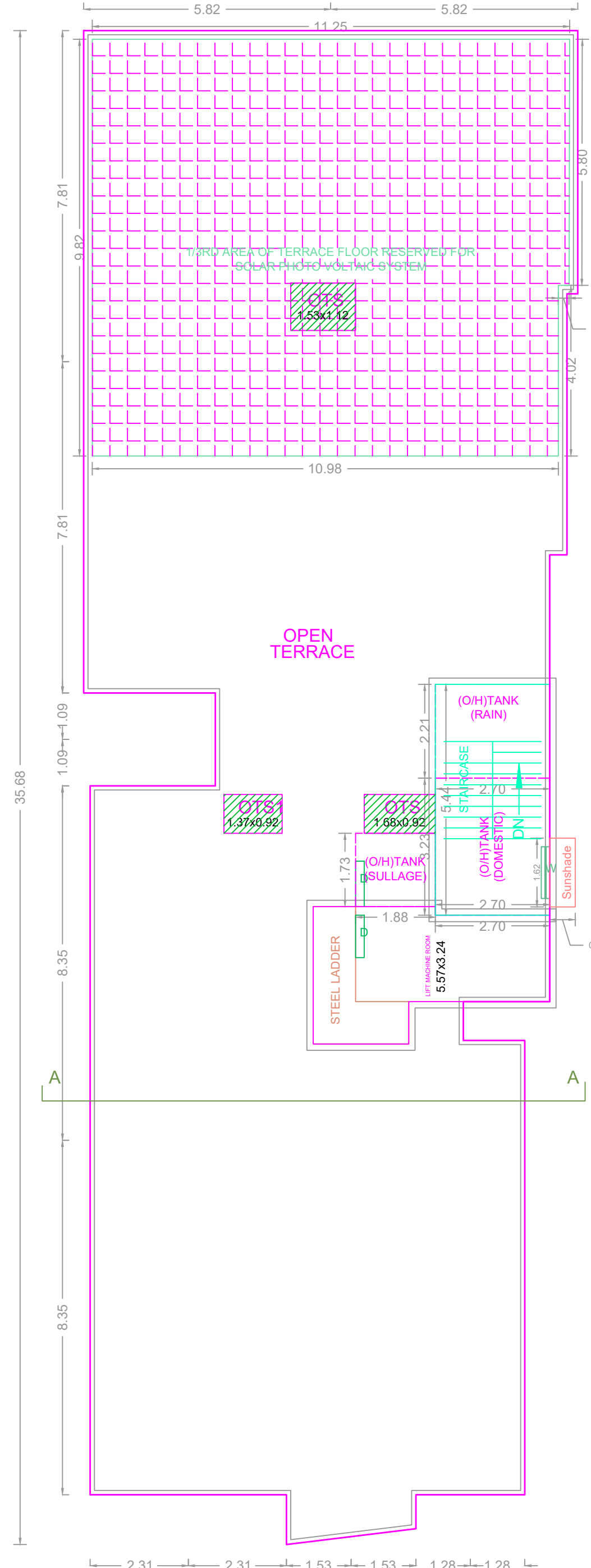

TERRACE FLOOR PLAN

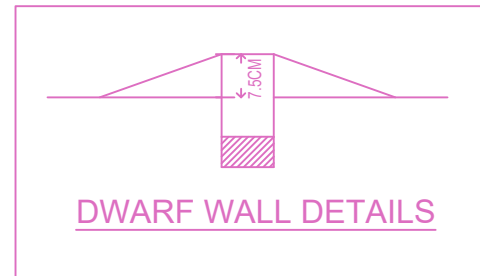
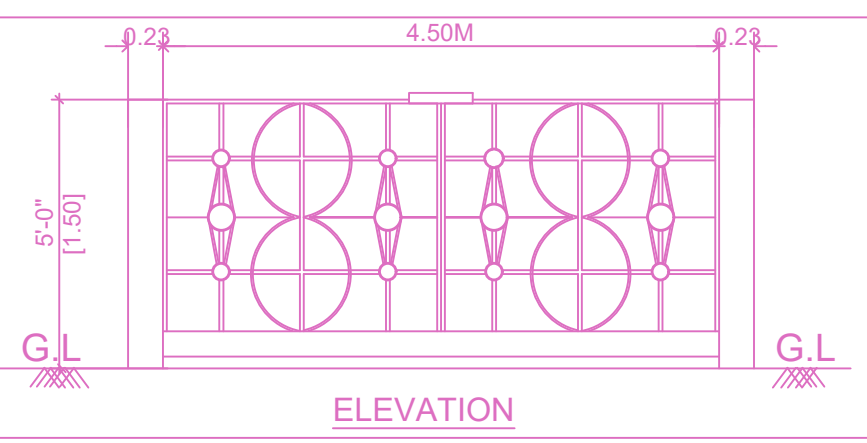

APPROVAL CONDITION

SCALE 1:100

CHENNAI METROPOLITAN DEVELOPMENT AUTHORITY
APPROVED
SUBJECT TO THE CONDITIONS MENTIONED IN THIS OFFICE

This Planning Permission is issued under the provisions of the Chennai Metropolitan Development Authority Act, 1965 (No. 19 of 1965) and the Chennai Metropolitan Development Authority Rules, 1965 (No. 19 of 1965) and the Chennai Metropolitan Development Authority Regulations, 1965 (No. 19 of 1965).

For (Design Planner / Chief Planner / Member Secretary)
High Rise Building / Non High Rise Building
This Approval is valid only after Building Permit is issued by the concerned Local Body.

KEY NO. 9688

QR CODE