

PLAN SHOWING THE PROPOSED CONSTRUCTION OF STILT + 5 FLOORS RESIDENTIAL WITH 5 DWELLING UNITS 18.30M HEIGHT AT PLOT NO.411, W BLOCK, 4TH STREET, ANNA NAGAR, CHENNAI 600040, COMPRISED IN S.NO: 149/1 PART, T.S.NO.102, BLOCK NO:40, WARD - 1 OF VILLIVAKKAM VILLAGE, WITHIN THE LIMIT OF GREATER CHENNAI CORPORATION.

A) AREA STATEMENT		SQ.M.
AREA AS PER PATTA		310.00
AREA AS PER DOCUMENT		305.46
AREA CONSIDERED FOR FSI		305.46
STREET ALIGNMENT/ ROAD WIDENING/LINK ROAD		0.00
OSR AREA		0.00
TOTAL FSI AREA		609.35
FSI FACTOR		1.995
COVERAGE AREA (PERCENTAGE %)		N.A

A) PARKING STATEMENT		
VEHICLE	REQUIRED	PROVIDED
LORRY	0	0
CAR	5	5
TWO WHEELER	0	0
CYCLE	0	0

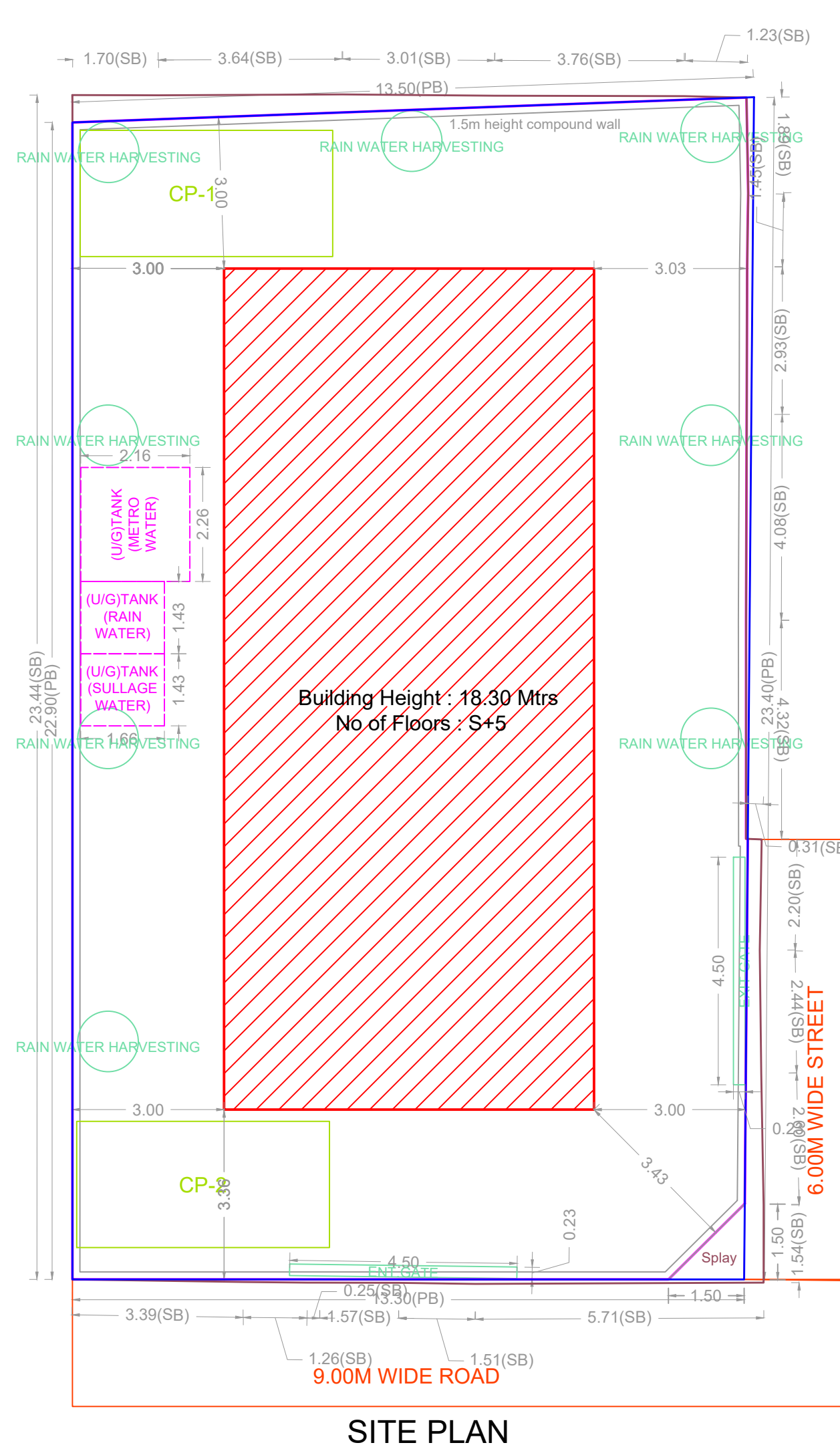

SITE PLAN

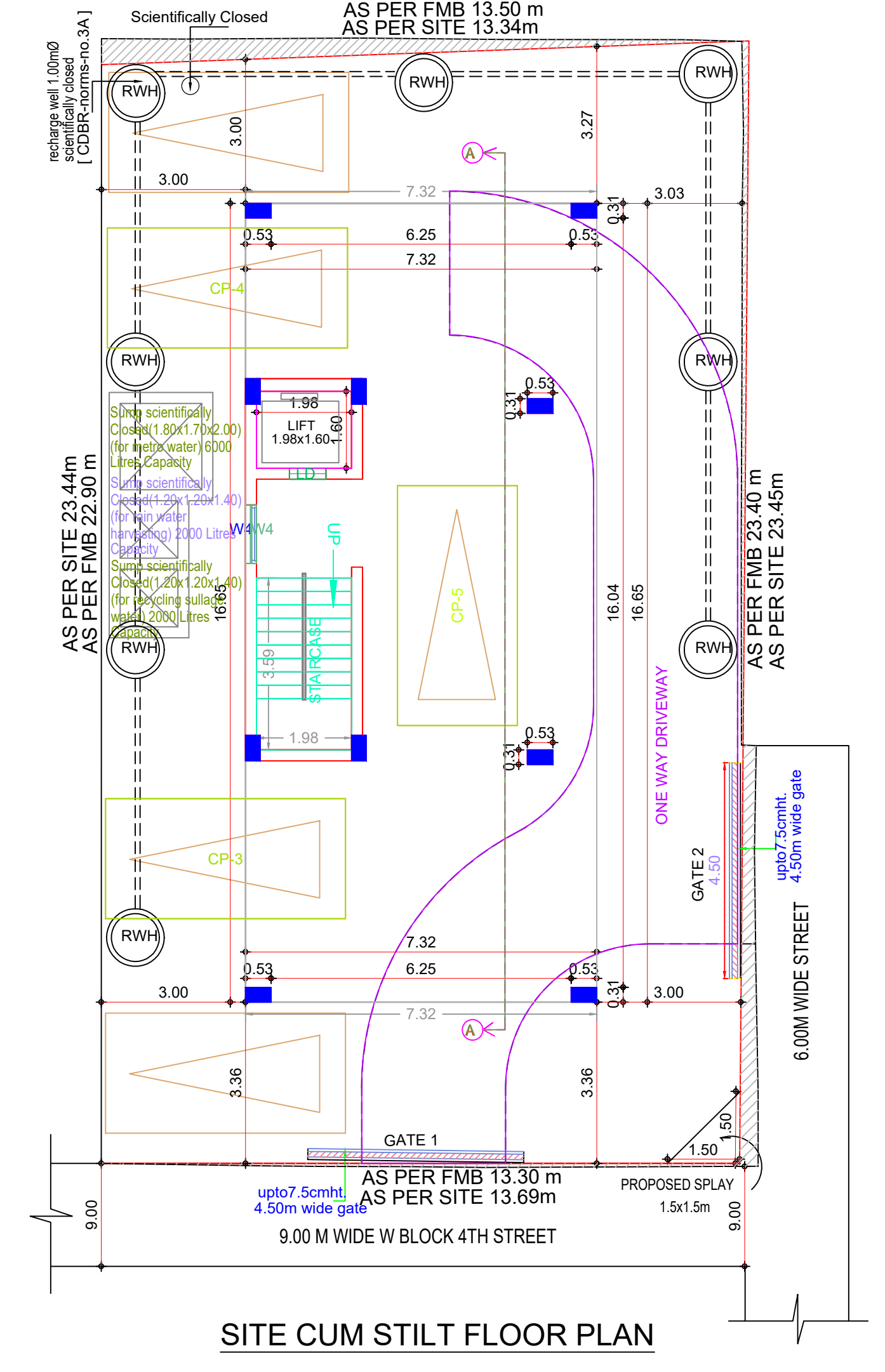

SITE CUM STILT FLOOR PLAN



FRONT ELEVATION

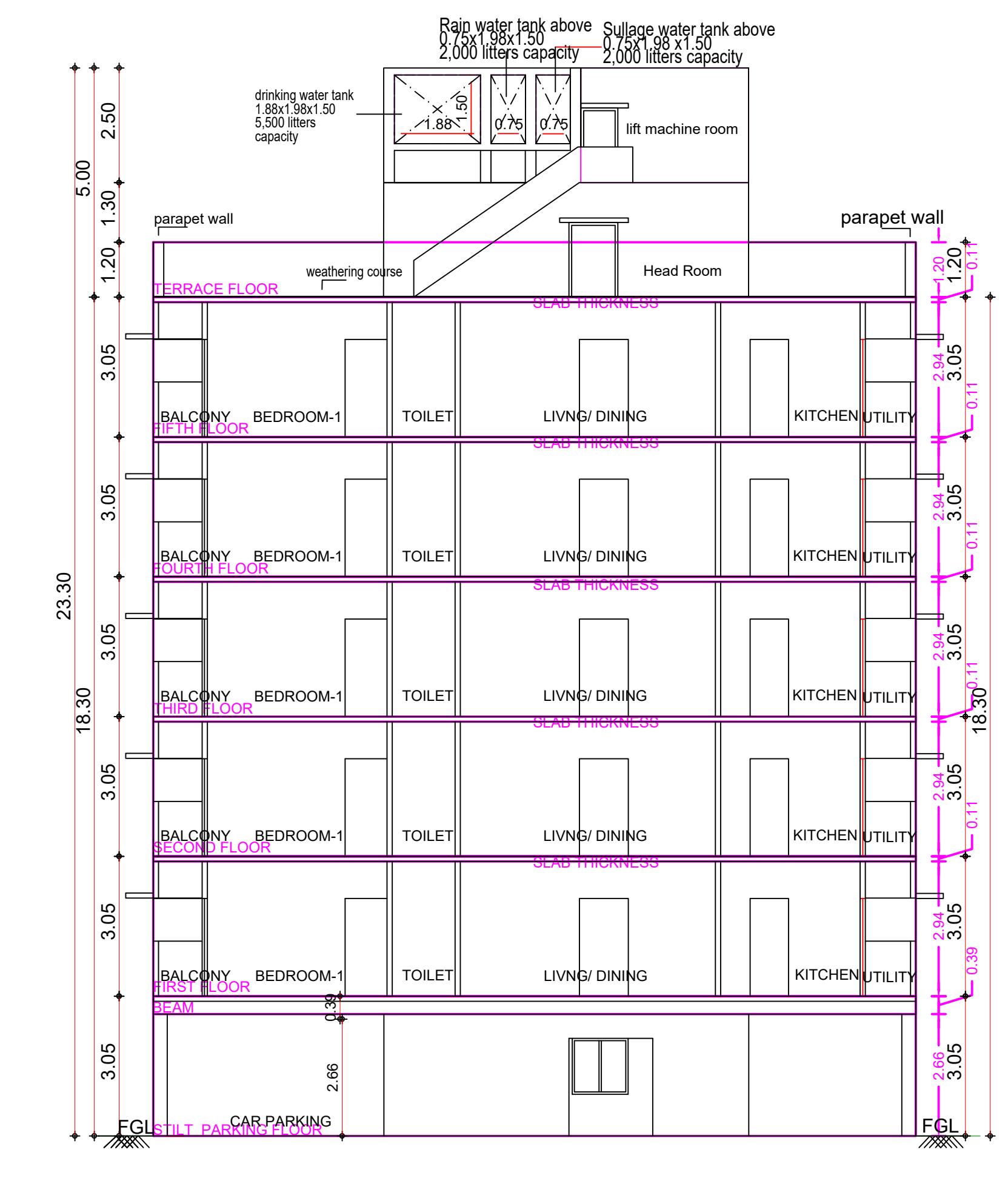

SECTION-AA

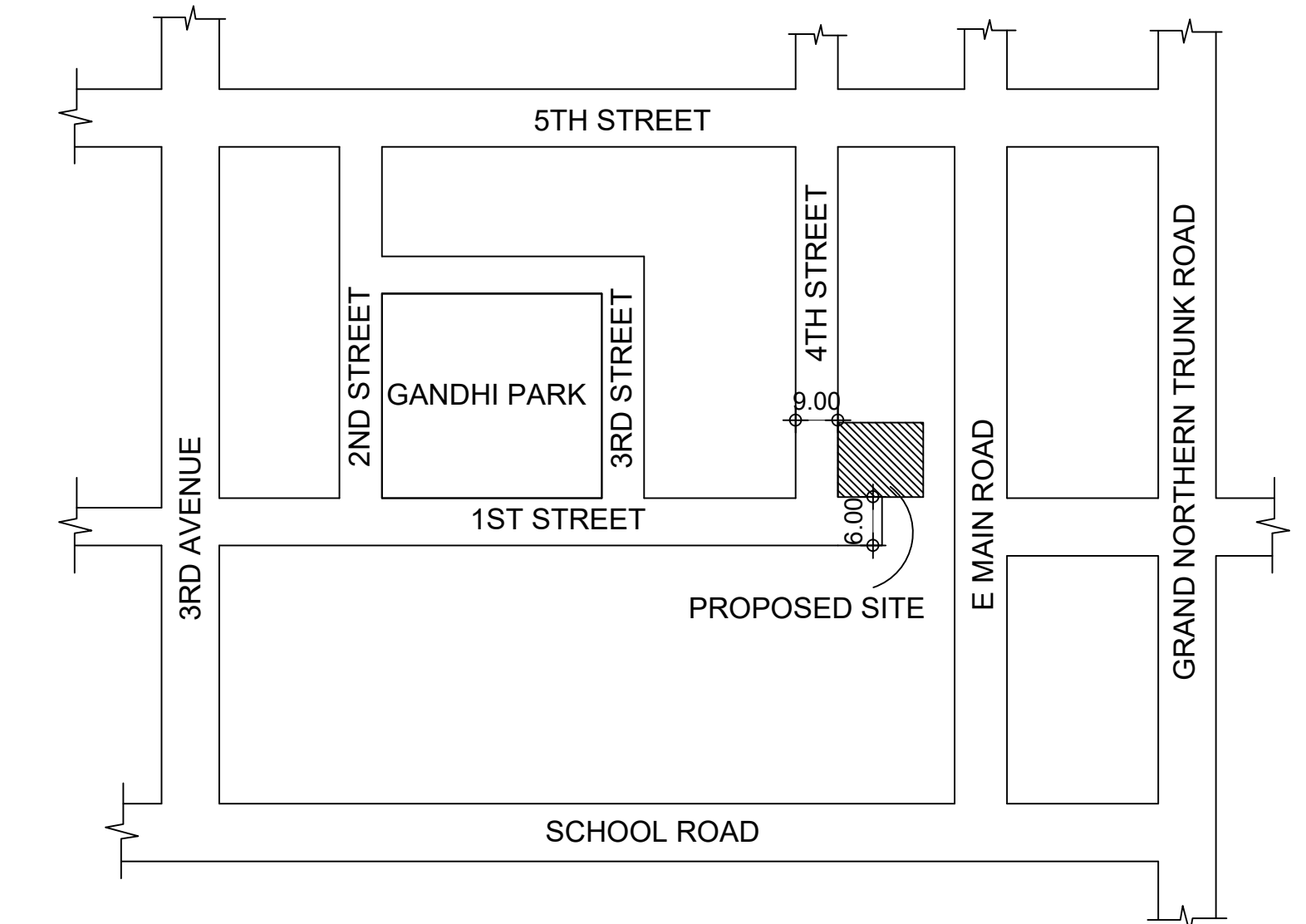

KEY PLAN NOT TO SCALE Location plan (Taken as per User Inputs)

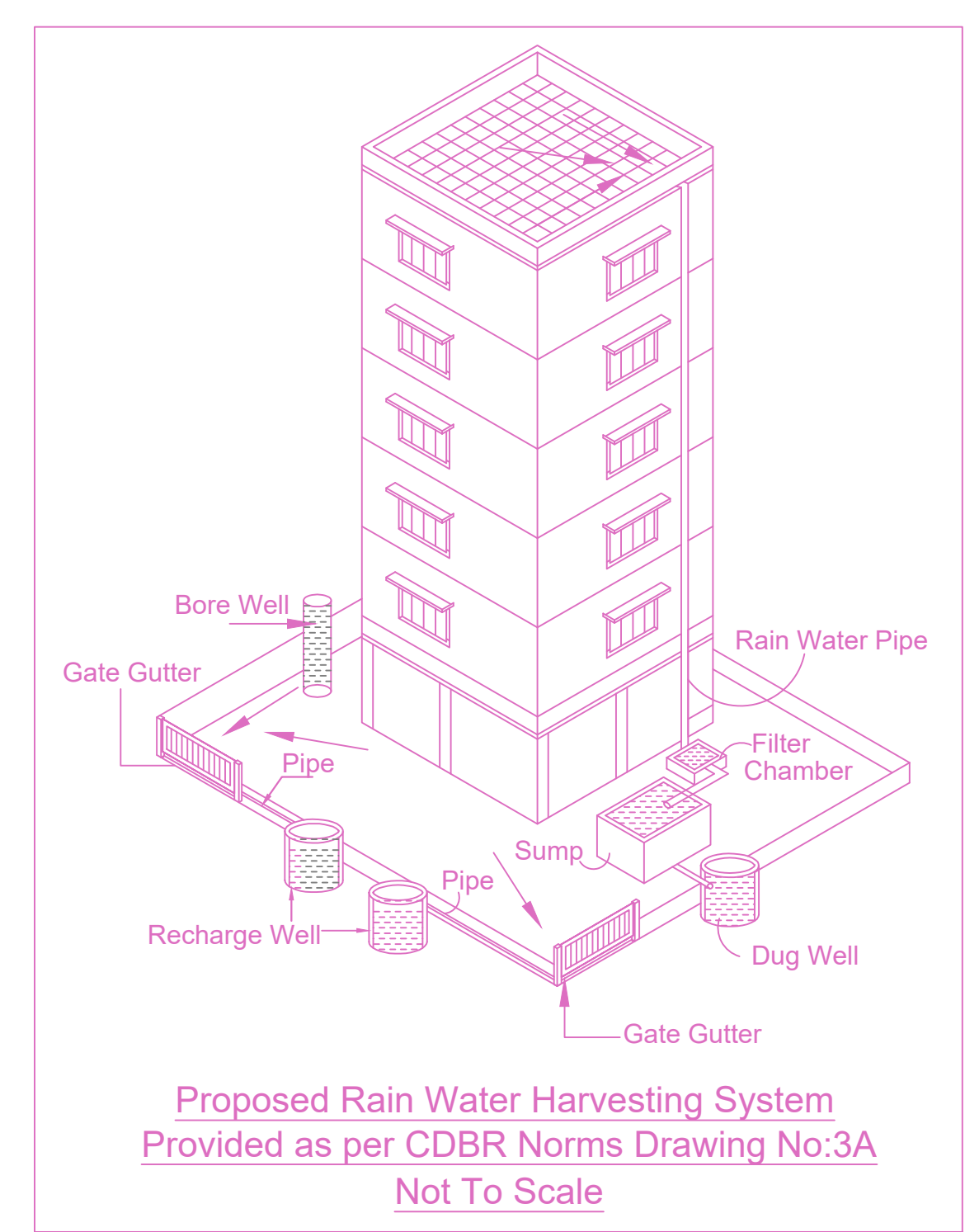

Proposed Rain Water Harvesting System Provided as per CDBR Norms Drawing No:3A Not To Scale

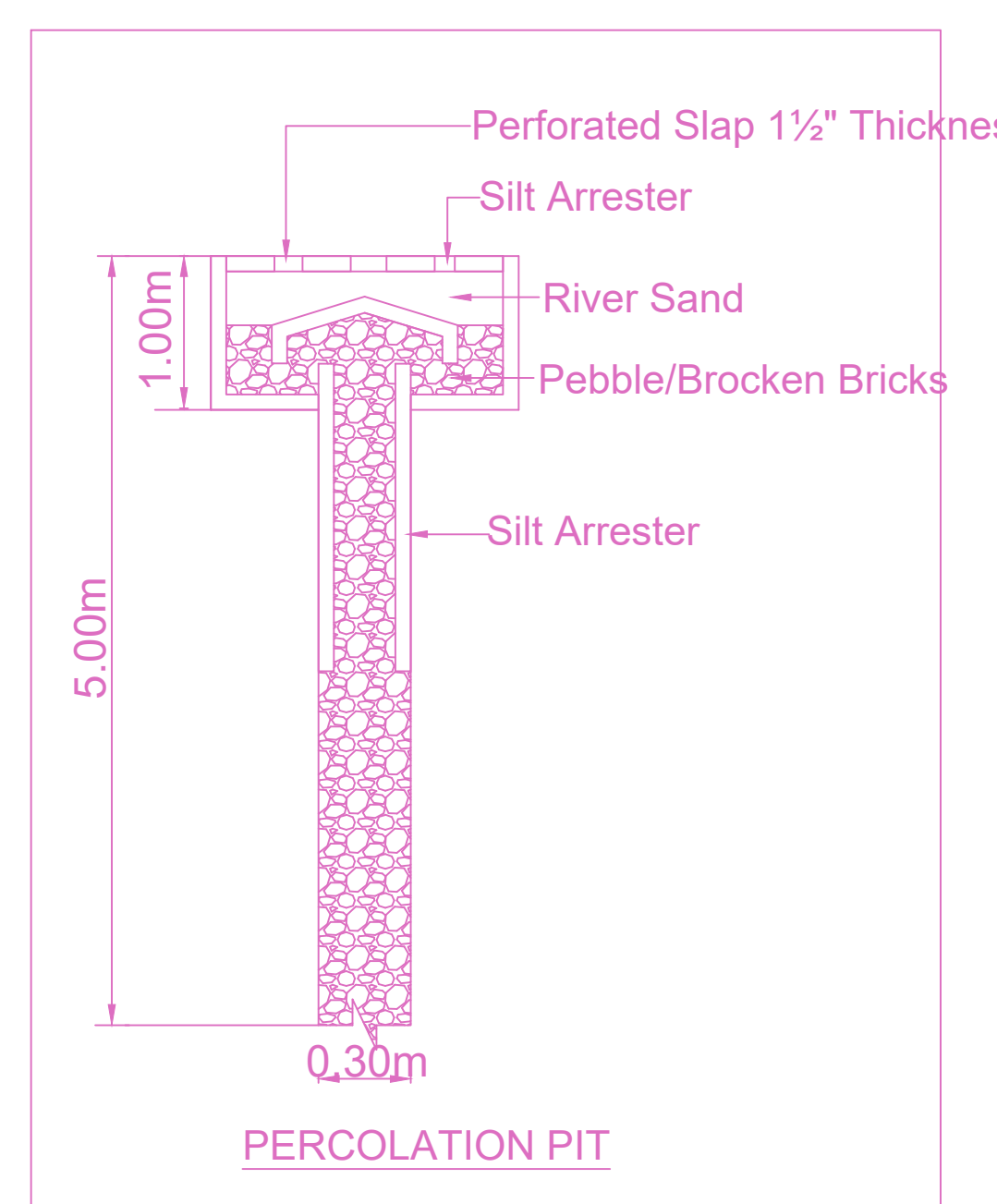

PERCOLATION PIT

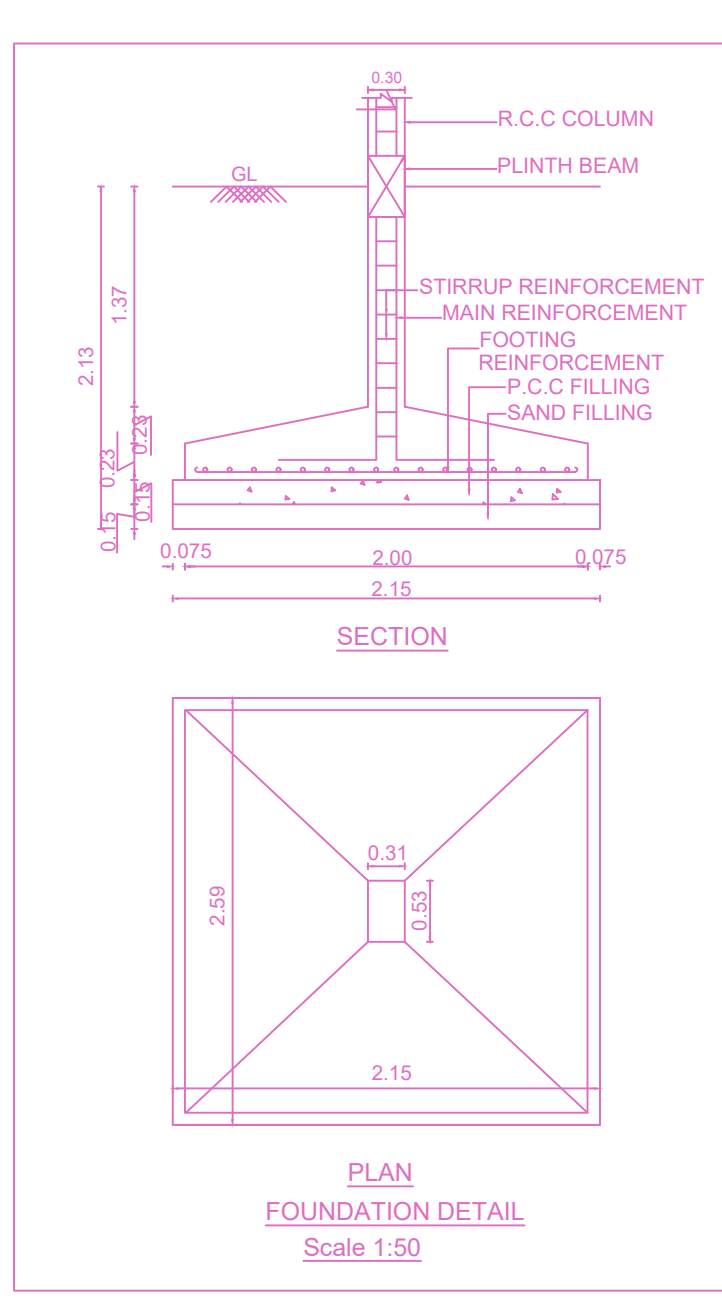

PLAN FOUNDATION DETAIL Scale 1:50

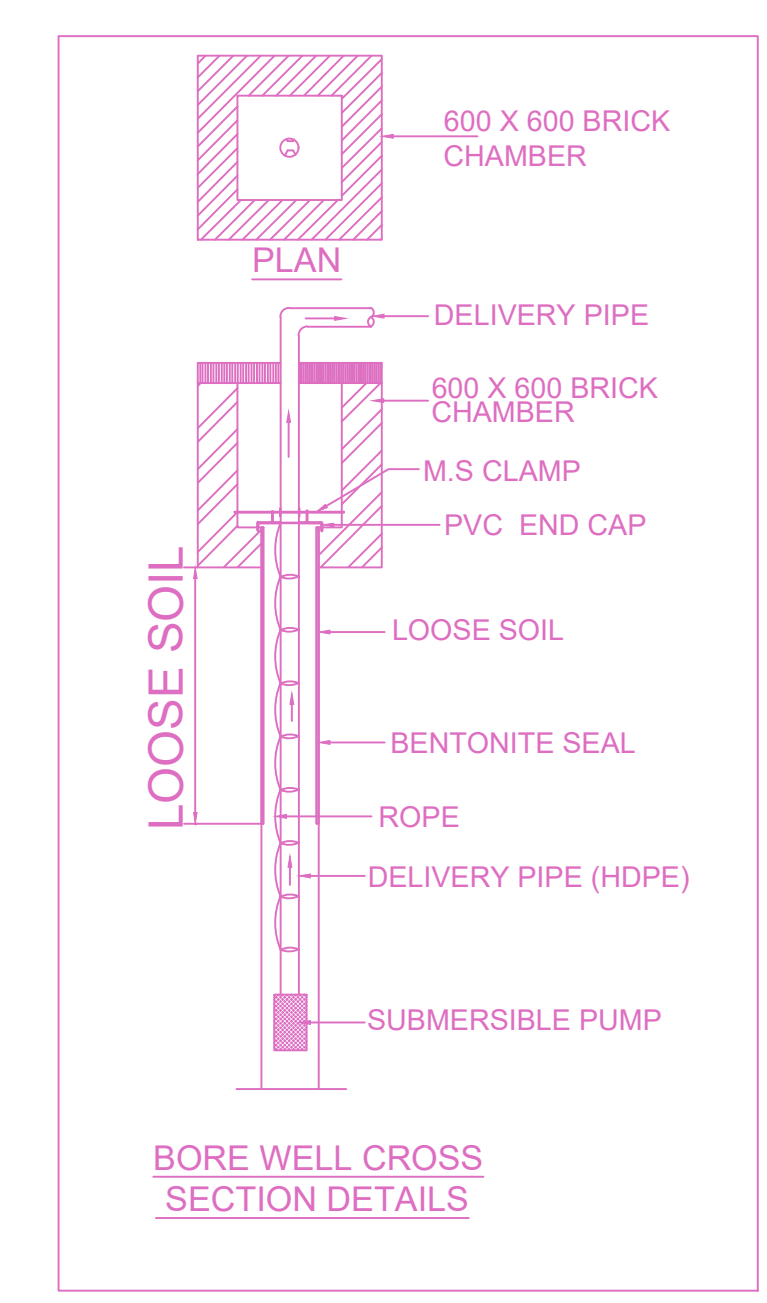

BORE WELL CROSS SECTION DETAILS

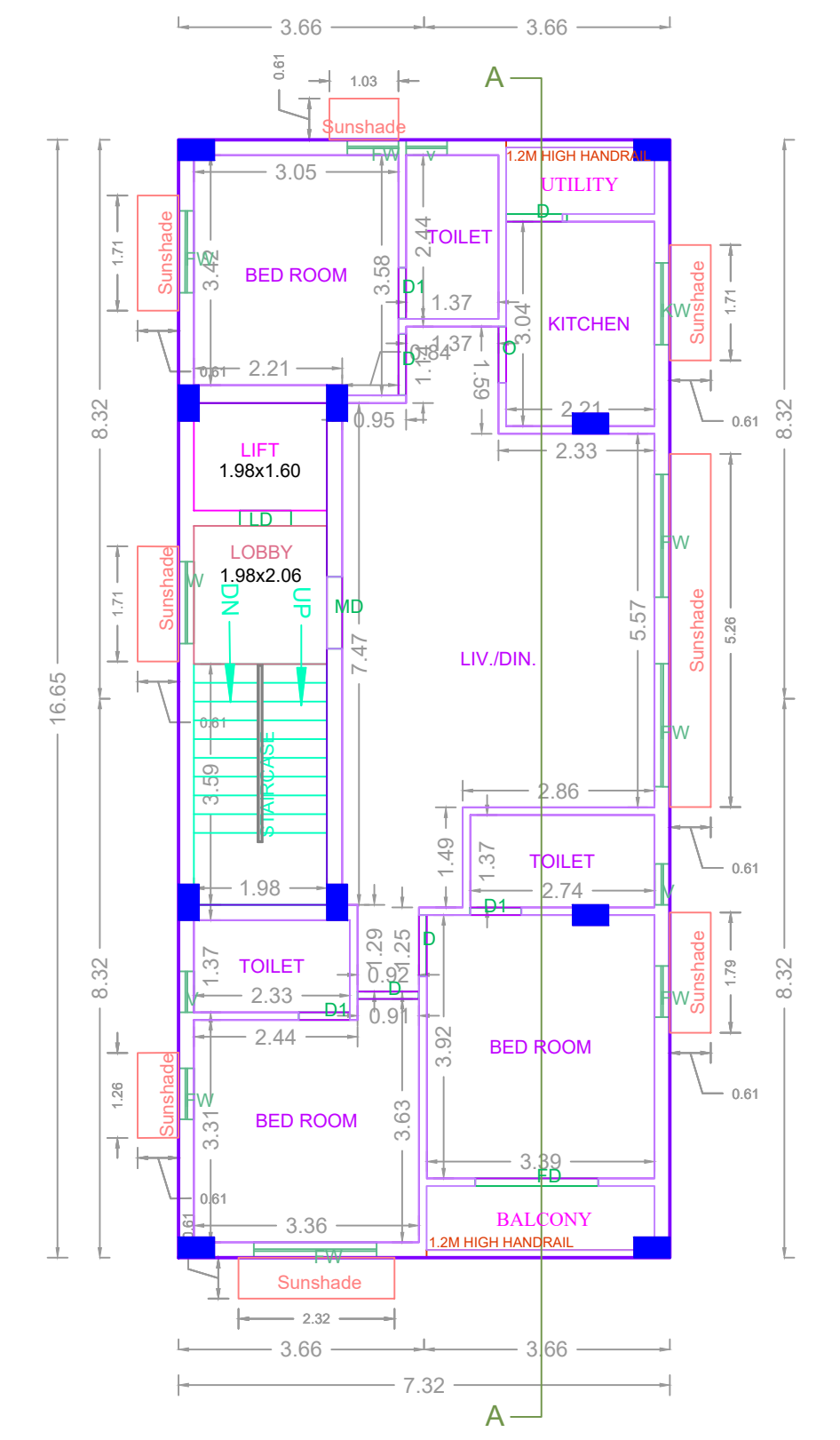

TYPICAL - 1, 2, 3, 4, 5 FLOOR PLAN

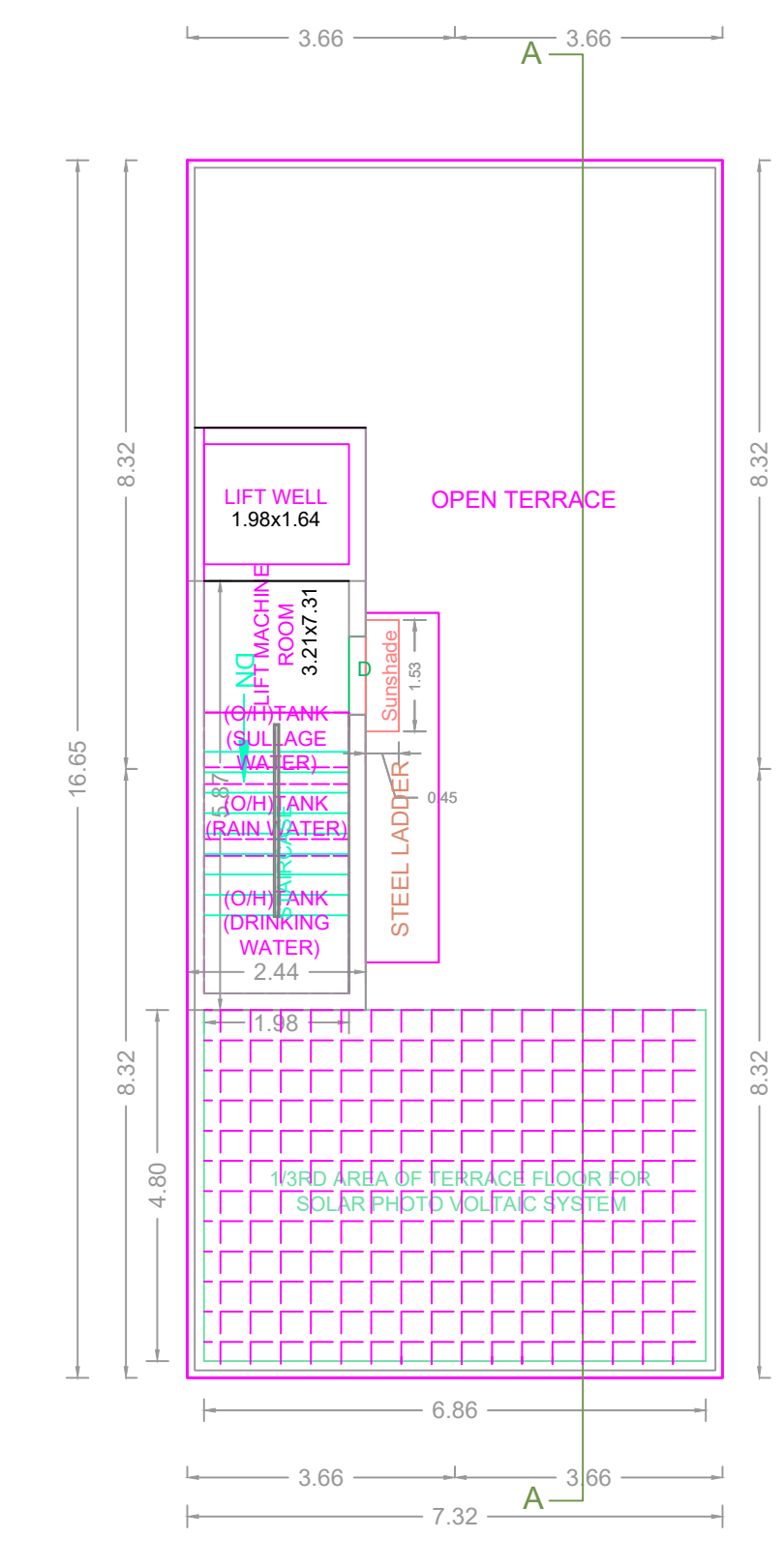

TERRACE FLOOR PLAN

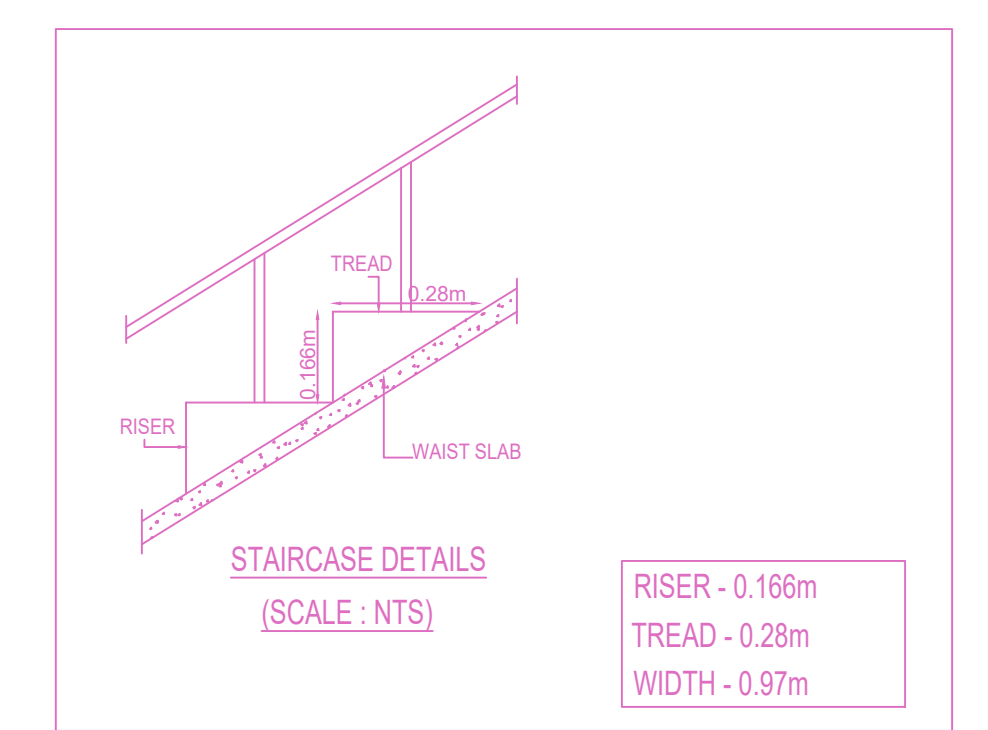

STAIRCASE DETAILS (SCALE - NTS) RISER - 0.166m TREAD - 0.28m WIDTH - 0.97m

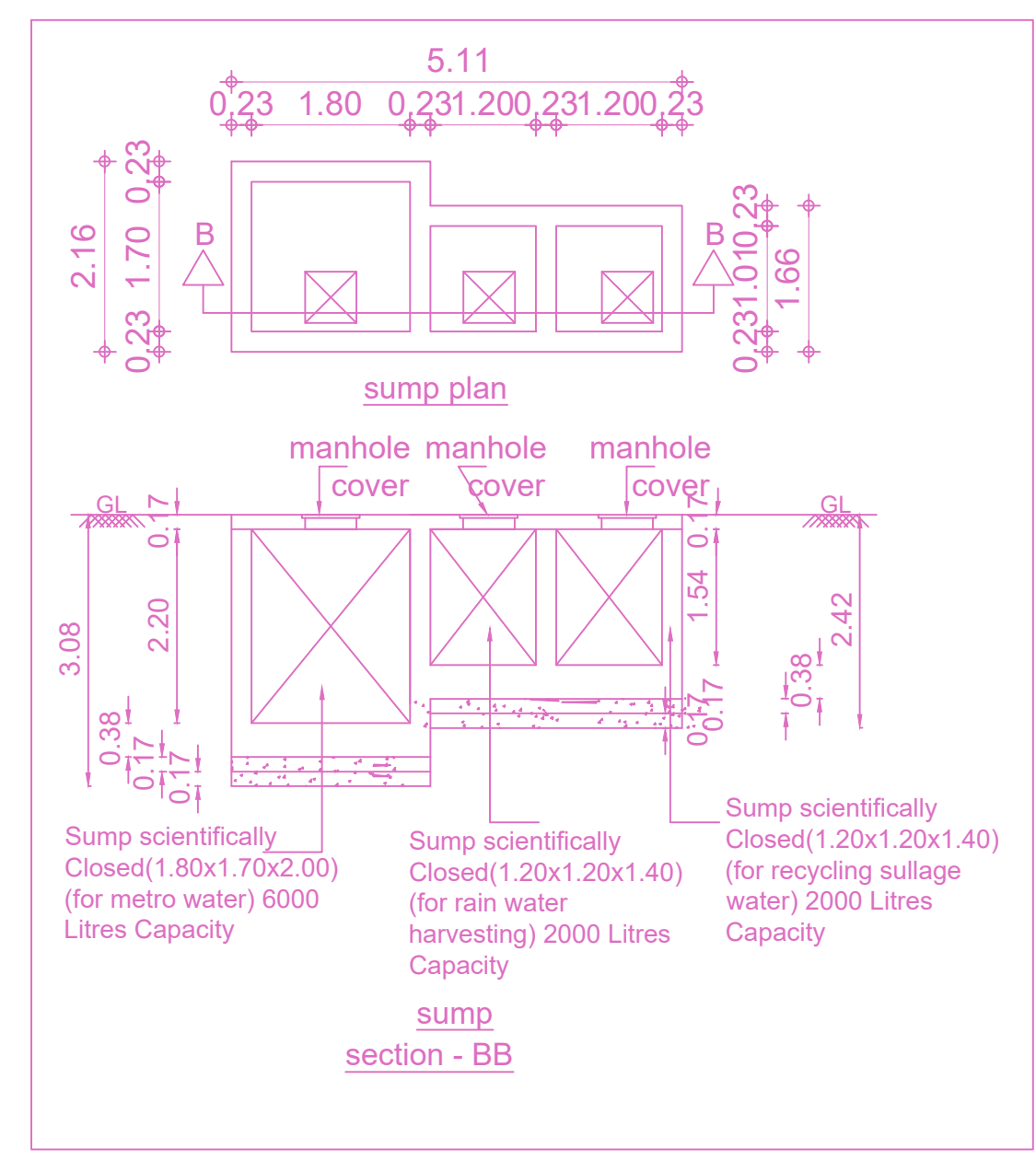

SUMP SECTION-BB

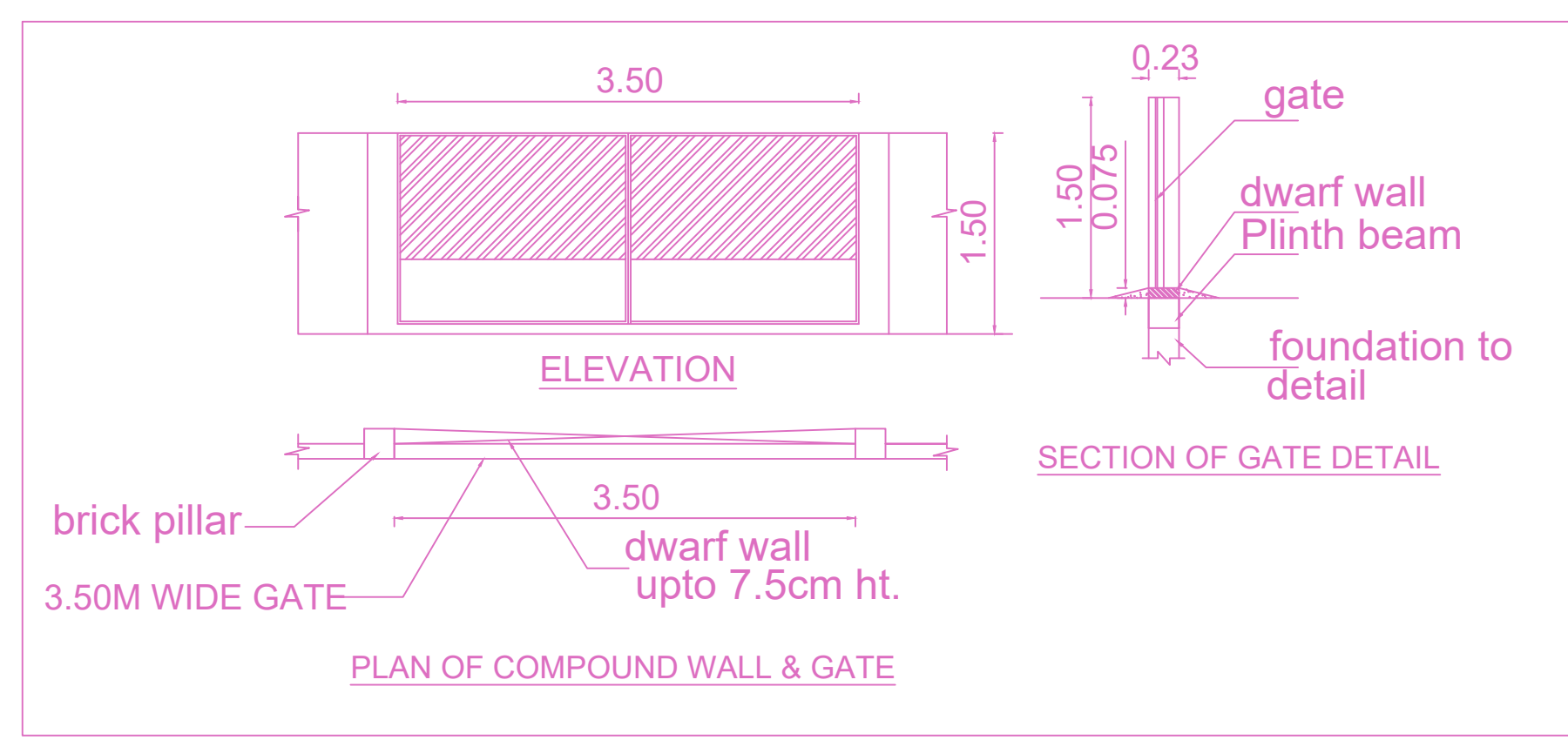

PLAN OF COMPOUND WALL & GATE

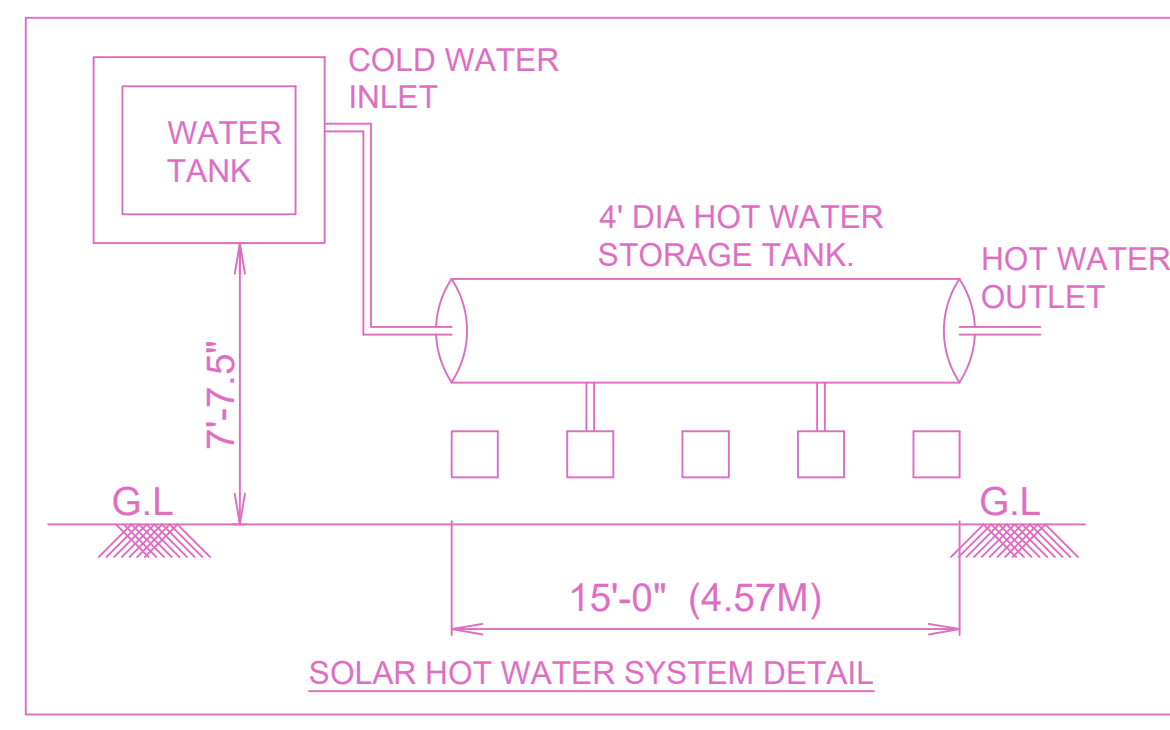

SOLAR HOT WATER SYSTEM DETAIL

FLOOR WISE FSI STATEMENT: A (B)

FLOORS	FSI AREA				DU	TOTAL FSI AREA
	COMM.	RESI.	IND.	SPEC.		
Terrace	0.00	0.00	0.00	0.00	0	0.00
FIFTH FLOOR	0.00	121.87	0.00	0.00	1	121.87
FOURTH FLOOR	0.00	121.87	0.00	0.00	1	121.87
THIRD FLOOR	0.00	121.87	0.00	0.00	1	121.87
SECOND FLOOR	0.00	121.87	0.00	0.00	1	121.87
FIRST FLOOR	0.00	121.87	0.00	0.00	1	121.87
STILT PARKING FLOOR	0.00	0.00	0.00	0.00	0	0.00
Total	0.00	609.35	0.00	0.00	5	609.35

BUILDING WISE FSI STATEMENT

BUILDING	NO OF SAME BUILDING	FSI AREA				DU	TOTAL FSI AREA
		COMM.	RESI.	IND.	SPEC.		
A-1 (B)		0.00	609.35	0.00	0.00	5	609.35
Total		0.00	609.35	0.00	0.00	5	609.35

APPROVAL CONDITION

1. The proposed building shall be constructed in accordance with the approved plans and specifications.

2. The building shall be constructed within the stipulated time frame.

3. The building shall be constructed in accordance with the approved floor area ratio (FSI) and coverage.

4. The building shall be constructed in accordance with the approved height and setbacks.

5. The building shall be constructed in accordance with the approved parking provision.

SCALE 1:100

CHENNAI METROPOLITAN DEVELOPMENT AUTHORITY

APPROVED

SUBJECT TO THE CONDITIONS MENTIONED IN THIS OFFICE

For (Deputy Planner / Chief Planner / Member-Secretary)
High Rise Building / Non High Rise Building
This Approval is valid only after building Permit is issued by the concerned Local Body.

KEY NO. 3688

QR CODE