

PLAN SHOWING THE PROPOSED CONSTRUCTION OF STILT + 5 FLOORS (18.0M HEIGHT) WITH 9 DWELLING UNITS AVAILING PREMIUM FSI OF RESIDENTIAL BUILDING AT OLD DOOR NO-178, NEW DOOR NO-18, 14th CROSS STREET, DEFENCE OFFICERS COLONY, NANDAMBAKKAM, CHENNAI-600 032, COMPRISED IN S.NO:-1601 & 1631, AS PER PATTA S.NO:-1601/L & 1631/C OF NANDAMBAKKAM VILLAGE, GREATER CHENNAI CORPORATION, DIVISION NO- 158, ZONE - XII.

A) AREA STATEMENT	SQM.
AREA AS PER PATTA	555.00
AREA AS PER DOCUMENT	557.40
AREA CONSIDERED FOR FSI	550.00
STREET ALIGNMENT/ ROAD WIDENING/ LINK ROAD	0.00
OSR AREA	0.00
TOTAL FSI AREA	1427.54
FSI FACTOR	2.596
COVERAGE AREA (PERCENTAGE %)	N/A

A) PARKING STATEMENT	REQUIRED	PROVIDED
VEHICLE		
LORRY	0	0
CAR	11	11
TWO WHEELER	0	0
CYCLE	0	0

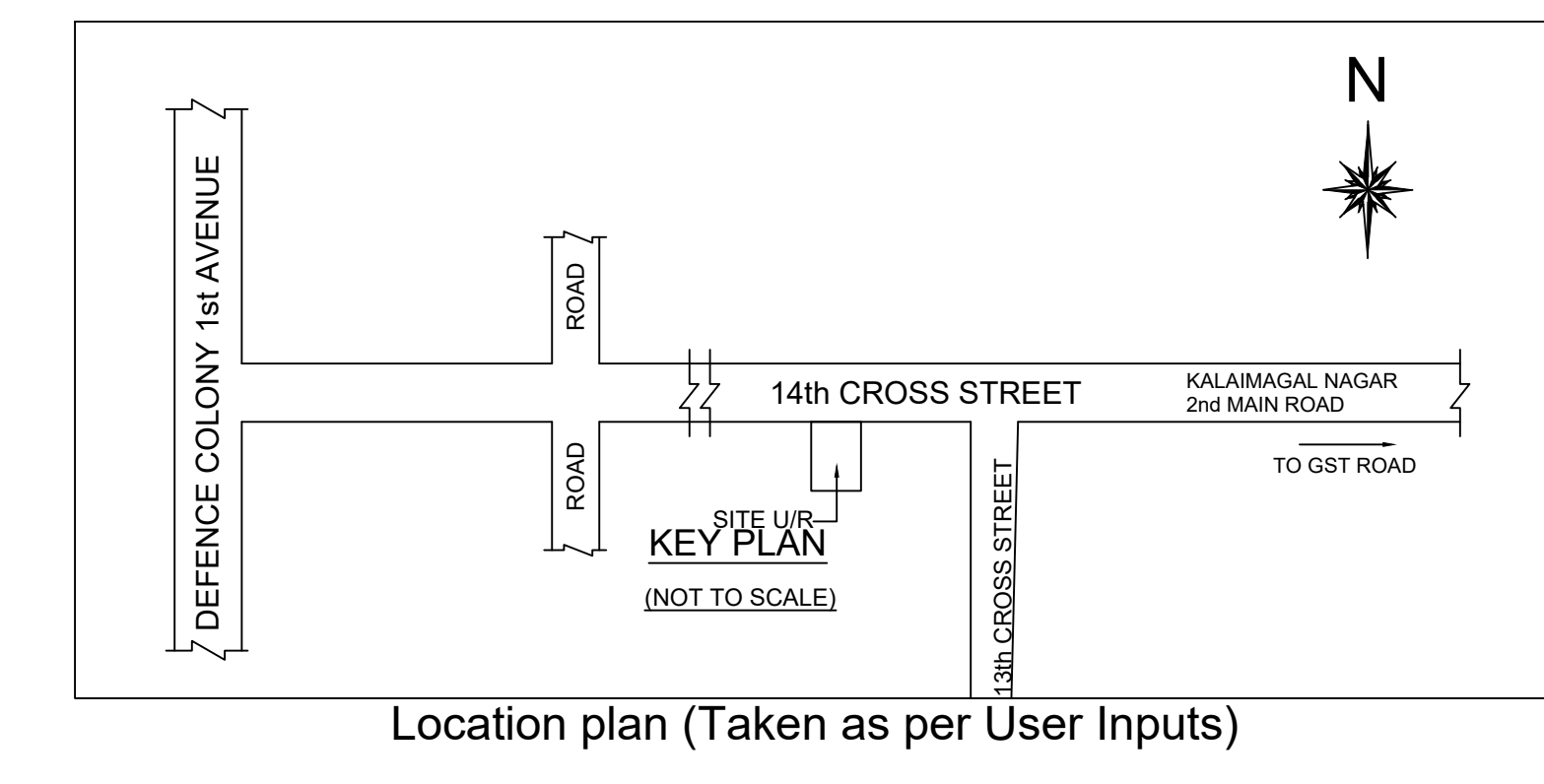

Location plan (Taken as per User Inputs)

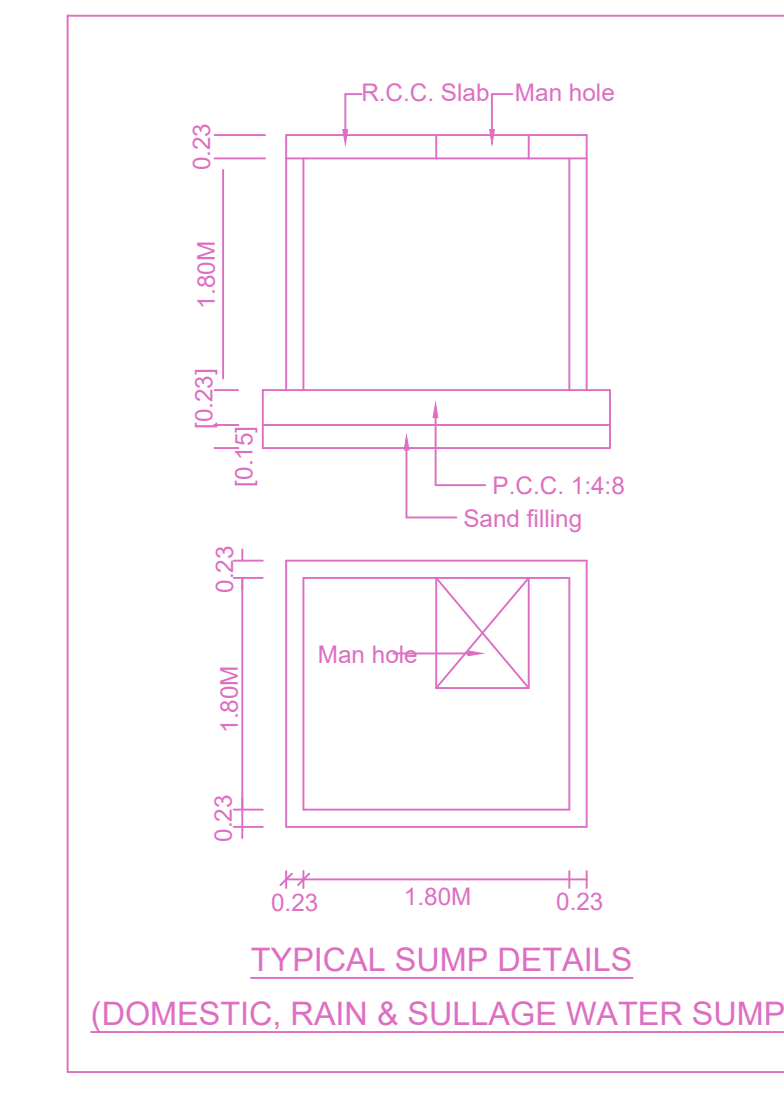

TYPICAL SUMP DETAILS (DOMESTIC, RAIN & SULLAGE WATER SUMP)

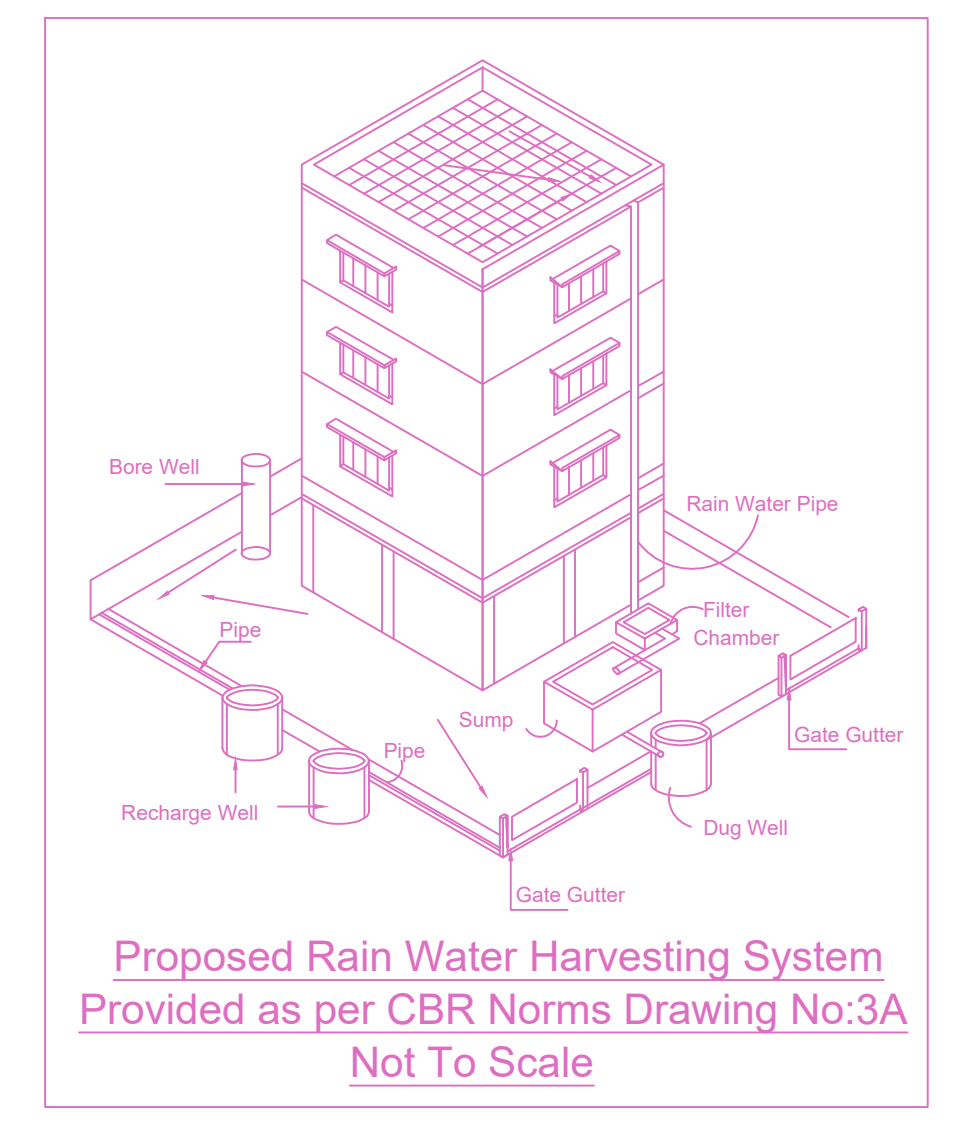

Proposed Rain Water Harvesting System Provided as per CBR Norms Drawing No:3A Not To Scale

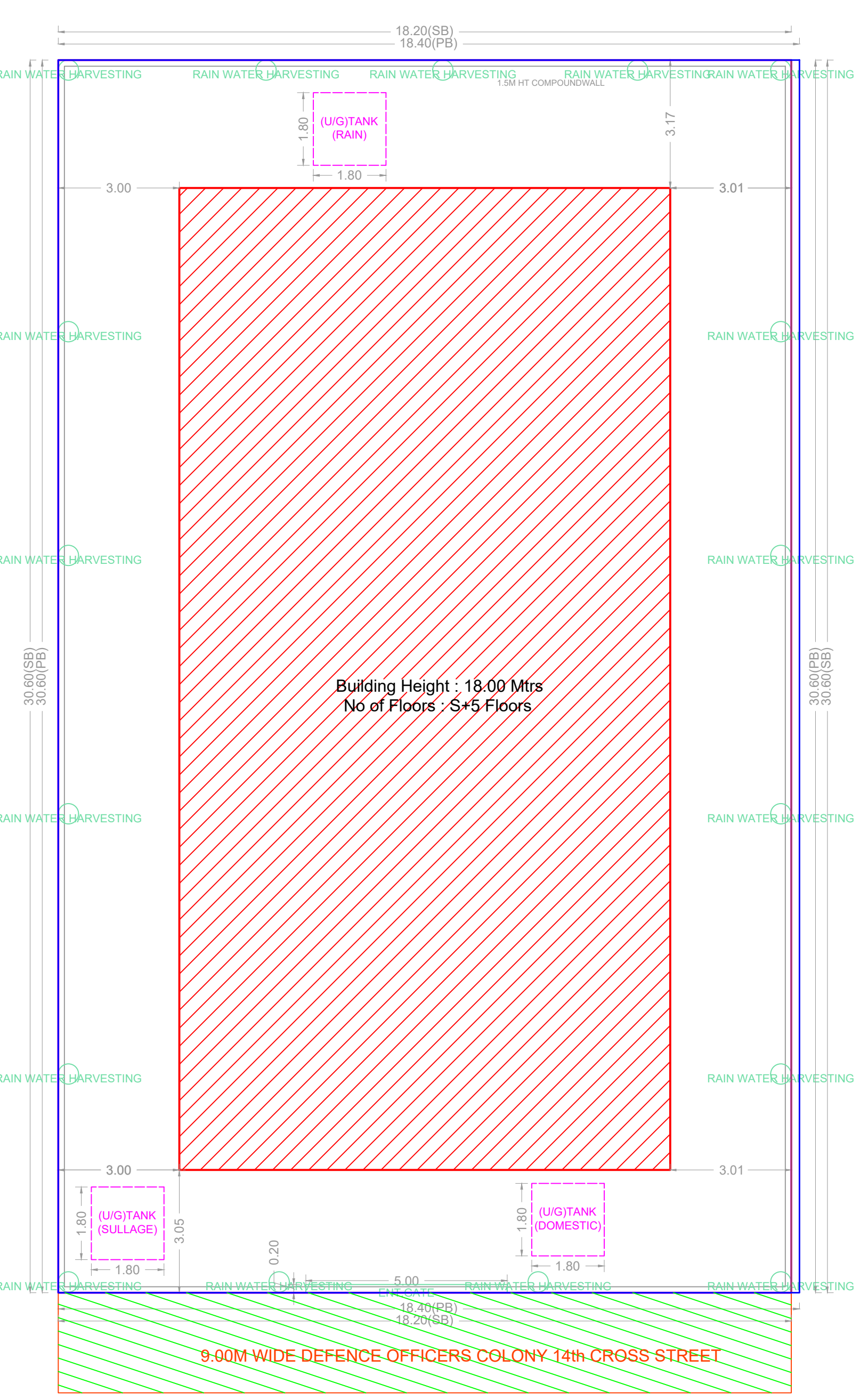

SITE PLAN

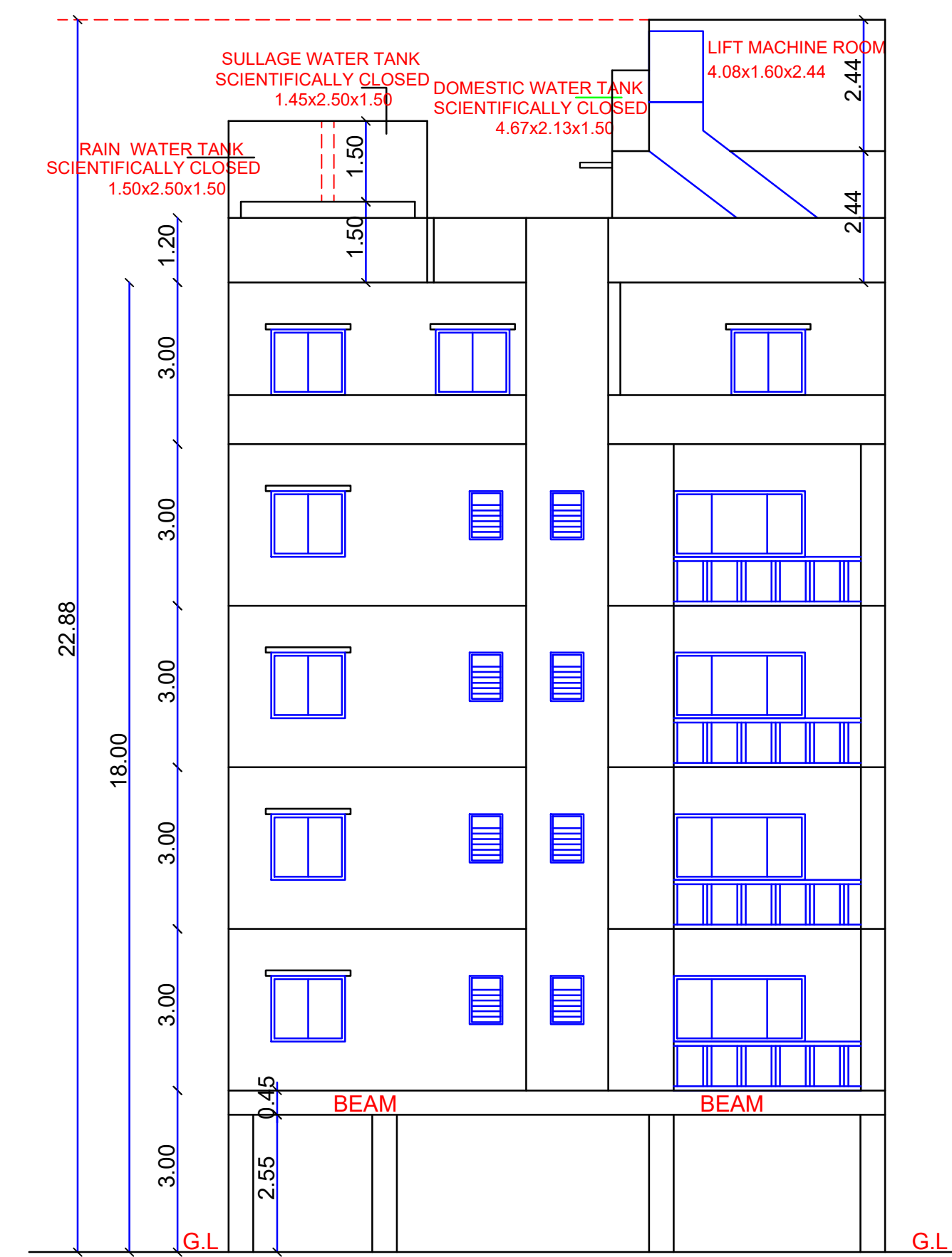

ELEVATION

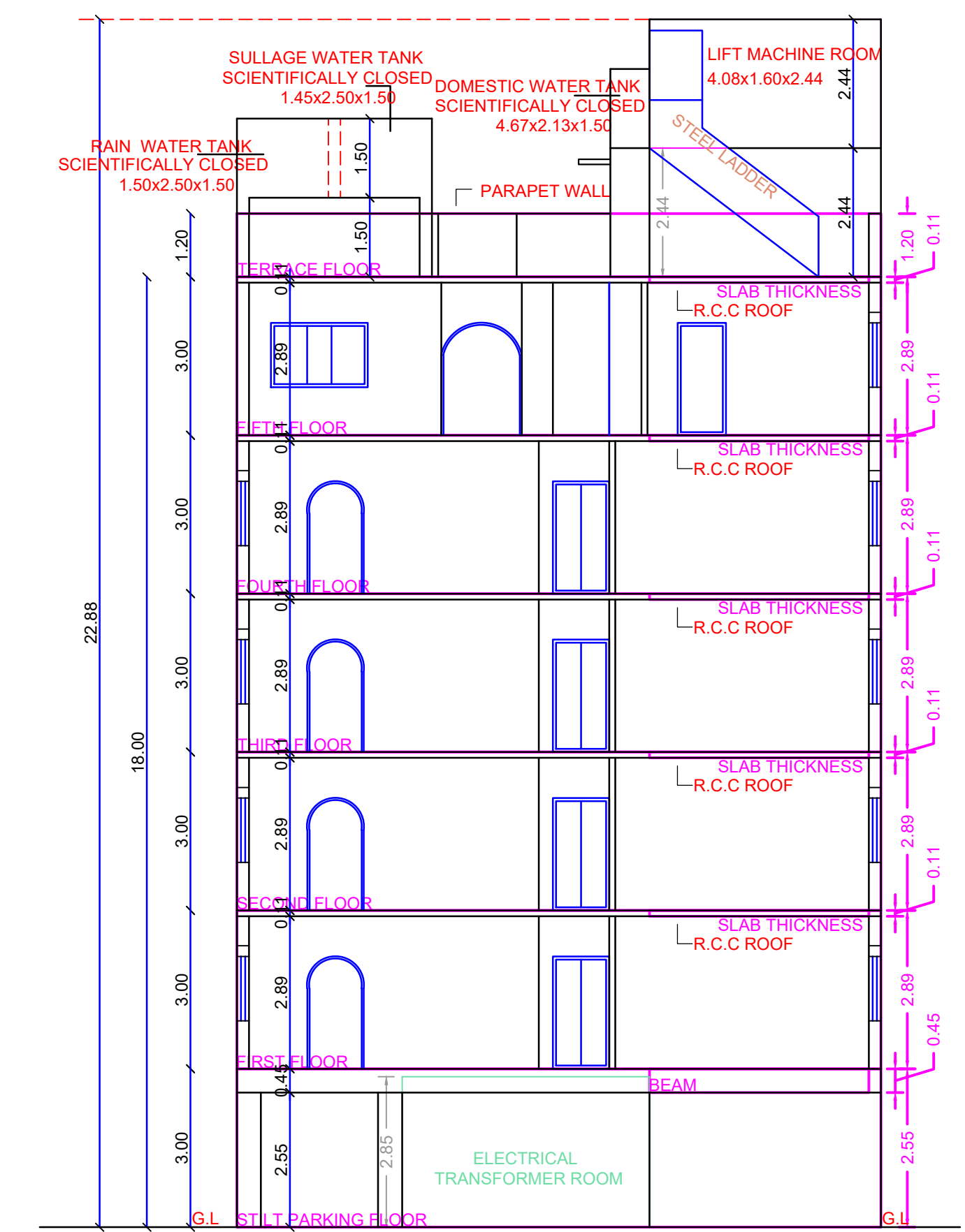

SECTION ON A-A

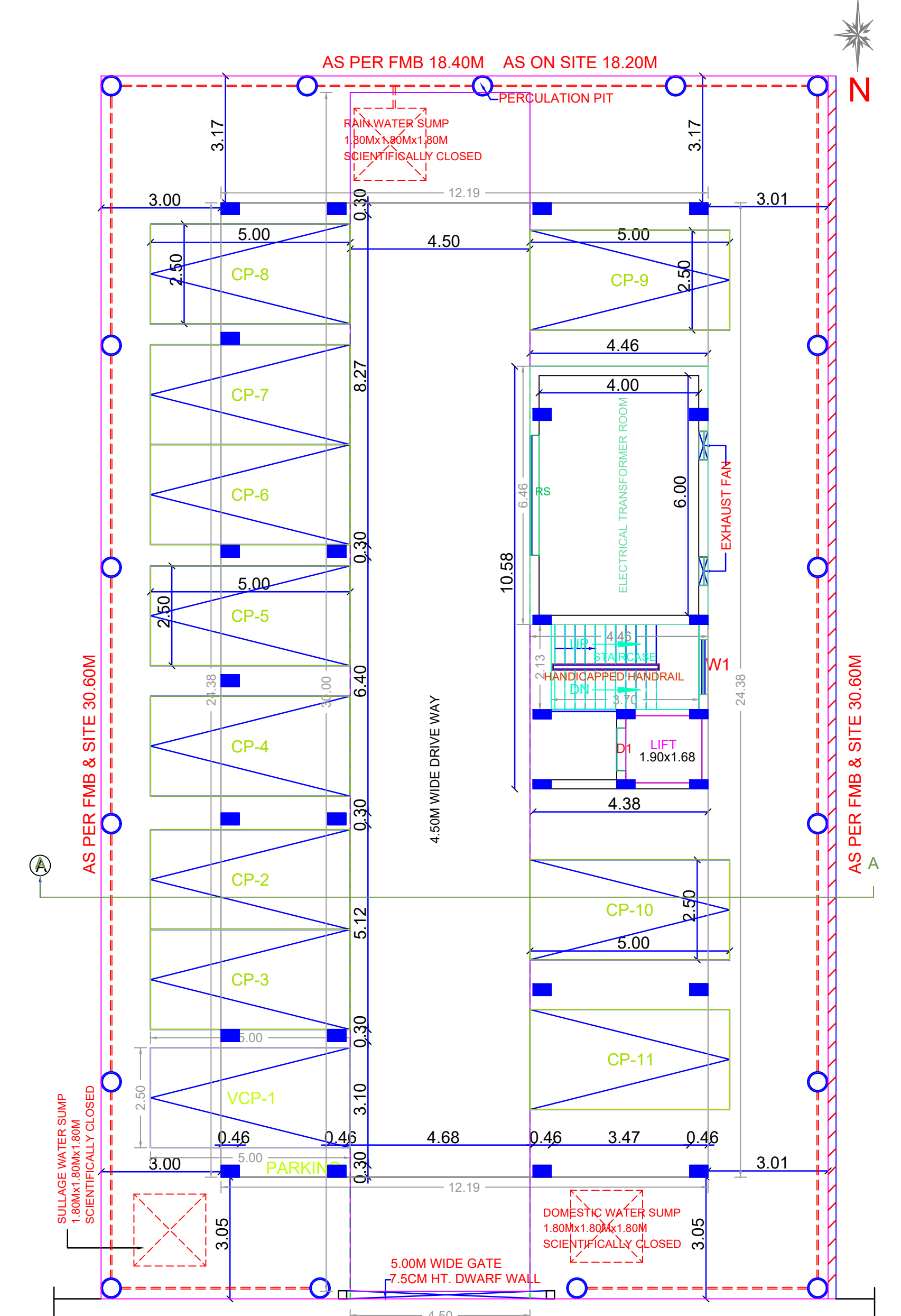

SITE CUM STILT FLOOR PLAN

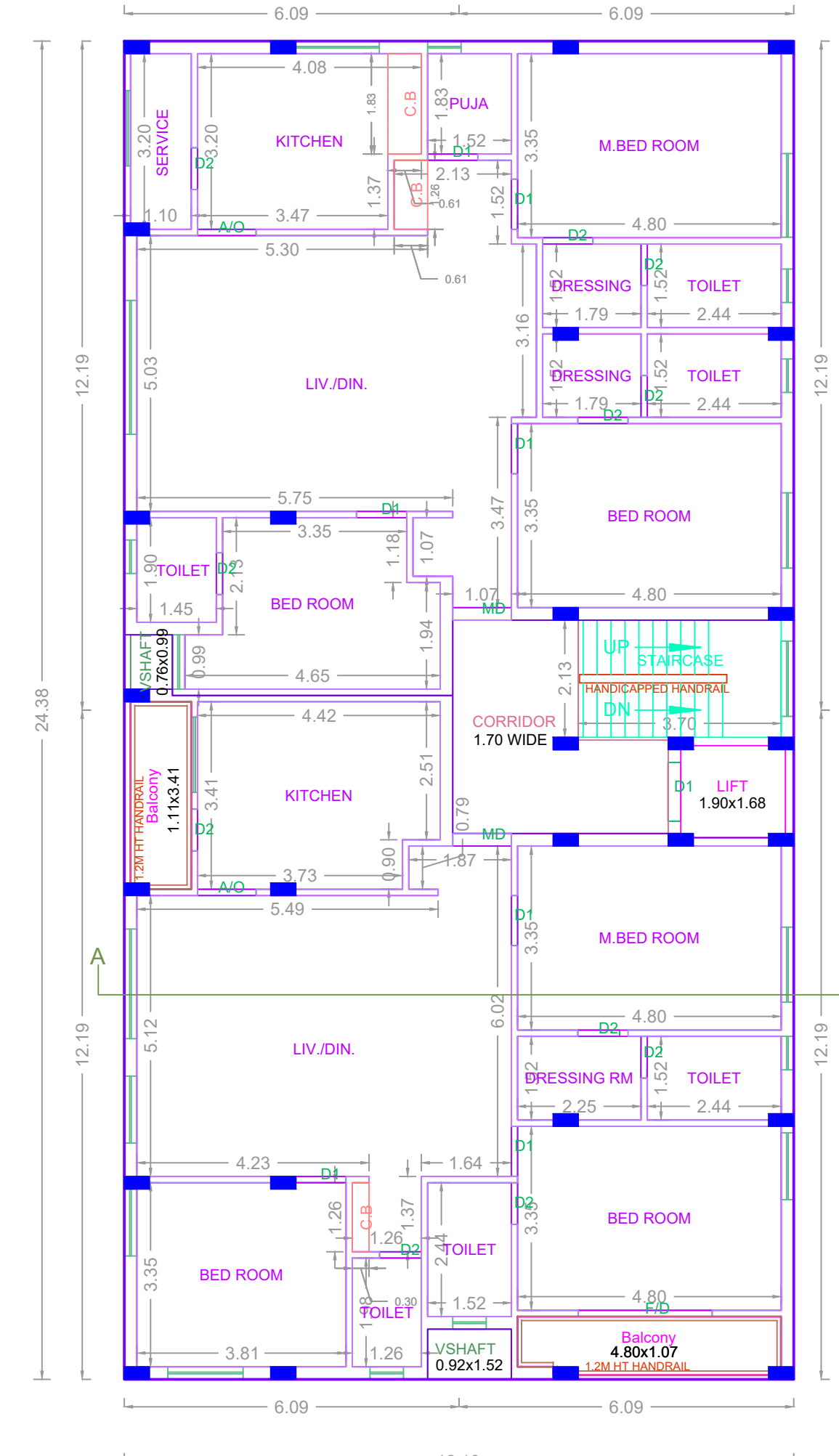

TYPICAL - 1- 4 FLOOR PLAN

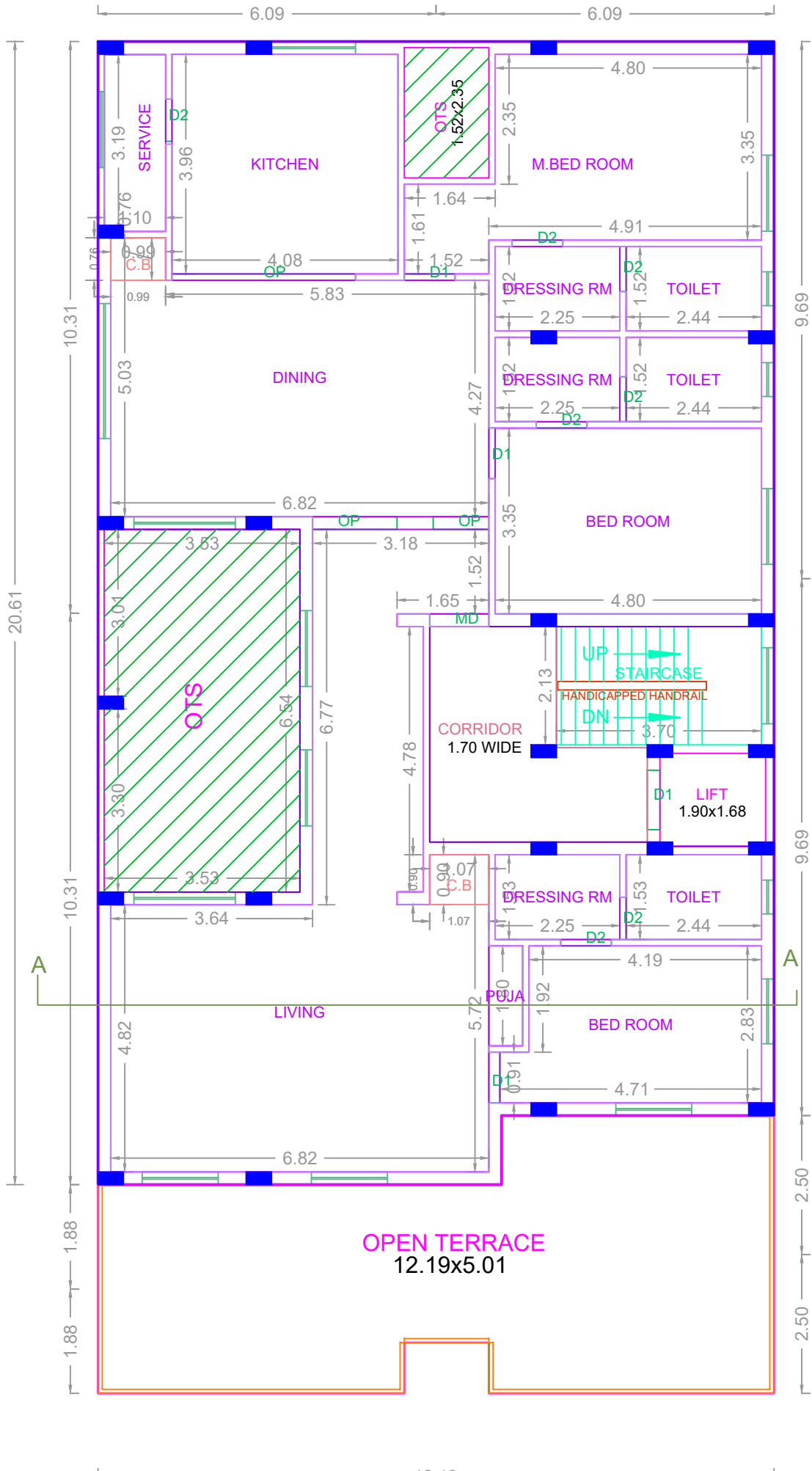

FIFTH FLOOR PART PLAN

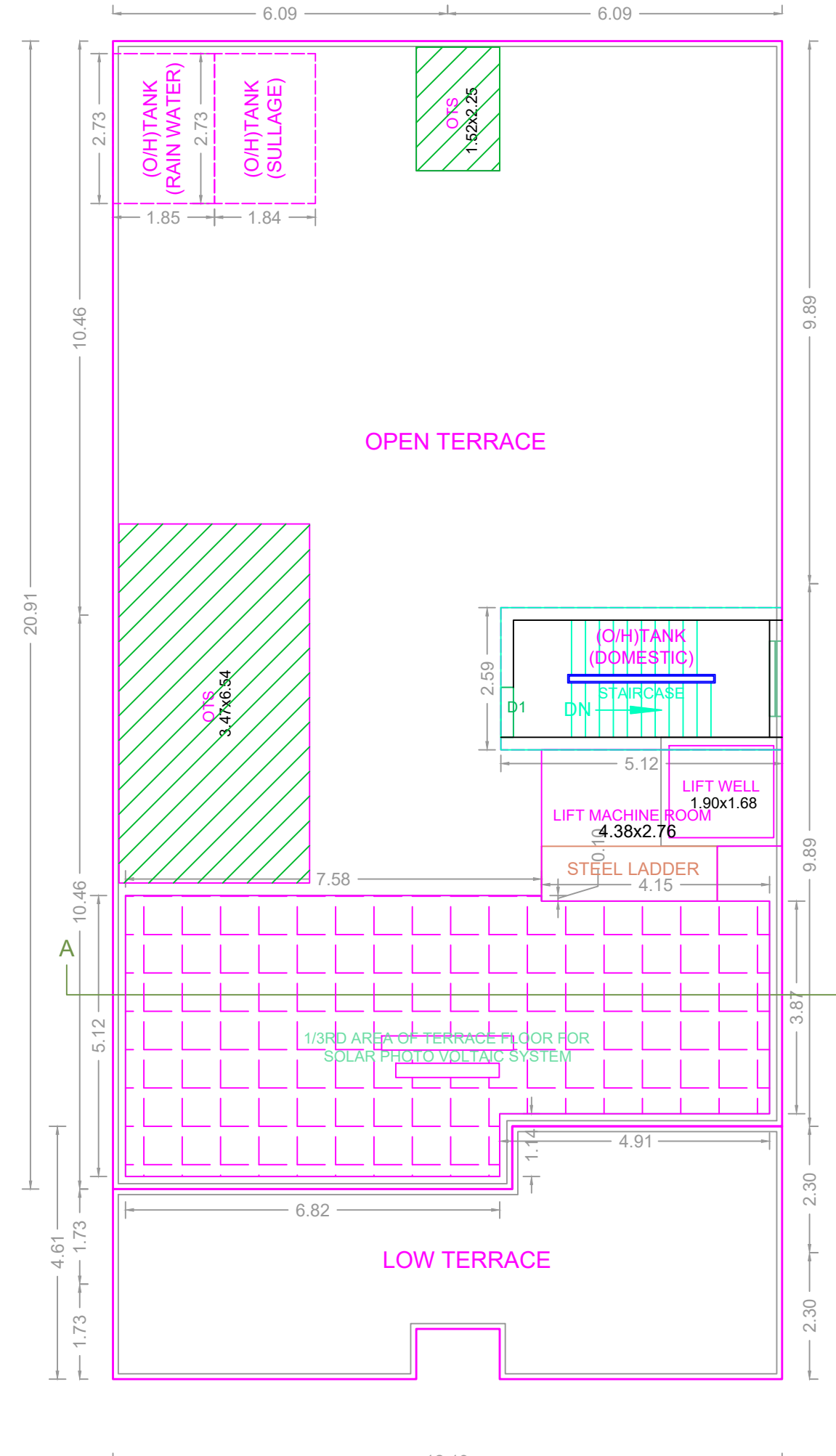

TERRACE FLOOR PLAN

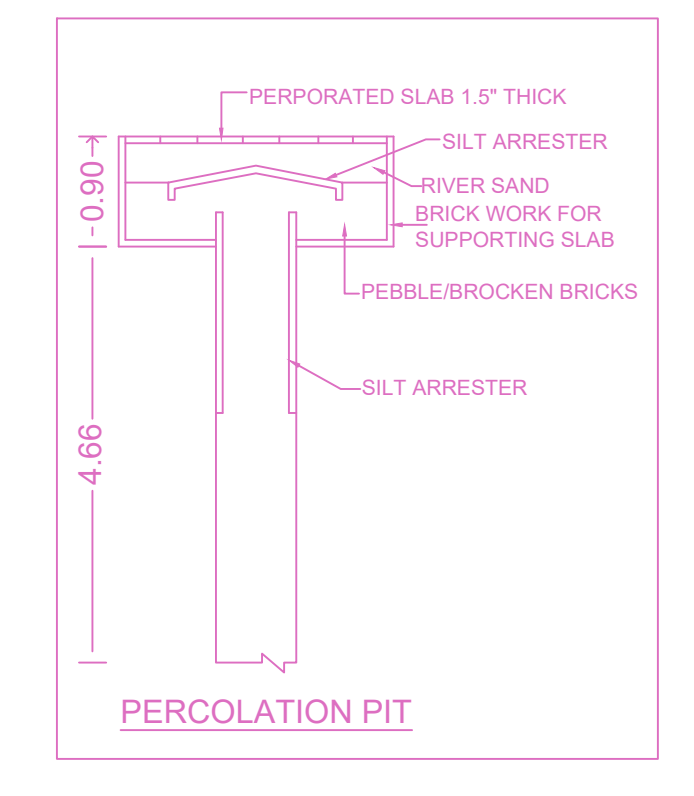

PERCOLATION PIT

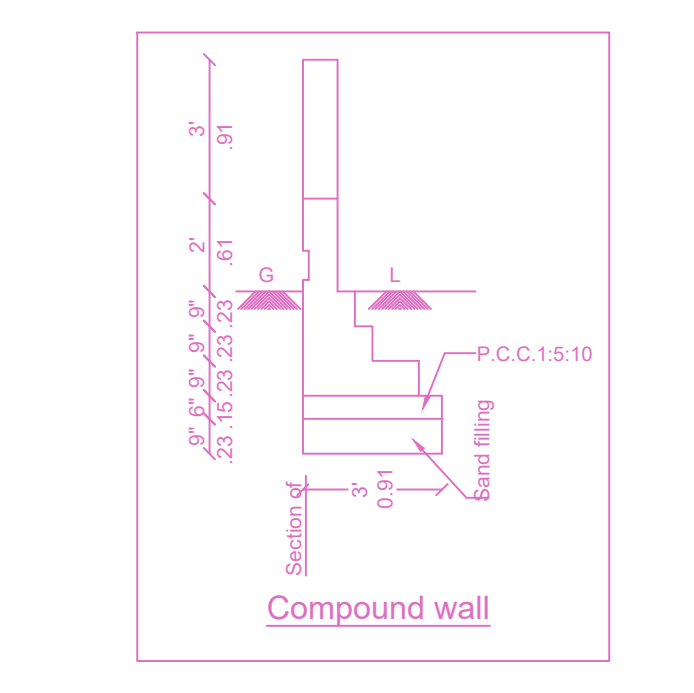

Compound wall

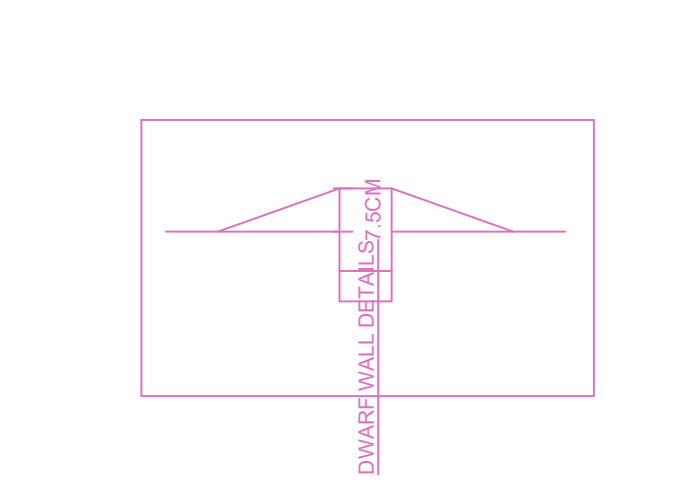

ELEVATION

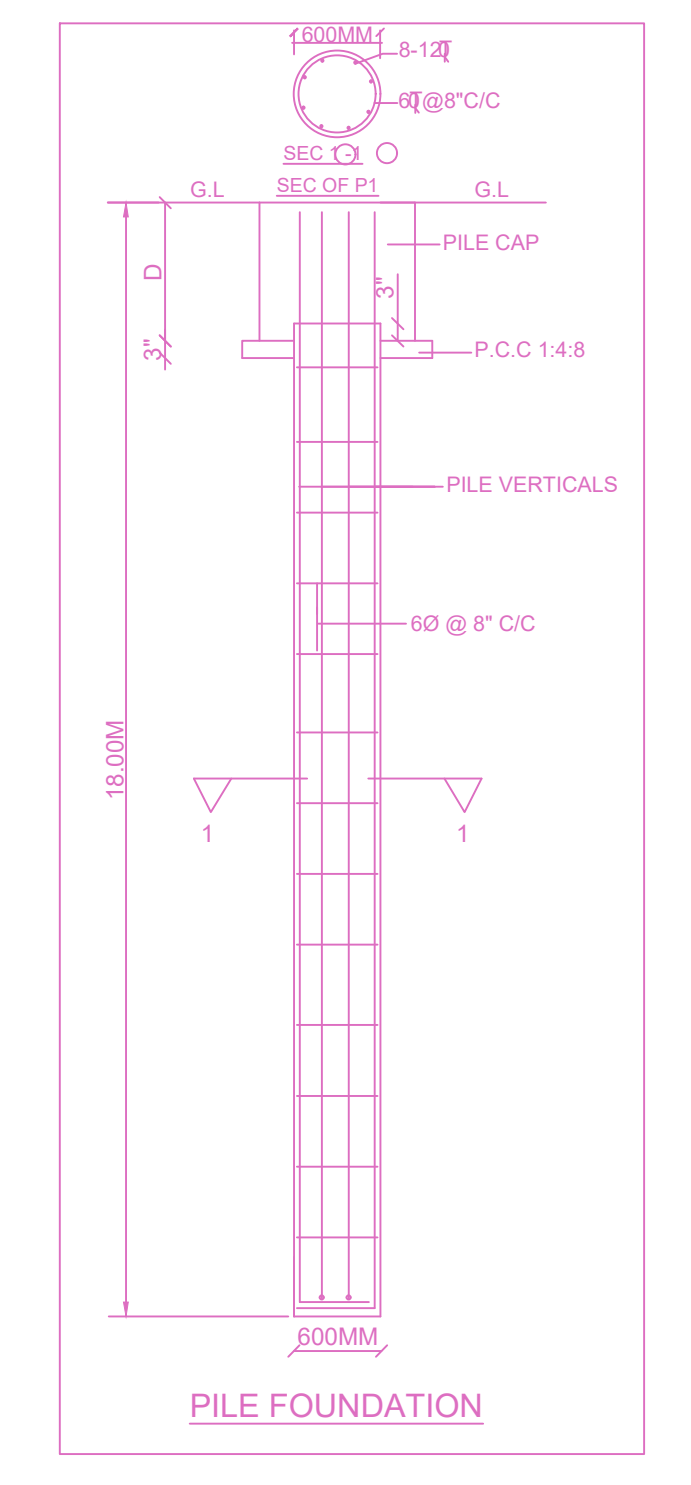

PILE FOUNDATION

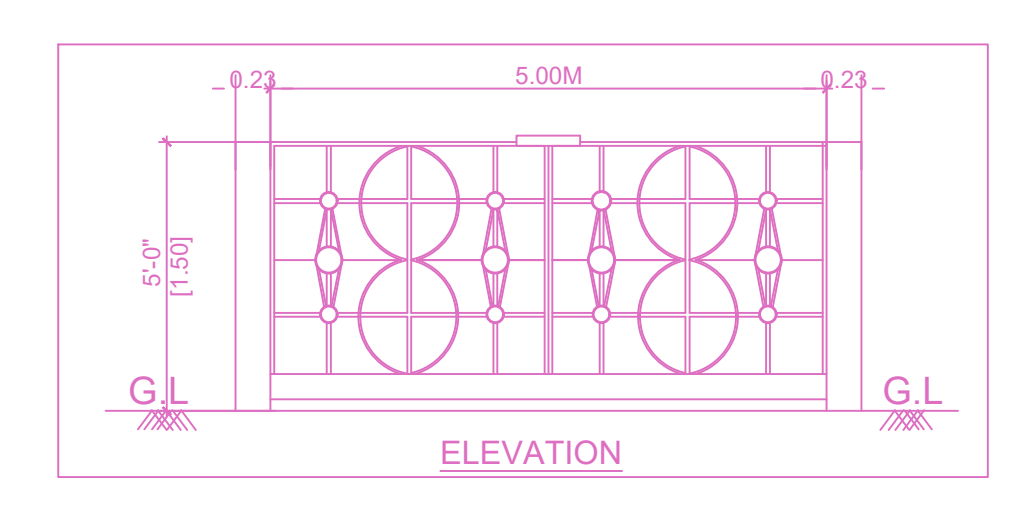

ELEVATION

FLOOR WISE FSI STATEMENT: BLOCK (RESI)

FLOORS	FSI AREA				DU	TOTAL FSI AREA
	COMM.	RESI.	IND.	SPEC.		
Terrace	0.00	0.00	0.00	0.00	0	0.00
FIFTH FLOOR	0.00	218.59	0.00	0.00	1	218.59
FOURTH FLOOR	0.00	295.04	0.00	0.00	2	295.04
THIRD FLOOR	0.00	295.04	0.00	0.00	2	295.04
SECOND FLOOR	0.00	295.04	0.00	0.00	2	295.04
FIRST FLOOR	0.00	295.04	0.00	0.00	2	295.04
STILT PARKING FLOOR	0.00	28.79	0.00	0.00	0	28.79
Total	0.00	1427.54	0.00	0.00	9	1427.54

BUILDING WISE FSI STATEMENT

BUILDING	NO OF SAME BUILDING	FSI AREA				DU	TOTAL FSI AREA
		COMM.	RESI.	IND.	SPEC.		
BLOCK-1 (RESI)	1	0.00	1427.54	0.00	0.00	9	1427.54
Total	1	0.00	1427.54	0.00	0.00	9	1427.54

APPROVAL CONDITION

CHENNAI METROPOLITAN DEVELOPMENT AUTHORITY
APPROVED
 SUBJECT TO THE CONDITIONS MENTIONED IN THIS OFFICE

SCALE: 1:100
 CHENNAI METROPOLITAN DEVELOPMENT AUTHORITY
 APPROVED
 SUBJECT TO THE CONDITIONS MENTIONED IN THIS OFFICE
 For Check/Planner / Chief Planner / Member Secretary
 High Rise Building / Non High Rise Building
 This Approval is valid only after building Permit is issued by the concerned Local Body.
 KEY NO. 5688
 QR CODE