

PLAN SHOWING THE PROPOSED CONSTRUCTION OF STILT FLOOR + 3 FLOORS (12.0M HEIGHT) RESIDENTIAL BUILDING WITH 16 DWELLING UNITS AT PLOT NO.1, (GCC APPROVED LAYOUT -SD/WDCN15/00248/2022), LAYOUT ROAD, SEMMANCHERY, SHOLINGANALLUR COMPRISED IN OLD S.NO.15/2A2, 15/2B2, T.S.NO.3, BLOCK NO.2, WARD F OF SEMMANCHERY VILLAGE, SHOLINGANALLUR TALUK WITHIN THE LIMITS OF GREATER CHENNAI CORPORATION.

A) AREA STATEMENT		SQ.M.
AREA AS PER PATTA		7250.00
AREA AS PER DOCUMENT		975.53
AREA CONSIDERED FOR FSI		975.51
STREET ALIGNMENT/ ROAD WIDENING/LINK ROAD		0.00
OSR AREA		0.00
TOTAL FSI AREA		1762.03
FSI FACTOR		1.806
COVERAGE AREA (PERCENTAGE %)		NA

A) PARKING STATEMENT		
VEHICLE	REQUIRED	PROVIDED
LORRY	0	0
CAR	15	15
TWO WHEELER	4	20
CYCLE	0	0

Building Height : 12.00 Mtrs
No of Floors : S + 3

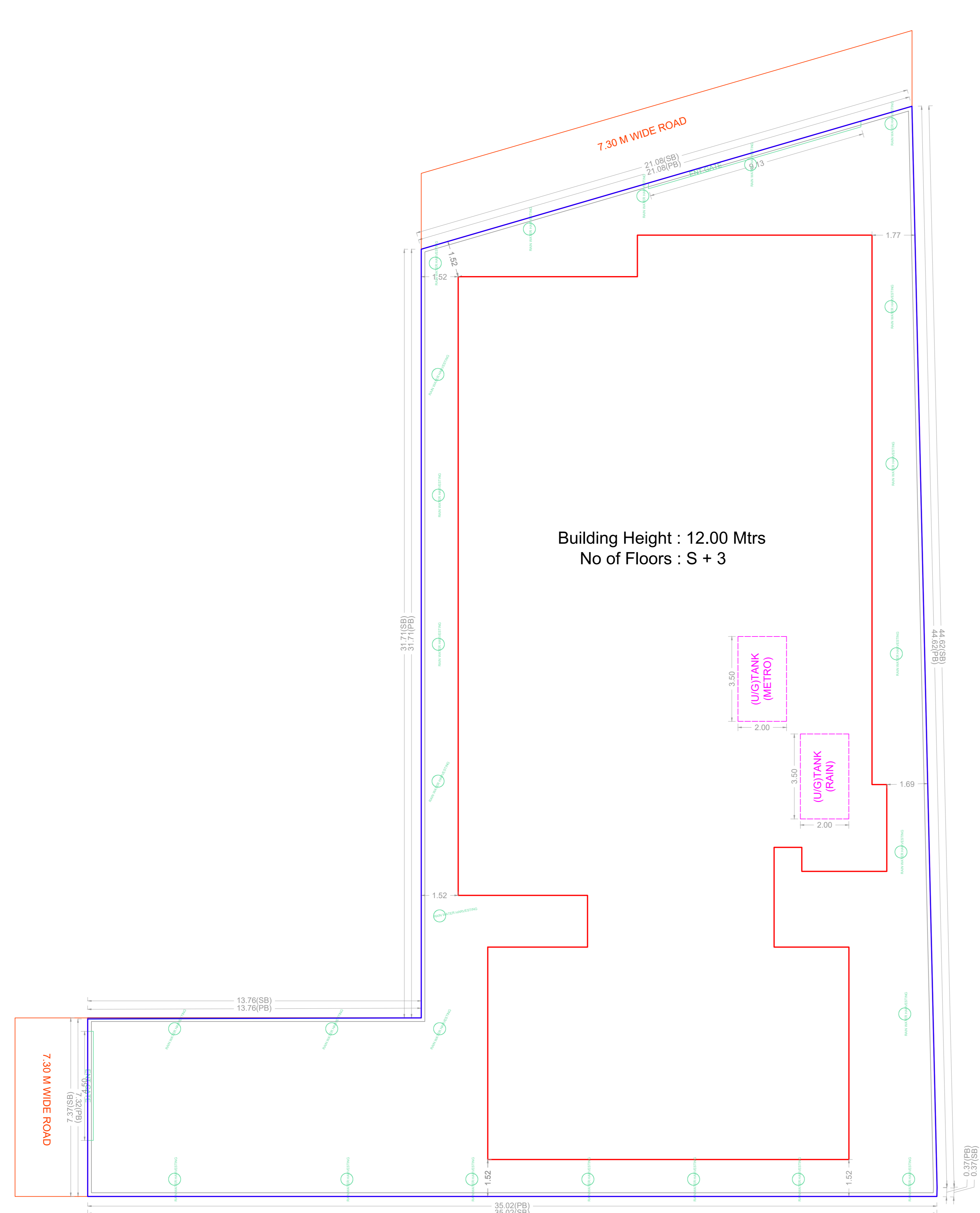

SITE PLAN

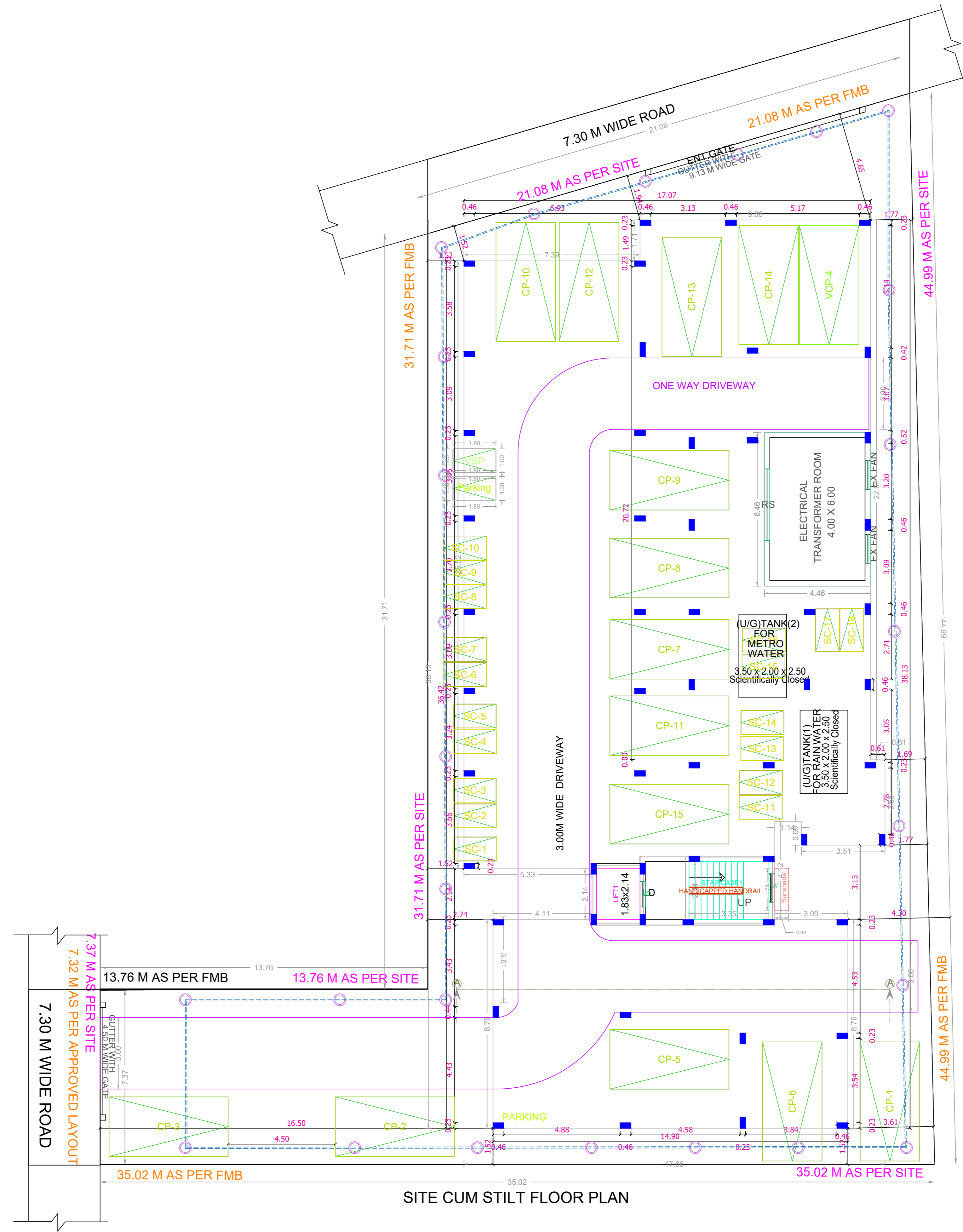

SITE CUM STILT FLOOR PLAN

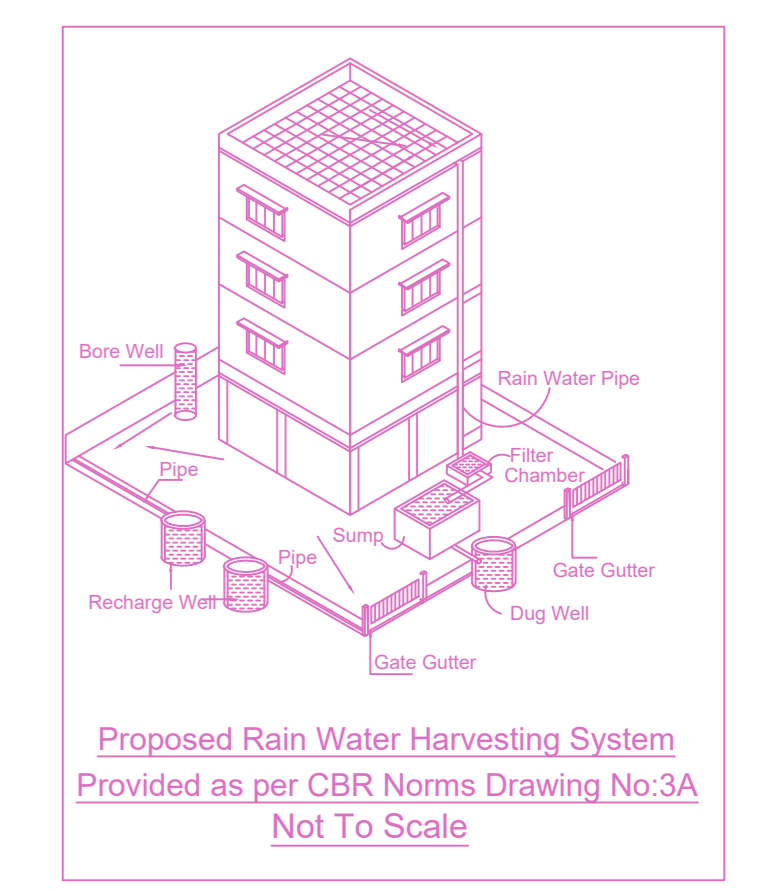
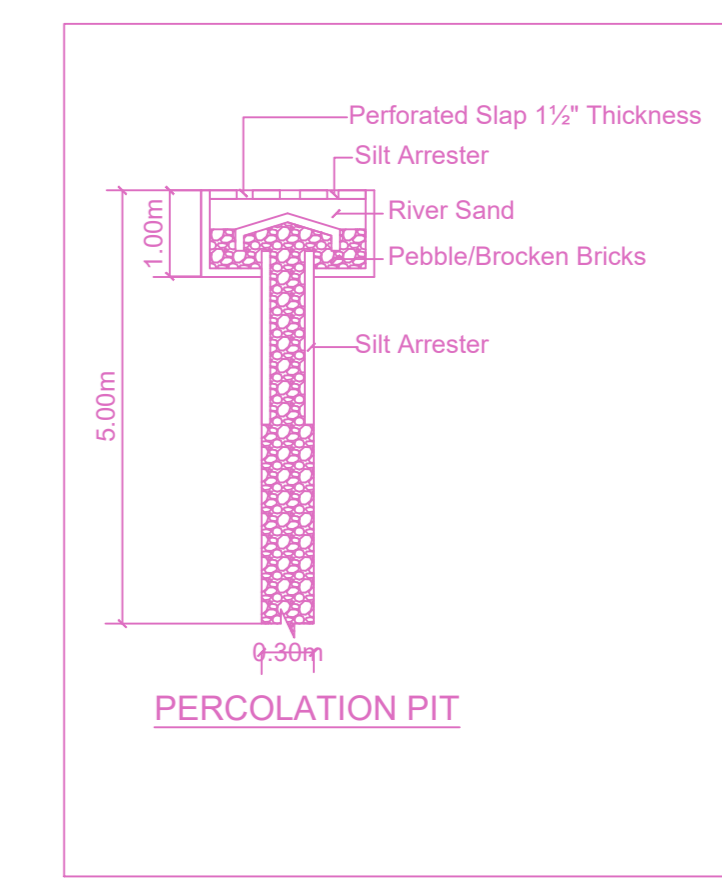
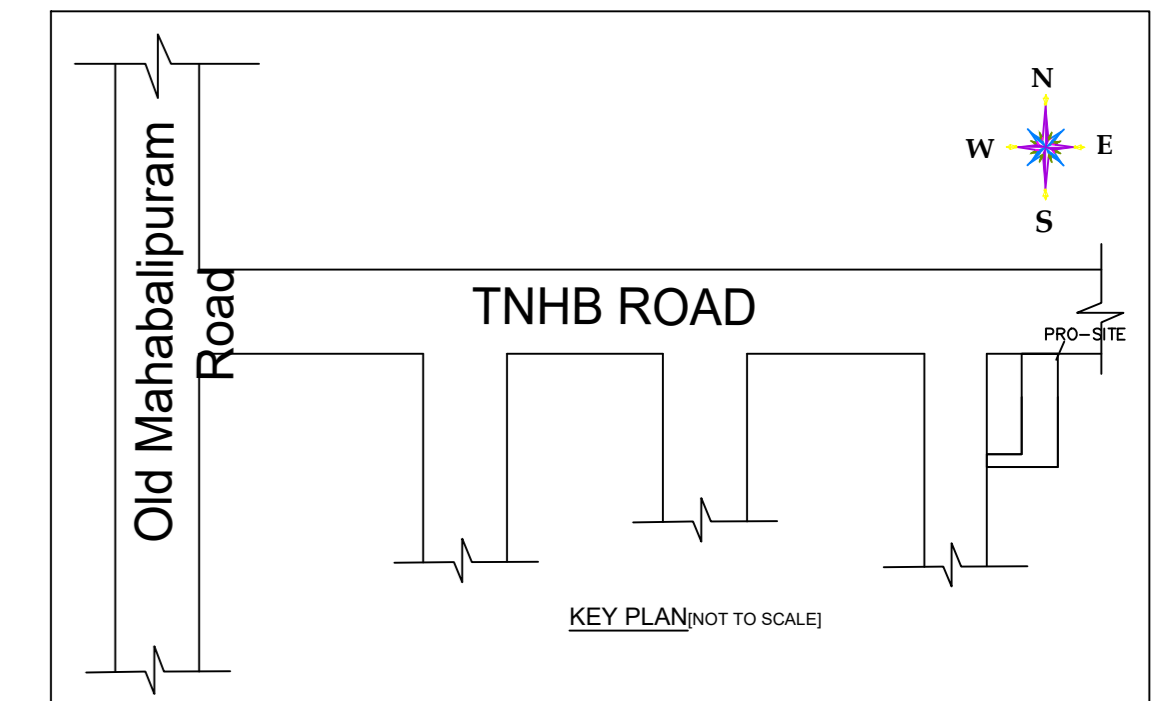

Proposed Rain Water Harvesting System Provided as per CBR Norms Drawing No.3A Not To Scale

FLOOR WISE FSI STATEMENT: NHRB (RES)

FLOORS	COMM.	RESI.	IND.	SPEC.	DU	TOTAL FSI AREA
Terrace	0.00	0.00	0.00	0.00	0	0.00
THIRD FLOOR	0.00	577.74	0.00	0.00	4	577.74
SECOND FLOOR	0.00	577.74	0.00	0.00	6	577.74
FIRST FLOOR	0.00	577.74	0.00	0.00	6	577.74
STILT PARKING FLOOR	0.00	28.81	0.00	0.00	0	28.81
Total	0.00	1762.03	0.00	0.00	16	1762.03

BUILDING WISE FSI STATEMENT

BUILDING	NO OF SAME BUILDING	COMM.	RESI.	IND.	SPEC.	DU	TOTAL FSI AREA
NHRB-1 (RES)		0.00	1762.03	0.00	0.00	16	1762.03
Total		0.00	1762.03	0.00	0.00	16	1762.03

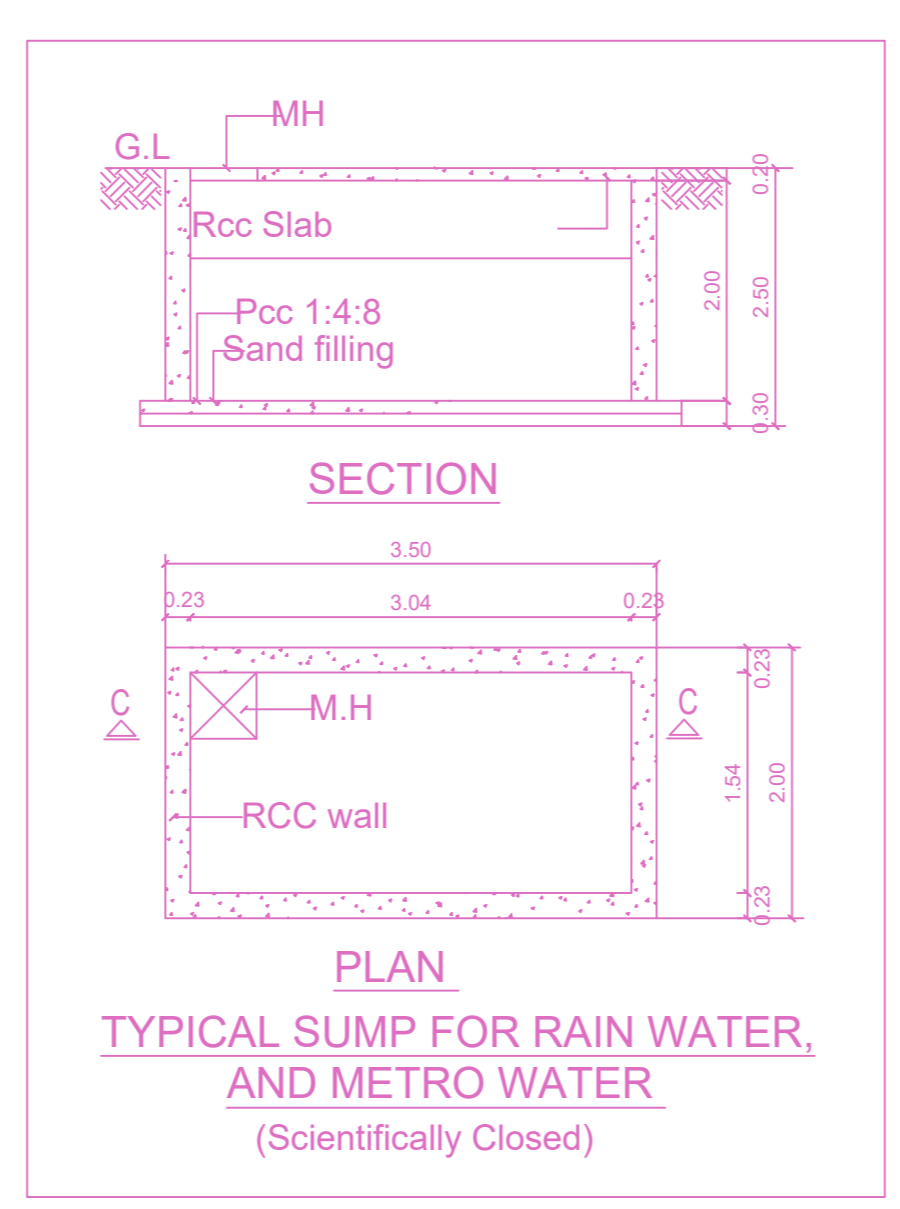

TYPICAL SUMP FOR RAIN WATER AND METRO WATER (Scientifically Closed)

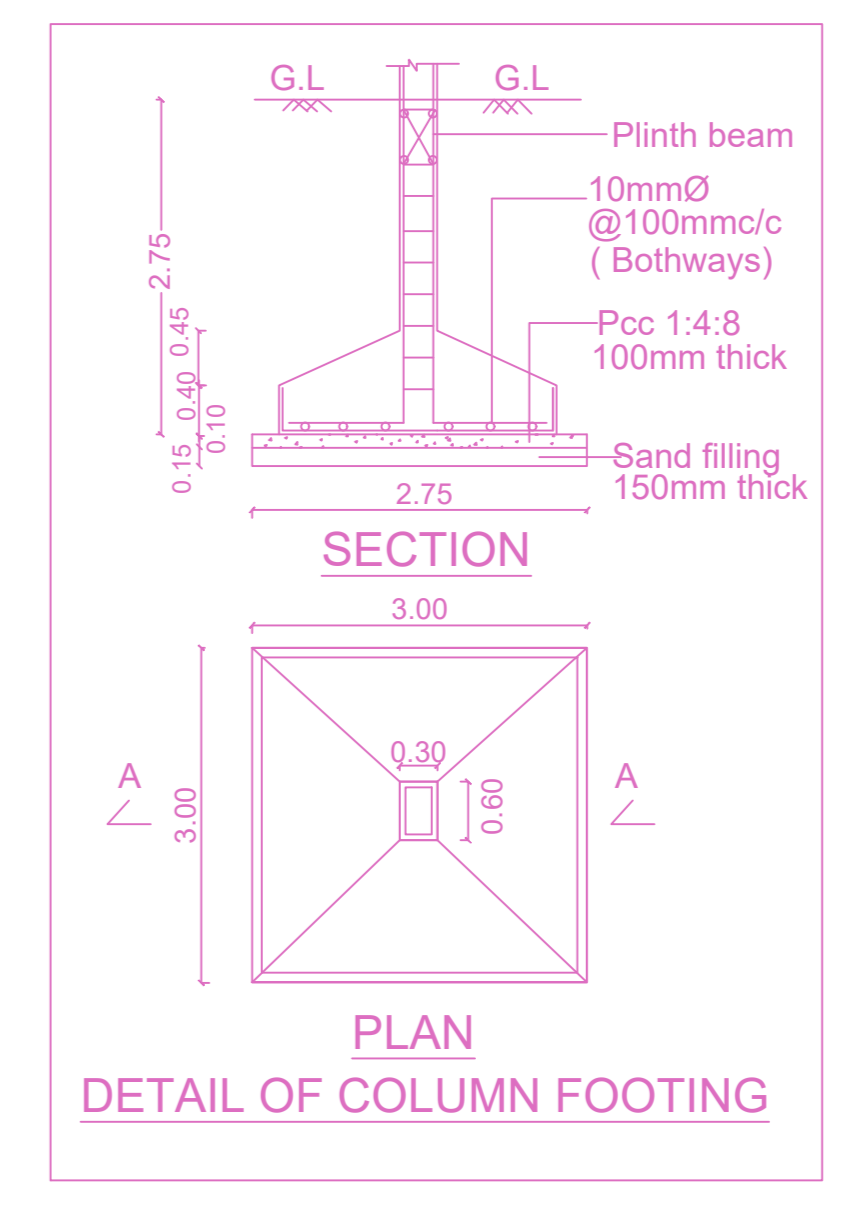
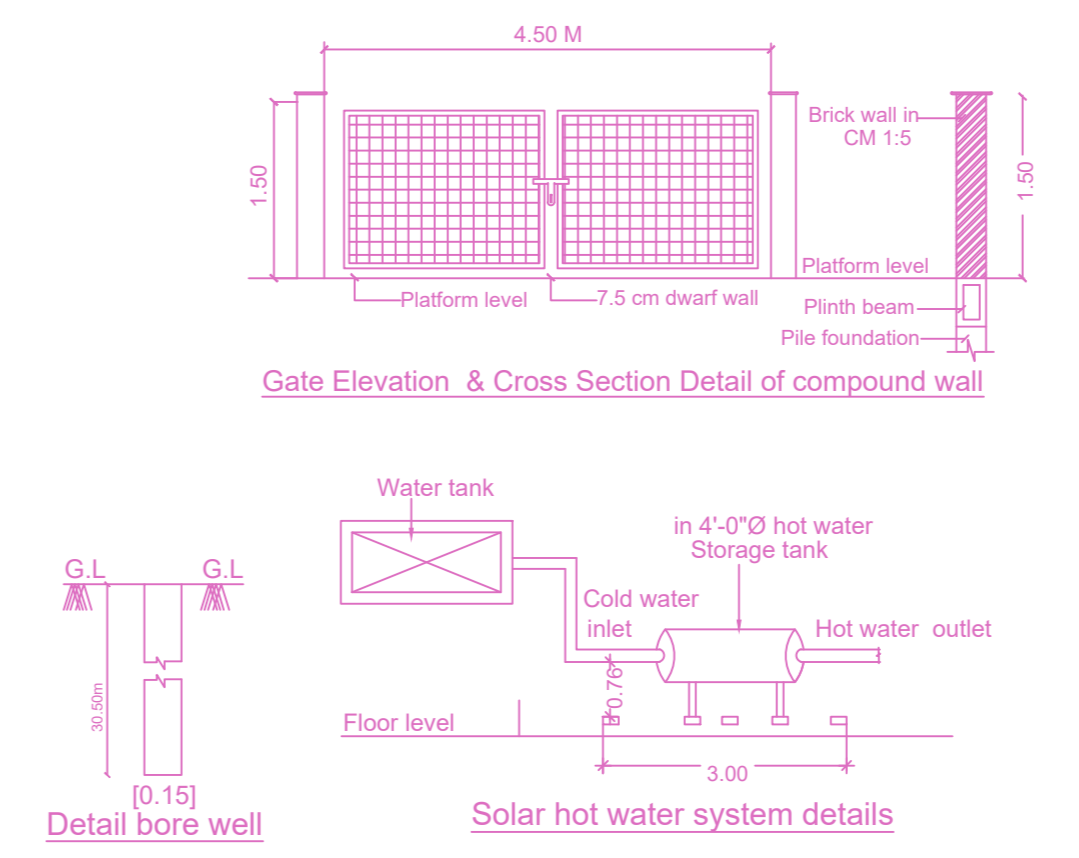
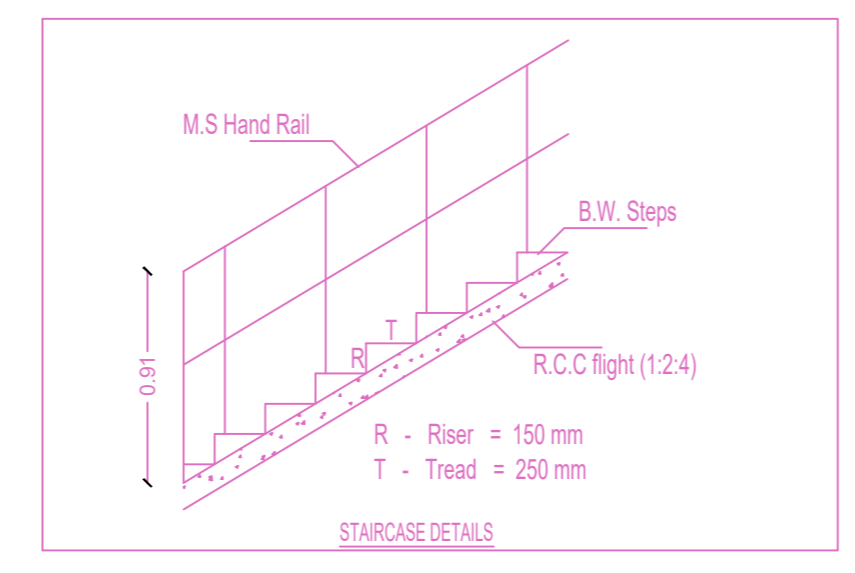

DETAIL OF COLUMN FOOTING

APPROVAL CONDITION

016 Dated November

PREP. BY: [Name]
CHECK. BY: [Name]
ISSUED: [Date]

SCALE 1:100

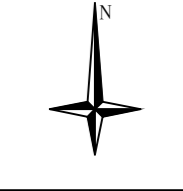

CHENNAI METROPOLITAN DEVELOPMENT AUTHORITY

APPROVED

SUBJECT TO THE CONDITIONS MENTIONED IN THIS OFFICE

For (Deputy Planner / Chief Planner / Member-Secretary)
High Rise Building / Non High Rise Building
This Approval is valid only after building Permit is issued by the concerned Local Body.

KEY NO. 2688

