

ELEVATION

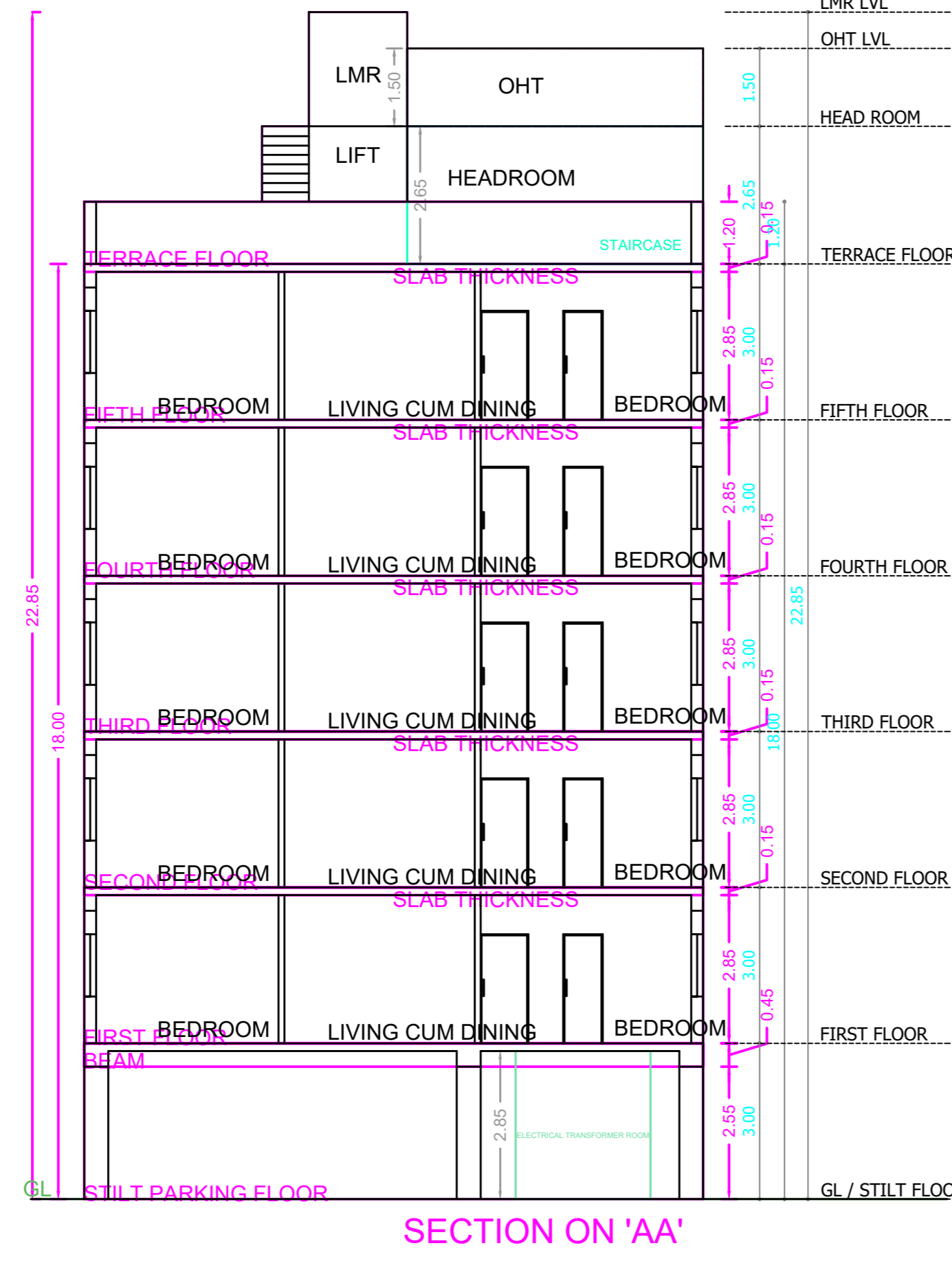

SECTION ON 'AA'

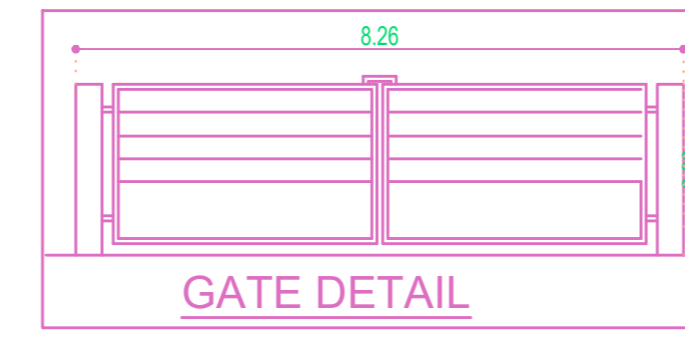
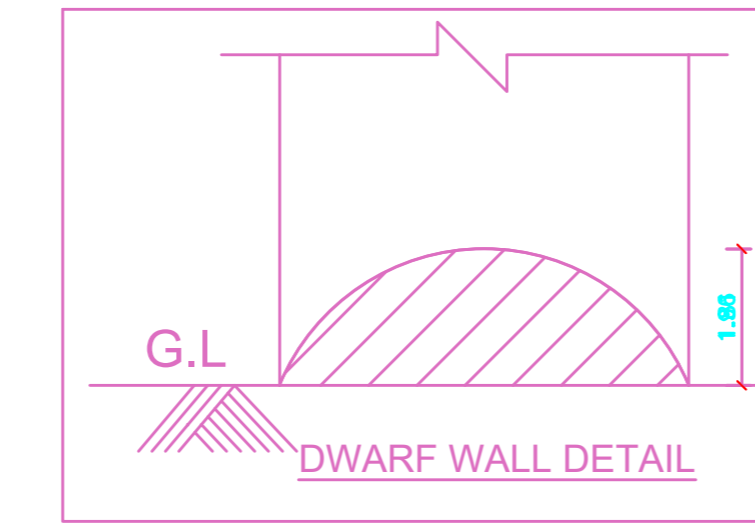

GATE DETAIL

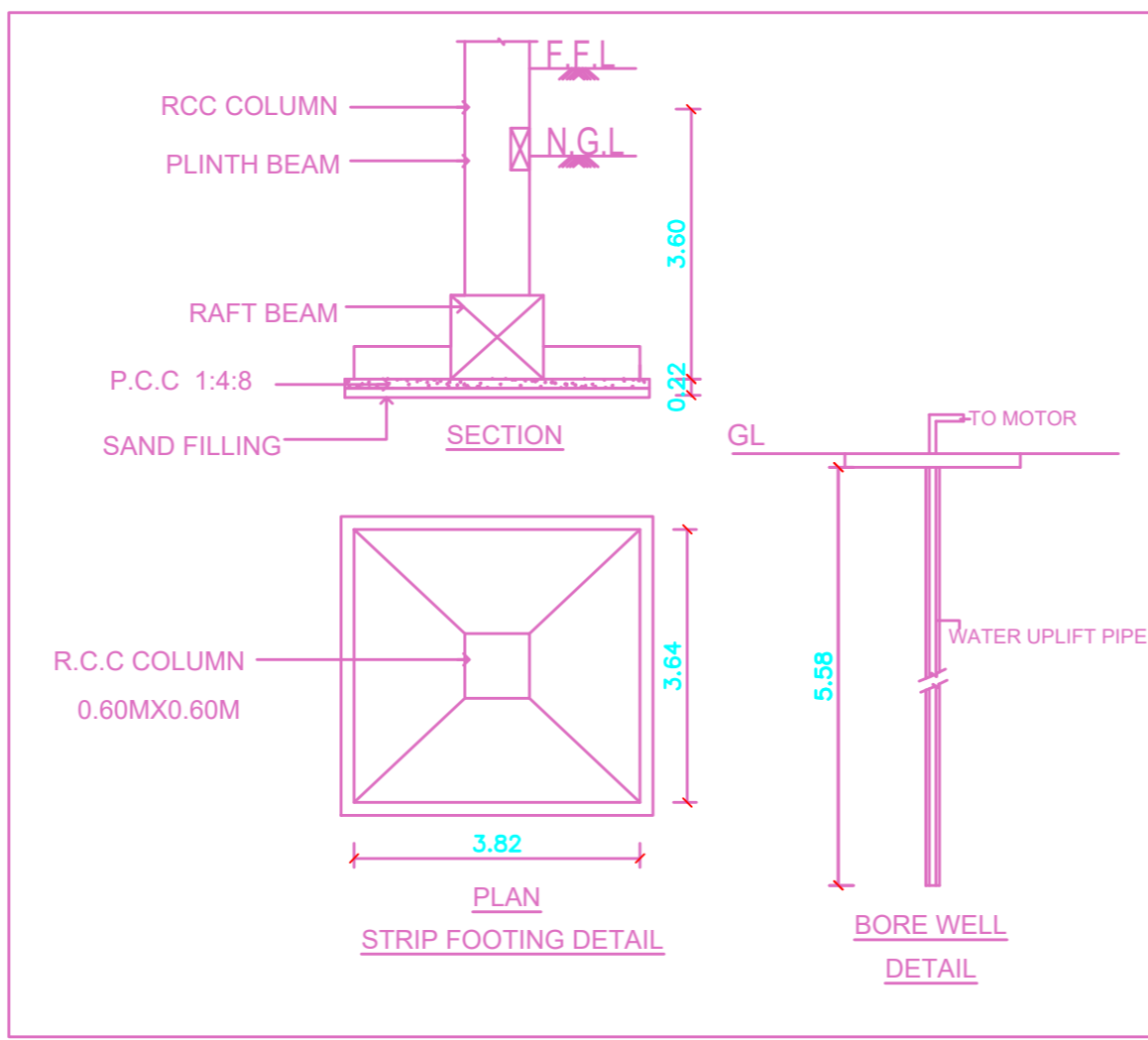

STRIP FOOTING DETAIL

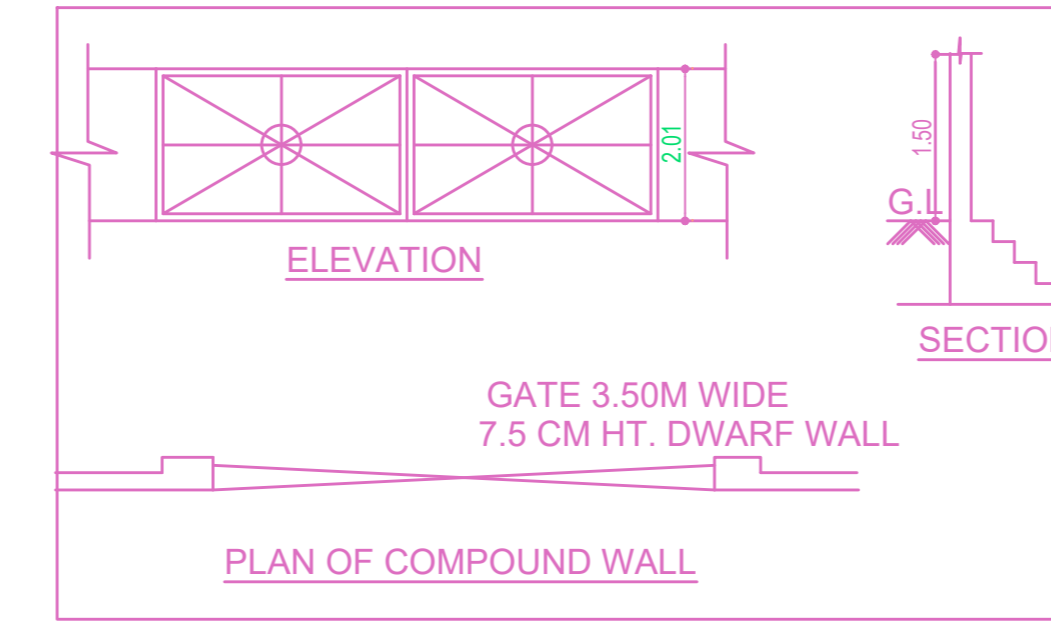

ELEVATION

PLAN OF COMPOUND WALL

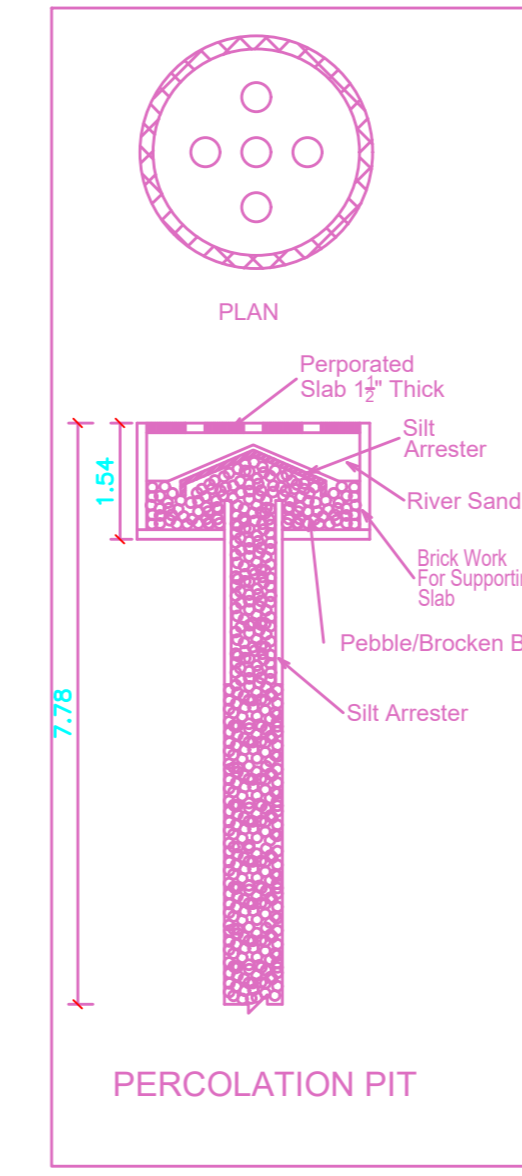

PERCOLATION PIT

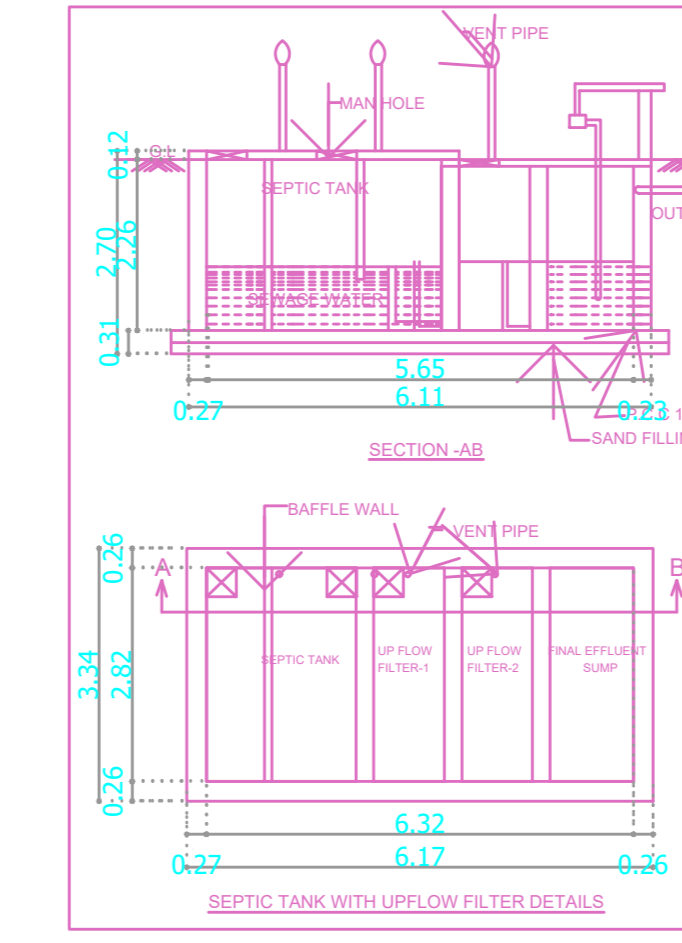

SEPTIC TANK WITH UPFLOW FILTER DETAILS

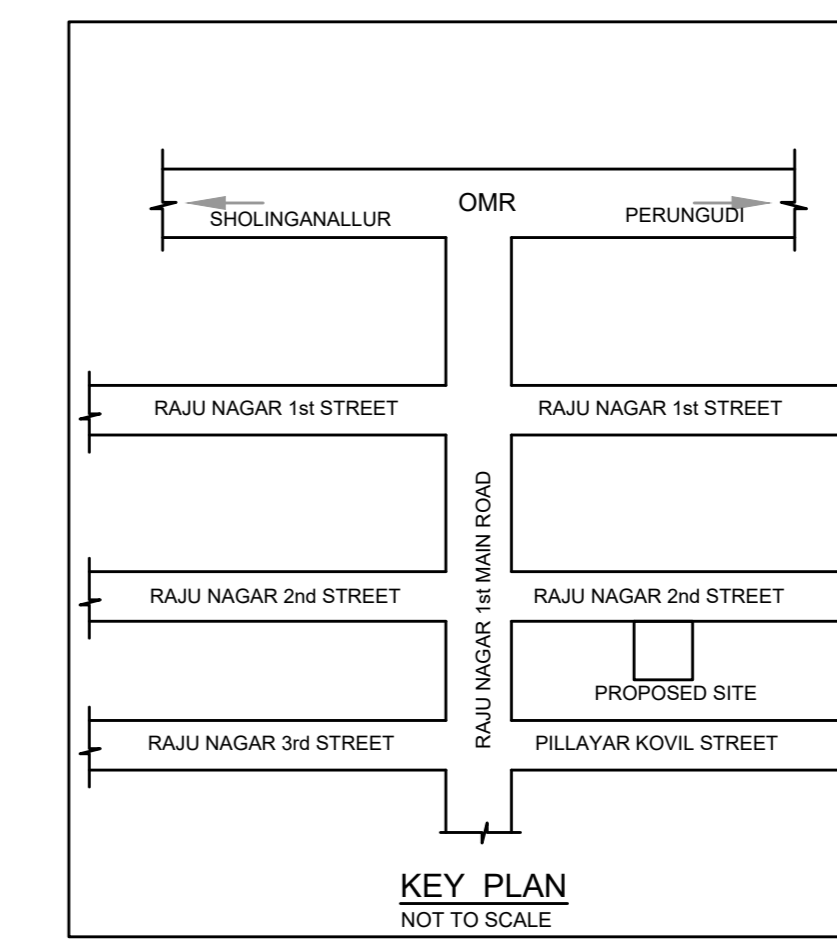

Location plan (Taken as per User Inputs)

PLAN SHOWING THE PROPOSED CONSTRUCTION OF STILT + 5 FLOORS RESIDENTIAL BUILDING WITH 10 DWELLING UNITS AVAILING PREMIUM FSI AT PLOT NO.57, RAJU NAGAR 2ND STREET, OKKIAM THORAIPAKKAM, CHENNAI IN COMPRISED IN S.NO.213/4 OF OKKIAM THORAIPAKKAM VILLAGE WITHIN THE LIMIT OF GREATER CHENNAI CORPORATION.

| A) AREA STATEMENT | SQ.M. |
|---|---------|
| AREA AS PER PATTA | 470.00 |
| AREA AS PER DOCUMENT | 473.80 |
| AREA CONSIDERED FOR FSI | 470.00 |
| STREET ALIGNMENT/ ROAD WIDENING/LINK ROAD | 0.00 |
| OSR AREA | 0.00 |
| TOTAL FSI AREA | 1187.20 |
| FSI FACTOR | 2.526 |
| COVERAGE AREA (PERCENTAGE %) | NA |

| A) PARKING STATEMENT | REQUIRED | PROVIDED |
|----------------------|----------|----------|
| VEHICLE | | |
| LORRY | 0 | 0 |
| CAR | 11 | 11 |
| TWO WHEELER | 0 | 0 |
| CYCLE | 0 | 0 |

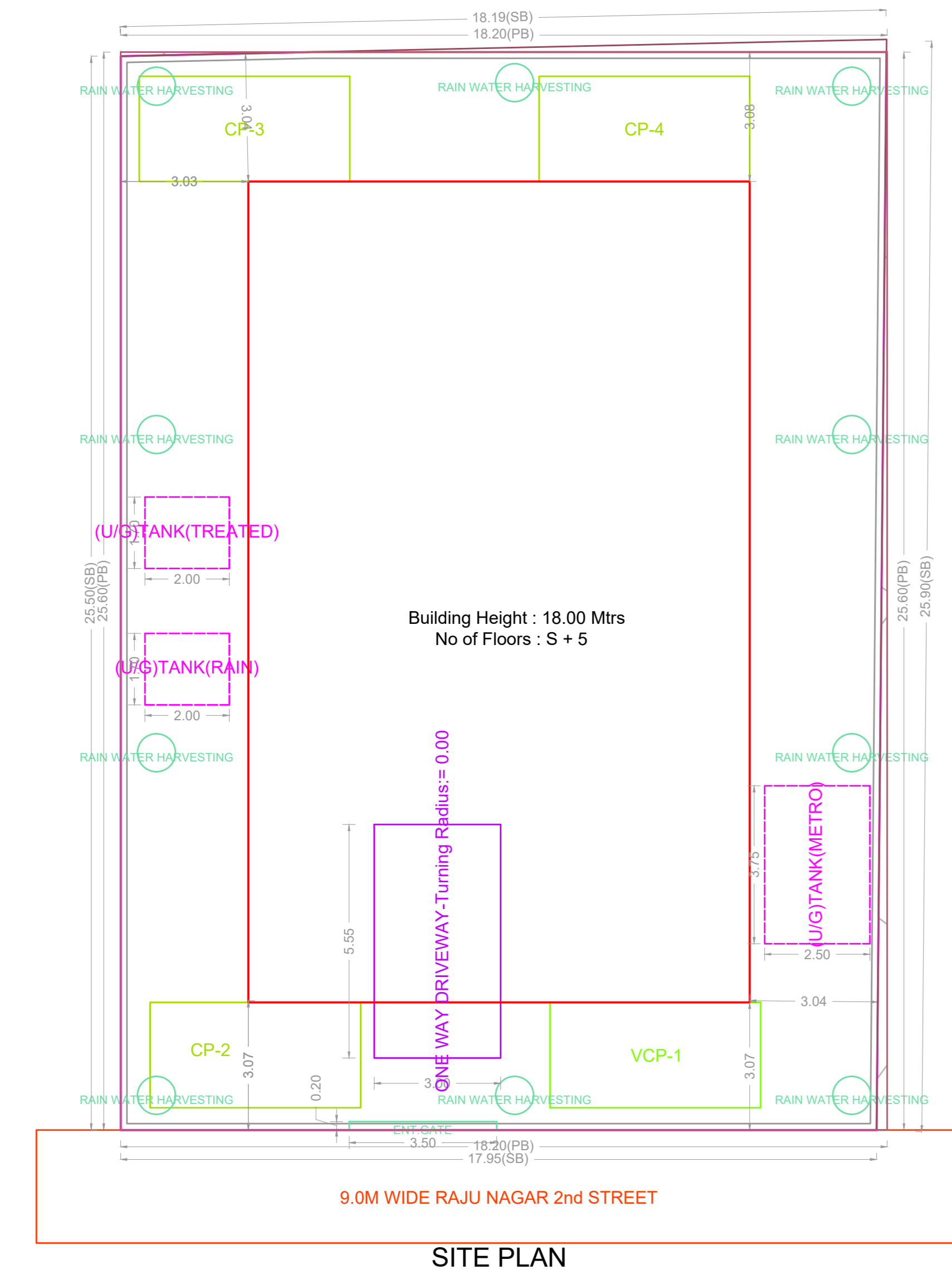

SITE PLAN

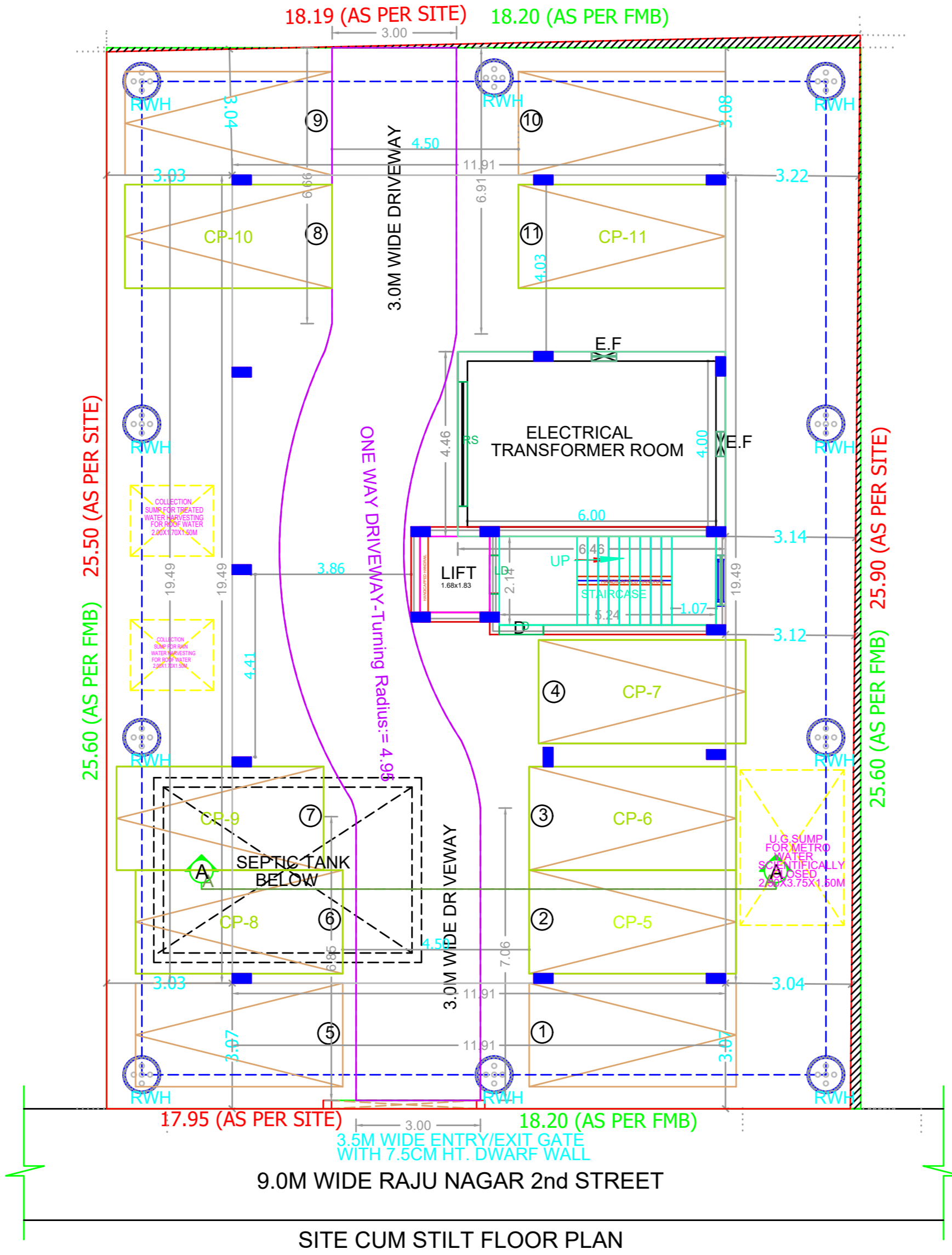

SITE CUM STILT FLOOR PLAN

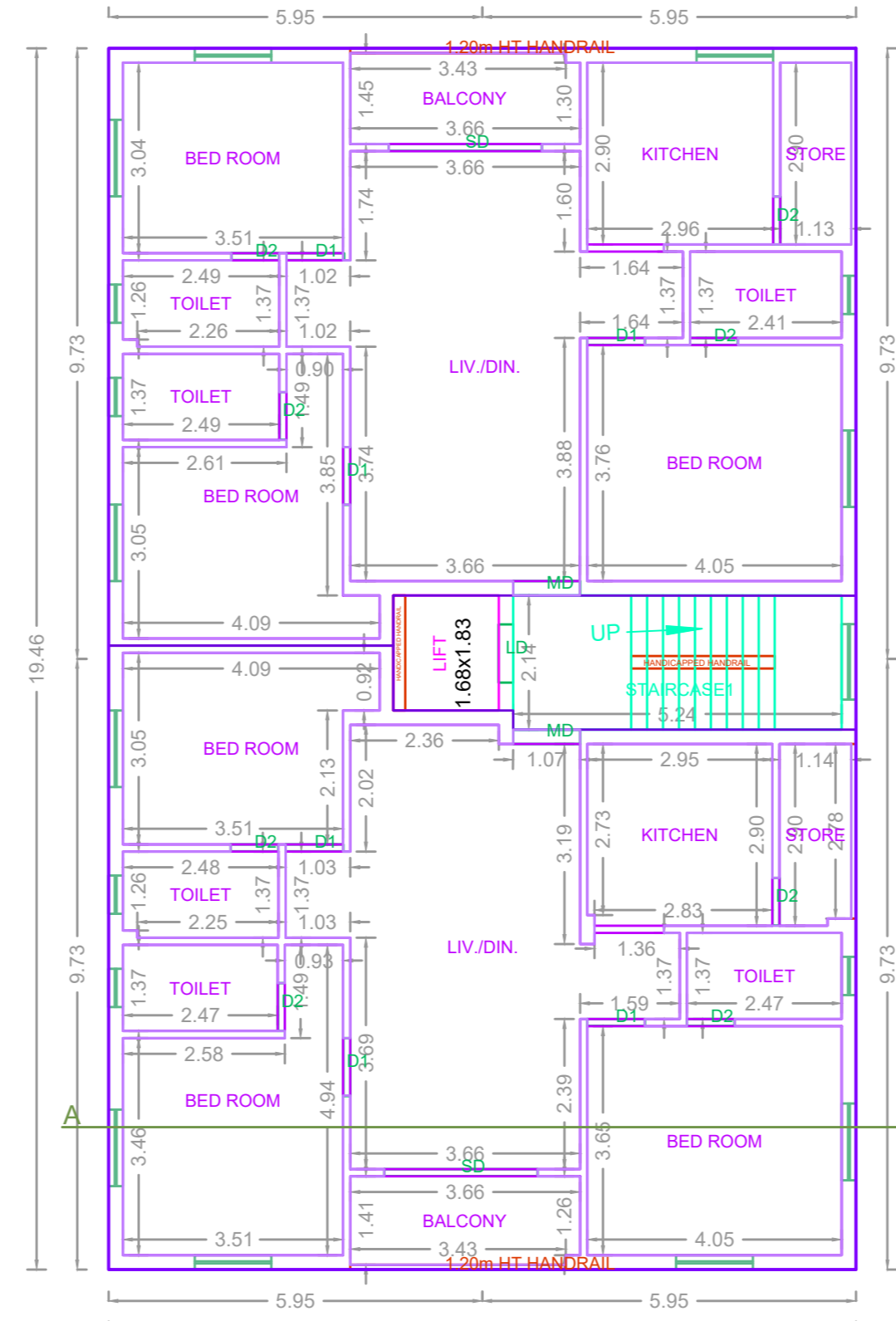

TYPICAL - FLOOR PLAN (1ST TO 5TH FLOOR)

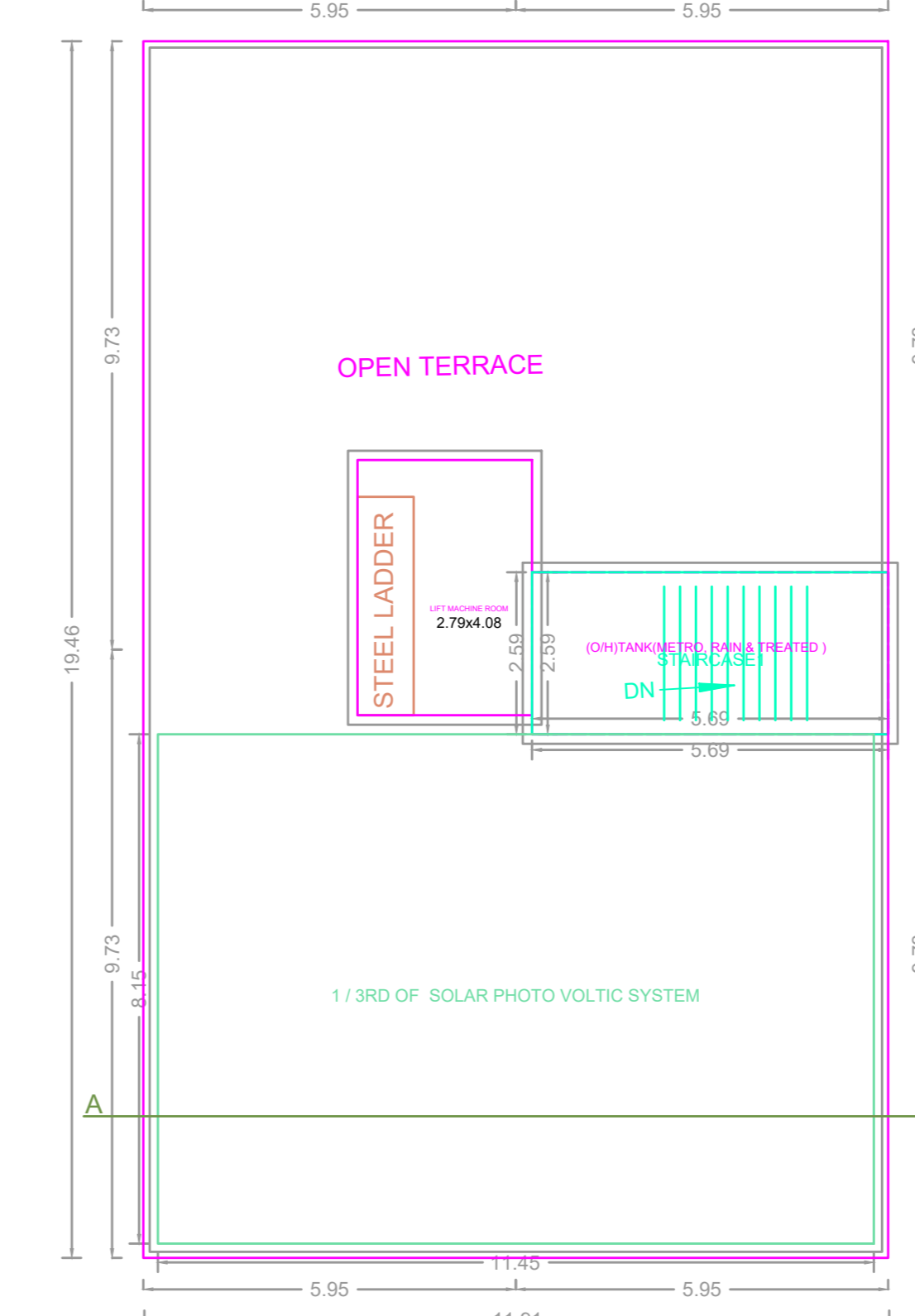

TERRACE FLOOR PLAN

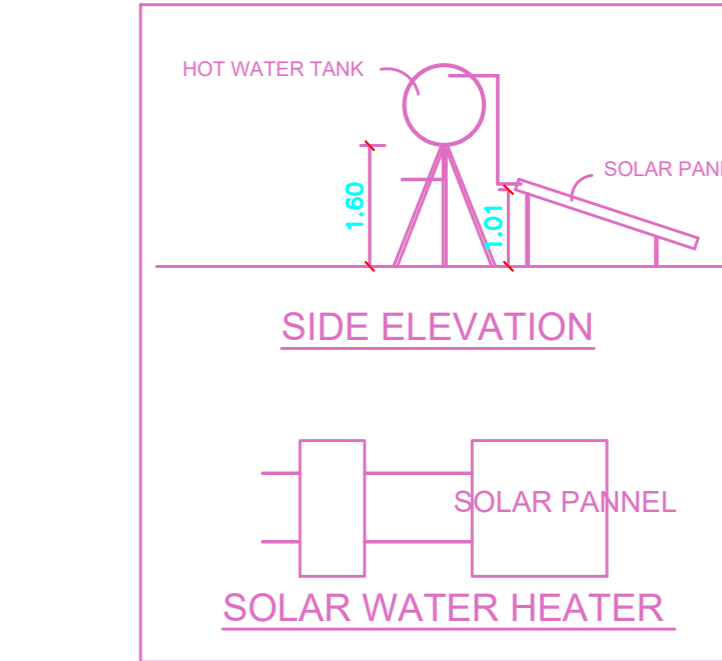

SIDE ELEVATION

SOLAR WATER HEATER

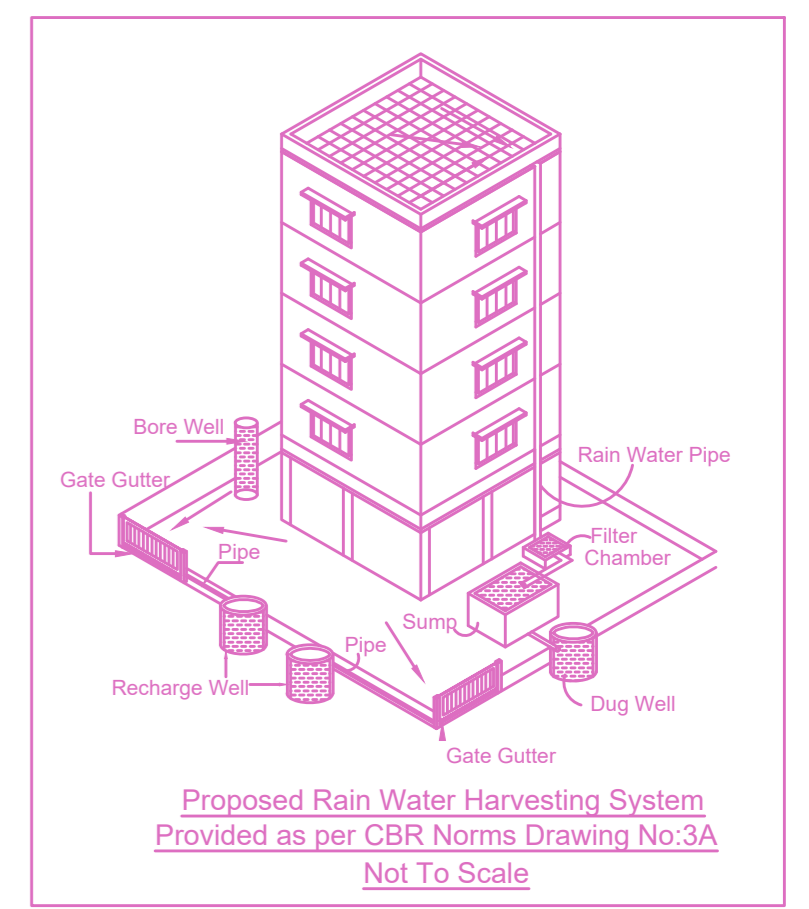

Proposed Rain Water Harvesting System Provided as per CBR Norms Drawing No.3A Not To Scale

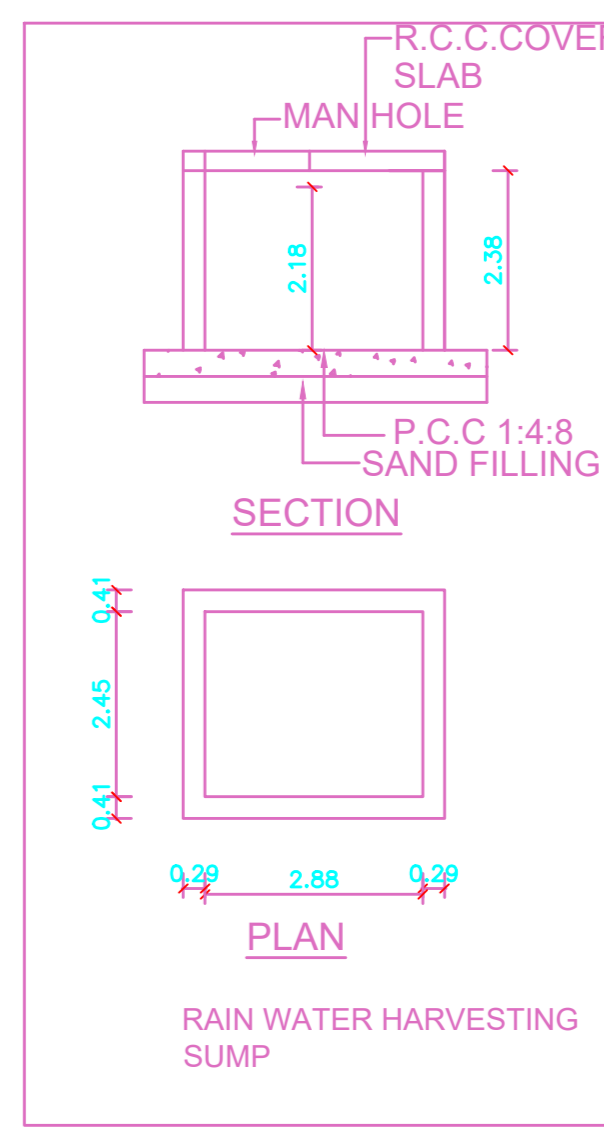

PLAN

RAIN WATER HARVESTING SUMP

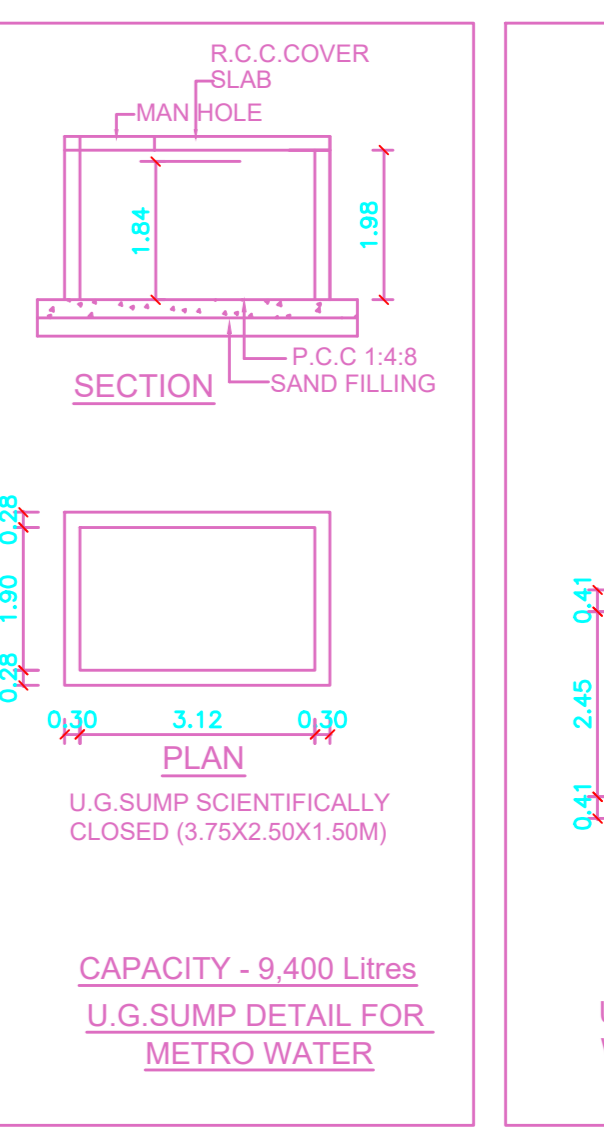

PLAN

U.G.SUMP FOR TREATED WATER SCIENTIFICALLY CLOSED

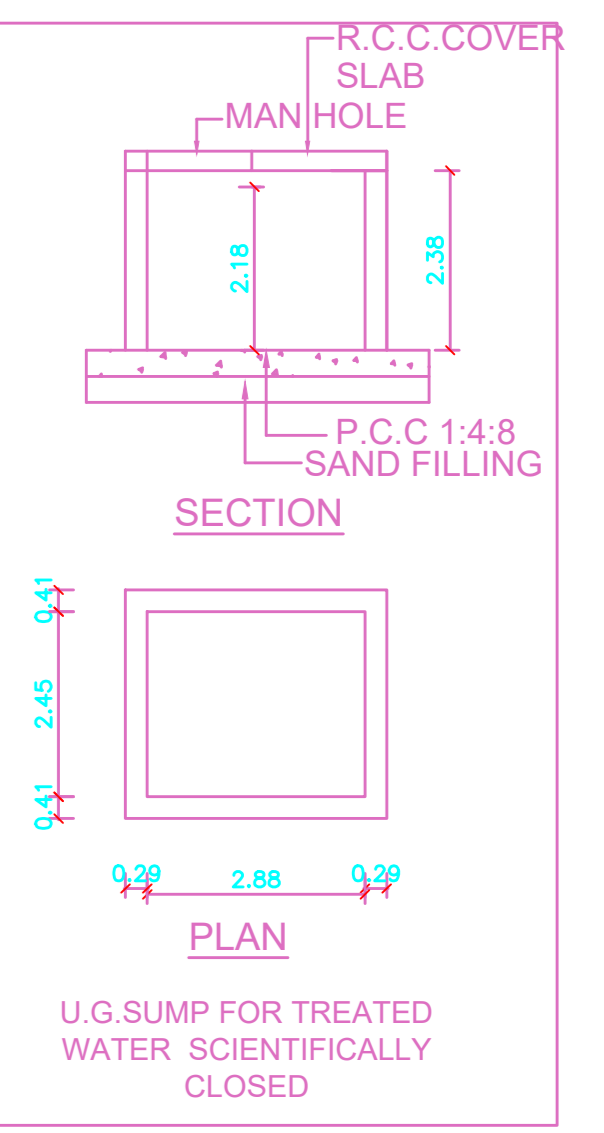

PLAN

U.G.SUMP FOR TREATED WATER SCIENTIFICALLY CLOSED

FLOOR WISE FSI STATEMENT: A (RESI)

| FLOORS | FSI AREA | | | | DU | TOTAL FSI AREA |
|---------------------|----------|---------|------|-------|----|----------------|
| | COMM. | RESI. | IND. | SPEC. | | |
| Terrace | 0.00 | 0.00 | 0.00 | 0.00 | 0 | 0.00 |
| FIFTH FLOOR | 0.00 | 231.68 | 0.00 | 0.00 | 2 | 231.68 |
| FOURTH FLOOR | 0.00 | 231.68 | 0.00 | 0.00 | 2 | 231.68 |
| THIRD FLOOR | 0.00 | 231.68 | 0.00 | 0.00 | 2 | 231.68 |
| SECOND FLOOR | 0.00 | 231.68 | 0.00 | 0.00 | 2 | 231.68 |
| FIRST FLOOR | 0.00 | 231.68 | 0.00 | 0.00 | 2 | 231.68 |
| STILT PARKING FLOOR | 0.00 | 28.80 | 0.00 | 0.00 | 0 | 28.80 |
| Total | 0.00 | 1187.20 | 0.00 | 0.00 | 10 | 1187.20 |

BUILDING WISE FSI STATEMENT

| BUILDING | NO OF SAME BUILDING | FSI AREA | | | | DU | TOTAL FSI AREA |
|------------|---------------------|----------|---------|------|-------|----|----------------|
| | | COMM. | RESI. | IND. | SPEC. | | |
| A-1 (RESI) | | 0.00 | 1187.20 | 0.00 | 0.00 | 10 | 1187.20 |
| Total | | 0.00 | 1187.20 | 0.00 | 0.00 | 10 | 1187.20 |

SEPTIC TANK CALCULATION
 Design of Septic tank with up flow filter:
 No of Dwelling Units = 20 Units
 No. of Users per Dwelling Per Unit(3BHK) = 65 Numbers
 No of Users Assuming as 20 X5 = 100 Nos.
 Assuming 2 Fixtures per toilets, hence - 100 X 2 = 200 Units.
 Per Hour Discharge is - 200 X 6 = 1200 Lts.,
 Septic Tank:
 Surface Area needed = 1200 X 0.92/ 10 = 110.4
 Volume of Sedimentation Assuming 0.30m depth (110.4 X 0.3 M) = 33.12 M3
 For Digestion (500 X 0.033) = 16.50 M3
 For Sludge Storage (0.00021 X 365 X 25) = 1.625M3
 Free board for Sludge (53 X 0.3M) = 15.9M3
 Depth (V / V) = 7.5 = 1.40M
 PROVIDED SIZE OF SEPTIC TANK = 6.00 X 4.00 X 4.00
 Up flow Filter:
 Liquid depth of septic tank = 2.5m
 Up flow filter depth / Allowing 0.30m as Free board 1.4 - 0.3 = 1.10m
 Area needed = 1.10 / 1.10 = 1.0m
 Size of Up flow filter 2.0 X 2.0
 Up flow = 1.0 X 2.0 X 1.5M x 2 Nos.

APPROVAL CONDITION

SCALE 1:100

CHENNAI METROPOLITAN DEVELOPMENT AUTHORITY
 APPROVED
 SUBJECT TO THE CONDITIONS MENTIONED IN THIS OFFICE