

PLAN SHOWING THE PROPOSED CONSTRUCTION OF STILL FLOOR + 3 FLOORS (HEIGHT -12.0m) RESIDENTIAL BUILDING WITH 9 DWELLING UNITS AT PLOT NO: 2, DOOR NO: 13, LATHEEF COLONY 3rd STREET, ZAMIN PALLAVARAM, CHENNAI 600043. COMPRISED IN OLD S.NO:332/2-A, T.S.NO.21, BLOCK NO:22, WARD-B JAMEEN PALLAVARAM, PALLAVARAM TALUK, WITHIN THE LIMITS OF TAMBARAM MUNICIPAL CORPORATION.

A) AREA STATEMENT	SQ.M.
AREA AS PER PATTA	421.00
AREA AS PER DOCUMENT	431.78
AREA CONSIDERED FOR FSI	421.00
STREET ALIGNMENT/ ROAD WIDENING/LINK ROAD	0.00
OSR AREA	0.00
TOTAL FSI AREA	840.18
FSI FACTOR	1.996
COVERAGE AREA (PERCENTAGE %)	N.A

A) PARKING STATEMENT		
VEHICLE	REQUIRED	PROVIDED
LORRY	0	0
CAR	9	9
TWO WHEELER	3	18
CYCLE	0	0

BUILDING WISE FSI STATEMENT							
BUILDING	NO OF SAME BUILDING	FSI AREA				DU	TOTAL FSI AREA
		COMM.	RESI.	IND.	SPEC.		
A-1 (RESIDENCE)		0.00	840.18	0.00	0.00	9	840.18
Total		0.00	840.18	0.00	0.00	9	840.18

FLOOR WISE FSI STATEMENT: A (RESIDENCE)						
FLOORS	FSI AREA				DU	TOTAL FSI AREA
	COMM.	RESI.	IND.	SPEC.		
Terrace	0.00	0.00	0.00	0.00	0	0.00
THIRD FLOOR	0.00	280.06	0.00	0.00	3	280.06
SECOND FLOOR	0.00	280.06	0.00	0.00	3	280.06
FIRST FLOOR	0.00	280.06	0.00	0.00	3	280.06
STILT PARKING FLOOR	0.00	0.00	0.00	0.00	0	0.00
Total	0.00	840.18	0.00	0.00	9	840.18

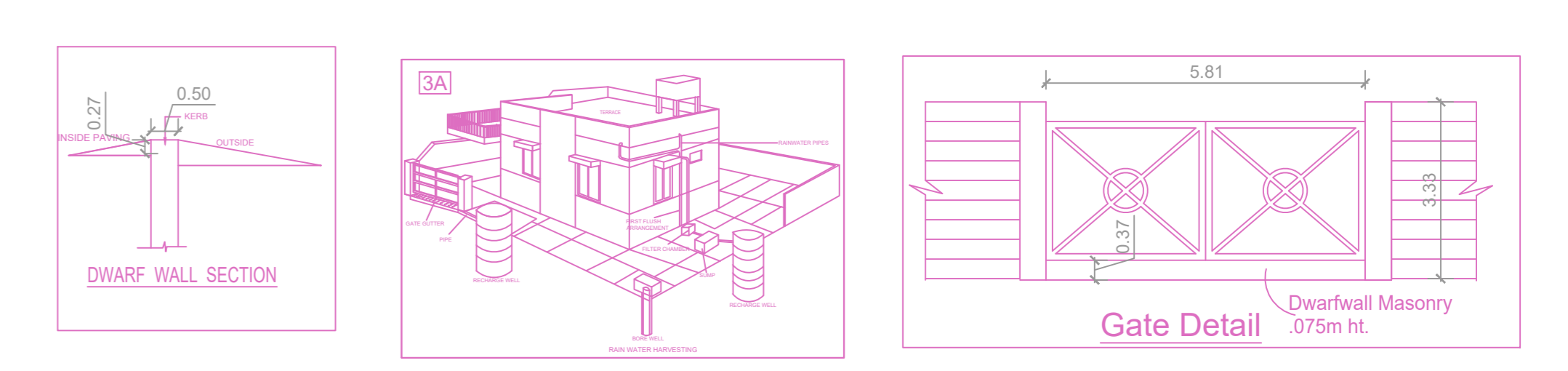
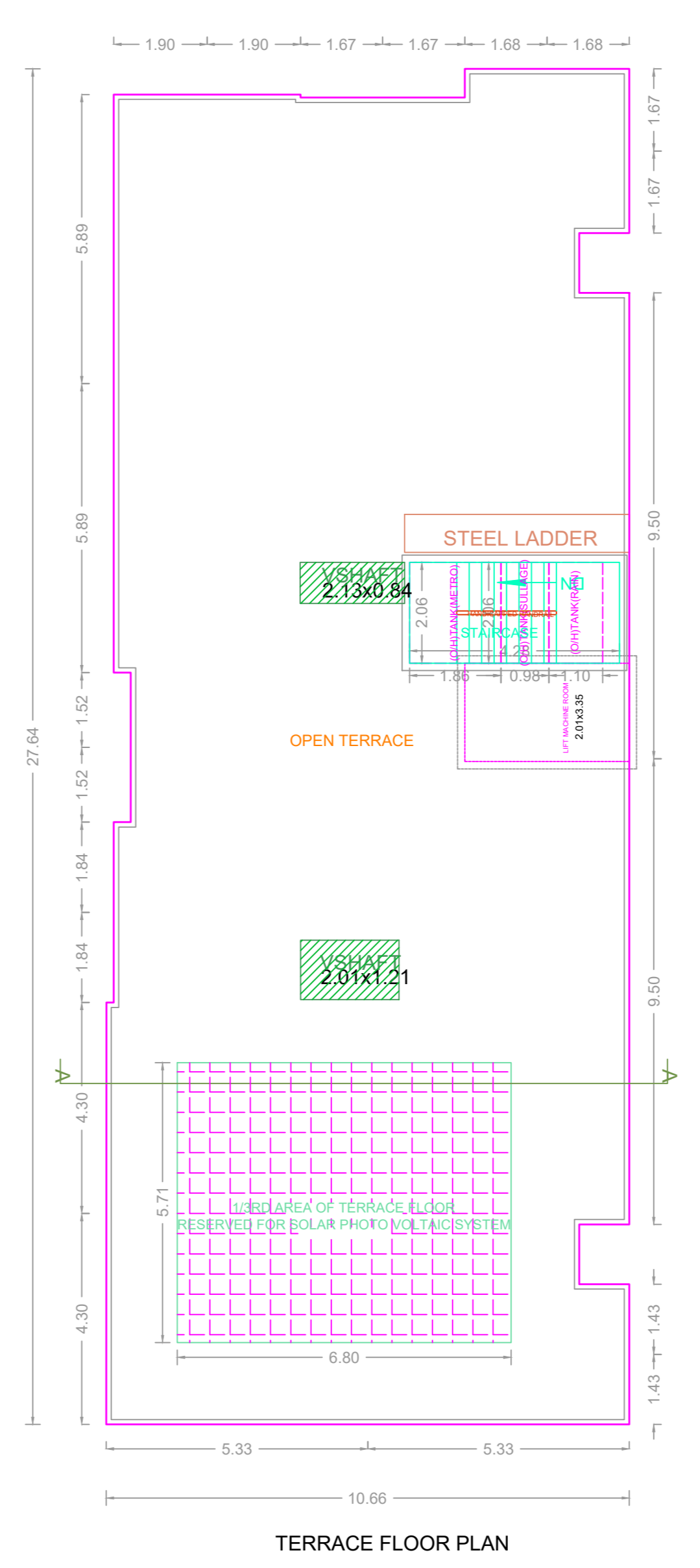
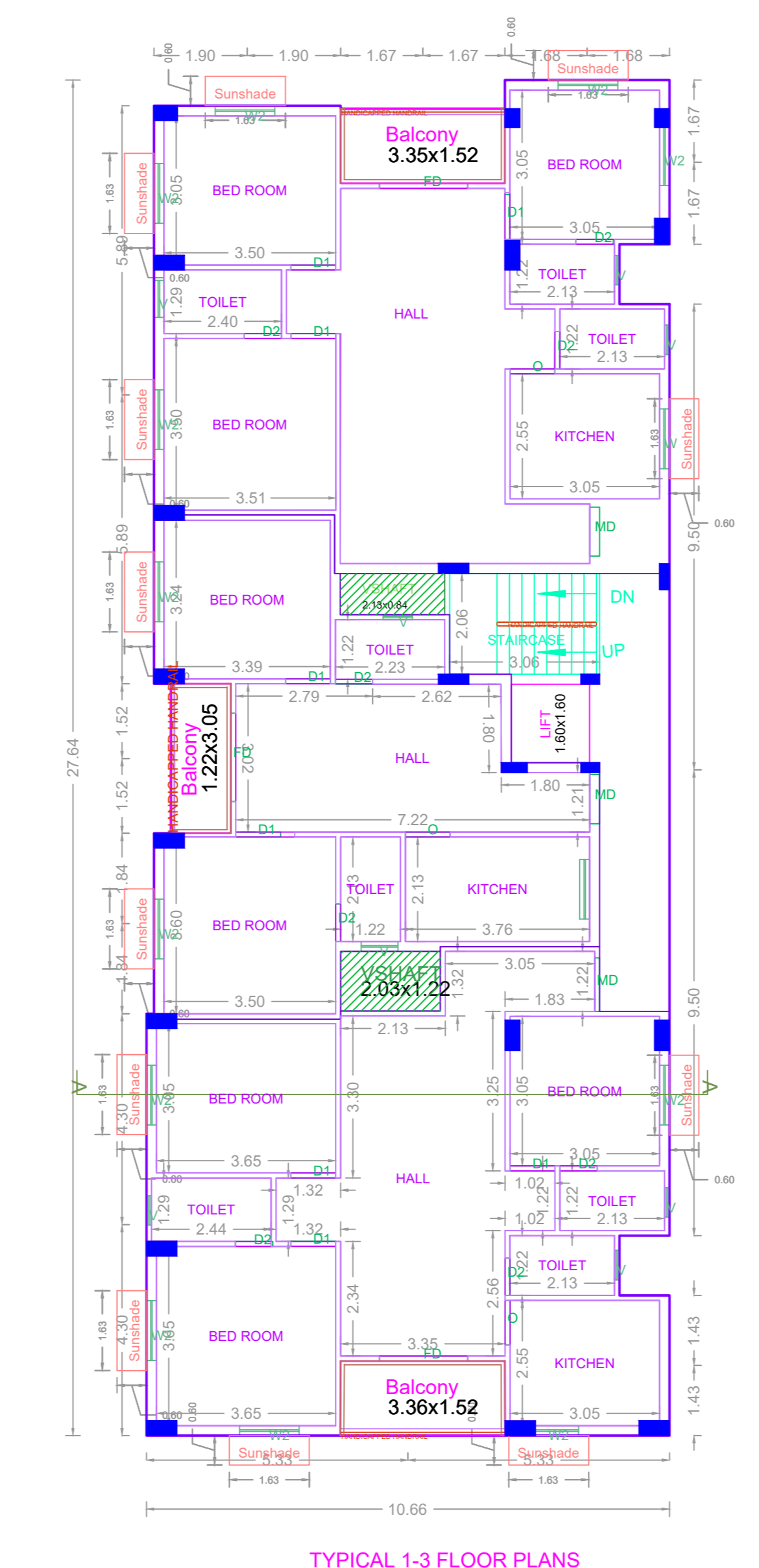
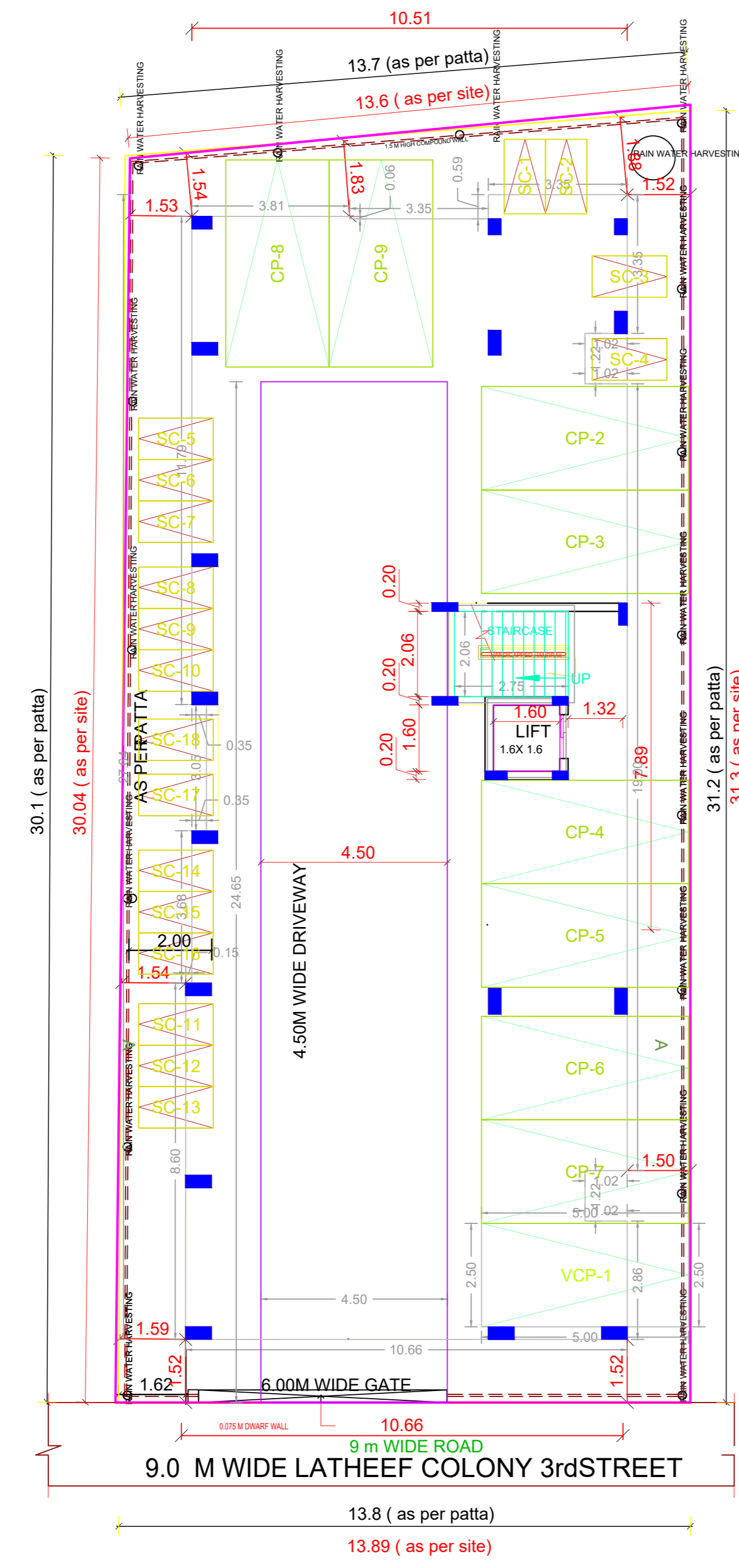
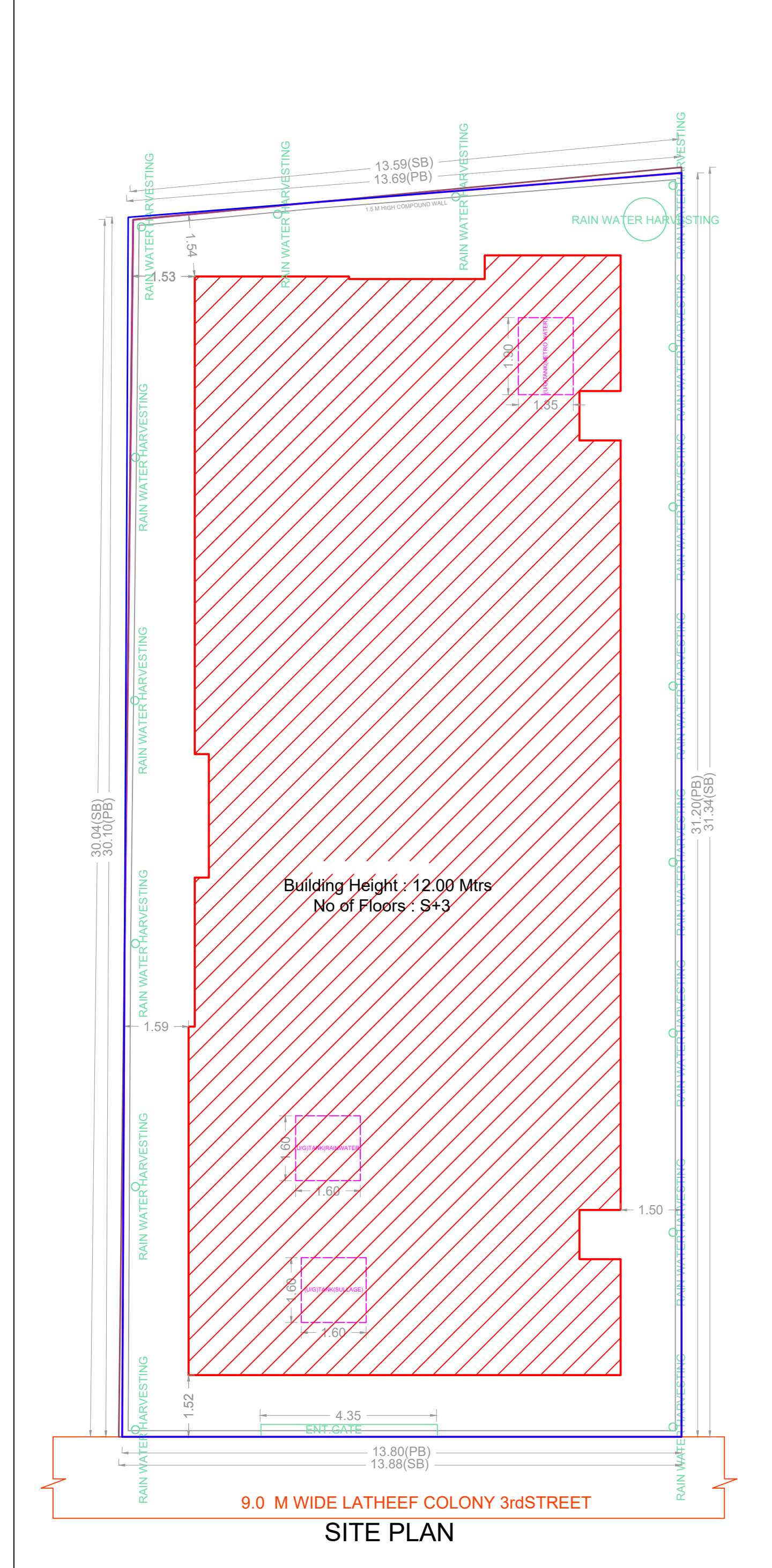

APPROVAL CONDITION

SCALE 1:100

CHENNAI METROPOLITAN DEVELOPMENT AUTHORITY
APPROVED
SUBJECT TO THE CONDITIONS MENTIONED IN THIS OFFICE

For (Deputy Planner / Chief Planner / Member-Secretary)
High Rise Building / Non High Rise Building
This Approval is valid only after building Permit is issued by the concerned Local Body.

KEY NO. 9688 QR CODE