

SITE PLAN

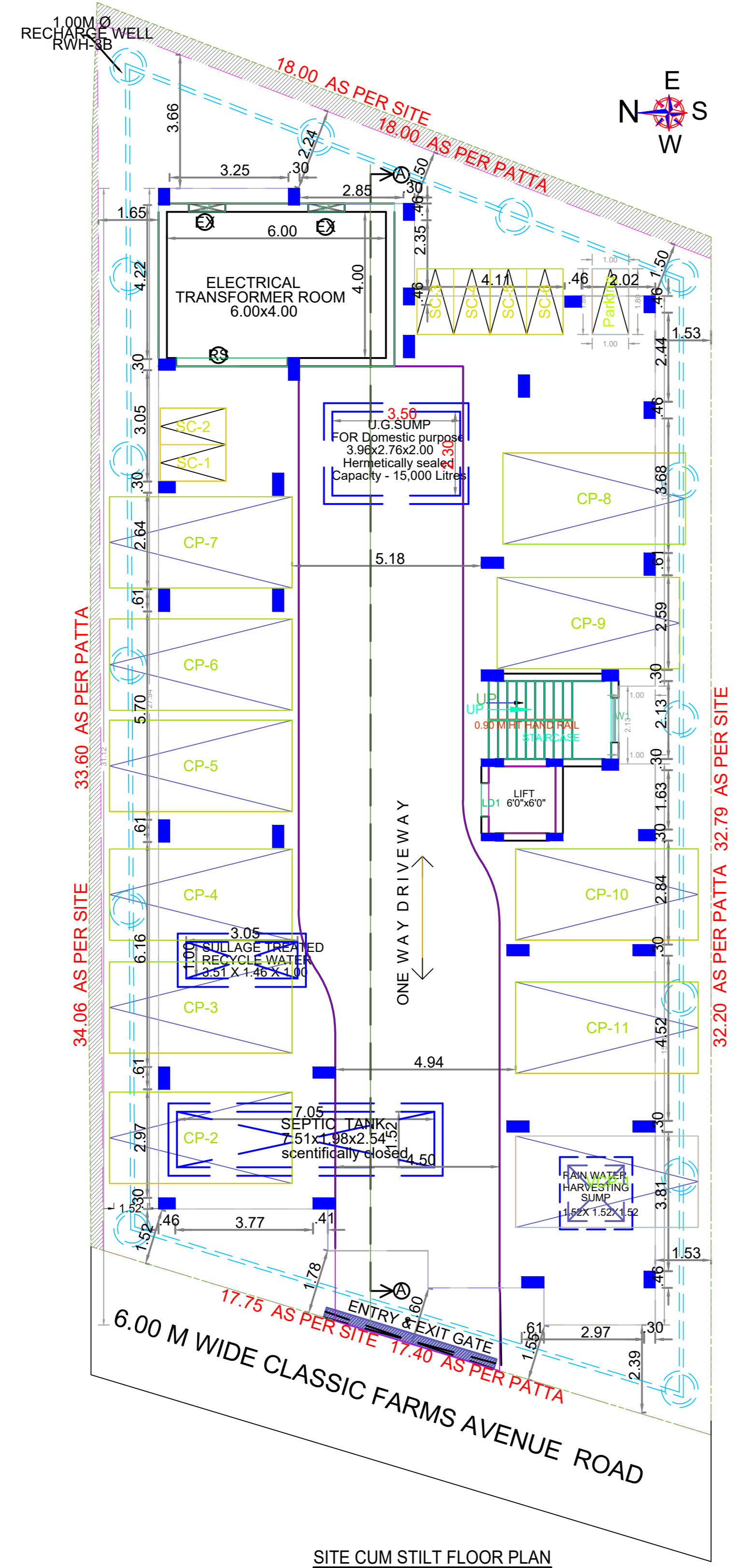

SITE CUM STILT FLOOR PLAN

FLOOR WISE FSI STATEMENT: SA (BUILDING)

FLOORS	FSI AREA				DU	TOTAL FSI AREA
	COMM.	RESI.	IND.	SPEC.		
Terrace	0.00	0.00	0.00	0.00	0	0.00
THIRD FLOOR	0.00	376.84	0.00	0.00	3	376.84
SECOND FLOOR	0.00	376.84	0.00	0.00	4	376.84
FIRST FLOOR	0.00	376.84	0.00	0.00	4	376.84
STILT PARKING FLOOR	0.00	28.81	0.00	0.00	0	28.81
Total	0.00	1159.33	0.00	0.00	11	1159.33

BUILDING WISE FSI STATEMENT

BUILDING	NO OF SAME BUILDING	FSI AREA				DU	TOTAL FSI AREA
		COMM.	RESI.	IND.	SPEC.		
SA-1 (BUILDING)	1	0.00	1159.33	0.00	0.00	11	1159.33
Total	1	0.00	1159.33	0.00	0.00	11	1159.33

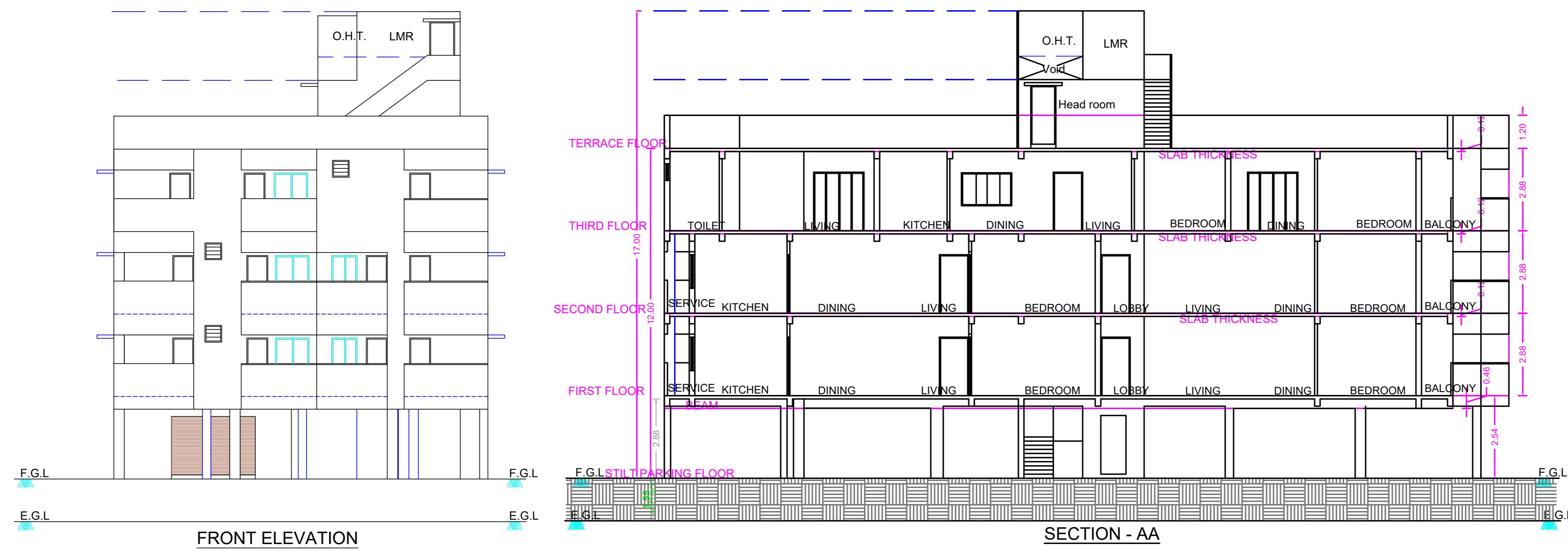

FRONT ELEVATION

SECTION - AA



FIRST FLOOR PLAN

SECOND FLOOR PLAN

THIRD FLOOR PLAN

TERRACE FLOOR PLAN

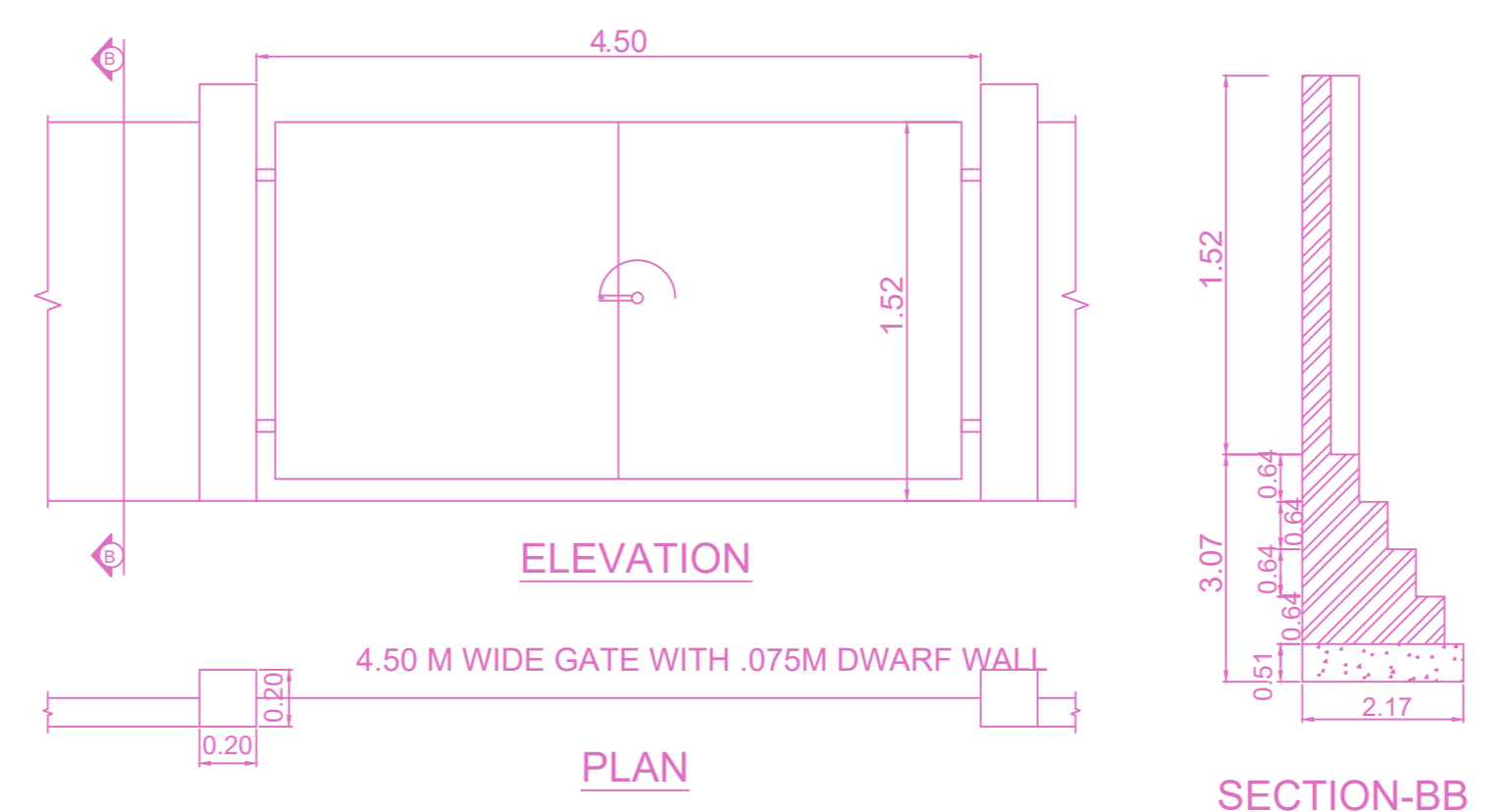

ELEVATION

PLAN

SECTION-BB

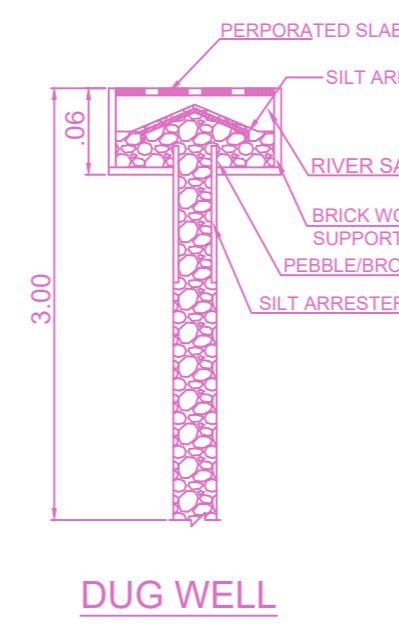

DUG WELL

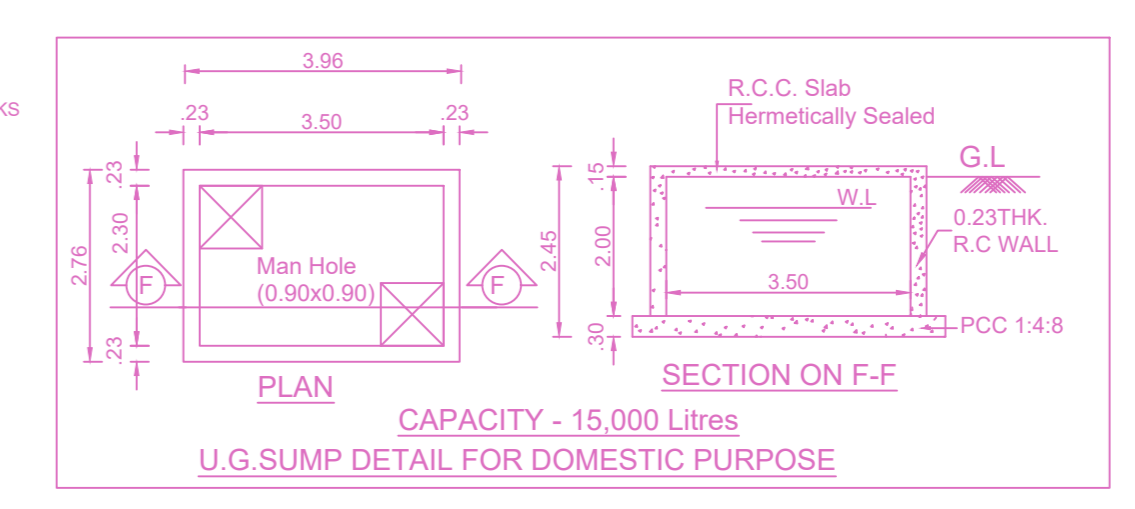

U.G. SUMP DETAIL FOR DOMESTIC PURPOSE

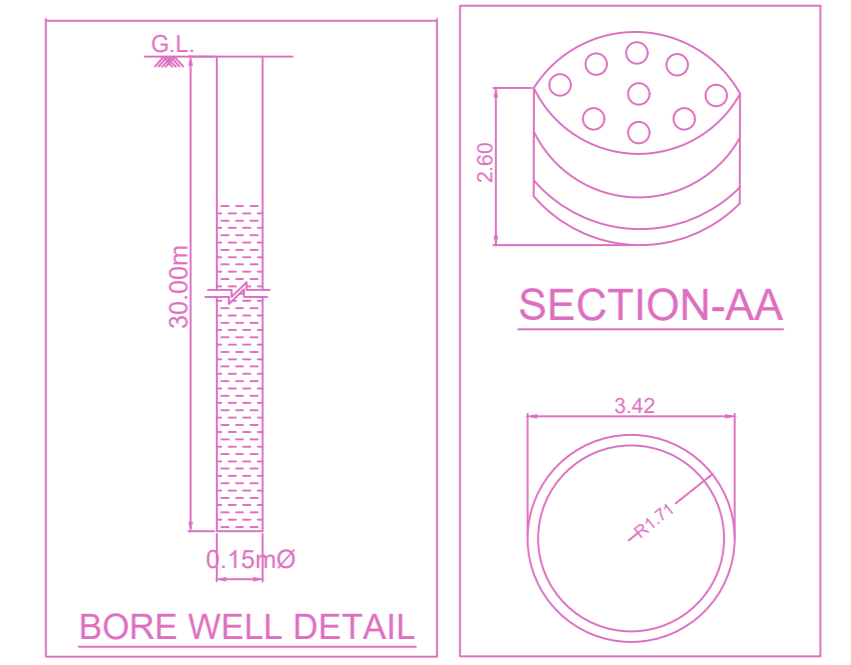

SECTION-AA

BORE WELL DETAIL

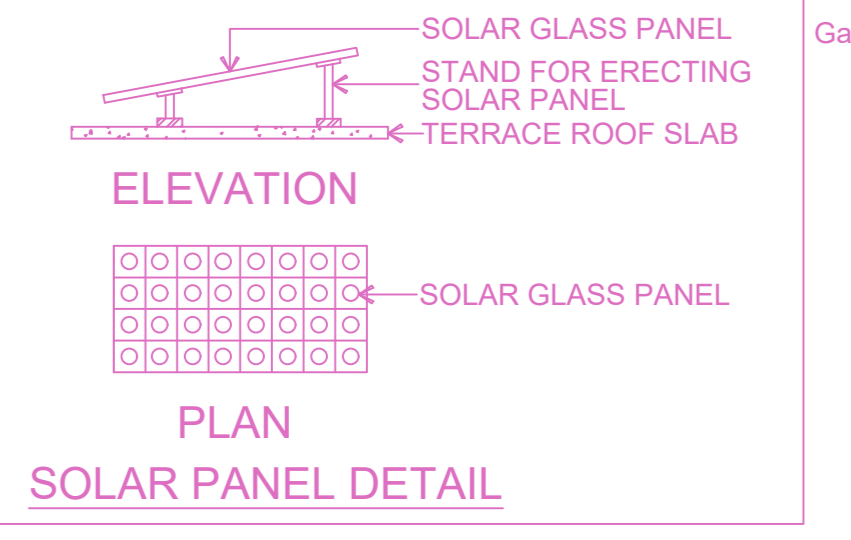

ELEVATION

PLAN

SOLAR PANEL DETAIL

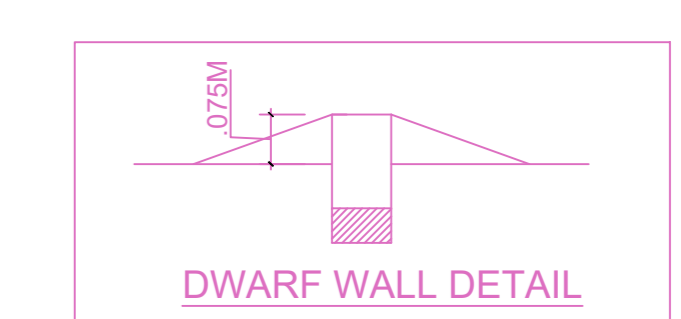

DWARF WALL DETAIL

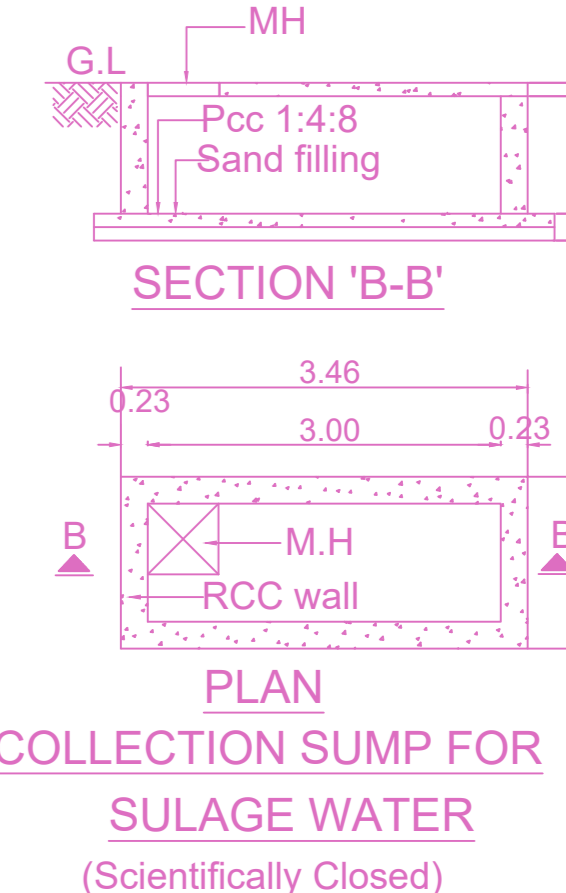

PLAN COLLECTION SUMP FOR SULAGE WATER (Scientifically Closed)

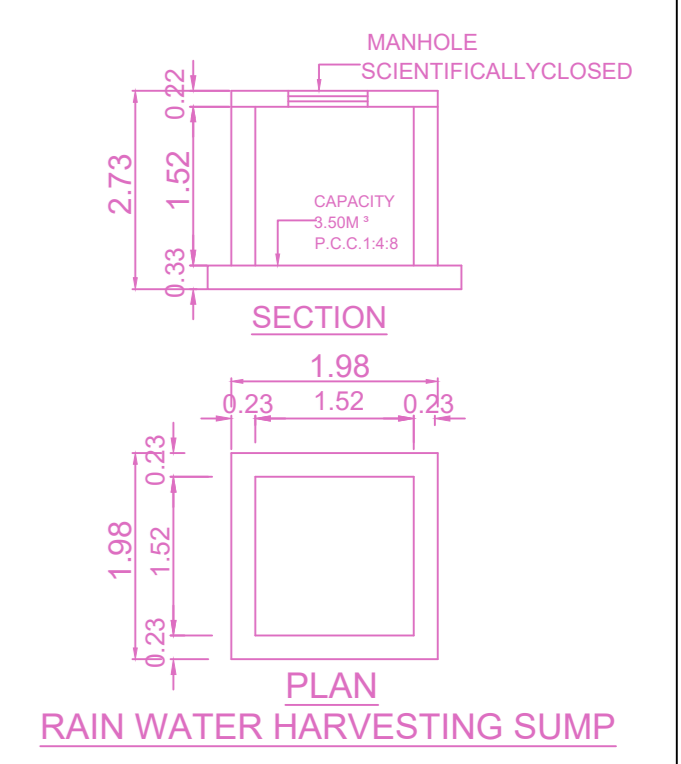

PLAN RAIN WATER HARVESTING SUMP

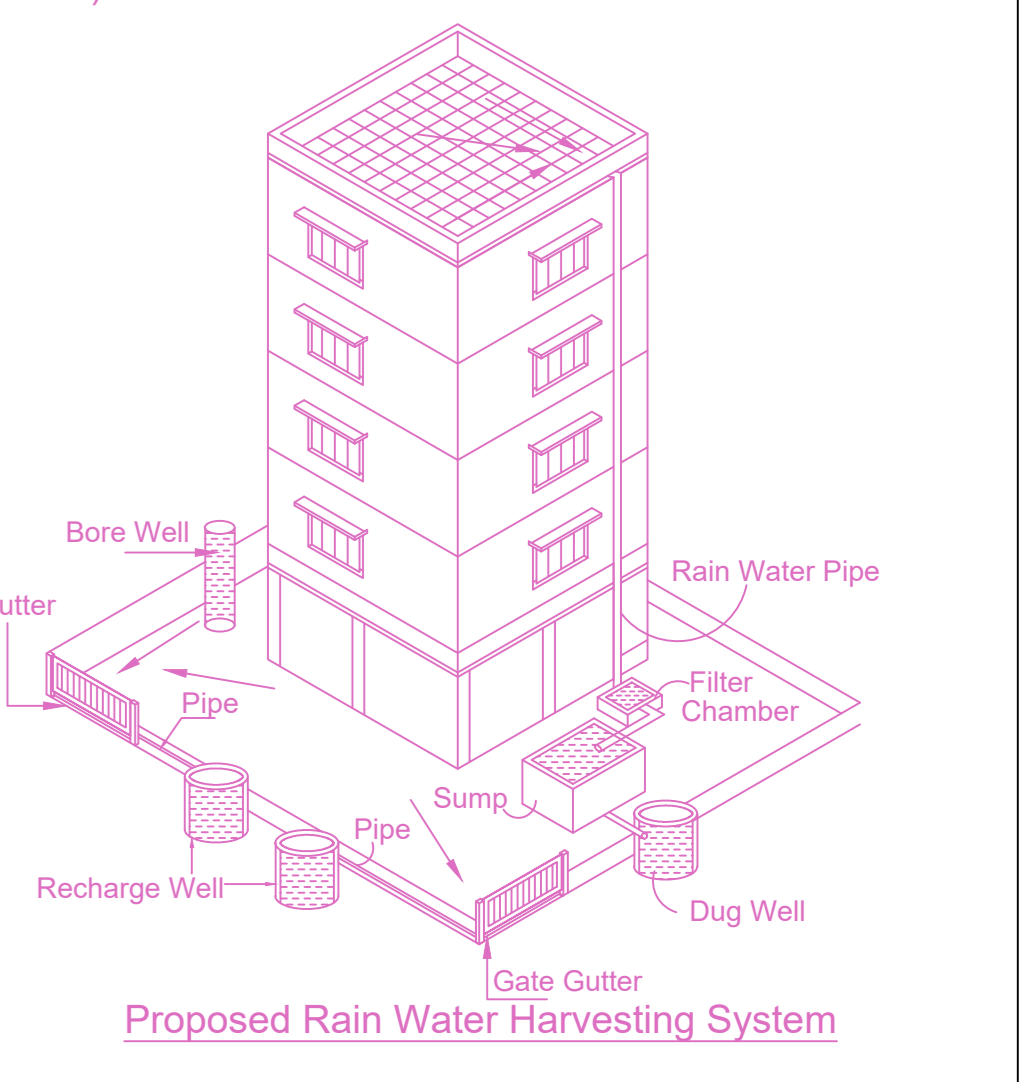

Proposed Rain Water Harvesting System

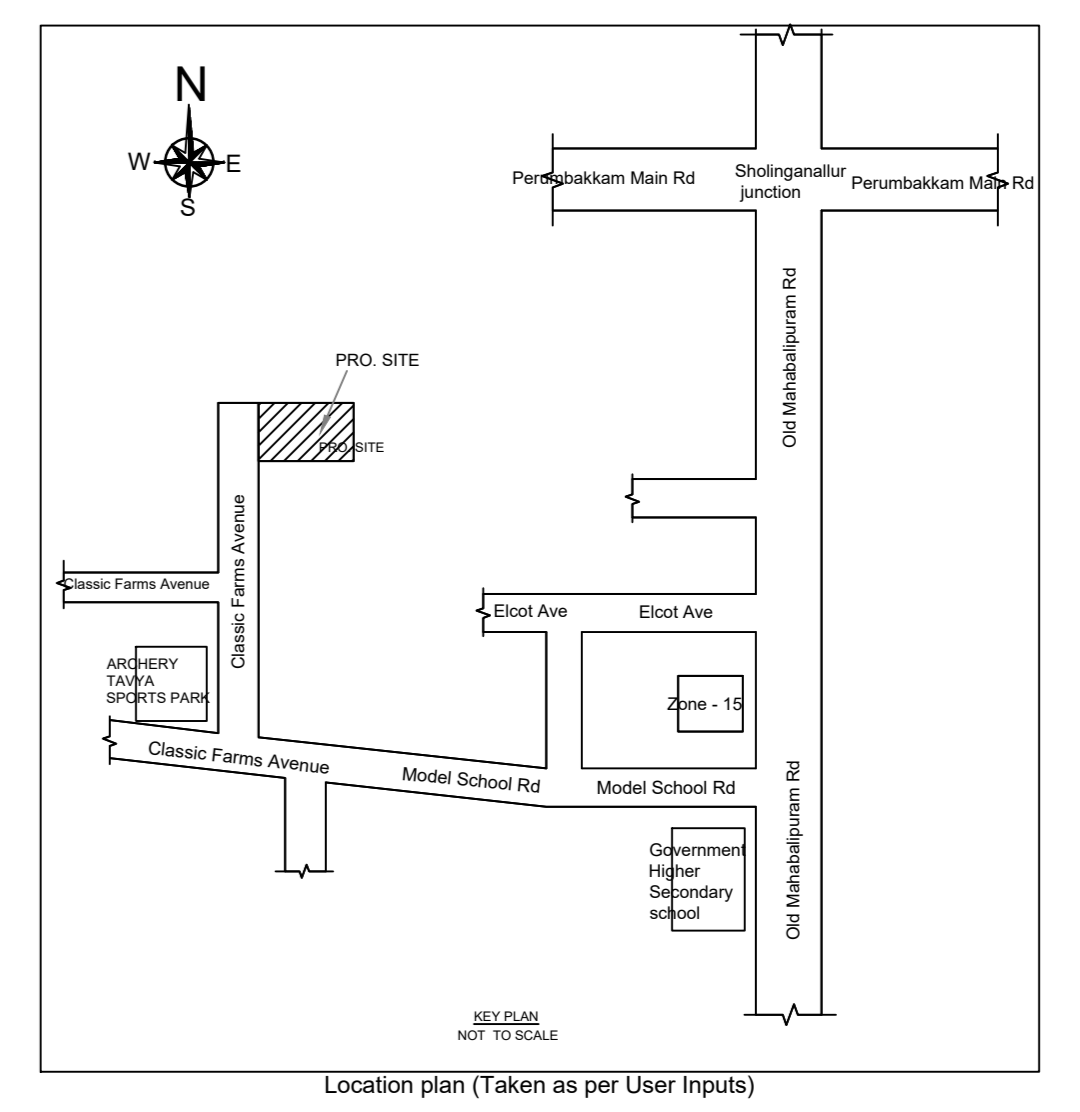

Location plan (Taken as per User Input)

PLAN SHOWING THE PROPOSED CONSTRUCTION OF STILT FLOOR + 3 FLOORS RESIDENTIAL BUILDING WITH 11 DWELLING UNITS (12.00 HEIGHT) AT PLOT NO.10A, "CLASSIC RETREAT" SHOLINGANALLUR, CHENNAI -600 119. COMPRISED IN OLD S.NO. 602/K & 602/L, AS PER PATTA S.NO. 602/2B19A, 602/2B19B AND 602/2B19C, OF SHOLINGANALLUR VILLAGE, WITH IN GREATER CHENNAI CORPORATION.

A) AREA STATEMENT

DESCRIPTION	SQ.M.
AREA AS PER PATTA	600.00
AREA AS PER DOCUMENT	610.93
AREA CONSIDERED FOR FSI	600.00
STREET ALIGNMENT ROAD WIDENING/LINK ROAD	0.00
OSR AREA	0.00
TOTAL FSI AREA	1159.33
FSI FACTOR	1.932
COVERAGE AREA (PERCENTAGE %)	NA

A) PARKING STATEMENT

VEHICLE	REQUIRED	PROVIDED
LORRY	0	0
CAR	11	11
TWO WHEELER	2	2
CYCLE	0	0

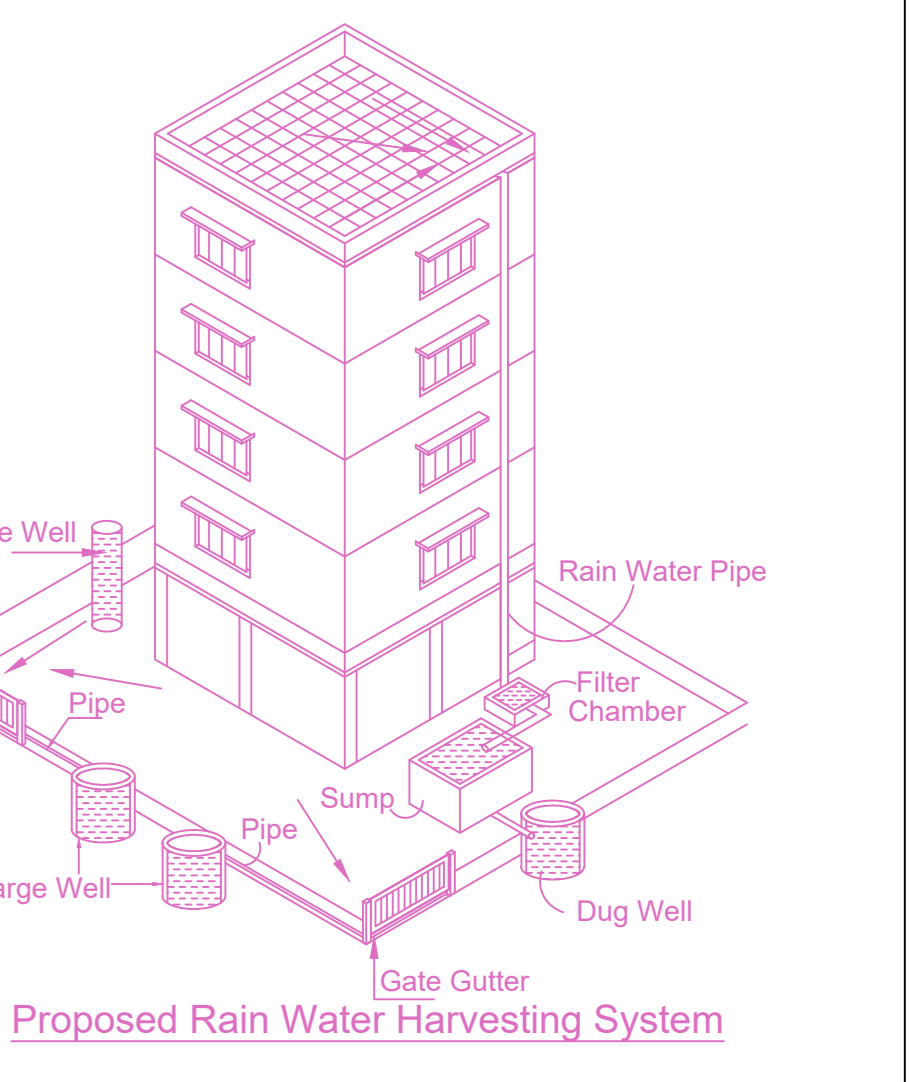
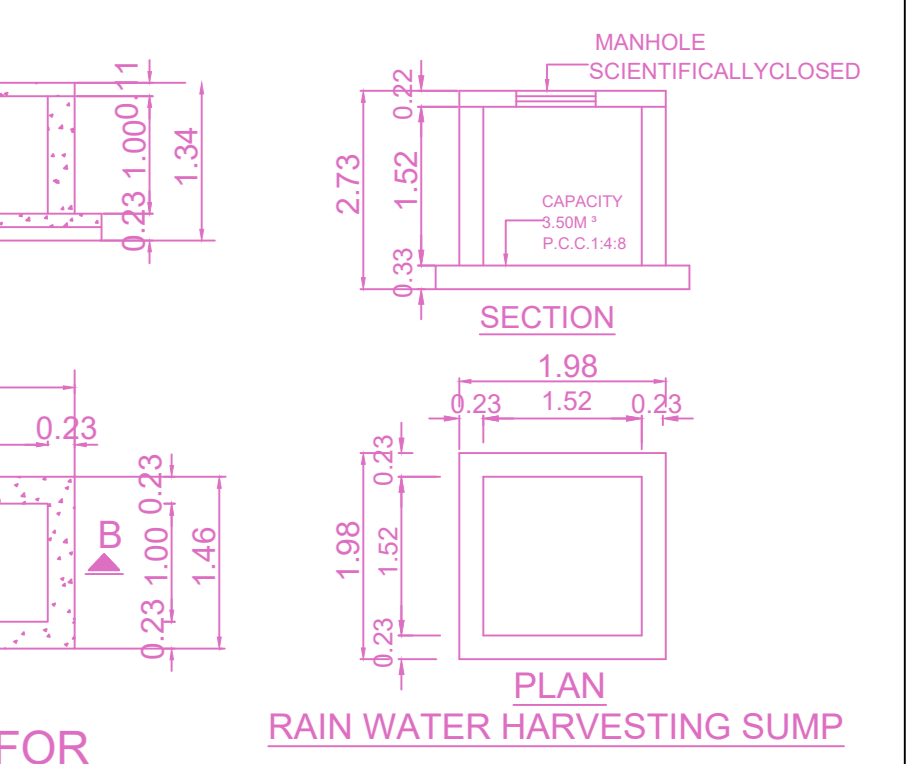
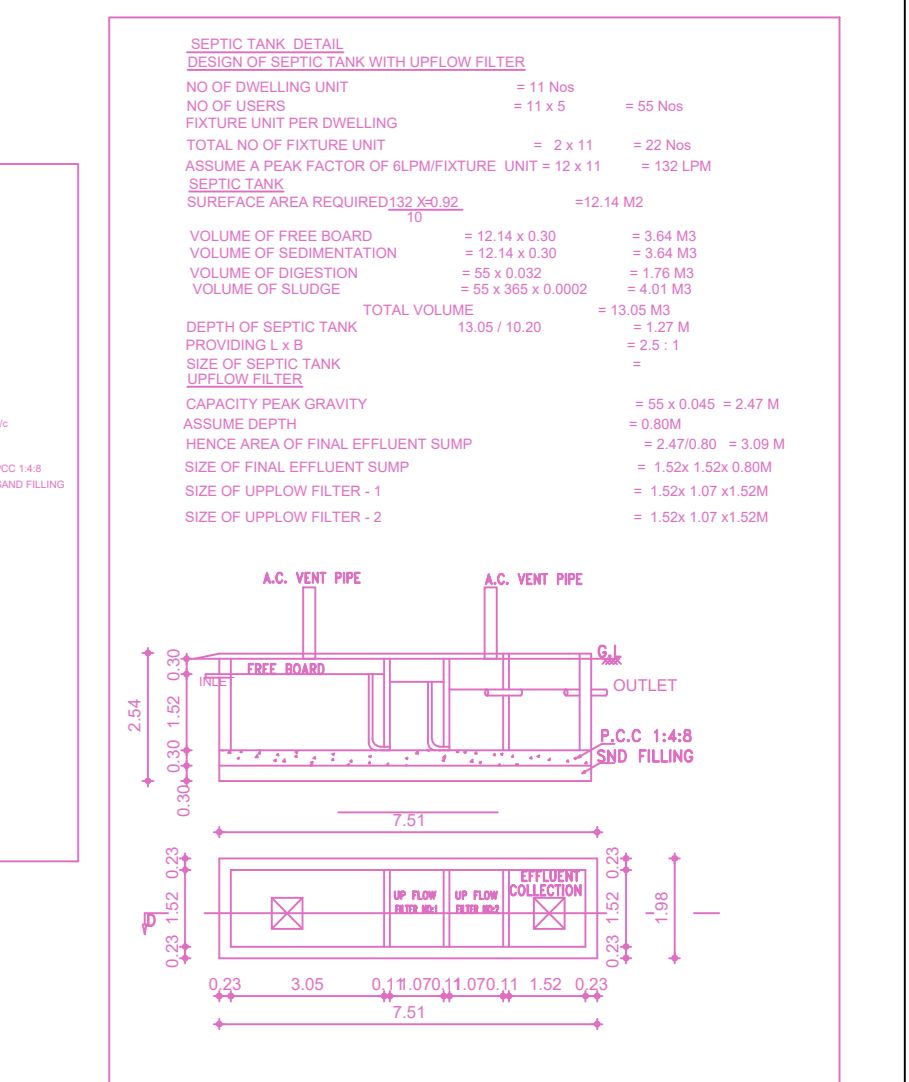

APPROVAL CONDITION

SCALE: 1:100

CHENNAI METROPOLITAN DEVELOPMENT AUTHORITY
APPROVED
SUBJECT TO THE CONDITIONS MENTIONED IN THIS OFFICE

This Planning Permission issued under New Rule TNCODR, 2019 is subject to final outcome of the W.P. (MD) No.8948 of 2019 and WMP (MD) Nos. 6912 & 6913 of 2019.

For Deputy Planner / Chief Planner / Member (Secretary) High Rise Building, High Rise Floor Building

The Approval is valid only after building Permit is issued by the concerned Local Body.

KEY NO. 0688
QR CODE