

FLOOR WISE FSI STATEMENT: A (RESIDENTIAL)

FLOORS	COMM.	RESI.	IND.	INST.	DU	TOTAL FSI AREA
BASEMENT PARKING FLOOR	0.00	33.71	0.00	0.00	0	33.71
GROUND PARKING FLOOR	0.00	800.57	0.00	0.00	0	800.57
FIRST FLOOR	0.00	578.20	0.00	0.00	0	578.20
SECOND FLOOR	0.00	580.13	0.00	0.00	1	580.13
Terrace	0.00	0.00	0.00	0.00	0	0.00
Total	0.00	1992.61	0.00	0.00	1	1992.61

BUILDING WISE FSI STATEMENT

BUILDING	NO OF SAME BUILDING	COMM.	RESI.	IND.	INST.	DU	TOTAL FSI AREA
A-1 (RESIDE...)	0.00	1992.61	0.00	0.00	0.00	1	1992.61
Total	0.00	1992.61	0.00	0.00	0.00	1	1992.61

SITE PLAN

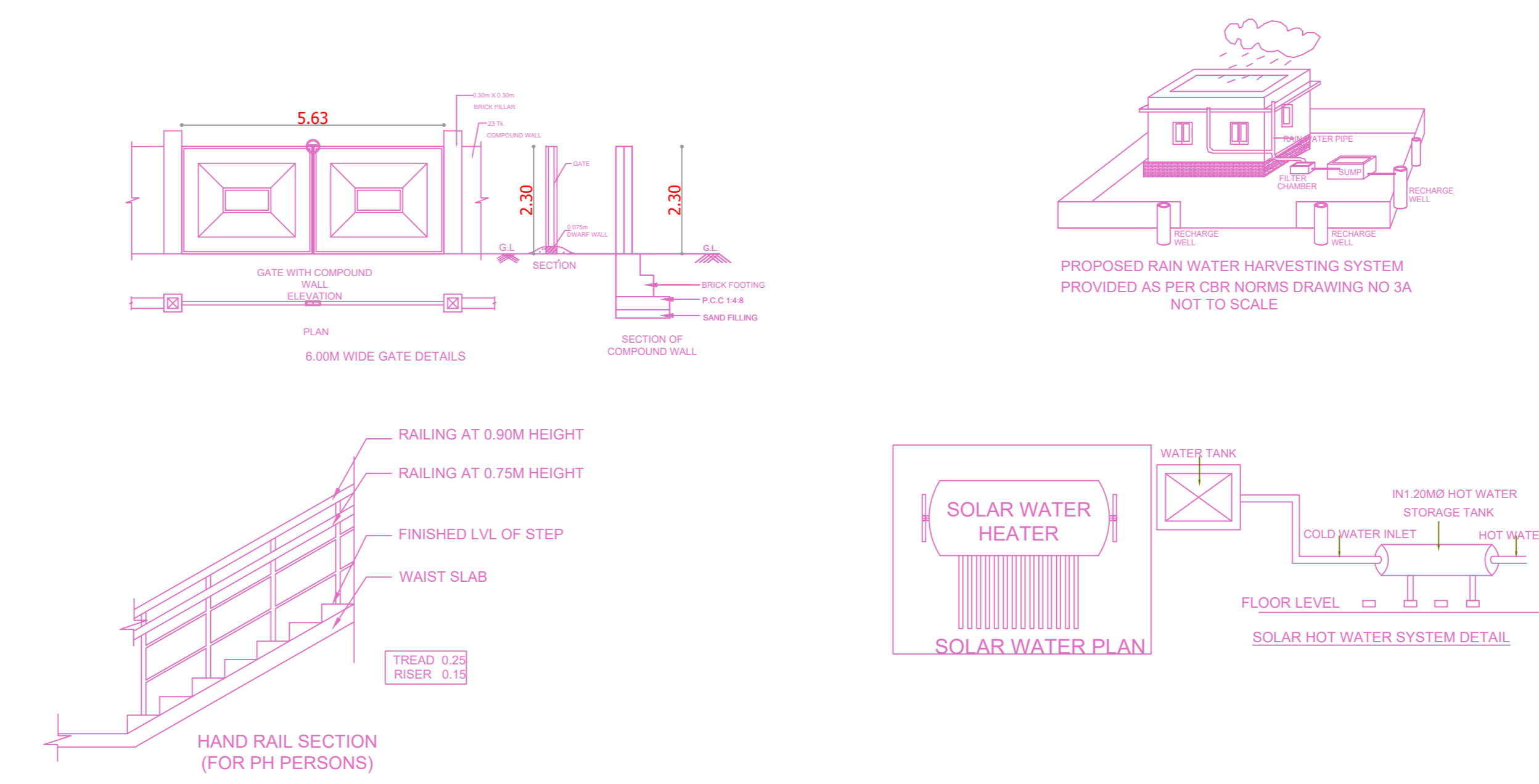

SECTION BASEMENT FLOOR RAMP DETAILS

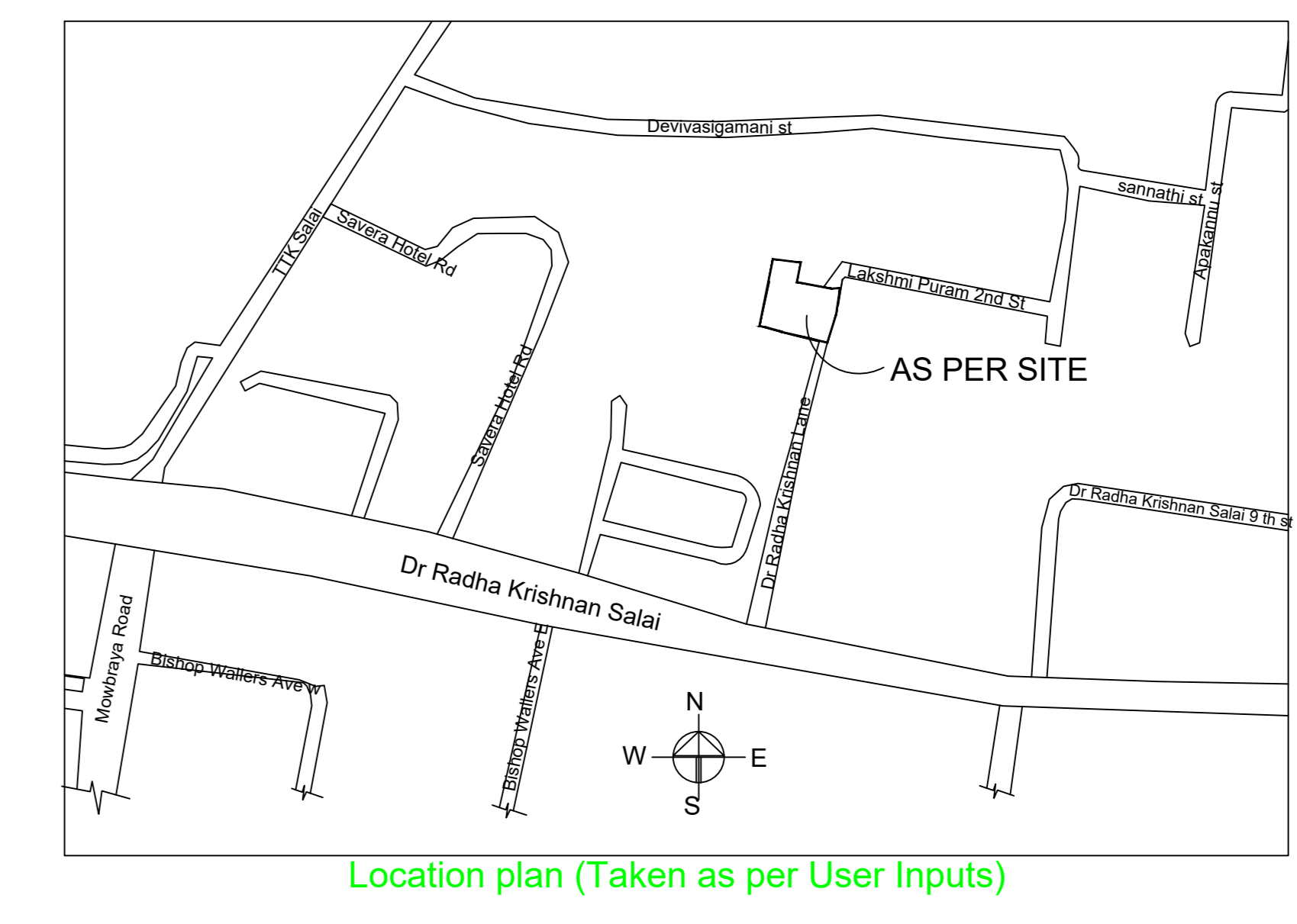
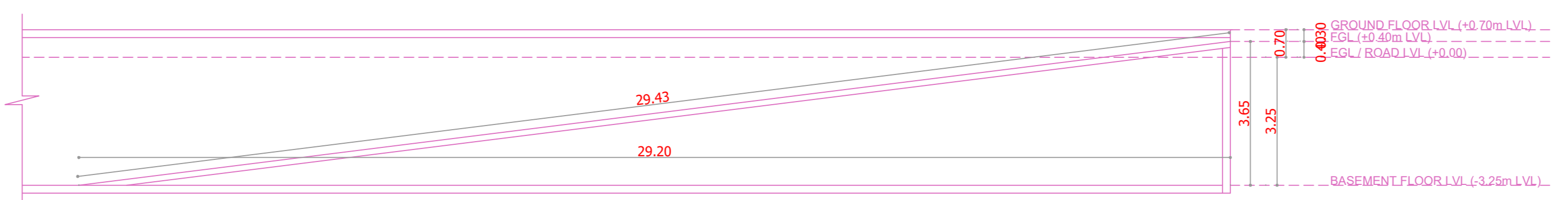

Location plan (Taken as per User Inputs)

PLAN BASEMENT FLOOR RAMP DETAILS

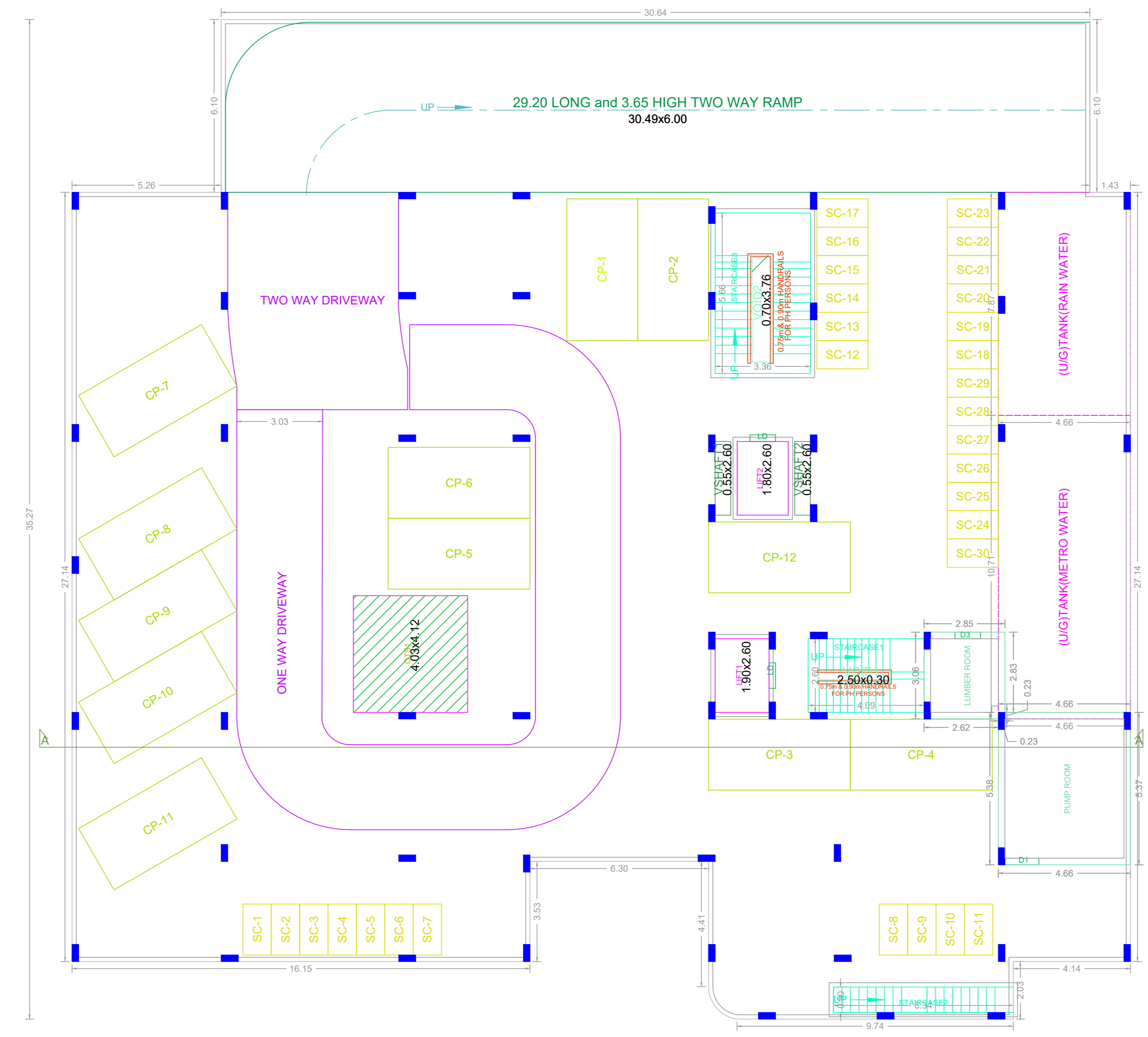
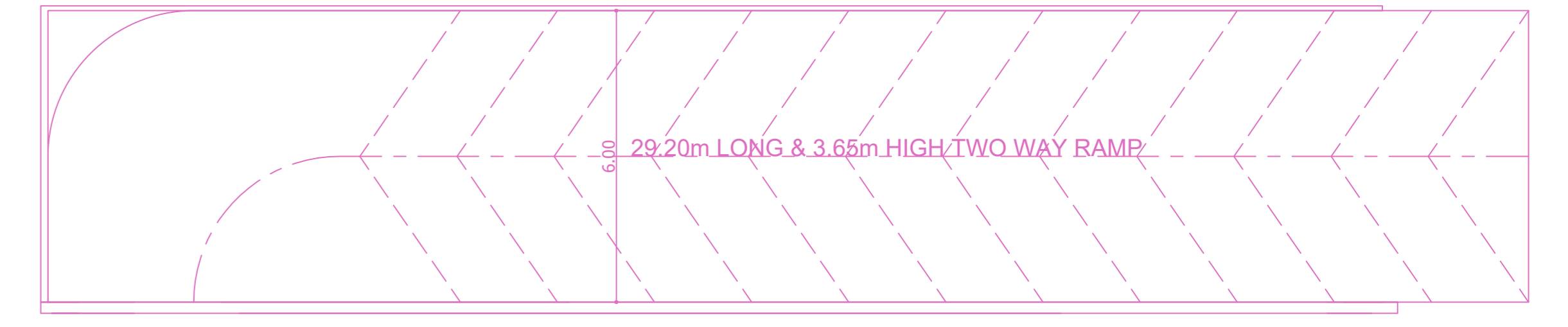

BASEMENT PARKING FLOOR PLAN

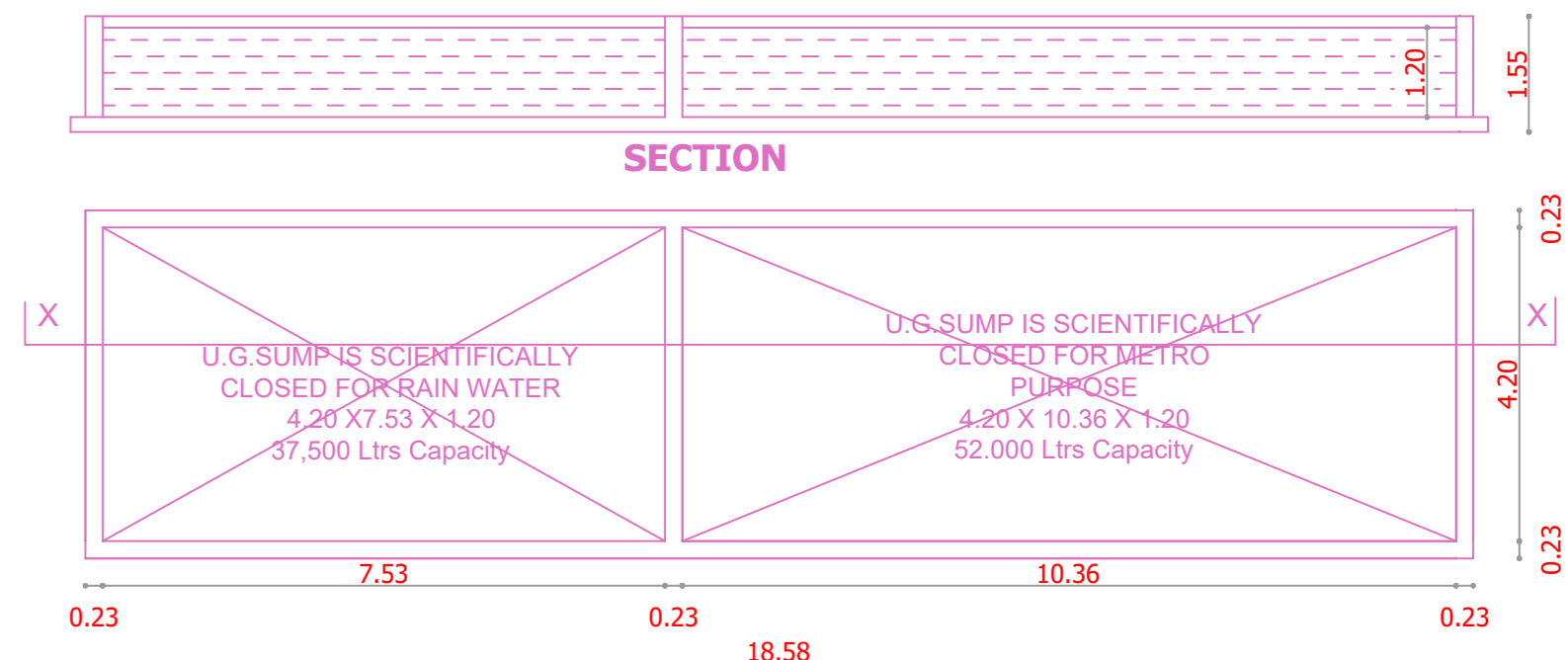

PLAN TYPICAL SUMP DETAILS FOR METRO WATER AND RAIN WATER

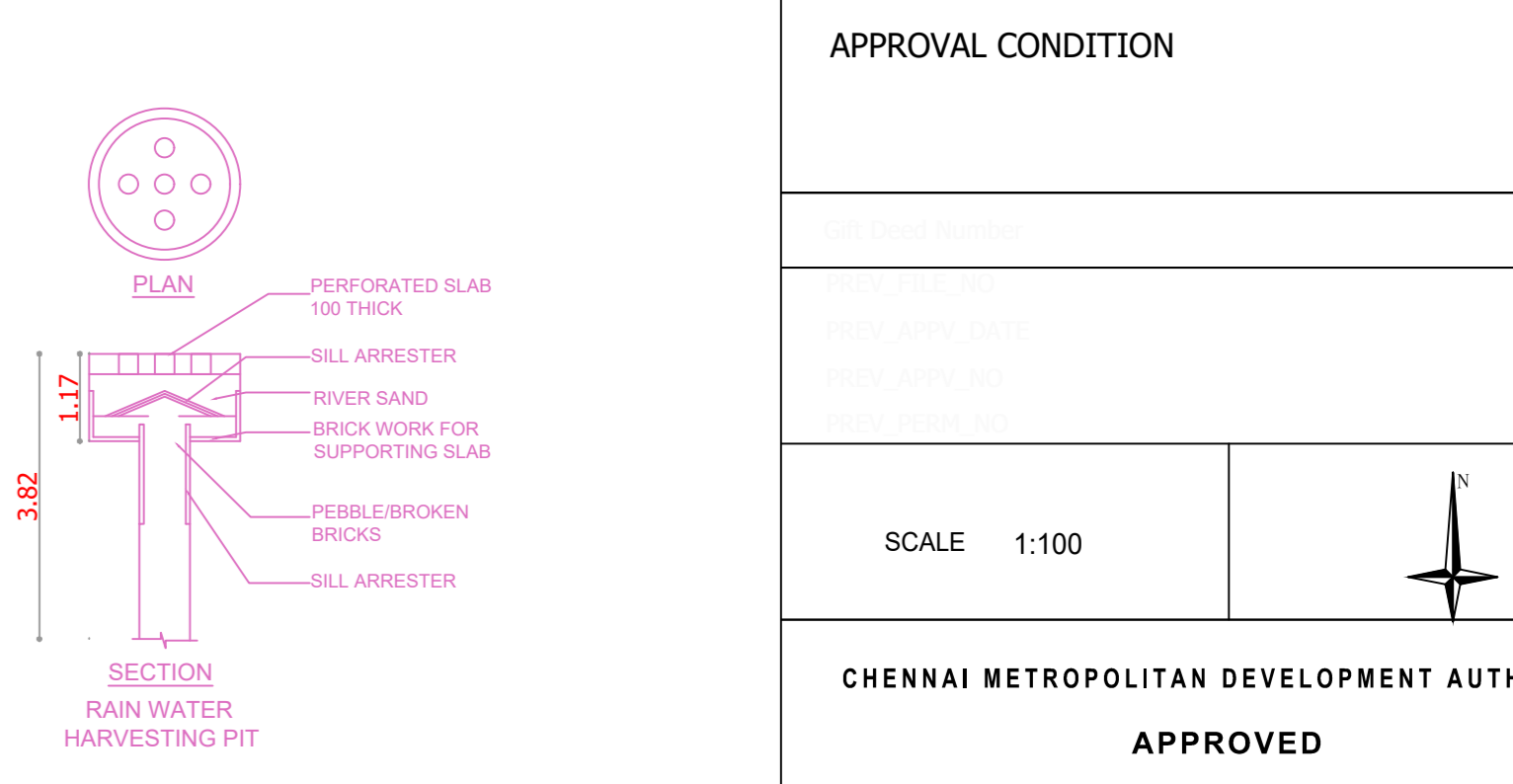
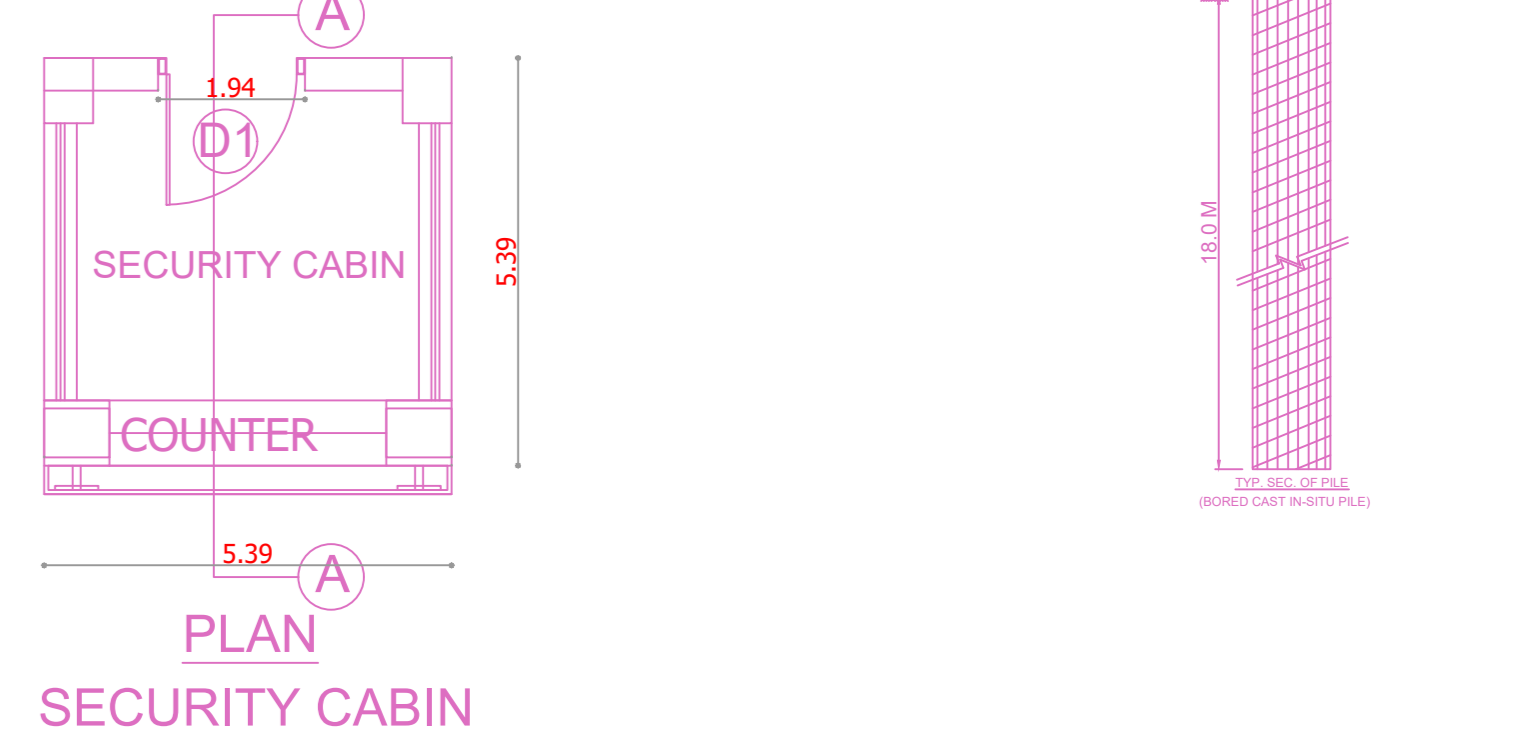
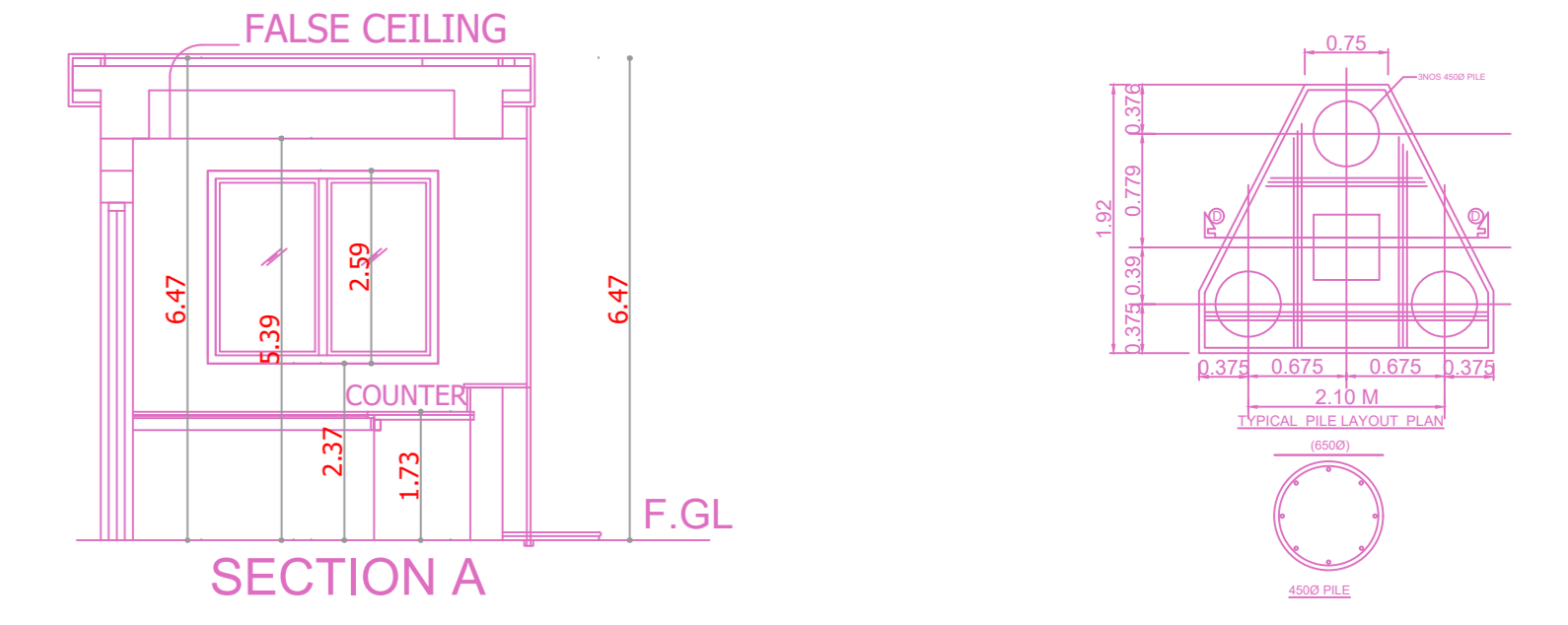

APPROVAL CONDITION

CHENNAI METROPOLITAN DEVELOPMENT AUTHORITY
APPROVED
 SUBJECT TO THE CONDITIONS MENTIONED IN THIS OFFICE

SCALE: 1:100

APPLICANTS: [Owner / Developer / Power of Attorney]

This is a system generated drawing as per the soft copy submitted by the Architect/ License Engineer

