

ELEVATION

SECTION A-A

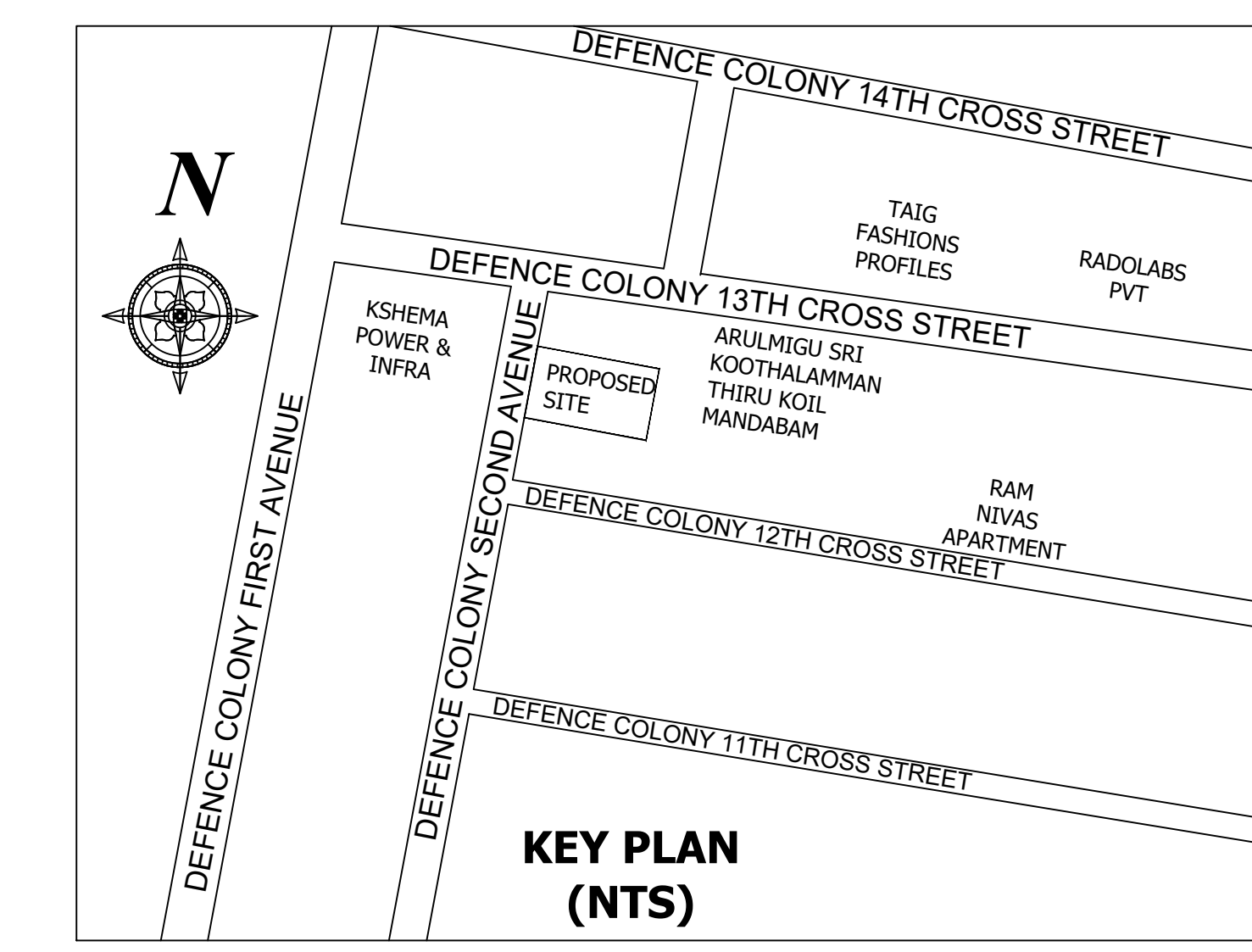

Location plan (Taken as per User Inputs)

PLAN SHOWING THE PROPOSED CONSTRUCTION OF STILL FLOOR (Part) / GROUND FLOOR (Part) + FIRST FLOOR + SECOND FLOOR (Part) + THIRD FLOOR (Part) RESIDENTIAL BUILDING WITH SINGLE DWELLING UNITS (WITH HEIGHT 15.00M) AT PLOT NO. 155, DOOR NO. 155, DEFENCE OFFICERS COLONY 2ND AVENUE, DEFENCE COLONY, EKAATTATHANGAL, CHENNAI-600 032 AND COMPRISED IN S.NO. 163/23 OF NANDAMBARKAM VILLAGE, ALANDUR TALUK AND WITHIN THE LIMITS OF GREATER CHENNAI CORPORATION.

ZONE - XII / DIVISION - 168.

NO.	DESCRIPTION	SO.M.
A1	AREA STATEMENT	900.00
	AREA AS PER PATTA	613.15
	AREA AS PER DOCUMENT	600.00
	AREA CONSIDERED FOR FSI	7.55
	STREET ALIGNMENT/ ROAD WIDENING LINK ROAD	0.00
	OSR AREA	0.00
	TOTAL FSI AREA	964.23
	FSI FACTOR	1.028
	COVERAGE AREA (PERCENTAGE %)	NA

A) PARKING STATEMENT

VEHICLE	REQUIRED	PROVIDED
LORRY	0	0
CAR	4	4
TWO-WHEELER	4	4
CYCLE	0	0

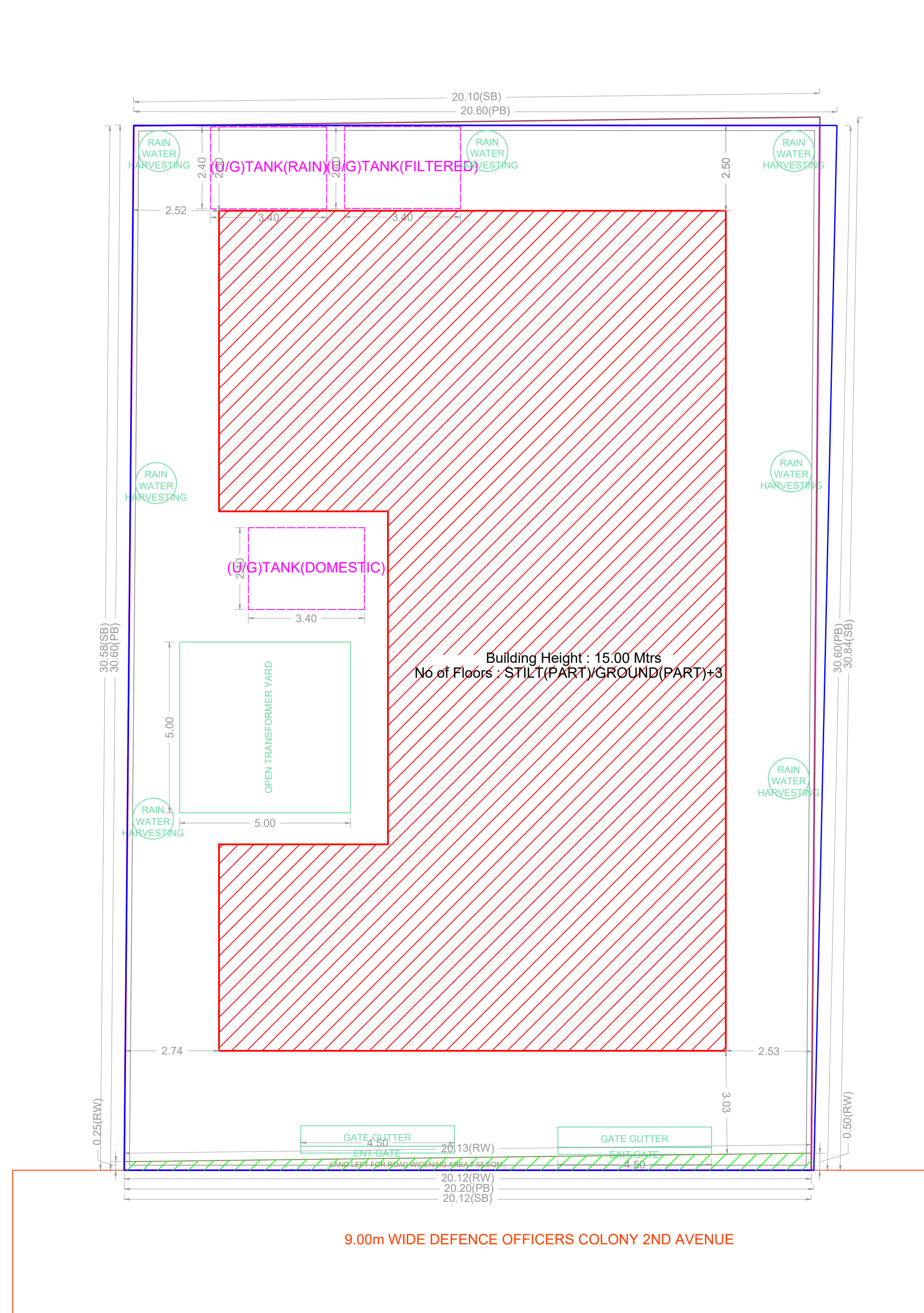

SITE PLAN

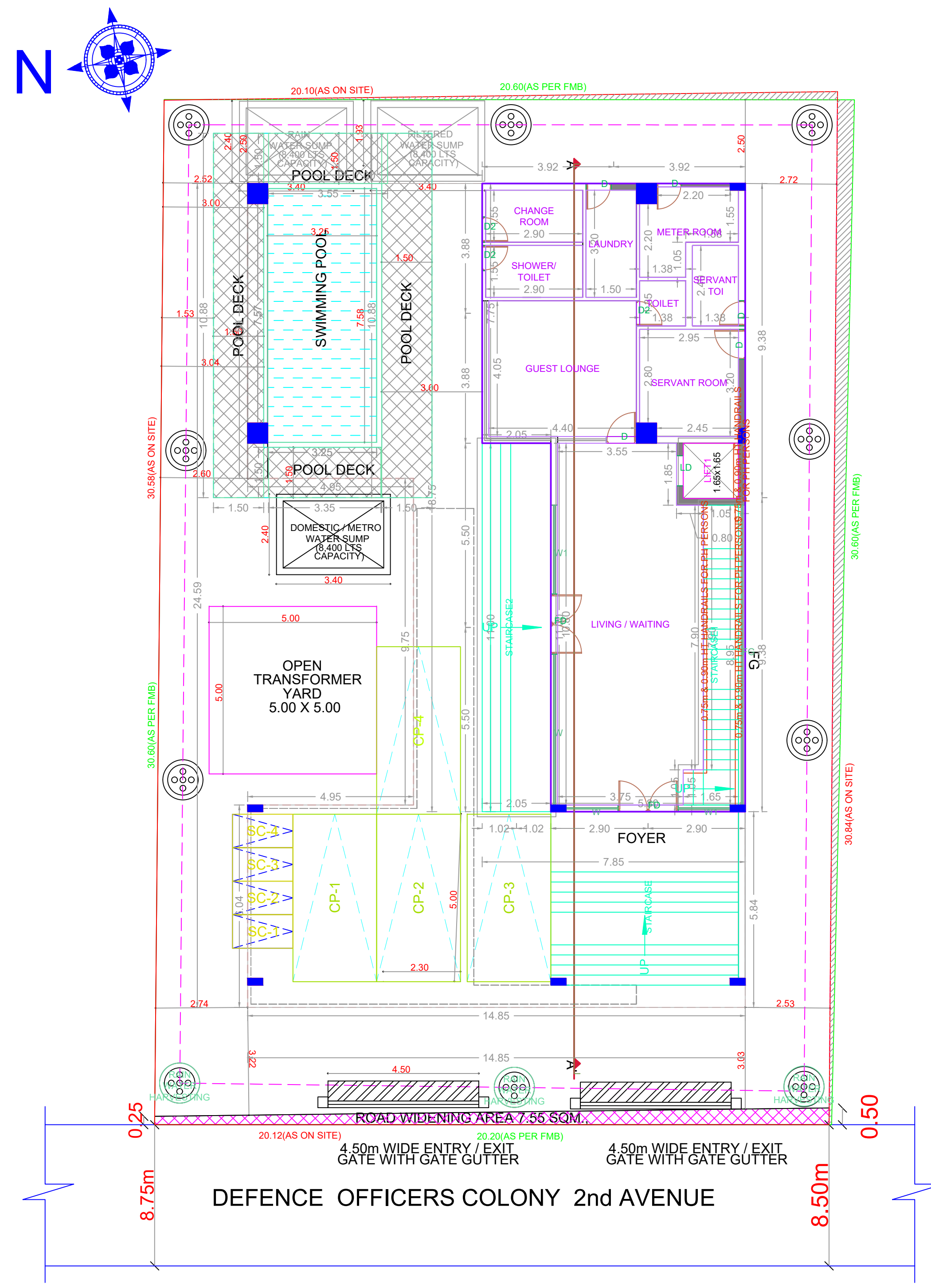

SITE CUM STILT (Part) / GROUND FLOOR (Part)

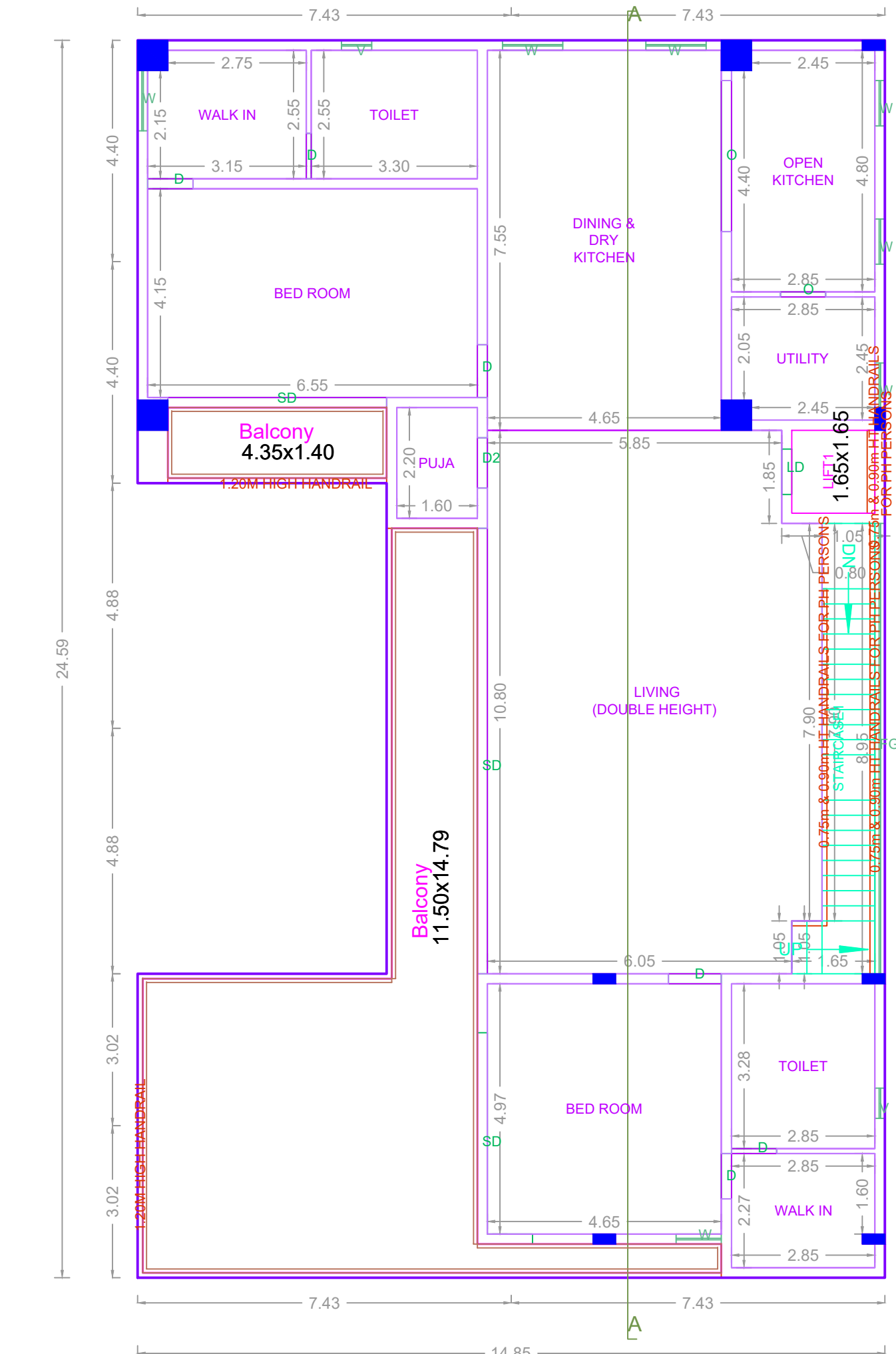

FIRST FLOOR PLAN

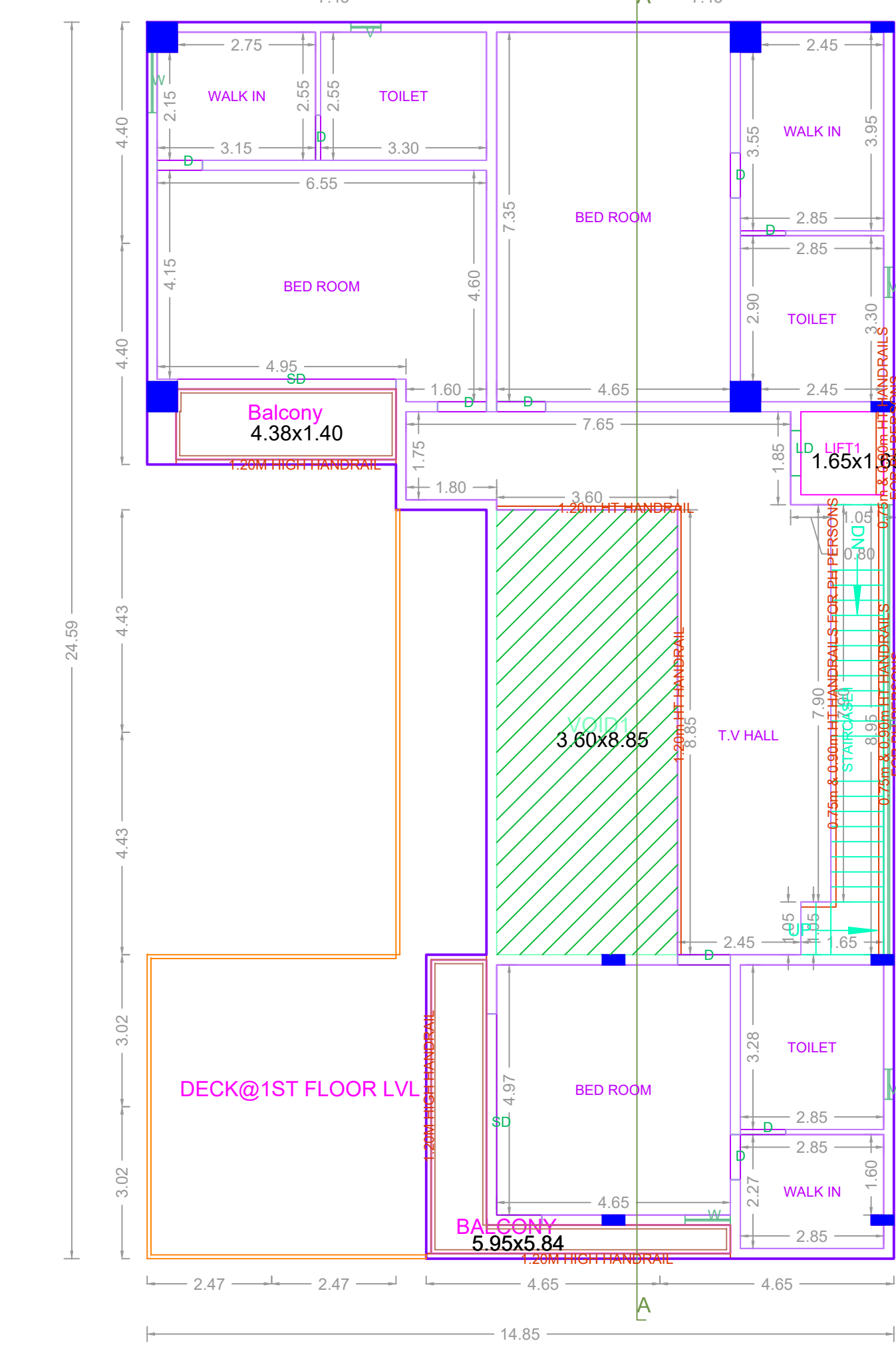

SECOND FLOOR PLAN(PART)

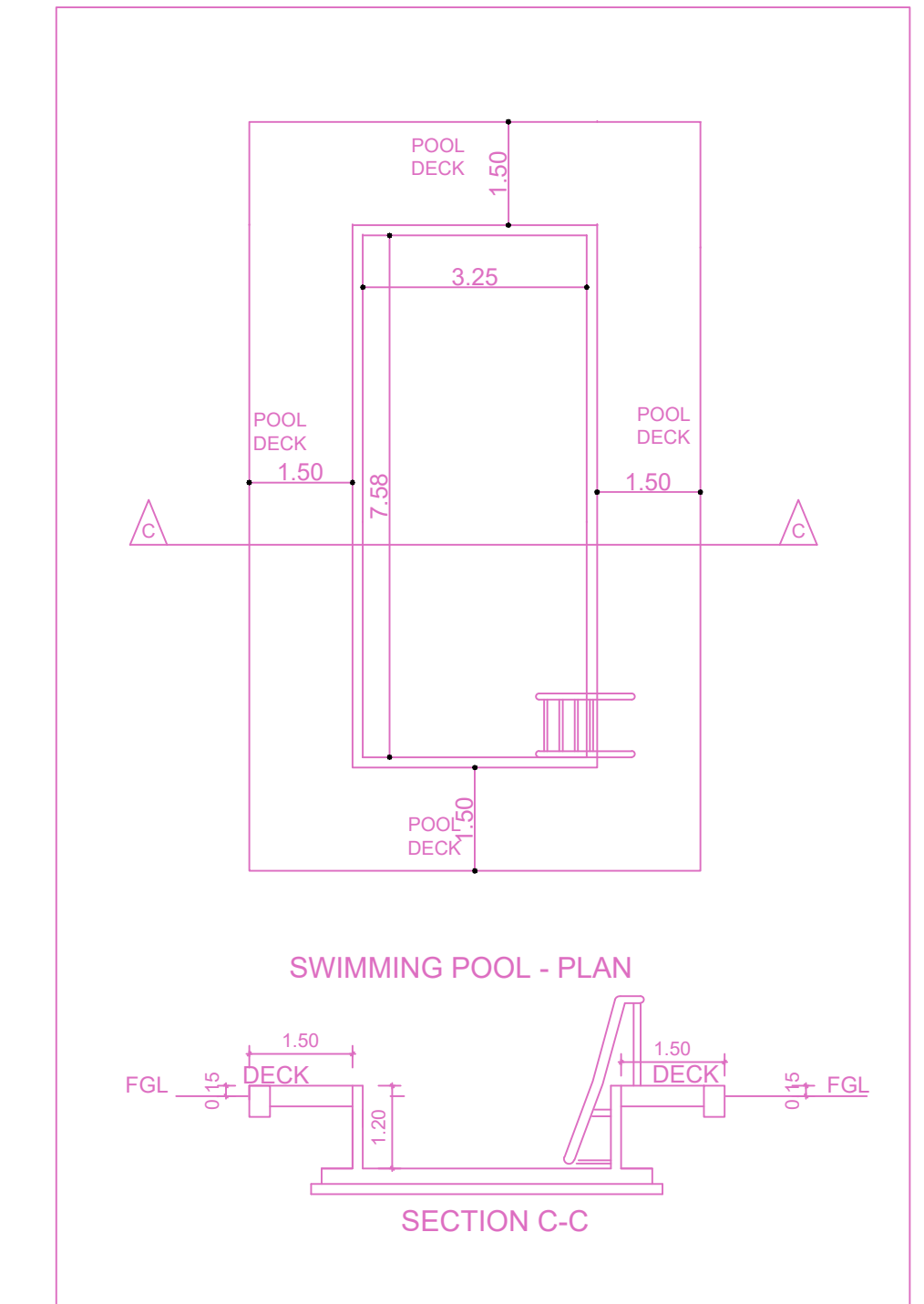

SWIMMING POOL - PLAN  
SECTION C-C

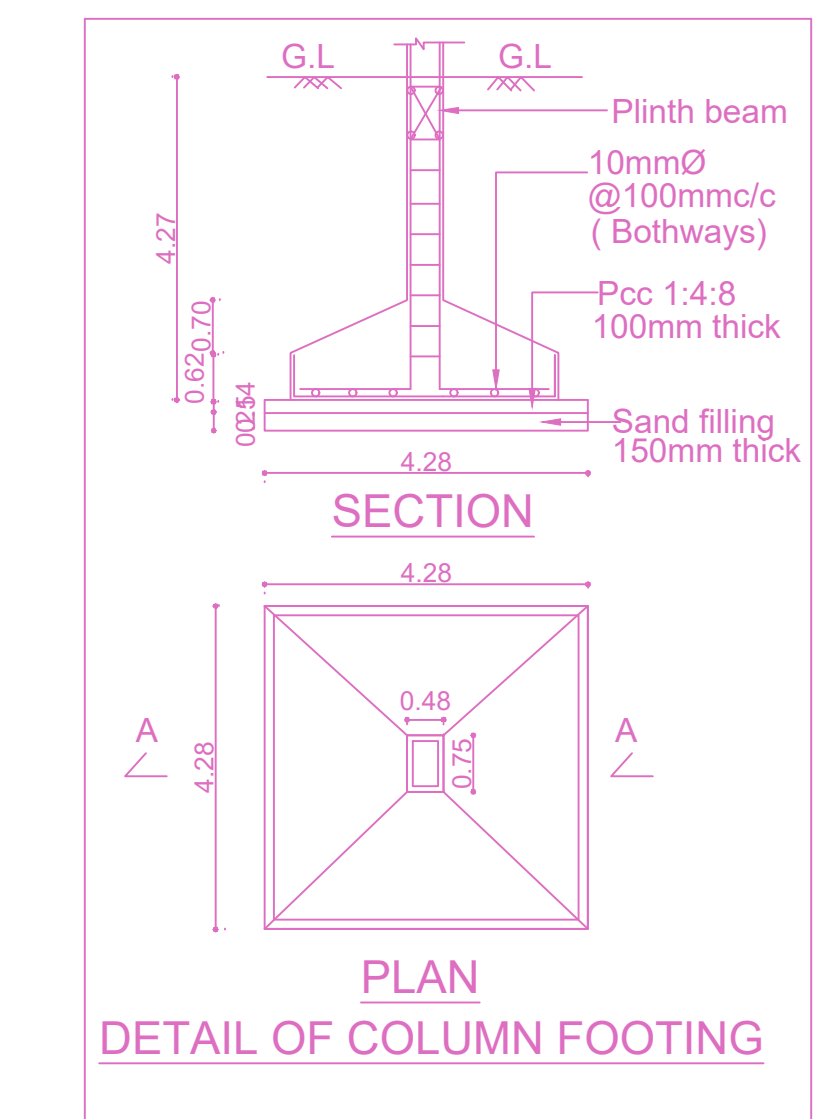

PLAN  
DETAIL OF COLUMN FOOTING

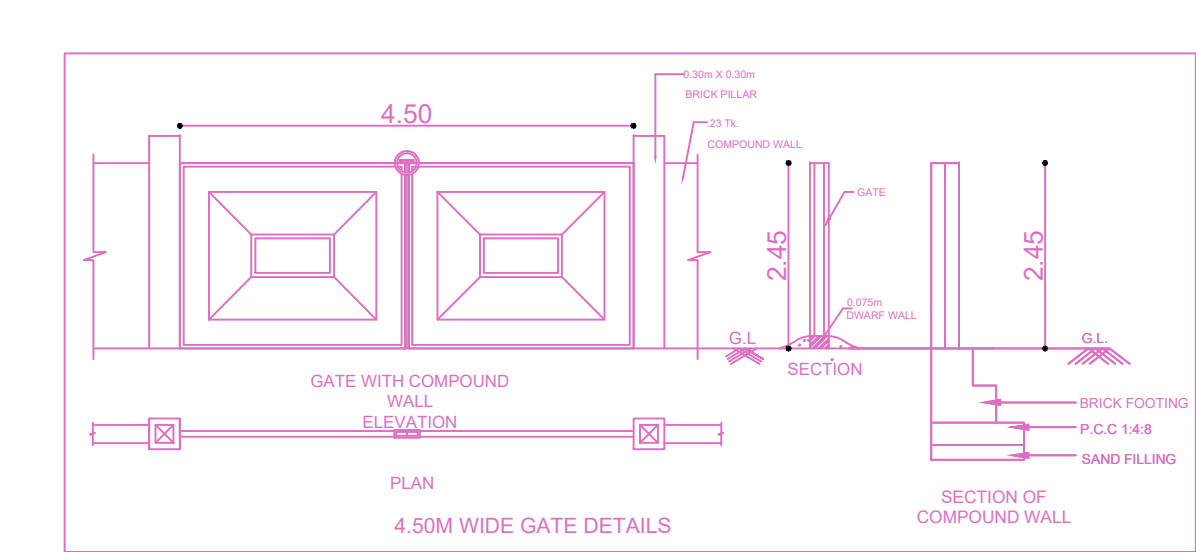
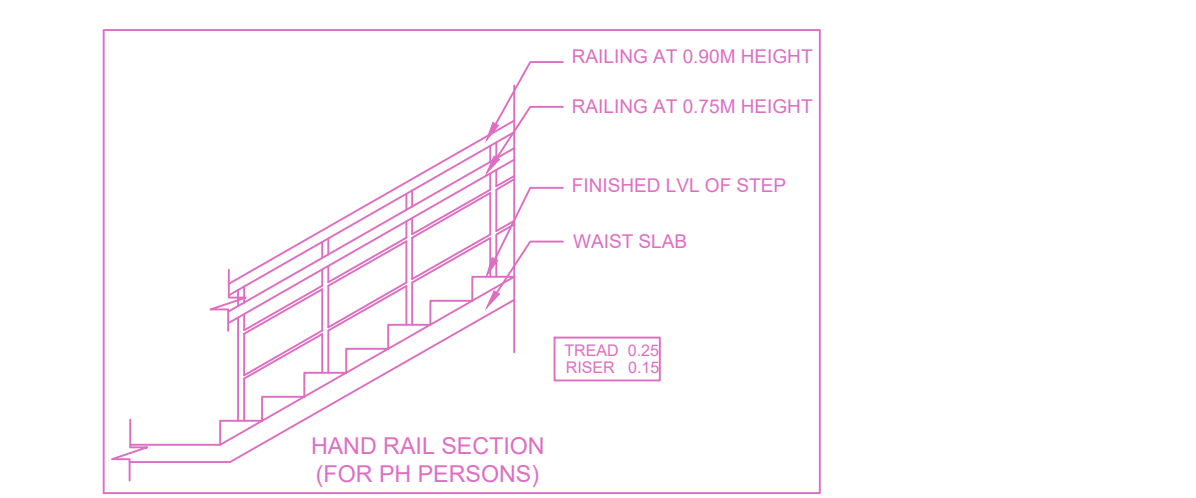

SECTION OF GATE WITH COMPOUND WALL

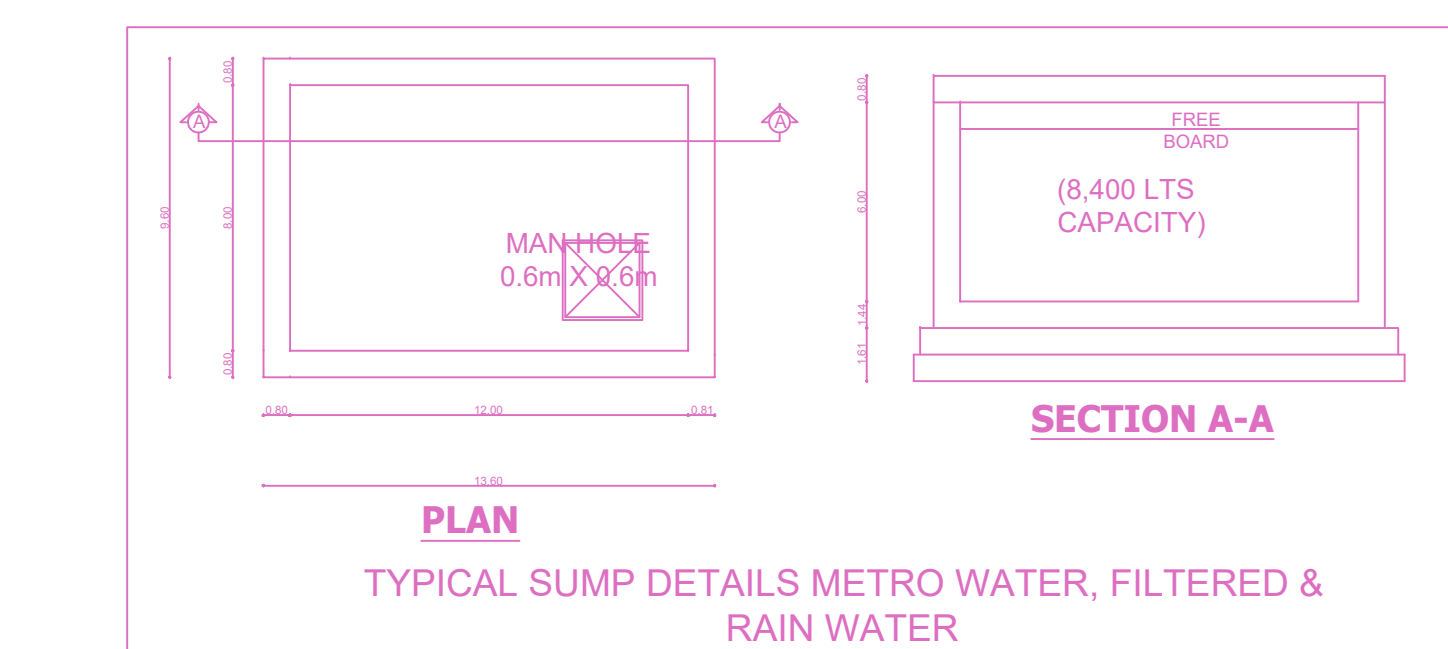

TYPICAL SUMP DETAILS METRO WATER, FILTERED & RAIN WATER

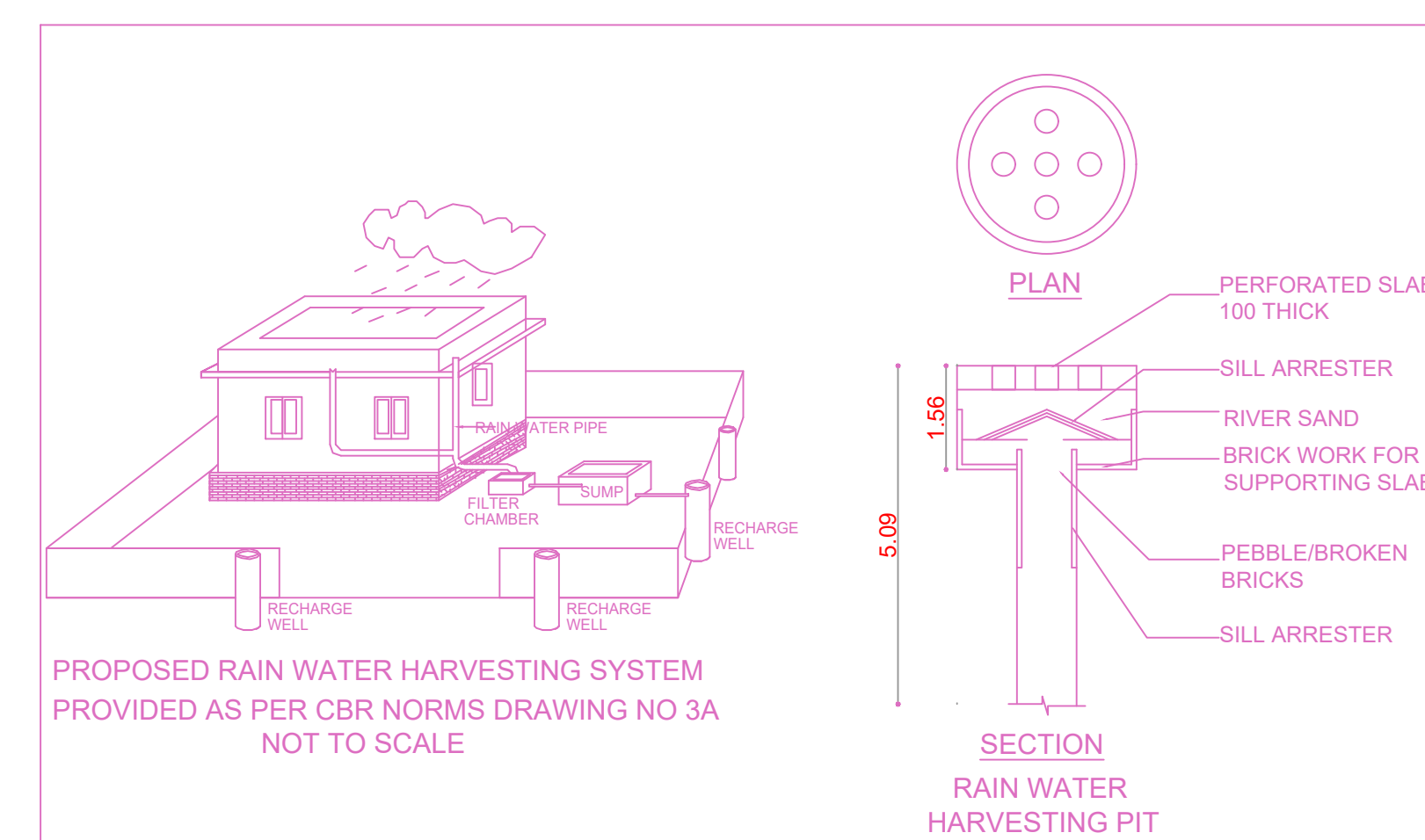

PROPOSED RAIN WATER HARVESTING SYSTEM PROVIDED AS PER CBR NORMS DRAWING NO 3A NOT TO SCALE

**FLOOR WISE FSI STATEMENT: RESIDENTIAL ((SINGLE ...))**

FLOORS	FSI AREA				DU	TOTAL FSI AREA
	COMM.	RESI.	IND.	INST.		
STILT PARKING FLOOR	0.00	124.64	0.00	0.00	1	124.64
FIRST FLOOR	0.00	316.94	0.00	0.00	0	316.94
SECOND FLOOR	0.00	235.62	0.00	0.00	0	235.62
THIRD FLOOR	0.00	287.03	0.00	0.00	0	287.03
Terrace	0.00	0.00	0.00	0.00	0	0.00
Total	0.00	964.23	0.00	0.00	1	964.23

**BUILDING WISE FSI STATEMENT**

BUILDING	NO OF SAME BUILDING	FSI AREA				DU	TOTAL FSI AREA
		COMM.	RESI.	IND.	INST.		
RESIDENTIAL...		0.00	964.23	0.00	0.00	1	964.23
Total		0.00	964.23	0.00	0.00	1	964.23

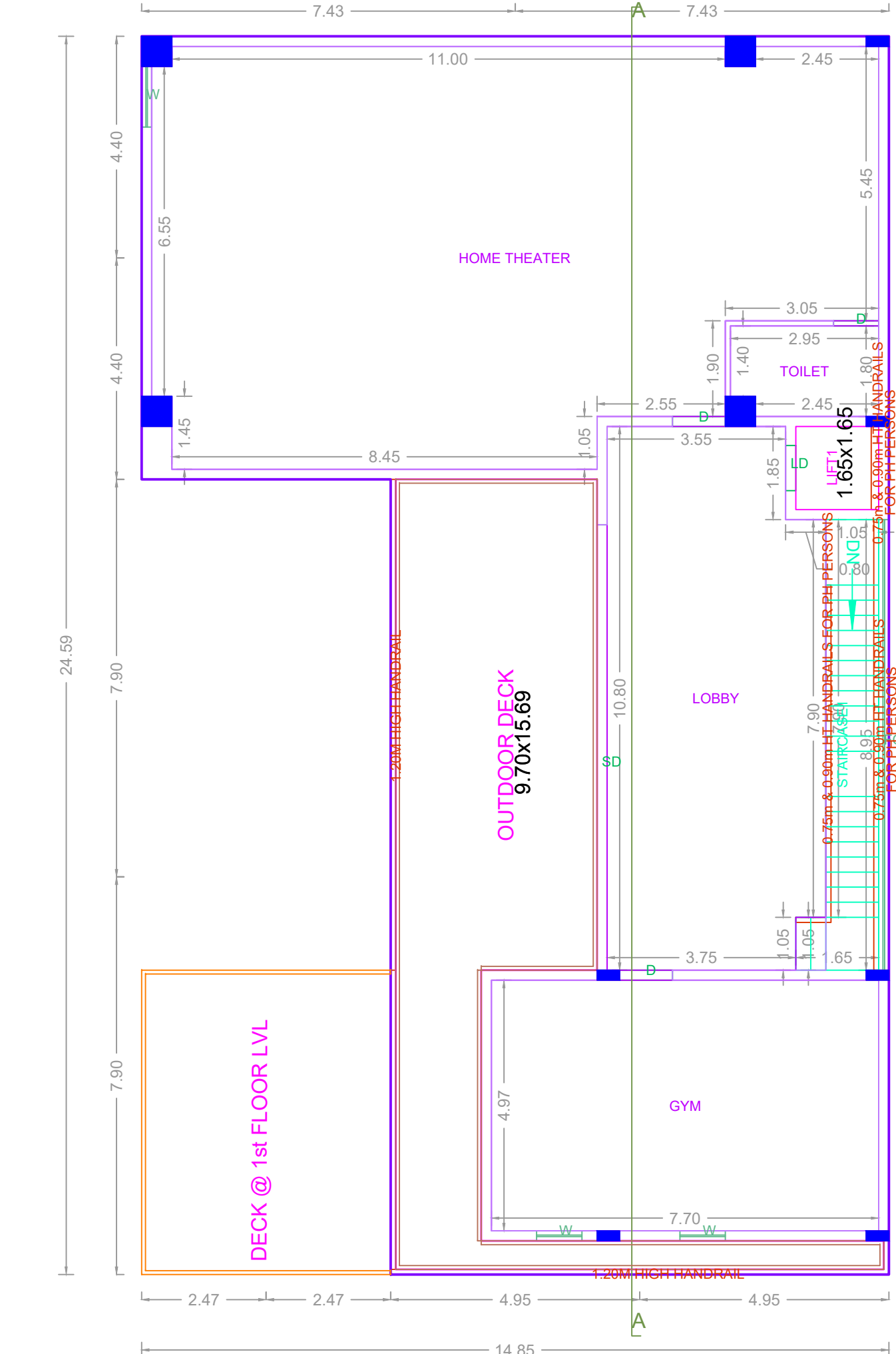

THIRD FLOOR PLAN(PART)

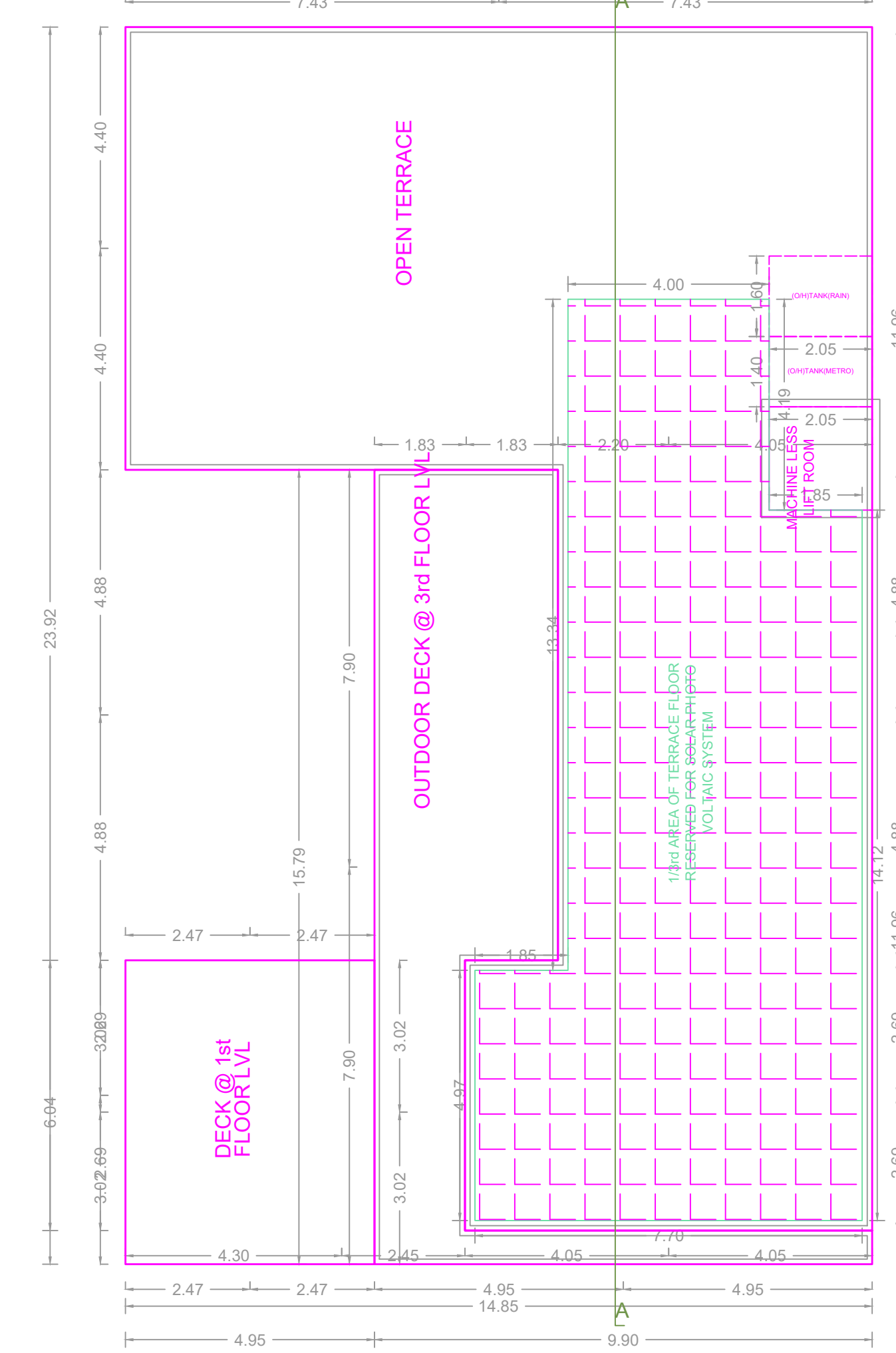

TERRACE FLOOR PLAN

APPROVAL CONDITION

THE PLANNING PERMISSION ISSUED UNDER THIS PLAN IS VALID ONLY FOR THE BUILDING PERMIT TO BE ISSUED BY THE CHENNAI METROPOLITAN DEVELOPMENT AUTHORITY.

SCALE: 1:100

CHENNAI METROPOLITAN DEVELOPMENT AUTHORITY

APPROVED

SUBJECT TO THE CONDITIONS MENTIONED IN THIS OFFICE

For Deputy Planner / Chief Planner / Member (Secretary)

High Rise Building / Non High Rise Building

This Approval is valid only after Building Permit is issued by the concerned Local Body.

OR CODE