

PLAN SHOWING THE PROPOSED CONSTRUCTION OF GROUND FLOOR (PART) / STILT FLOOR (PART) +1st FLOOR TO 3rd FLOOR (PART) RESIDENTIAL BUILDING (HEIGHT -16.00 m) WITH SINGLE DWELLING UNIT AT PLOT NO: 2-B, ABHIRAMAPURAM 4TH STREET, MYLAPORE, CHENNAI-600 018, COMPRISED IN R.S.NO: 3667/45, BLOCK NO: 72 OF MYLAPORE VILLAGE, WITHIN THE LIMITS OF GREATER CHENNAI CORPORATION, ZONE : IX, DIVISION NO - 123.

A) AREA STATEMENT	SQ.M.
AREA AS PER PATTA	549.50
AREA AS PER DOCUMENT	549.61
AREA CONSIDERED FOR FSI	549.50
STREET ALIGNMENT/ ROAD WIDENING/LINK ROAD	0.00
OSR AREA	0.00
TOTAL FSI AREA	735.52
FSI FACTOR	1.339
COVERAGE AREA (PERCENTAGE %)	NA

A) PARKING STATEMENT		
VEHICLE	REQUIRED	PROVIDED
LORRY	0	0
CAR	4	4
TWO WHEELER	4	4
CYCLE	0	0

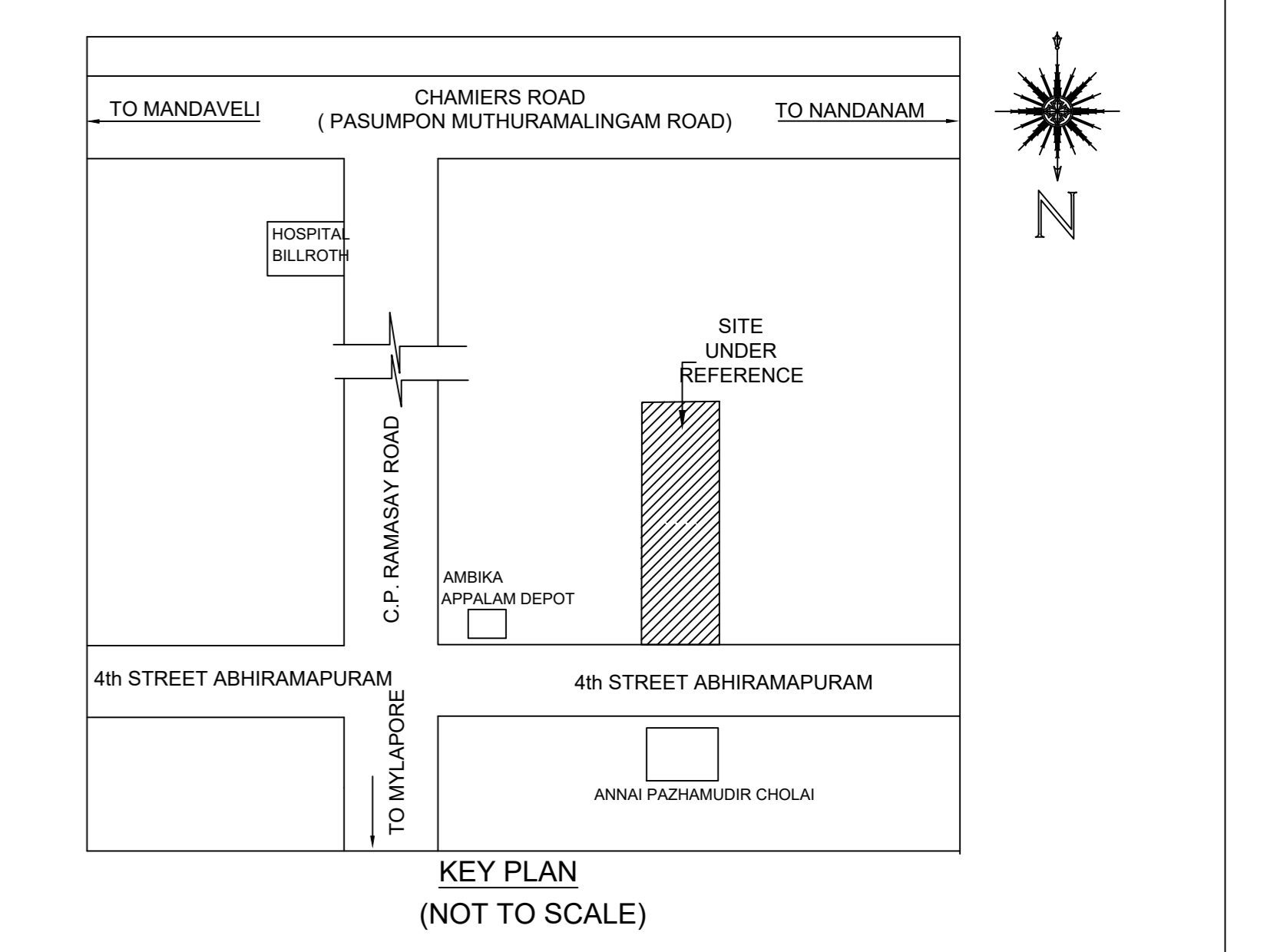
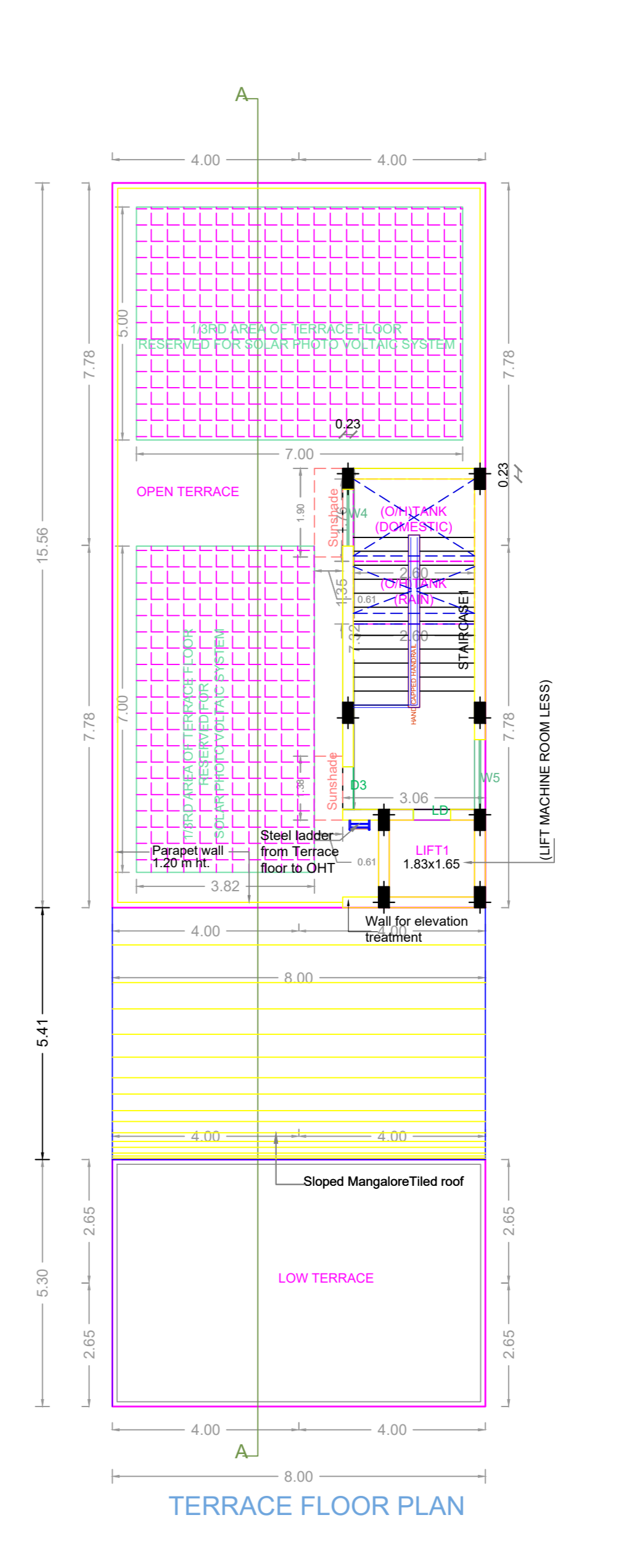
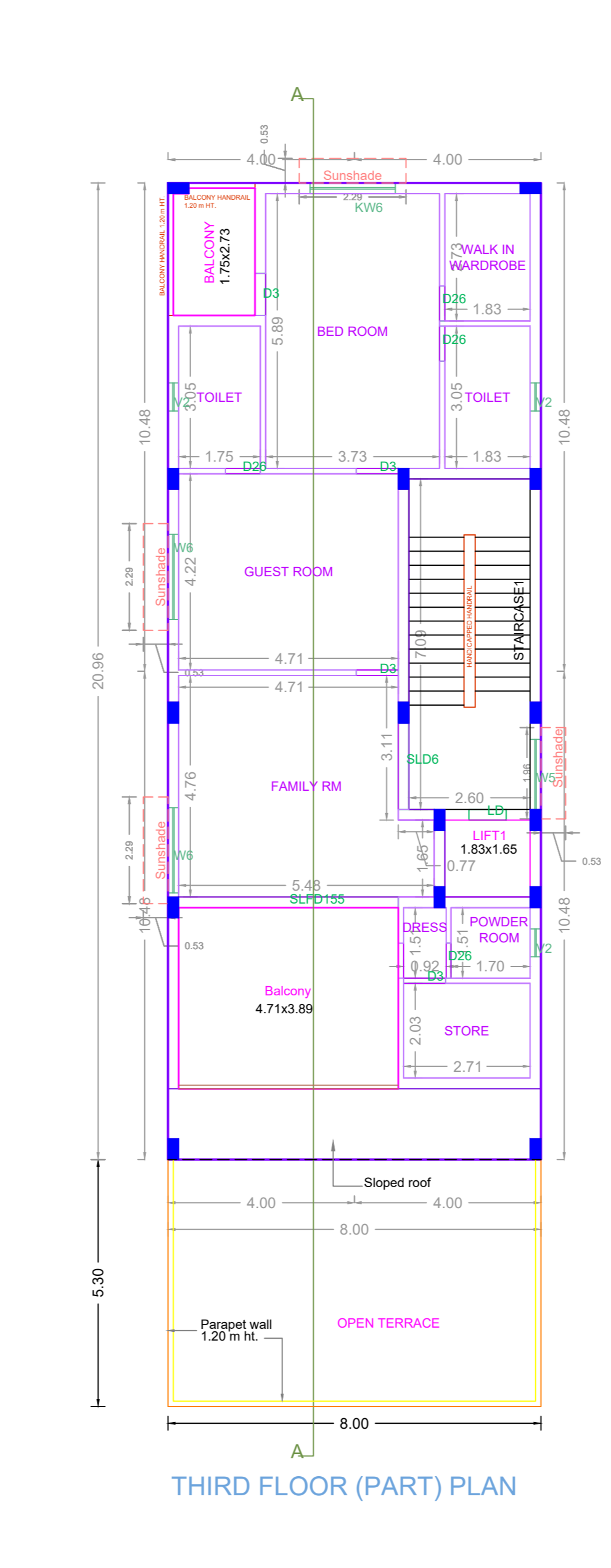
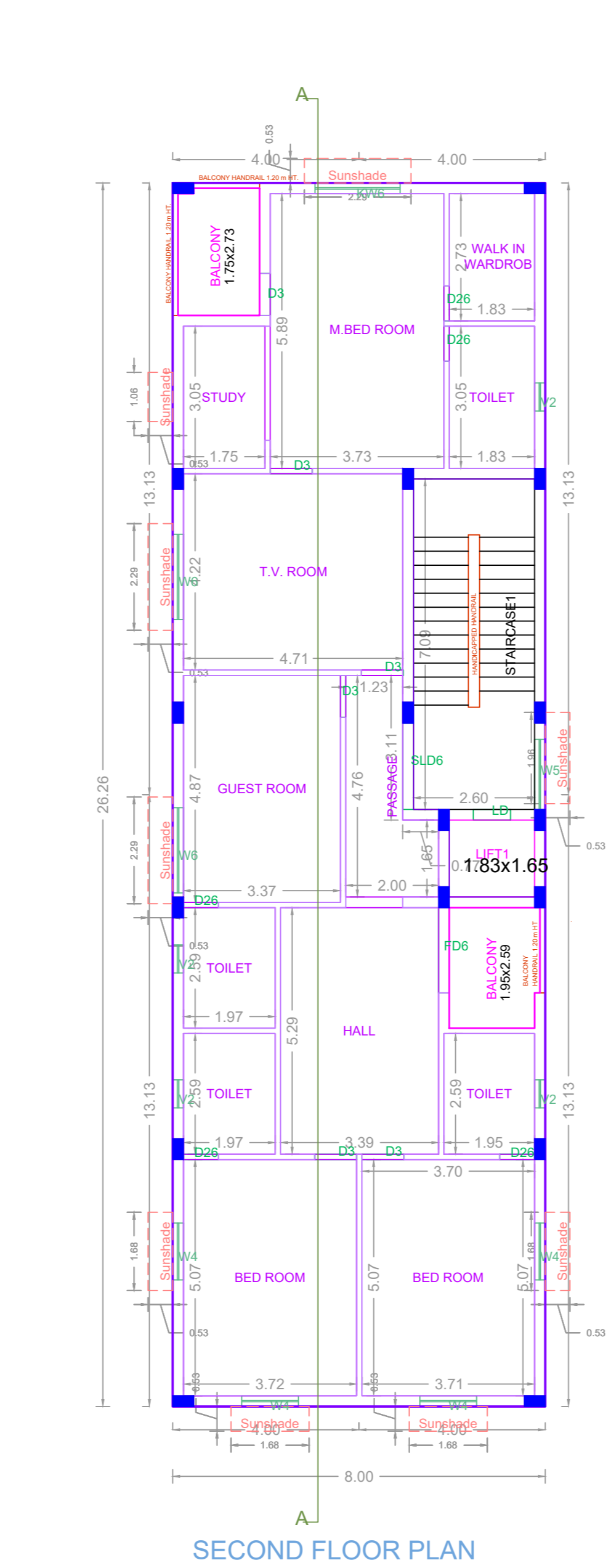
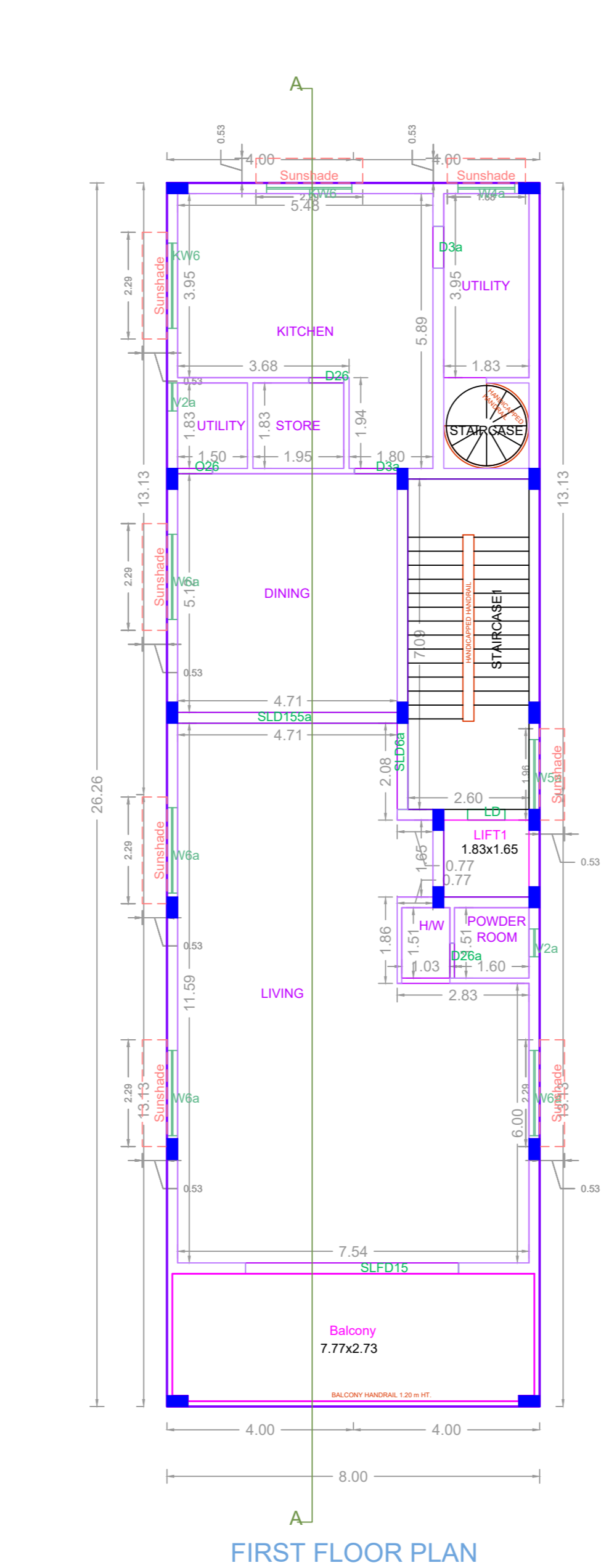
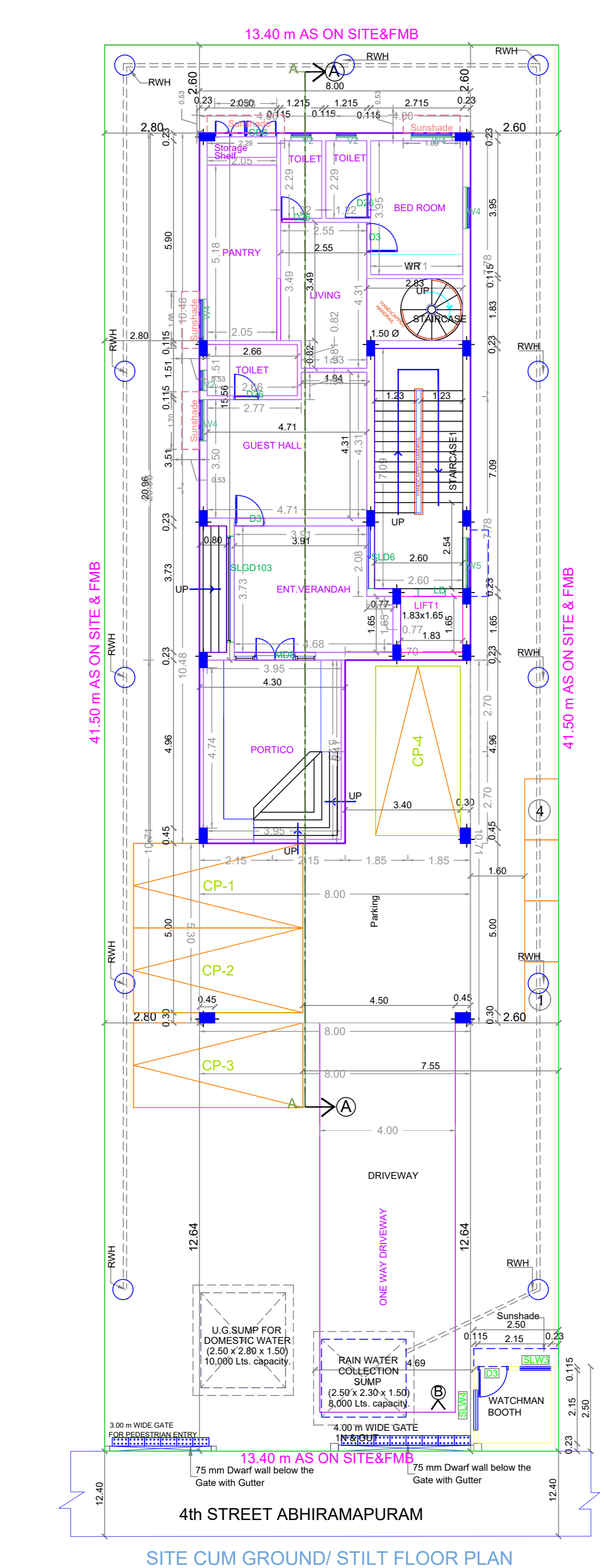
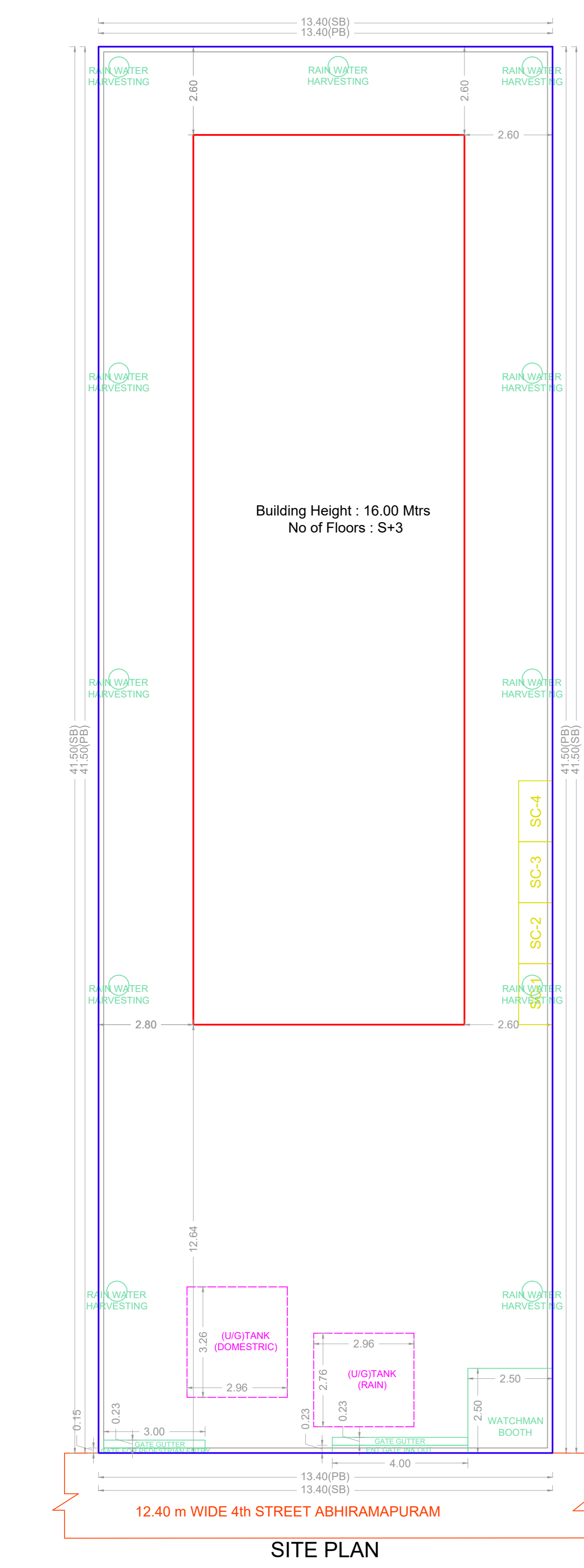

**FLOOR WISE FSI STATEMENT: NHB (ABHIRAMA)**

FLOORS	FSI AREA				DU	TOTAL FSI AREA
	COMM.	RESI.	IND.	INST.		
GROUND/STILTFLOOR	0.00	147.68	0.00	0.00	0	147.68
FIRST FLOOR	0.00	210.08	0.00	0.00	1	210.08
SECOND FLOOR	0.00	210.08	0.00	0.00	0	210.08
THIRD FLOOR	0.00	167.68	0.00	0.00	0	167.68
Terrace	0.00	0.00	0.00	0.00	0	0.00
Total	0.00	735.52	0.00	0.00	1	735.52

**BUILDING WISE FSI STATEMENT**

BUILDING	NO OF SAME BUILDING	FSI AREA				DU	TOTAL FSI AREA
		COMM.	RESI.	IND.	INST.		
NHB-1 (ABHI...)		0.00	735.52	0.00	0.00	1	735.52
Total		0.00	735.52	0.00	0.00	1	735.52

APPROVAL CONDITION

SCALE 1:100

CHENNAI METROPOLITAN DEVELOPMENT AUTHORITY  
**APPROVED**  
SUBJECT TO THE CONDITIONS MENTIONED IN THIS OFFICE

This Planning Permission issued under New Rule TNCDBR, 2019 is subject to final outcome of the W.P. (MD) No.8948 of 2019 and WMP (MD) Nos. 8912 & 8913 of 2019.

For (Deputy Planner / Chief Planner / Member-Secretary)  
High Rise Building / Non High Rise Building  
This Approval is valid only after building Permit is issued by the concerned Local Body.

KEY NO. 9688 QR CODE