

FRONT ELEVATION

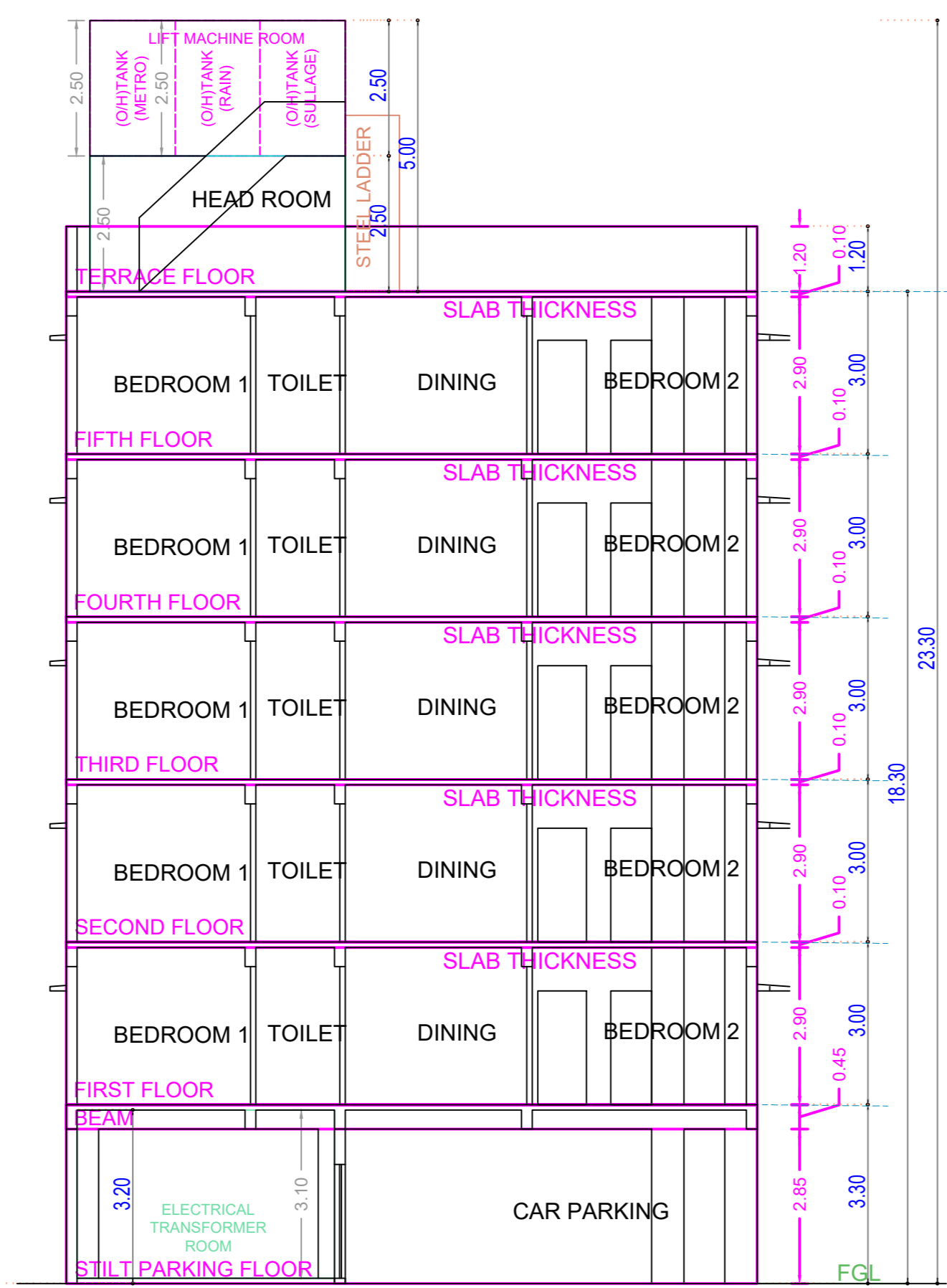

SECTION ON 'XX'

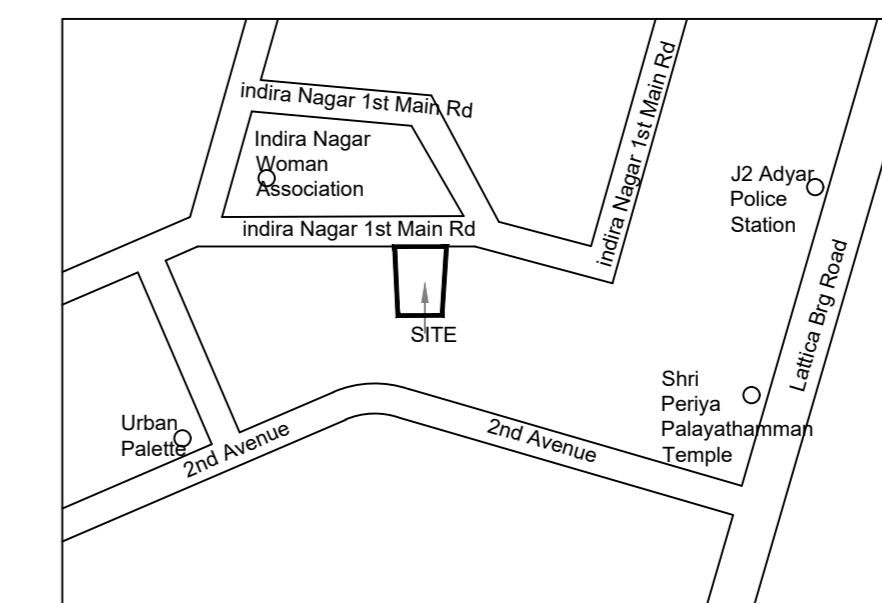
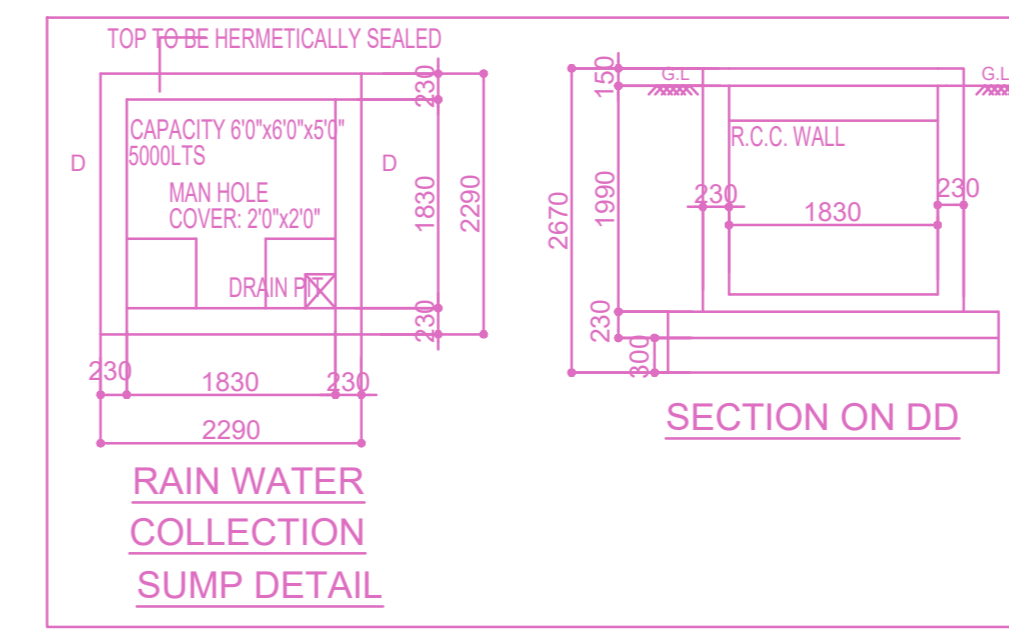
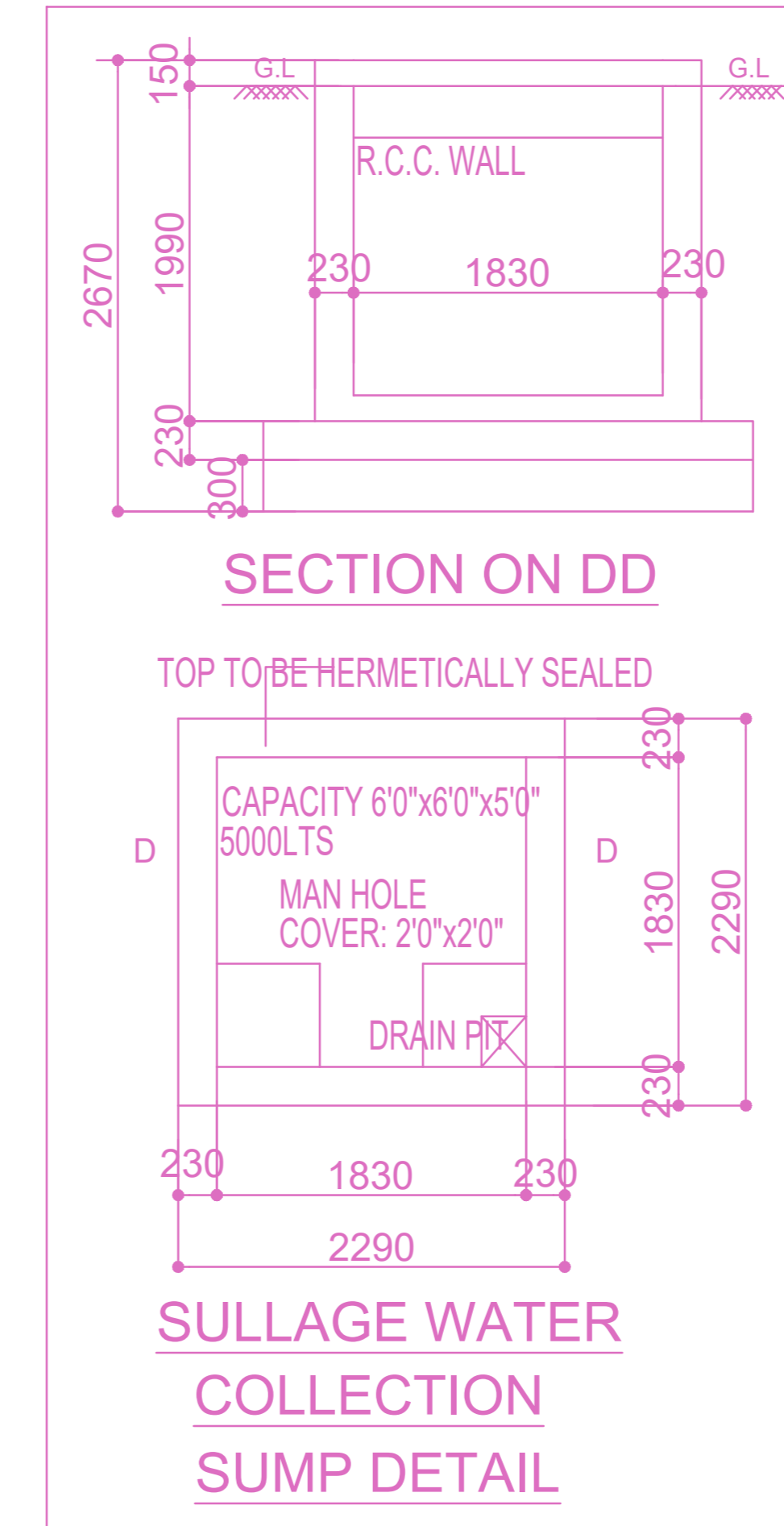
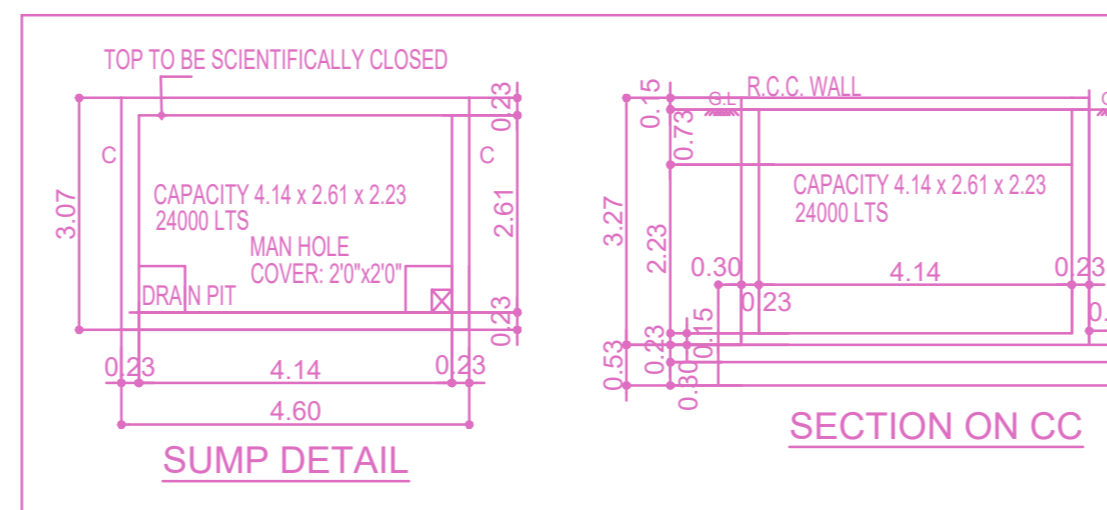
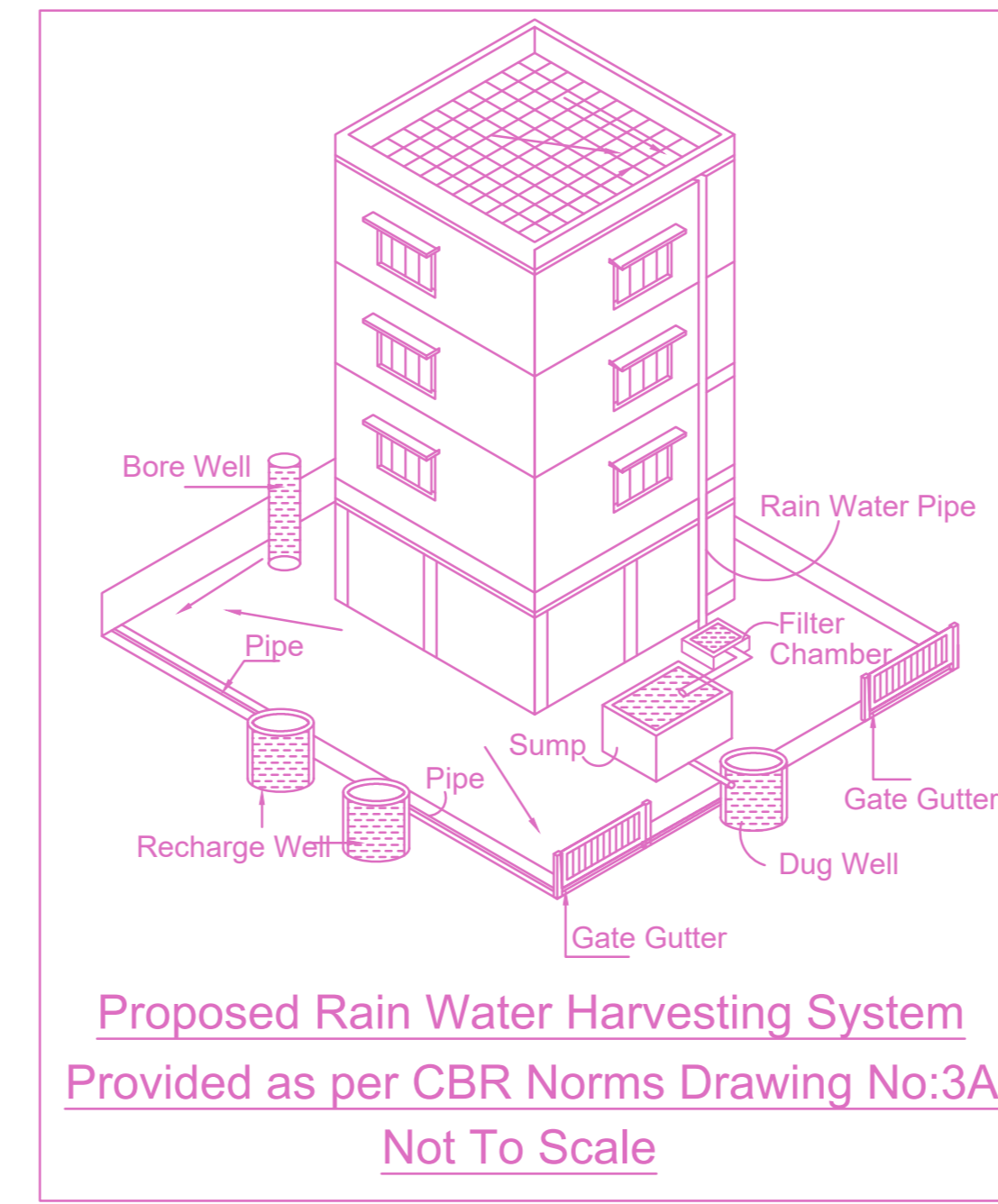
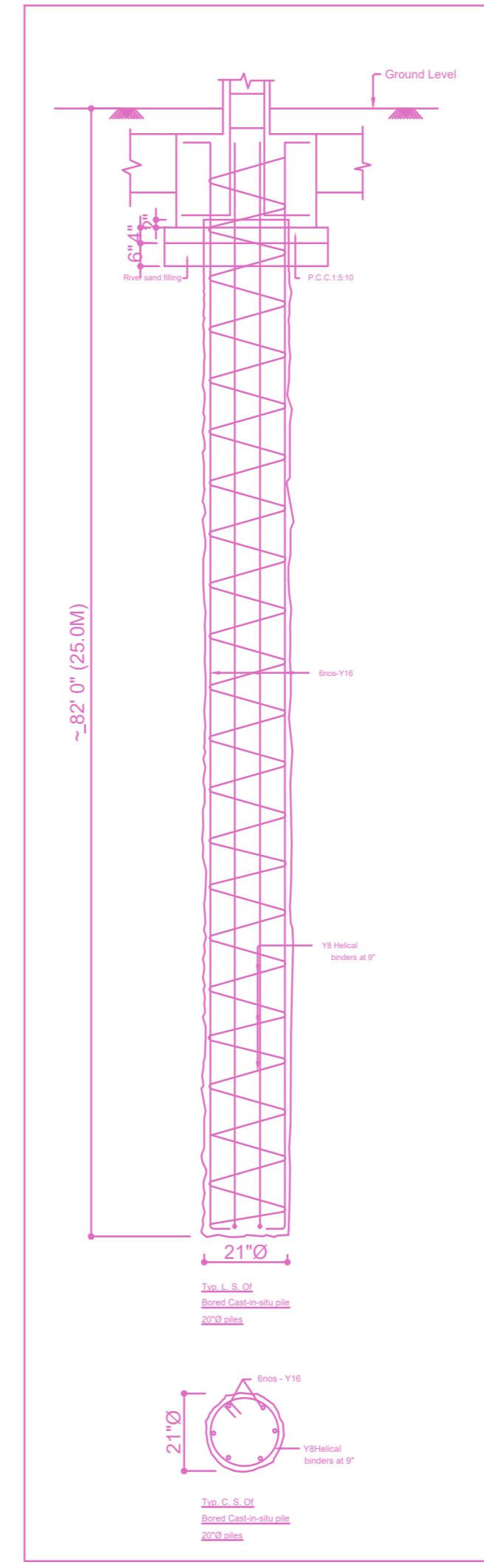

Location plan (Taken as per User Inputs)

PLAN SHOWING THE PROPOSED RESIDENTIAL BUILDING STILT + 5 FLOORS WITH 10 DWELLING UNITS AT PLOT NO: 424(W), NEW DOOR NO: 47, OLD DOOR NO: 23, INDIRA NAGAR 1ST MAIN ROAD, INDIRA NAGAR, CHENNAI - 600020. COMPRISED ON T.S.NO: 98, BLOCK NO: 15, KALIKUNDRAM VILLAGE, VELACHERY TALUK, CHENNAI DISTRICT, GREATER CHENNAI CORPORATION, DIVISION NO: 173, ZONE NO: 13.

A) AREA STATEMENT		SQ.M.
AREA AS PER PATTA		475.00
AREA AS PER DOCUMENT		480.58
AREA CONSIDERED FOR FSI		475.00
STREET ALIGNMENT/ ROAD WIDENING/LINK ROAD		0.00
OSR AREA		0.00
TOTAL FSI AREA		1210.00
FSI FACTOR		2.547
COVERAGE AREA (PERCENTAGE %)		NA

A) PARKING STATEMENT		
VEHICLE	REQUIRED	PROVIDED
LORRY	0	0
CAR	11	13
TWO WHEELER	0	0
CYCLE	0	0

FLOOR WISE FSI STATEMENT: RES (NHRB)

FLOORS	FSI AREA				DU	TOTAL FSI AREA
	COMM.	RESI.	IND.	INST.		
STILT PARKING FLOOR	0.00	33.45	0.00	0.00	0	33.45
FIRST FLOOR	0.00	235.31	0.00	0.00	2	235.31
SECOND FLOOR	0.00	235.31	0.00	0.00	2	235.31
THIRD FLOOR	0.00	235.31	0.00	0.00	2	235.31
FOURTH FLOOR	0.00	235.31	0.00	0.00	2	235.31
FIFTH FLOOR	0.00	235.31	0.00	0.00	2	235.31
Terrace	0.00	0.00	0.00	0.00	0	0.00
Total	0.00	1210.00	0.00	0.00	10	1210.00

BUILDING WISE FSI STATEMENT

BUILDING	NO OF SAME BUILDING	FSI AREA				DU	TOTAL FSI AREA
		COMM.	RESI.	IND.	INST.		
RES-1 (NHRB)		0.00	1210.00	0.00	0.00	10	1210.00
Total		0.00	1210.00	0.00	0.00	10	1210.00

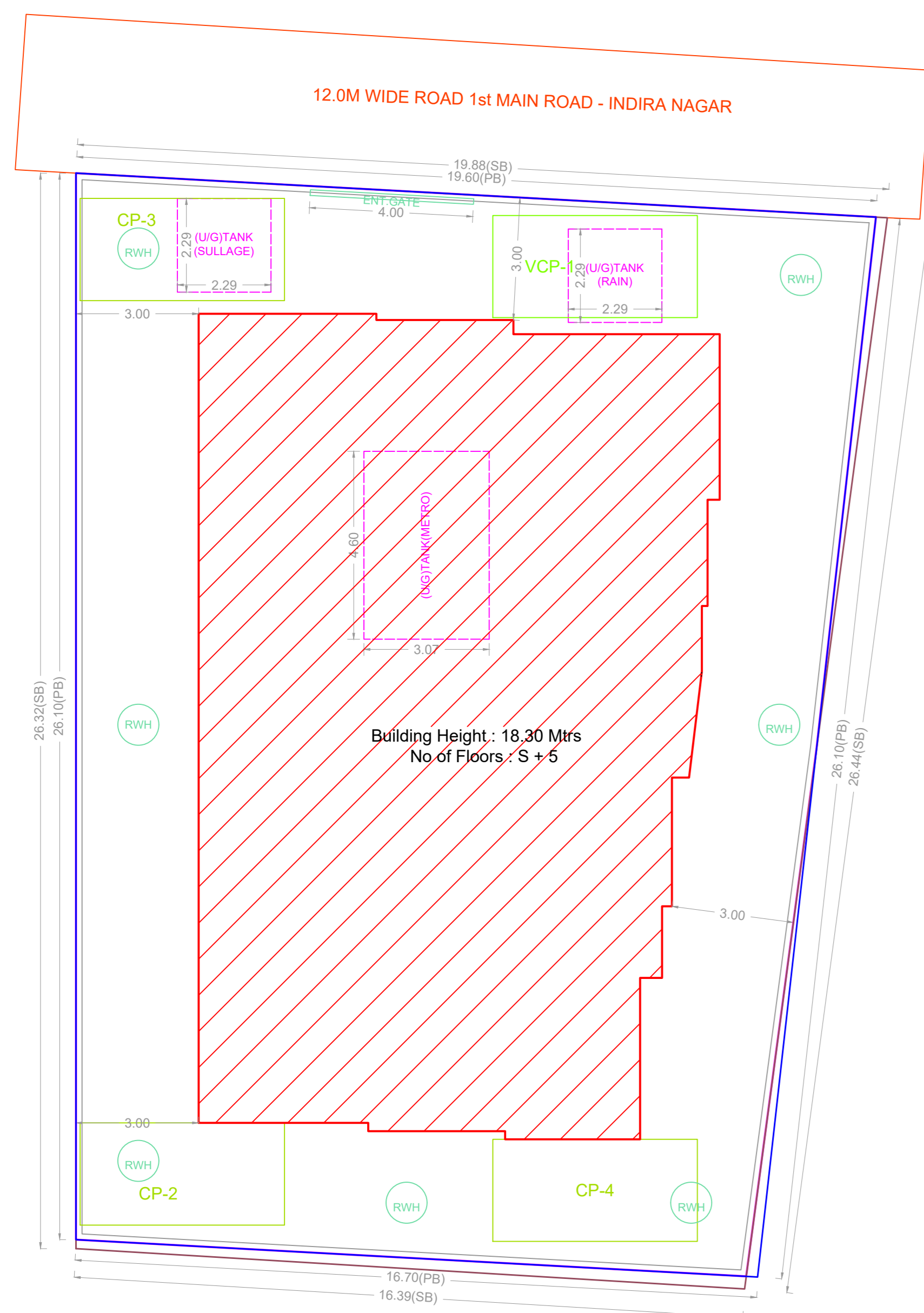

SITE PLAN

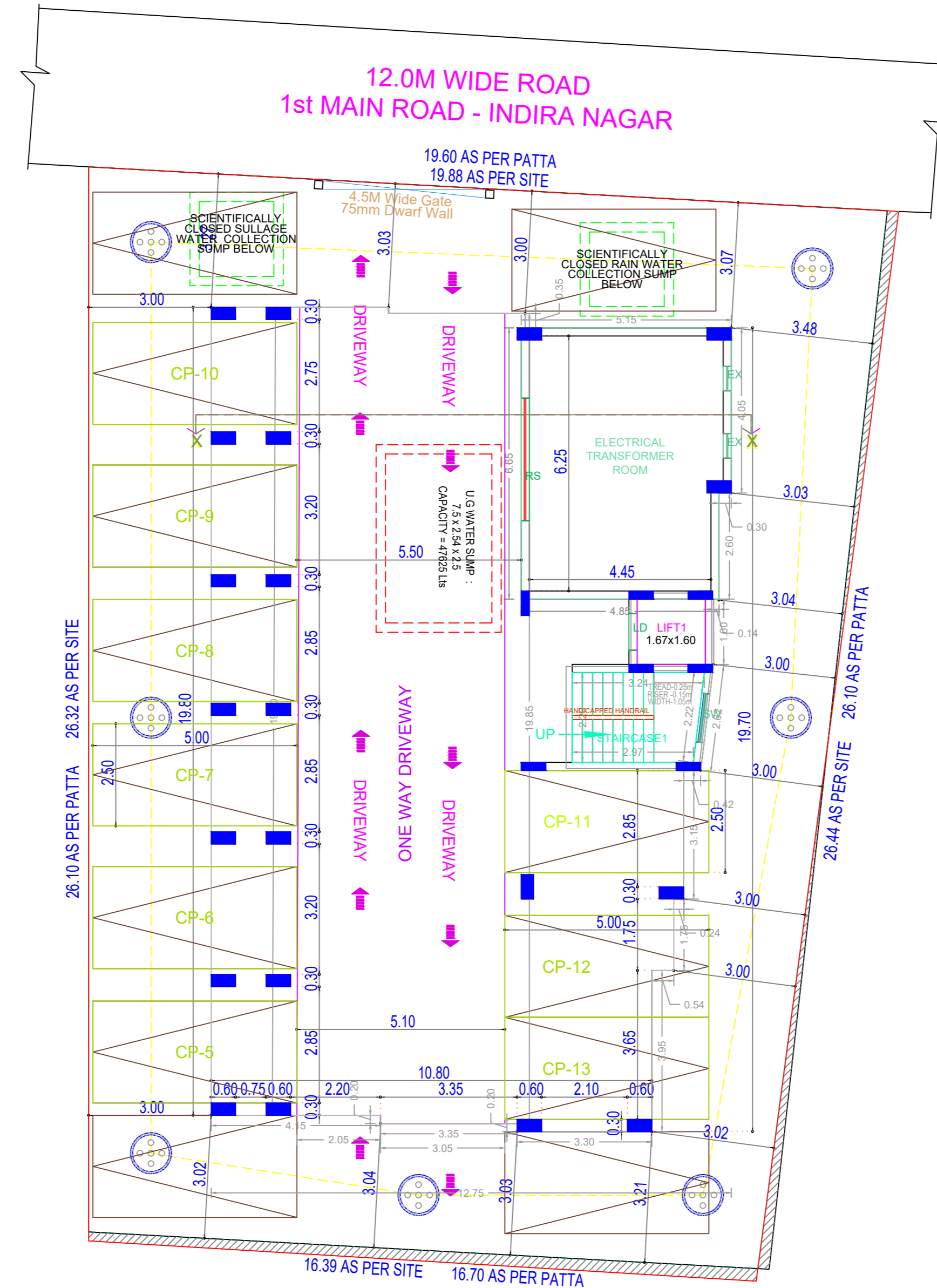

SITE CUM STILT FLOOR PLAN

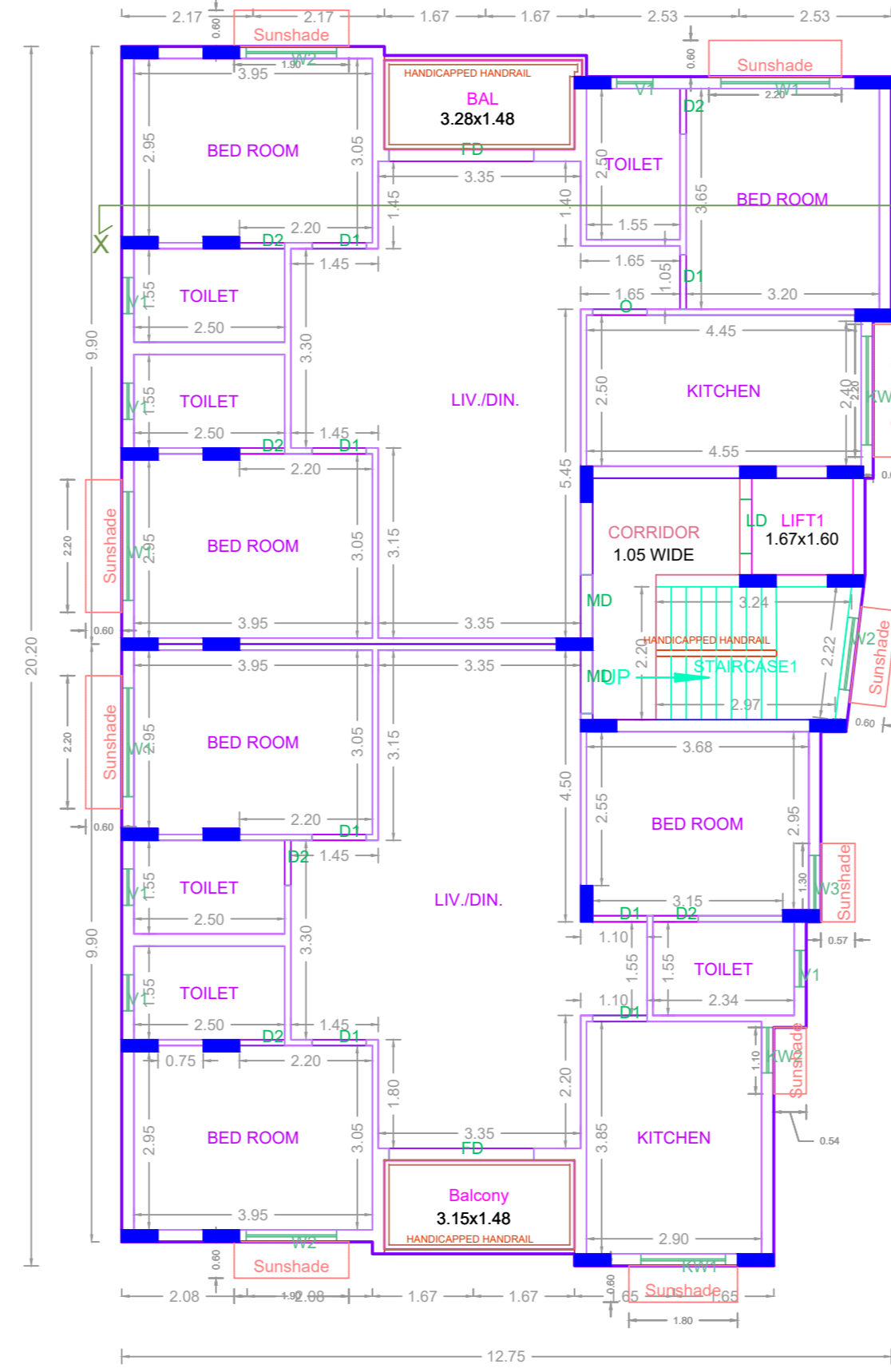

TYPICAL - 1-5 FLOOR PLAN

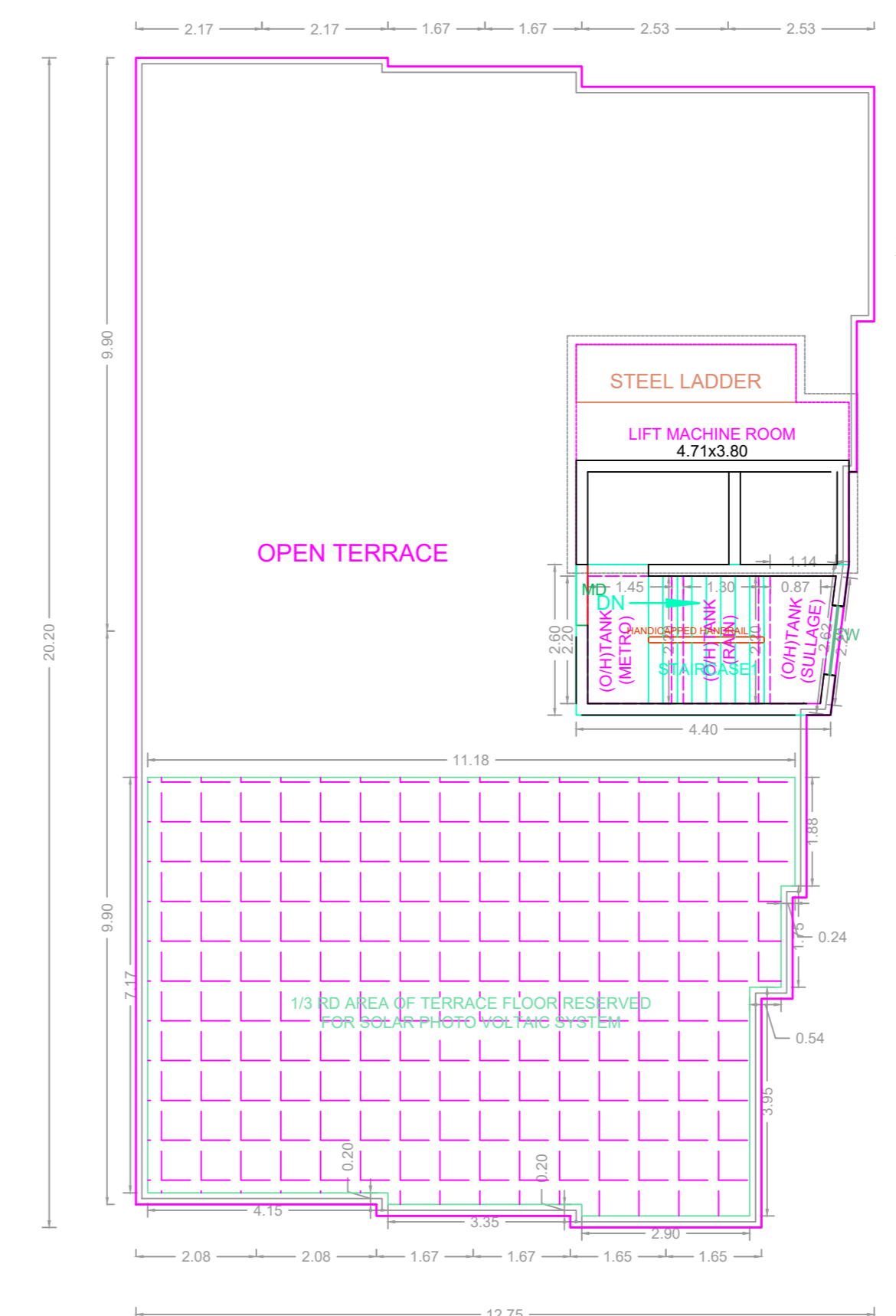

TERRACE FLOOR PLAN

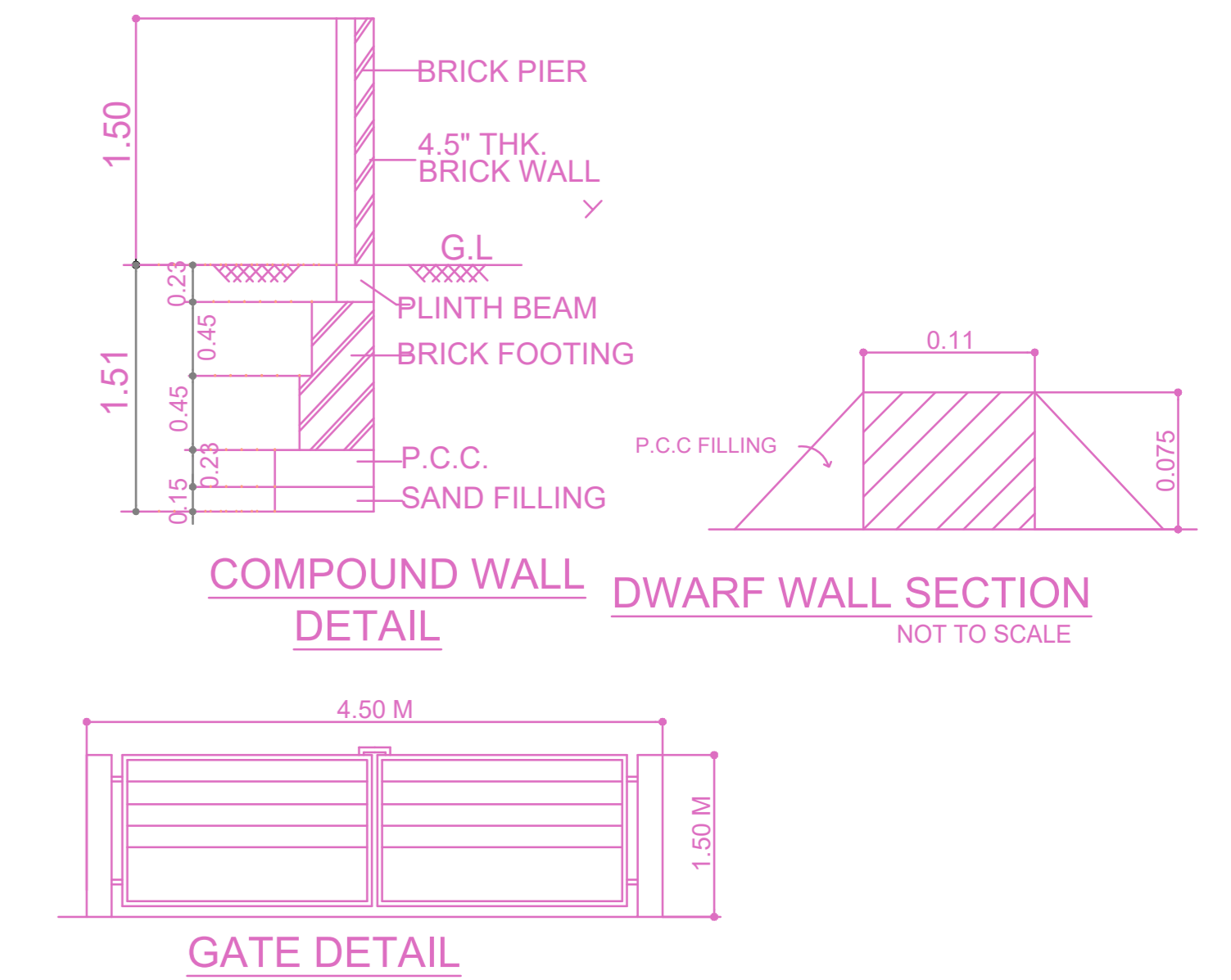

APPROVAL CONDITION

1. The Building shall be constructed as per the approved drawings.

2. The Building shall be constructed as per the approved specifications.

3. The Building shall be constructed as per the approved conditions.

SCALE 1:100



CHENNAI METROPOLITAN DEVELOPMENT AUTHORITY

APPROVED

SUBJECT TO THE CONDITIONS MENTIONED IN THIS OFFICE

For (Deputy Planner / Chief Planner / Member-Secretary)

High Rise Building / Non High Rise Building

This Approval is valid only after building Permit is issued by the concerned Local Body.

QR CODE